

ROUTE NO.	SECTION	COUNTY	TOTAL SHEETS	SHEET NO.
TR 434	*	IROQUOIS	23	22
STA. 21+75.00 TO STA. 22+00.00				
FED. ROAD DIST. NO. 7	ILLINOIS	PROJECT BROS-075(31)	CONTRACT #87356	

SURVEYED	SURVEY
NOTE BOOK	TEMPLATE
AREAS CHECKED	AREAS CHECKED
NO.	NO.

SURVEYED	SURVEY
NOTE BOOK	TEMPLATE
AREAS CHECKED	AREAS CHECKED
NO.	NO.

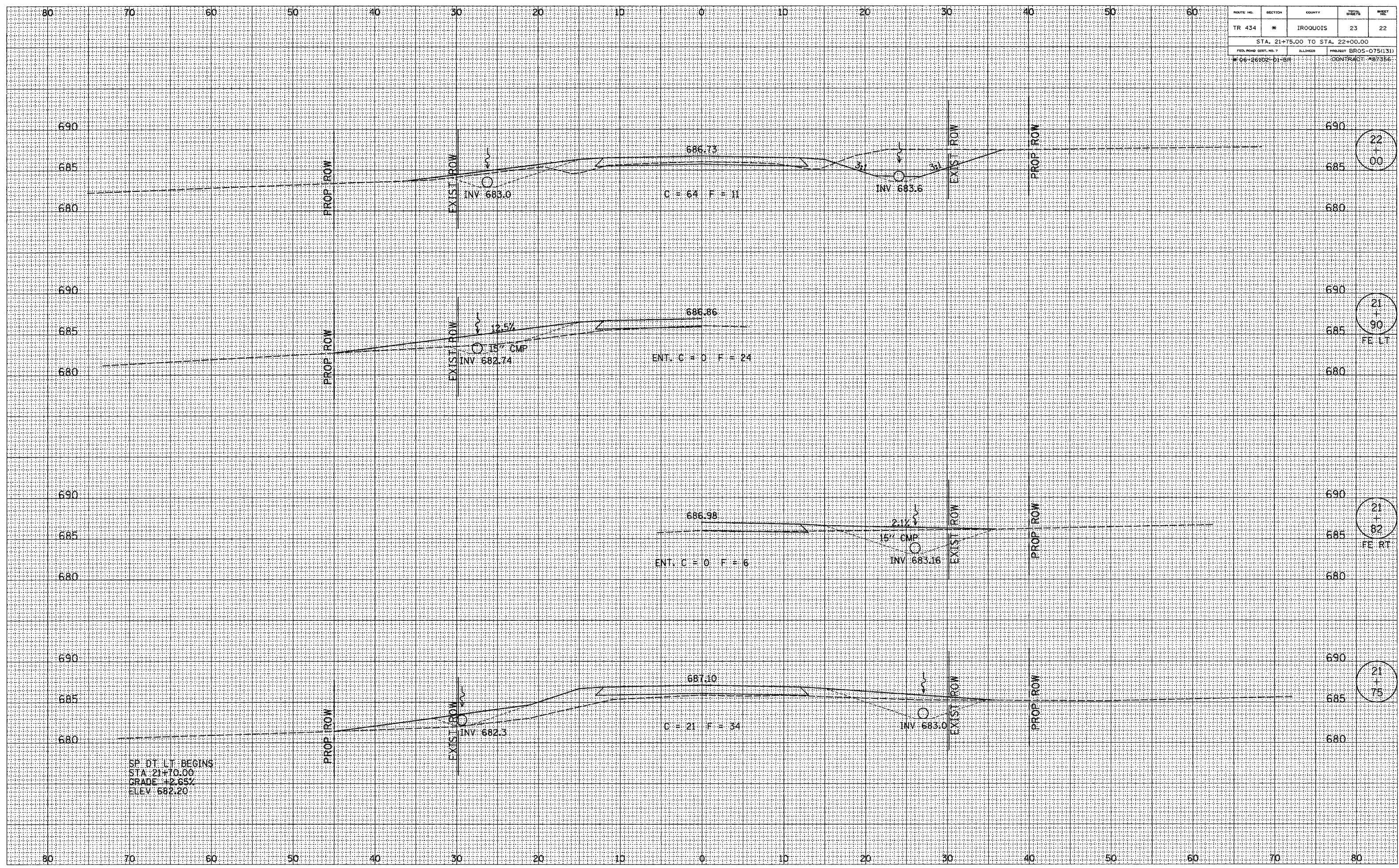

SP. DT. LT. BEGINS
 STA. 21+70.00
 GRADE +2.65%
 ELEV 682.20

22
+
00

21
+
90
FE LT

21
+
82
FE RT

21
+
75