

ROUTE NO.	SECTION	COUNTY	TOTAL SHEETS	SHEET NO.
CH 19	*	MORGAN	8	3
FED. ROAD DIST. NO. 7		BLINDERS	PROJECT	BRS-611(108)
*07-00097-00-BR		CONTRACT *93446		

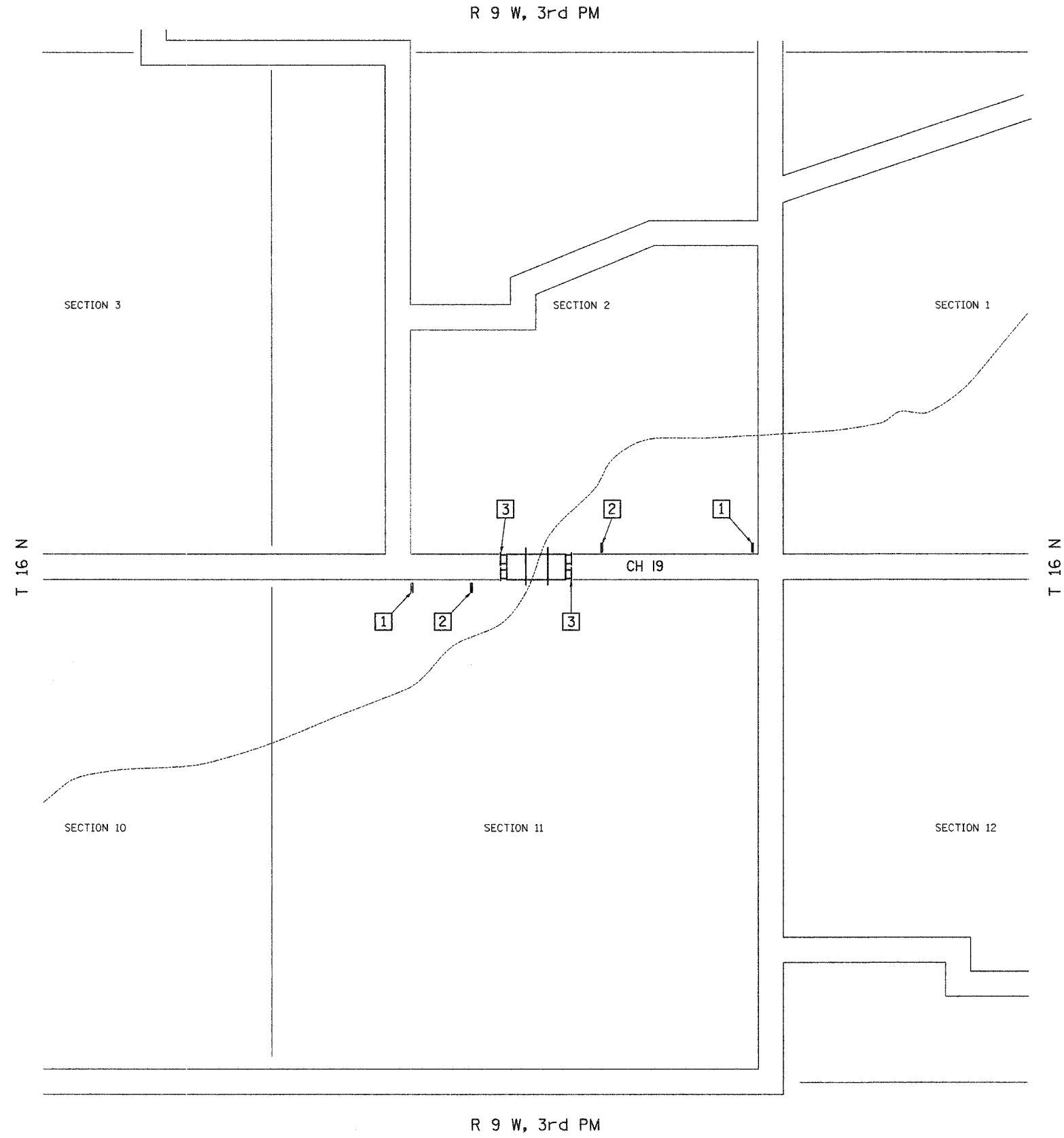

- 1 ROAD CLOSED AHEAD
W20-3
- 2 ROAD CLOSED 500 FT
W20-3
- 3 TYPE III BARRICADES

SEE STANDARD BLR 21 AND SPECIAL PROVISIONS
 R11-3 ADVANCE WARNING SIGNS SHALL BE PLACED AT THE DIRECTION OF THE ENGINEER.

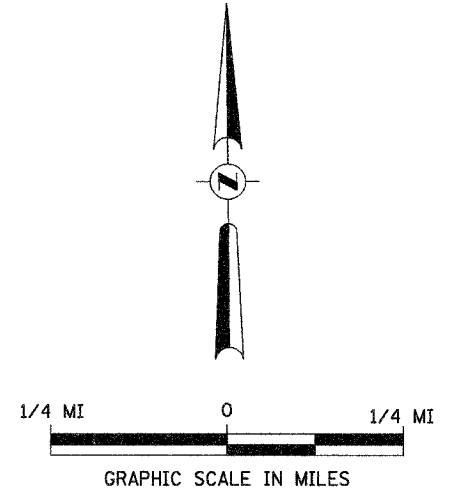

TRAFFIC CONTROL PLAN
 COUNTY HIGHWAY 19 OVER
 LITTLE INDIAN CREEK
 SECTION 07-00097-00-BR
 MORGAN COUNTY
 STATION 113+79.00