

F.A.P. RTE.	SECTION	COUNTY	TOTAL SHEETS	SHEET NO.
B27	12Z-3, 12BR	WABASH, IL GIBSON, IN	158	16
STA.		TO STA.		
FED. ROAD DIST. NO.		ILLINOIS	FED. AID PROJECT	

EMBANKMENT REMOVAL AND RIPRAP PLACEMENT TO BE COORDINATED WITH INDIANA CONTRACTOR
 "DO NOT MOW OR SPRAY SIGNS CONFORMING TO INDIANA STANDARD DRAWING 622-LSSN-04"

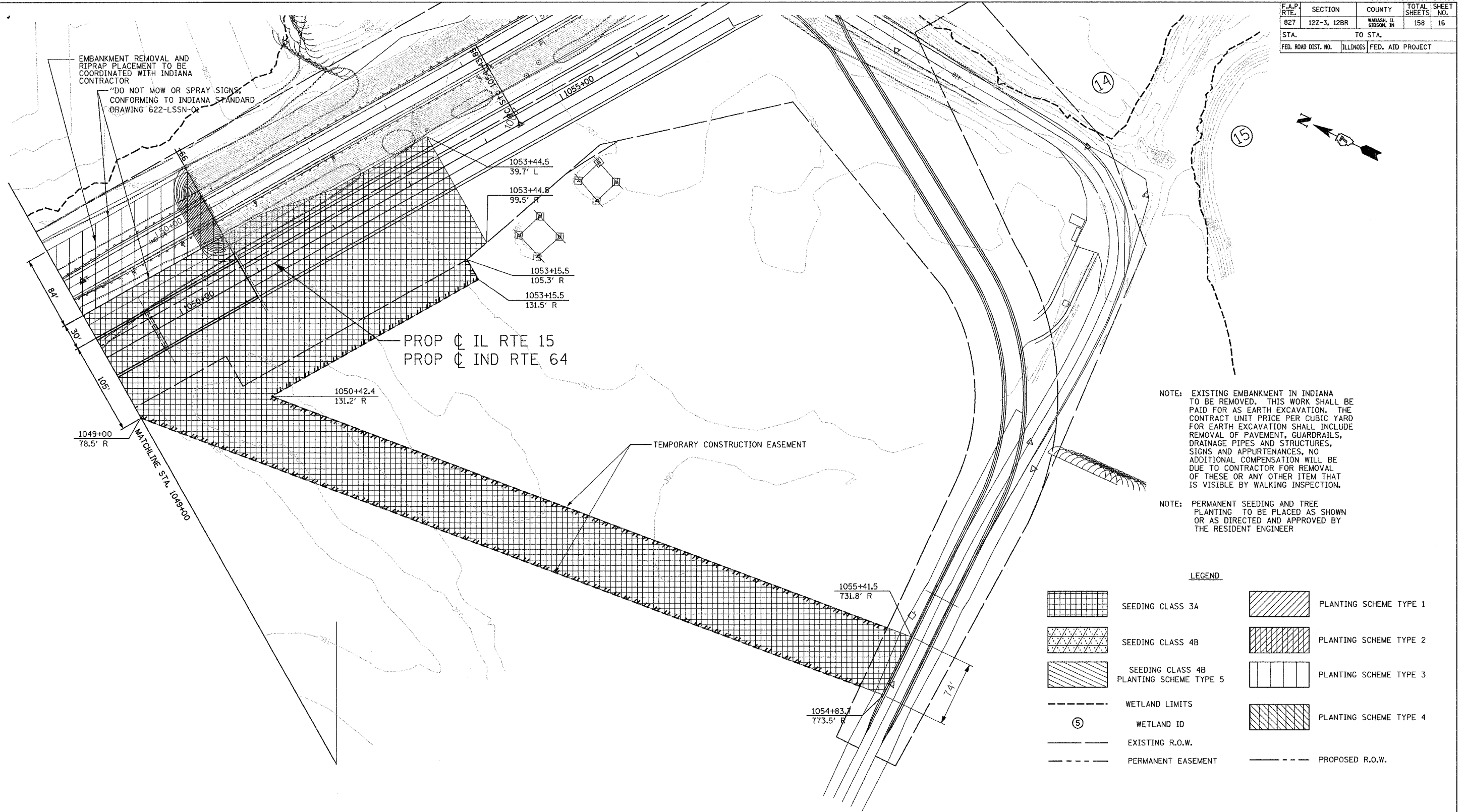

NOTE: EXISTING EMBANKMENT IN INDIANA TO BE REMOVED. THIS WORK SHALL BE PAID FOR AS EARTH EXCAVATION. THE CONTRACT UNIT PRICE PER CUBIC YARD FOR EARTH EXCAVATION SHALL INCLUDE REMOVAL OF PAVEMENT, GUARDRAILS, DRAINAGE PIPES AND STRUCTURES, SIGNS AND APPURTENANCES. NO ADDITIONAL COMPENSATION WILL BE DUE TO CONTRACTOR FOR REMOVAL OF THESE OR ANY OTHER ITEM THAT IS VISIBLE BY WALKING INSPECTION.

NOTE: PERMANENT SEEDING AND TREE PLANTING TO BE PLACED AS SHOWN OR AS DIRECTED AND APPROVED BY THE RESIDENT ENGINEER

LEGEND

	SEEDING CLASS 3A		PLANTING SCHEME TYPE 1
	SEEDING CLASS 4B		PLANTING SCHEME TYPE 2
	SEEDING CLASS 4B		PLANTING SCHEME TYPE 3
	WETLAND LIMITS		PLANTING SCHEME TYPE 4
	WETLAND ID		PROPOSED R.O.W.
	EXISTING R.O.W.		
	PERMANENT EASEMENT		

REVISIONS	
NAME	DATE

ILLINOIS DEPARTMENT OF TRANSPORTATION

GRADING AND LANDSCAPE PLAN

SCALE: VERT. _____
 HORIZ. _____

DATE 06/15/07

DRAWN BY MAC
 CHECKED BY RDC

benesch

alfred benesch & company
 Engineers • Surveyors • Planners
 205 North Michigan Avenue, Suite 2400
 Chicago, Illinois 60601
 312-565-0450
 Job No. 3426