

ROUTE No.	SECTION	COUNTY	TOTAL SHEETS	SHEET NO.
F.A.P. 827	12Z-3, 12BR	WABASH, IL GIBSON, IN	158	25
STA.		TO STA.		
F.H.W.A. REGION		ILLINOIS	PROJECT	
BRIDGE SHEET S9 OF S114				CONTRACT NO. 94450

BEAM 1, APPROACH SPAN

Location	Station	Offset	Theoretical Grade Elevation	Elevation Adjusted For Dead Load Deflection
Bk. of Approach Bent	1021+66.33	-18.750	418.191	418.191
⊕ Brg. ⊕ Approach Bent	1021+67.58	-18.750	418.217	418.217
A	1021+77.58	-18.750	418.398	418.409
B	1021+87.58	-18.750	418.536	418.554
C	1021+97.58	-18.750	418.656	418.669
⊕ Brg. ⊕ West Abut. (Appr. Span)	1022+08.91	-18.750	418.792	418.792

BEAM 5, APPROACH SPAN

Location	Station	Offset	Theoretical Grade Elevation	Elevation Adjusted For Dead Load Deflection
Bk. of Approach Bent	1021+66.33	11.250	418.839	418.839
⊕ Brg. ⊕ Approach Bent	1021+67.58	11.250	418.848	418.848
A	1021+77.58	11.250	418.917	418.929
B	1021+87.58	11.250	418.987	419.005
C	1021+97.58	11.250	419.057	419.070
⊕ Brg. ⊕ West Abut. (Appr. Span)	1022+08.91	11.250	419.135	419.135

BEAM 2, APPROACH SPAN

Location	Station	Offset	Theoretical Grade Elevation	Elevation Adjusted For Dead Load Deflection
Bk. of Approach Bent	1021+66.33	-11.250	418.353	418.353
⊕ Brg. ⊕ Approach Bent	1021+67.58	-11.250	418.374	418.374
A	1021+77.58	-11.250	418.545	418.557
B	1021+87.58	-11.250	418.682	418.700
C	1021+97.58	-11.250	418.802	418.815
⊕ Brg. ⊕ West Abut. (Appr. Span)	1022+08.91	-11.250	418.938	418.938

BEAM 6, APPROACH SPAN

Location	Station	Offset	Theoretical Grade Elevation	Elevation Adjusted For Dead Load Deflection
Bk. of Approach Bent	1021+66.33	18.750	418.720	418.720
⊕ Brg. ⊕ Approach Bent	1021+67.58	18.750	418.728	418.728
A	1021+77.58	18.750	418.795	418.807
B	1021+87.58	18.750	418.861	418.879
C	1021+97.58	18.750	418.927	418.941
⊕ Brg. ⊕ West Abut. (Appr. Span)	1022+08.91	18.750	419.002	419.002

BEAM 3, APPROACH SPAN

Location	Station	Offset	Theoretical Grade Elevation	Elevation Adjusted For Dead Load Deflection
Bk. of Approach Bent	1021+66.33	-3.750	418.515	418.515
⊕ Brg. ⊕ Approach Bent	1021+67.58	-3.750	418.532	418.532
A	1021+77.58	-3.750	418.669	418.681
B	1021+87.58	-3.750	418.795	418.812
C	1021+97.58	-3.750	418.915	418.928
⊕ Brg. ⊕ West Abut. (Appr. Span)	1022+08.91	-3.750	419.051	419.051

⊕ PROP. IL. RTE. 15/IN. RTE. 64 & P.G.

Location	Station	Offset	Theoretical Grade Elevation	Elevation Adjusted For Dead Load Deflection
Bk. of Approach Bent	1021+66.33	0.000	418.596	418.596
⊕ Brg. ⊕ Approach Bent	1021+67.58	0.000	418.611	418.611
A	1021+77.58	0.000	418.731	418.743
B	1021+87.58	0.000	418.851	418.869
C	1021+97.58	0.000	418.971	418.984
⊕ Brg. ⊕ West Abut. (Appr. Span)	1022+08.91	0.000	419.107	419.107

BEAM 4, APPROACH SPAN

Location	Station	Offset	Theoretical Grade Elevation	Elevation Adjusted For Dead Load Deflection
Bk. of Approach Bent	1021+66.33	3.750	418.677	418.677
⊕ Brg. ⊕ Approach Bent	1021+67.58	3.750	418.690	418.690
A	1021+77.58	3.750	418.793	418.805
B	1021+87.58	3.750	418.896	418.914
C	1021+97.58	3.750	419.000	419.013
⊕ Brg. ⊕ West Abut. (Appr. Span)	1022+08.91	3.750	419.116	419.116

DESIGNED	ADD
CHECKED	KWS
DRAWN	VH
CHECKED	ADD

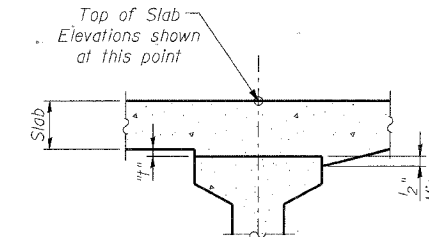

To determine "t": After all precast prestressed beams have been erected, elevations of the top flanges of the beams shall be taken at intervals shown in the tables. These elevations subtracted from the "Theoretical Grade Elevations Adjusted for Dead Load Deflections" minus slab thickness, equals the fillet heights "t" above top flanges of beams.

FILLET HEIGHTS - 36" P.P.C. I-BEAM

(Fascia Girder Shown)

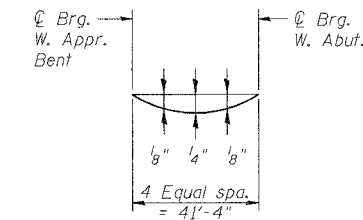

Approach Span

DEAD LOAD DEFLECTION DIAGRAM

APPROACH SPAN

(Includes weight of concrete, excluding beams).

Note:

The above deflections are not for use in the field if the Engineer is working from the Theoretical Grade Elevations Adjusted for Dead Load Deflections.

ILLINOIS DEPARTMENT OF TRANSPORTATION
IL ROUTE 15/IN ROUTE 64
OVER WABASH RIVER PUBLIC WATERS
FAP 827 SECT 12Z-3, 12BR

**DECK ELEVATIONS
APPROACH SLAB**

SN: 093-0021 (IL)/9502700 (IN) STA. 1036+27
WABASH CO., IL. DATE: JUNE 15, 2007

benesch

alfred benesch & company
Engineers • Surveyors • Planners
205 North Michigan Avenue, Suite 2400
Chicago, Illinois 60601
312-565-0450
Job No. 3426

m:\proj\3426\stage_2\structures\design\super\ske\003.dgn

12:59:00 PM

6/26/2007