

F.A. RTE.	SECTION	COUNTY	TOTAL SHEETS	SHEET NO.
8899 03-00026-00-RP		MADISON	107	35
FED. ROAD DIST. NO.	ILLINOIS	FED. AID PROJECT		

CONTRACT NO. 97295



FINAL SURVEY PLOTTED	BY	DATE
NO. _____		
NOTE BOOK TEMPLATE AREAS CHECKED		

ORIGINAL SURVEY PLOTTED	BY	DATE
NO. _____		
NOTE BOOK TEMPLATE AREAS CHECKED		

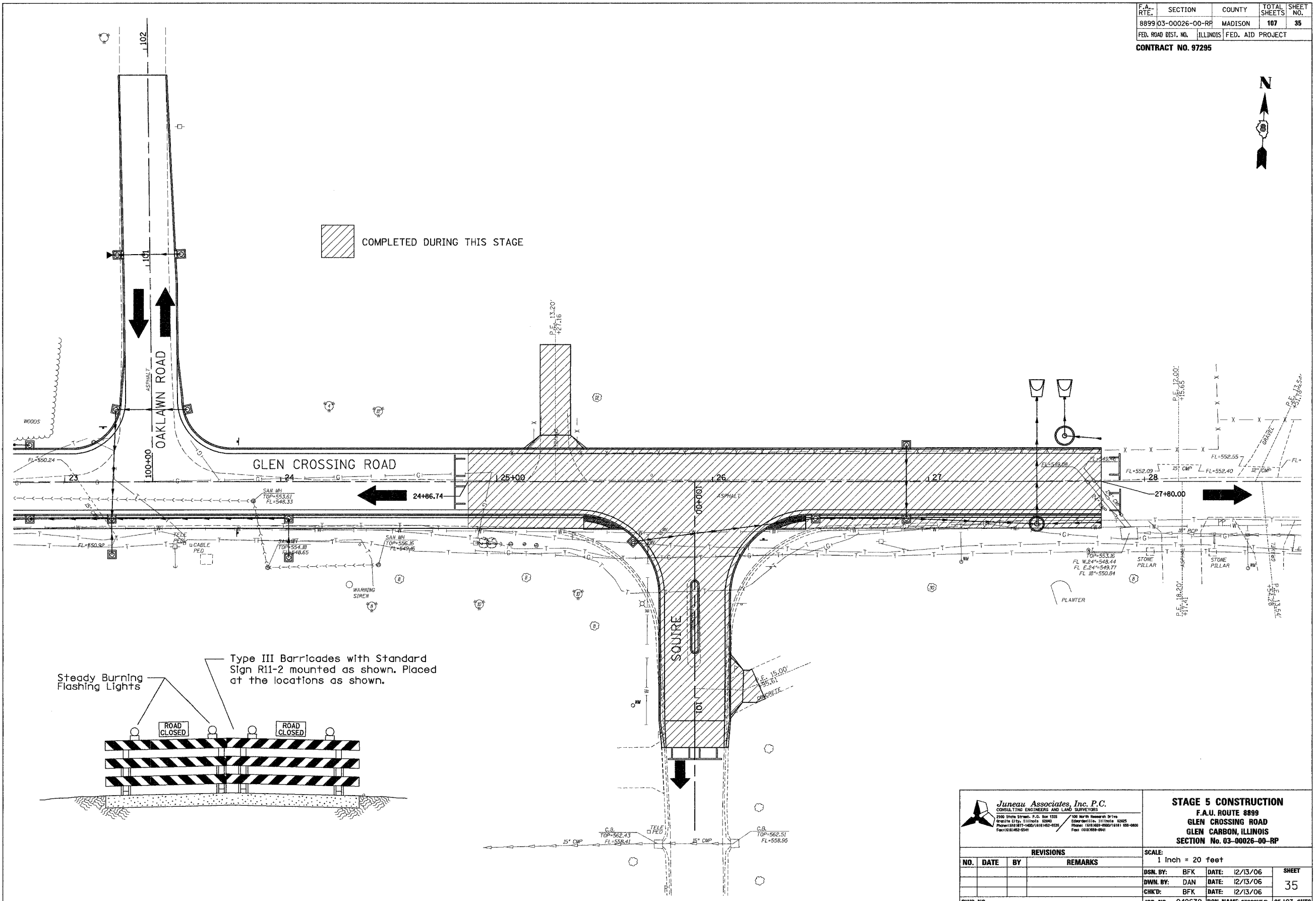

Steady Burning Flashing Lights

Type III Barricades with Standard Sign R11-2 mounted as shown. Placed at the locations as shown.

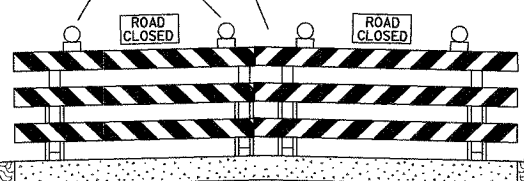

<p>Juneau Associates, Inc. P.C. CONSULTING ENGINEERS AND LAND SURVEYORS 2500 Stone Street, P.O. Box 1332 Greenville, Illinois 62302 Phone: (618) 871-4200 / (618) 862-9531 Fax: (618) 862-5241</p>		<p>STAGE 5 CONSTRUCTION F.A.U. ROUTE 8899 GLEN CROSSING ROAD GLEN CARBON, ILLINOIS SECTION No. 03-00026-00-RP</p>	
<p>SCALE: 1 Inch = 20 feet</p>		<p>DSN. BY: BFK DATE: 12/13/06 SHEET</p>	
<p>DWN. BY: DAN DATE: 12/13/06</p>		<p>CHKD: BFK DATE: 12/13/06</p>	
<p>DWG. NO. _____</p>		<p>JOB NO. 040630 DGN. NAME: STGCONTR5 OF 107 SHTS</p>	

REVISIONS			
NO.	DATE	BY	REMARKS