

F.A. RTE.	SECTION	COUNTY	TOTAL SHEETS	SHEET NO.
8899 03-00026-00-RP		MADISON	107	37
FED. ROAD DIST. NO.	ILLINOIS	FED. AID PROJECT		
CONTRACT NO. 97295				

DATE	BY
FINAL SURVEY PLOTTED	
NOTE BOOK TEMPLATE	
AREAS CHECKED	
NO.	

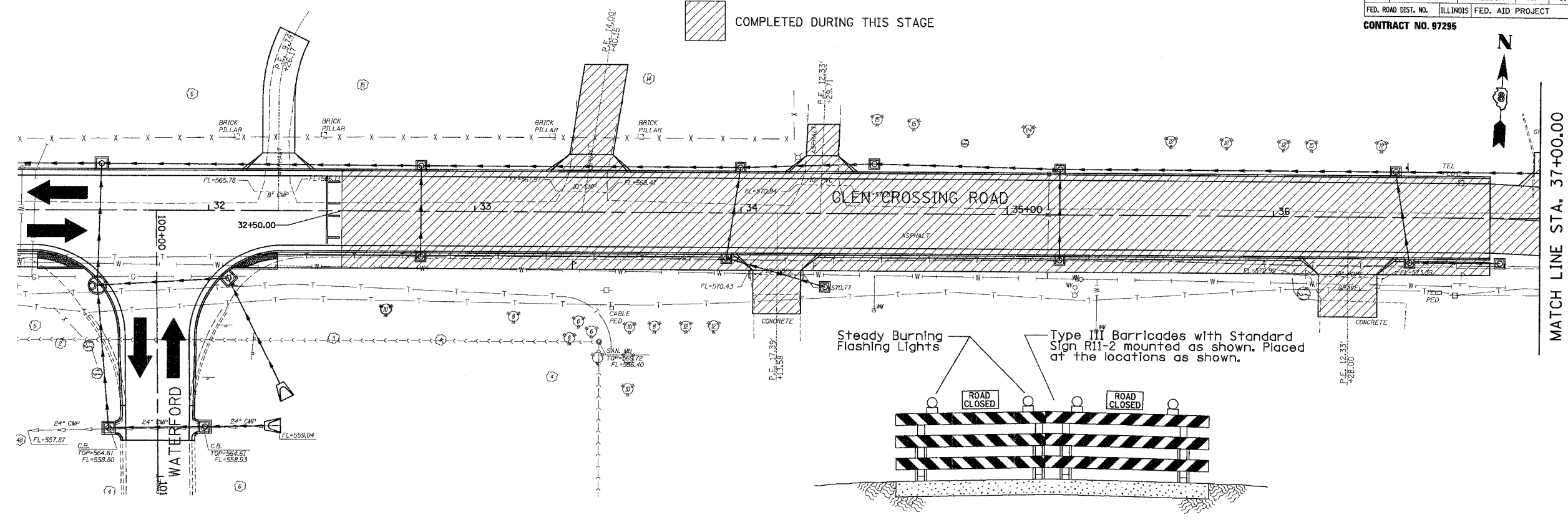

DATE	BY
ORIGINAL SURVEY PLOTTED	
NOTE BOOK TEMPLATE	
AREAS CHECKED	
NO.	

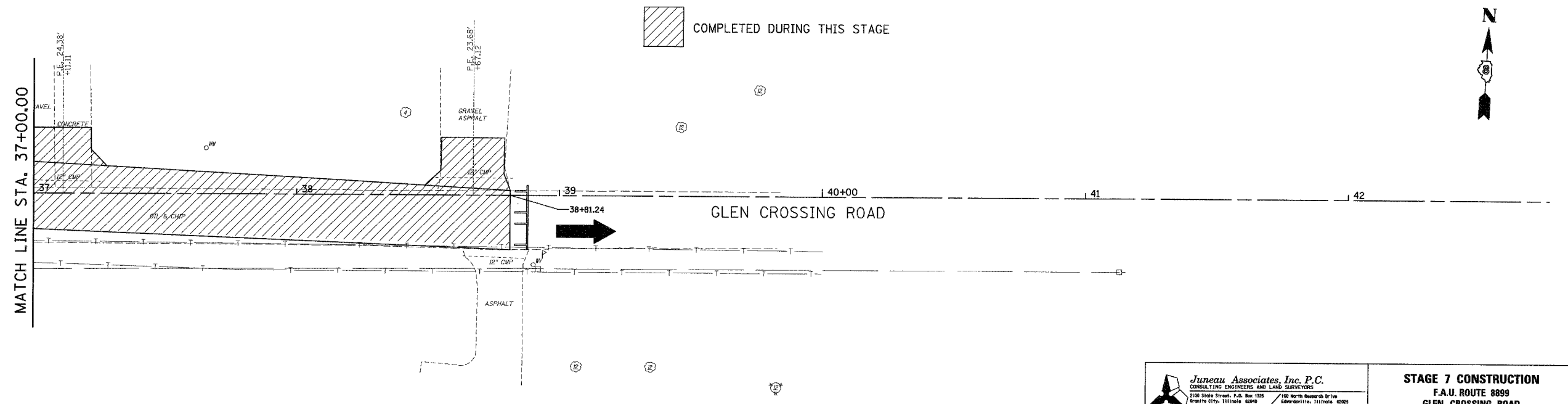

Juneau Associates, Inc. P.C.
CONSULTING ENGINEERS AND LAND SURVEYORS
2100 State Street, P.O. Box 1325
Moline, IL 61701-1325
Phone: (314) 687-4400 / (314) 687-2025
Fax: (314) 687-0941

STAGE 7 CONSTRUCTION
F.A.U. ROUTE 8899
GLEN CROSSING ROAD
GLEN CARBON, ILLINOIS
SECTION No. 03-00026-00-RP

SCALE: 1 Inch = 20 feet		SHEET 37
DSN. BY: BFK	DATE: 12/13/06	
DWN. BY: DAN	DATE: 12/13/06	37
CHKD: BFK	DATE: 12/13/06	
DWG. NO.	JOB NO. 040630	DGN. NAME: STGCNTS