

F.A. RTE.	SECTION	COUNTY	TOTAL SHEETS	SHEET NO.
8899	03-00026-00-RP	MADISON	107	54
FED. ROAD DIST. NO.	ILLINOIS	FED. AID PROJECT		

CONTRACT NO. 97295

H-31  
 INLET, SP, TY 2  
 STA. 37+50.00 LT.  
 TP=575.68  
 F.L.=570.30

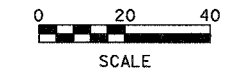

DATE	BY

DATE	BY

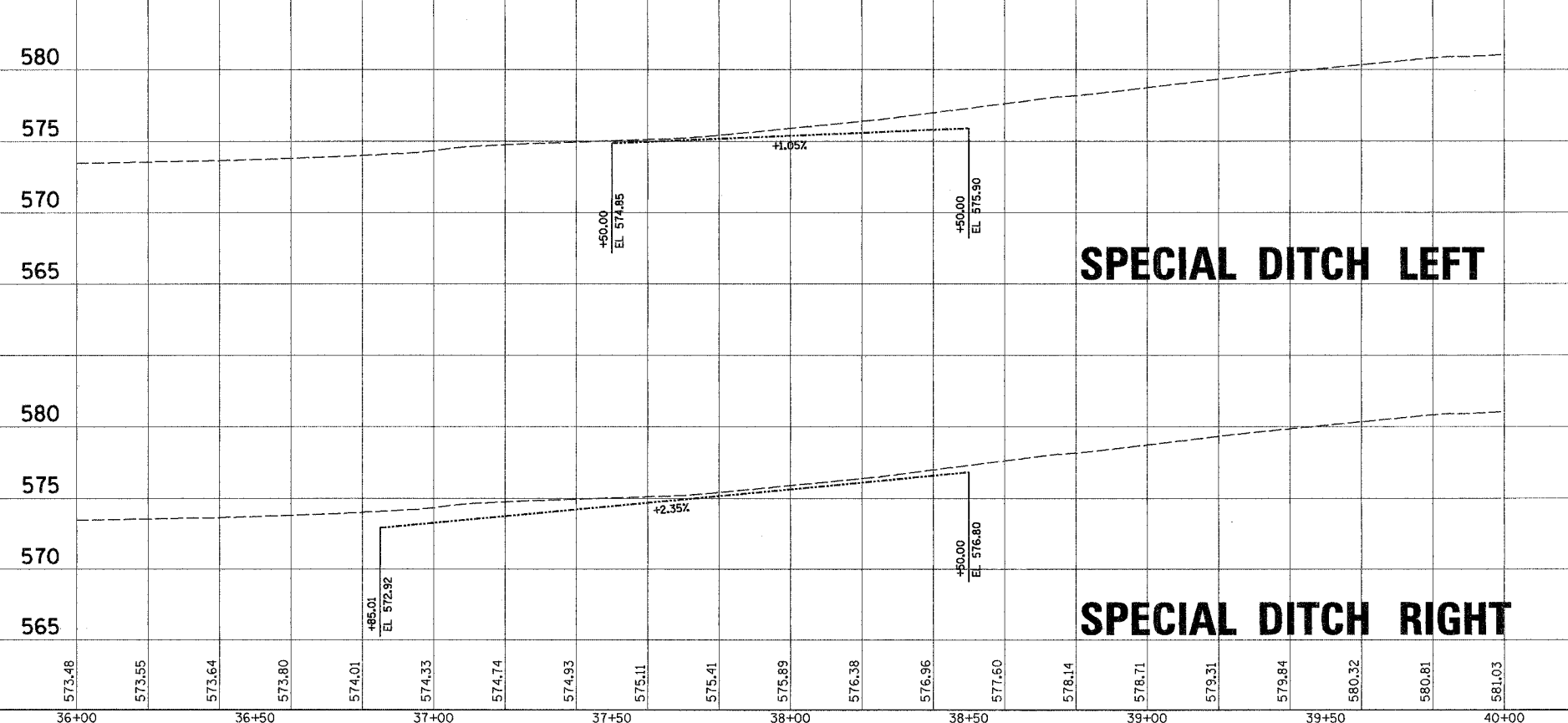
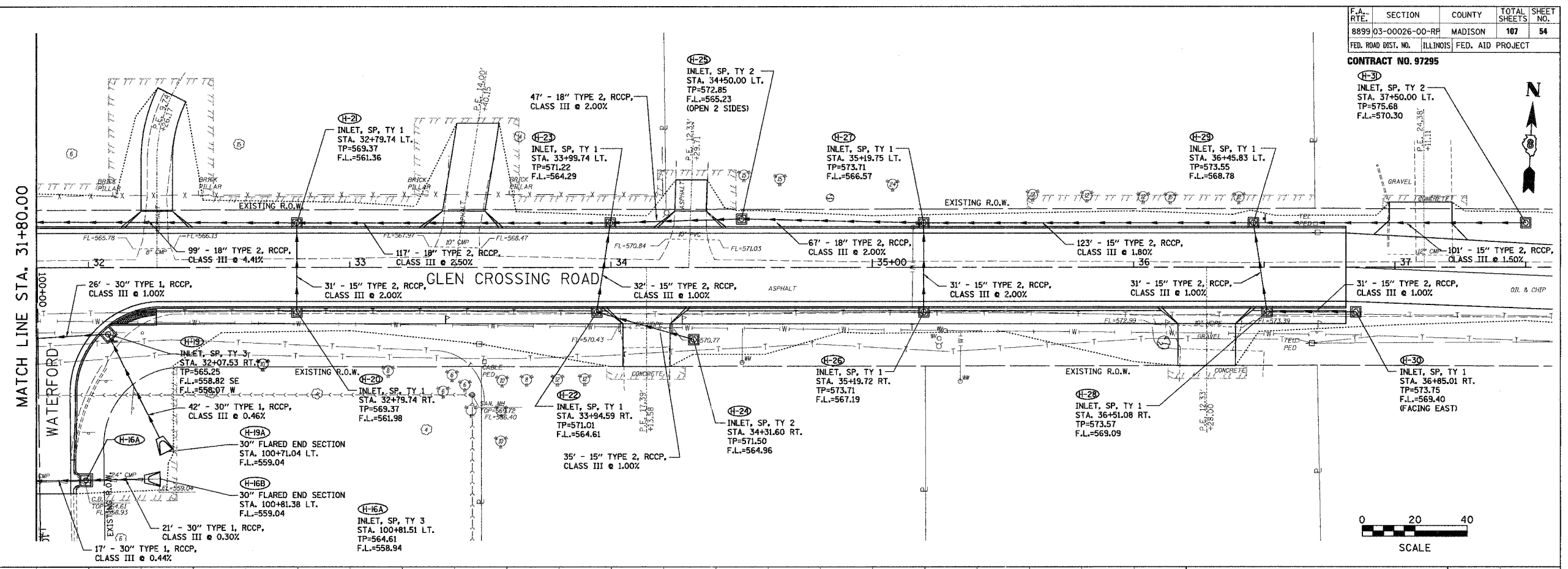

TBM: "M" IN MUELLER ON FIRE HYDRANT NEAR N.E. PROP. CORNER @ \* 750 GLEN CROSSING ROAD ELEV. 575.47

**Jureau Associates, Inc. P.C.**  
 CONSULTING ENGINEERS AND LAND SURVEYORS  
 2100 State Street, P.O. Box 1328  
 North Chicago, Illinois 60064  
 Phone: (847) 940-1400/940-4939  
 Fax: (847) 940-0941

**DRAINAGE PLAN**  
 F.A.U. ROUTE 8899  
 GLEN CROSSING ROAD  
 GLEN CARBON, ILLINOIS  
 SECTION No. 03-00026-00-RP

REVISIONS				
NO.	DATE	BY	REVISIONS	REMARKS

SCALE: 1 Inch = 20 feet	
DGN. BY: BFK	DATE: 12/13/06
DWN. BY: JJB	DATE: 12/13/06
CHKD: BFK	DATE: 12/13/06
JOB NO. 040630	DGN. NAME: DRAINS
	OF 107 SHTS

SHEET  
54