

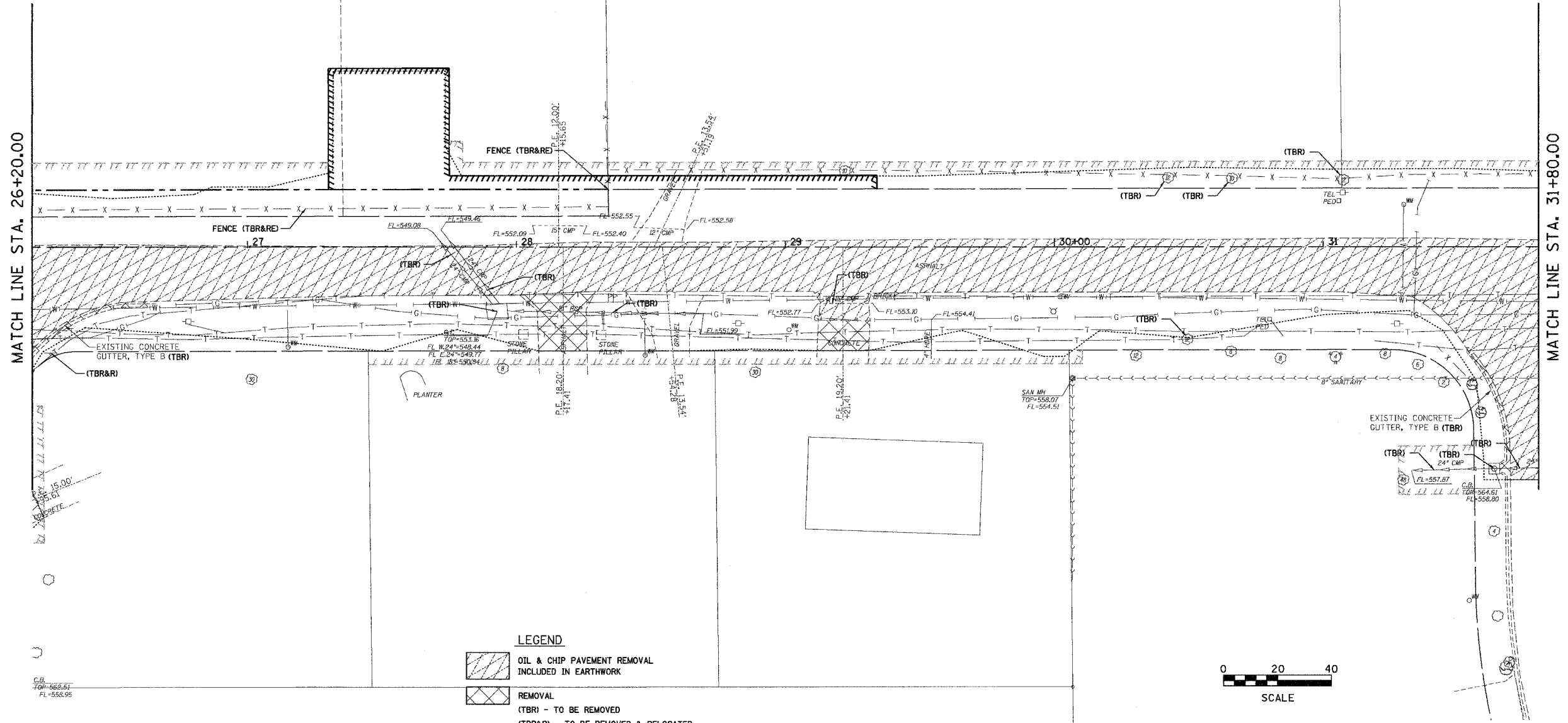

FINAL SURVEY	BY	DATE
NO. _____		
SURVEYED		
PLOTTED		
NOTE BOOK		
TEMPERATURE		
AREAS CHECKED		
NO. _____		

ORIGINAL SURVEY	BY	DATE
NO. _____		
SURVEYED		
PLOTTED		
NOTE BOOK		
TEMPERATURE		
AREAS CHECKED		
NO. _____		



- LEGEND**
- OIL & CHIP PAVEMENT REMOVAL INCLUDED IN EARTHWORK
 - REMOVAL
 - (TBR) - TO BE REMOVED
 - (TBR&R) - TO BE REMOVED & RELOCATED
 - (TBR&E) - TO BE REMOVED & REERECTED
 - (TBRBO) - TO BE REMOVED BY OTHERS
 - (TBR&RBO) - TO BE REMOVED & RELOCATED BY OTHERS
 - (TBA) - TO BE ADJUSTED

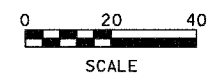

Juneau Associates, Inc. P.C. CONSULTING ENGINEERS AND LAND SURVEYORS <small>2300 Stone Street, P.O. Box 1205 / 100 North Goodrich Street Granite City, Illinois 62040 / Edwardsville, Illinois 62025 Phone: (618) 677-7400 / (618) 482-0339 / Fax: (618) 682-0541 / (618) 399-0541</small>	REMOVAL F.A.U. ROUTE 8899 GLEN CROSSING ROAD GLEN CARBON, ILLINOIS SECTION No. 03-00026-00-RP		
	SCALE: 1 inch = 20 feet		
REVISIONS			
NO.	DATE	BY	REMARKS
DSN. BY: BFK DATE: 12/13/06		SHEET	
DWN. BY: DAN DATE: 12/13/06		65	
CHK'D: BFK DATE: 12/13/06		OF 107 SHTS	
DWG. NO.		JOB NO. 040630 DGN. NAME: RSM4	