

F.A.U. RT.	SECTION	COUNTY	TOTAL SHEETS	SHEET NO.
8899	03-00026-00-RP	MADISON	107	86
FED. ROAD DIST. NO. - ILLINOIS		FED. AID PROJECT		
CONTRACT NO. 97295				

570
565
560
555
550

570
565
560
555
550

C = 140
F = 1

21 + 00.00

570
565
560
555

570
565
560
555

P.E. LEFT

20 + 73.11

570
565
560
555
550

570
565
560
555
550

C = 90
F = 0

20 + 50.00

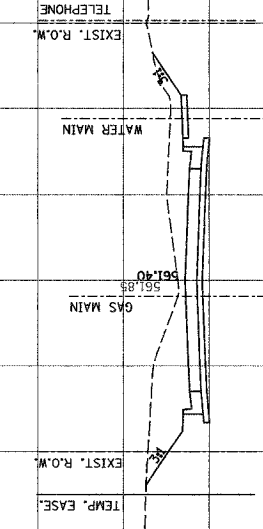
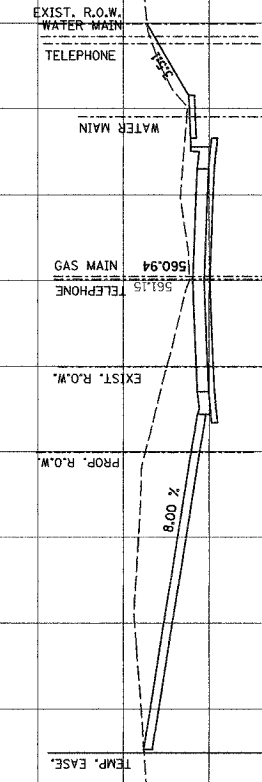
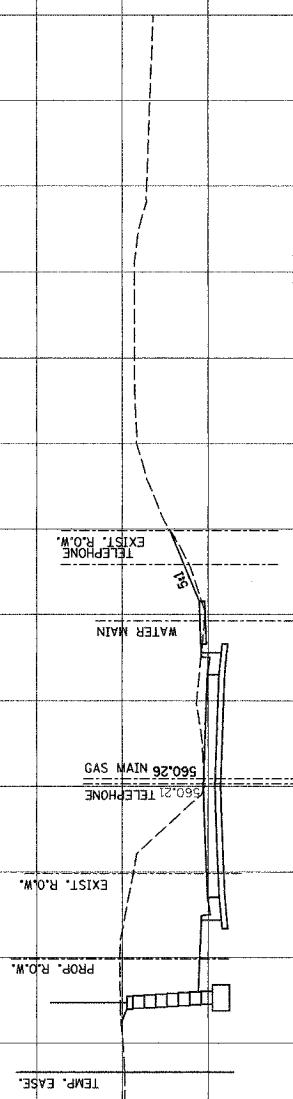

NO.	DATE	BY	REVISIONS	REMARKS

Juneau Associates, Inc. P.C.
CONSULTING ENGINEERS AND LAND SURVEYORS
1001 N. STATE ST., SUITE 200
SPRINGFIELD, ILLINOIS 62761
PHONE: (618) 233-8888
FAX: (618) 233-8889

CLIENT/PROJECT: GLEN CROSSING ROAD IMPROVEMENT
SECTION No. 03-00026-00-RP

GLEN CROSSING ROAD CROSS SECTIONS

DESIGN BY	SAS
DRAWN BY	SAS
CHECKED BY	BRK
JOB NO.	EM-00030
DATE	12/12/06
SCALE:	HORIZ. 1 inch = 10 feet VERT. 1 inch = 5 feet
SHEET No.	86
OF	107 SHEETS