

F.A.L. RTE.	SECTION	COUNTY	TOTAL SHEETS	SHEET NO.
8899 03-00026-00-RP		MADISON	107	92
FED. ROAD DIST. NO.	ILLINOIS FED. AID PROJECT			
CONTRACT NO. 97295				

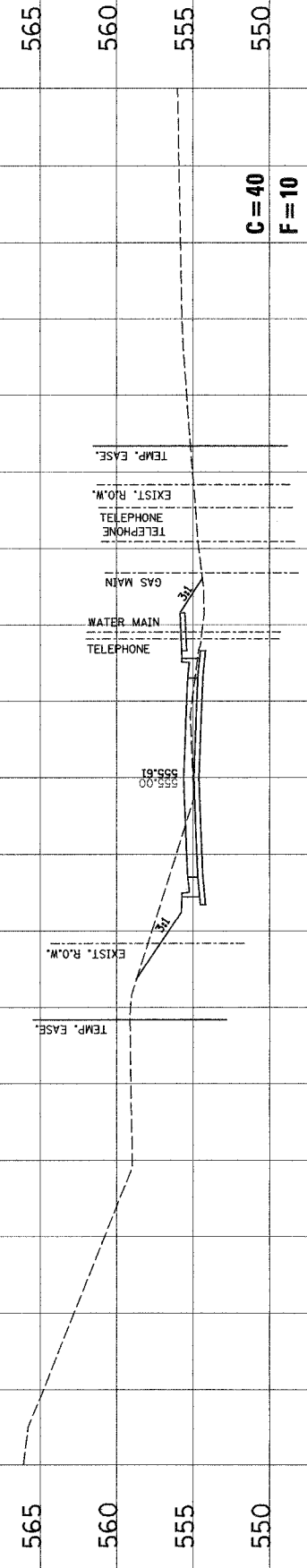

**29 + 50.00**

**C = 40  
F = 10**

**P.E. RIGHT**

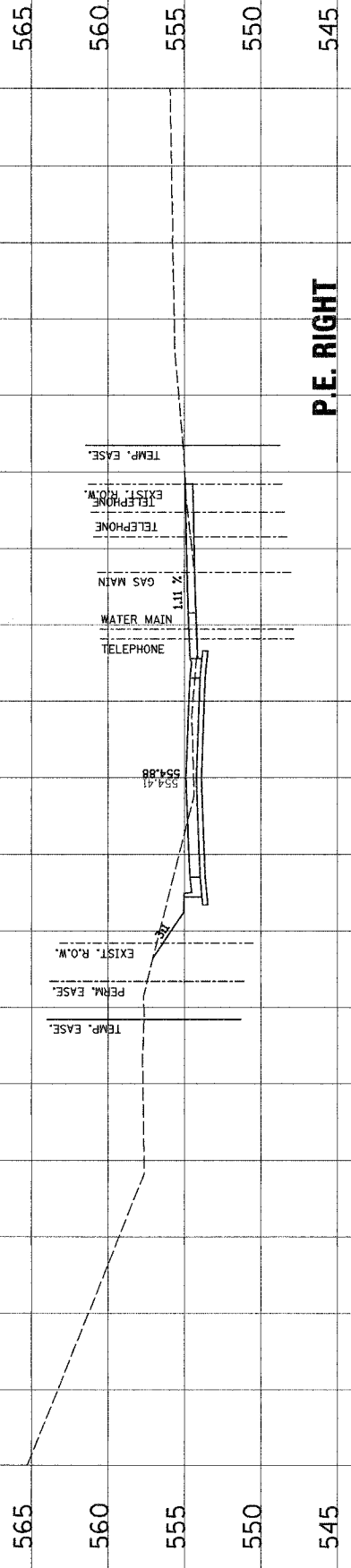

**29 + 21.41**

**C = 34  
F = 6**

**P.E. LEFT**

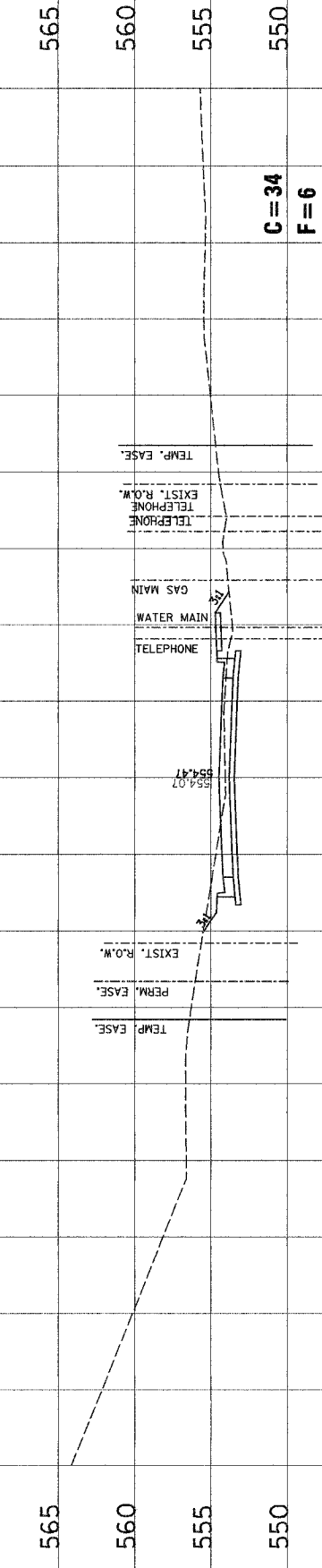

**29 + 00.00**

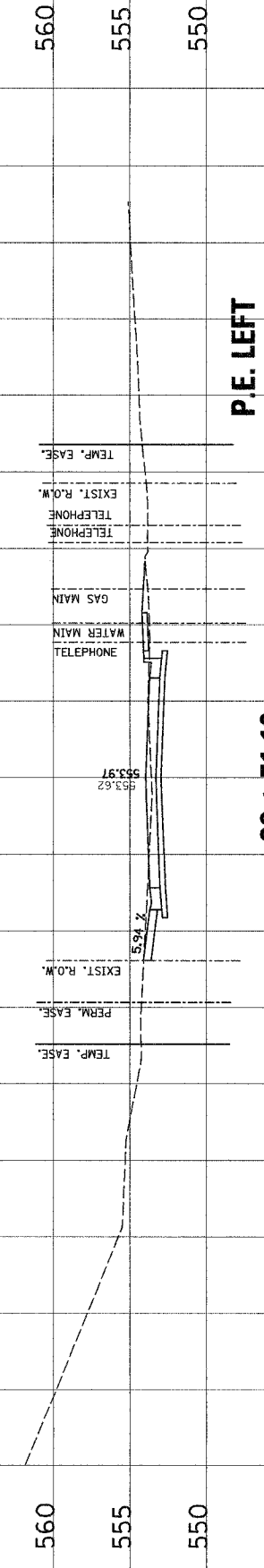

**28 + 51.19**

NO.	DATE	BY	REVISIONS	REMARKS

**Juneau Associates, Inc. P.C.**  
 1000 N. W. 10th St., Suite 200  
 Ft. Lauderdale, FL 33304  
 Phone: (954) 561-1100  
 Fax: (954) 561-1101  
 For 10/18/06-04/07

**CLIENT/PROJECT :**  
 GLEN CROSSING ROAD IMPROVEMENT  
 SECTION No. 03-00026-00-RP

**GLEN CROSSING ROAD  
CROSS SECTIONS**

DES. BY: SAS
CHK. BY: SAS
APP. BY: HFX
JOB NO. E040930
DATE: 12/02/06
SCALE: HORZ. 1 inch = 10 feet VERT. 1 inch = 5 feet
SHEET No. 92
OF 107 SHEETS