

F.A.U. RTE.	SECTION	COUNTY	TOTAL SHEETS	SHEET NO.
8899	D3-00026-00-RP	MADISON	107	97
FED. ROAD DIST. NO.	ILLINOIS		FED. AID PROJECT	
CONTRACT NO. 87285				

580
575
570

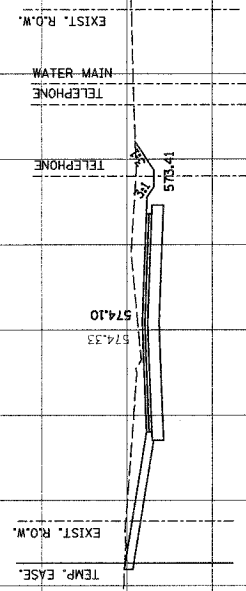

C=62
F=0

37 + 00.00

580
575
570

580
575
570

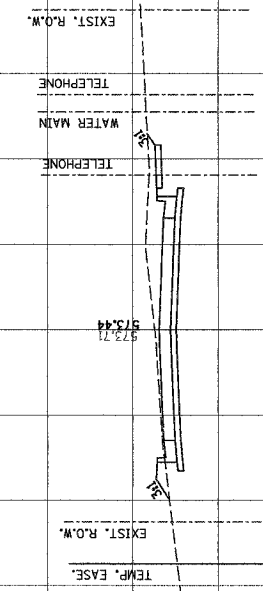

C=51
F=10

36 + 50.00

580
575
570

580
575
570
565

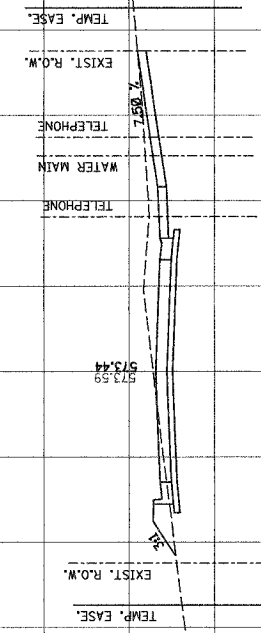

P.E. RIGHT

36 + 28.00

580
575
570
565

580
575
570
565

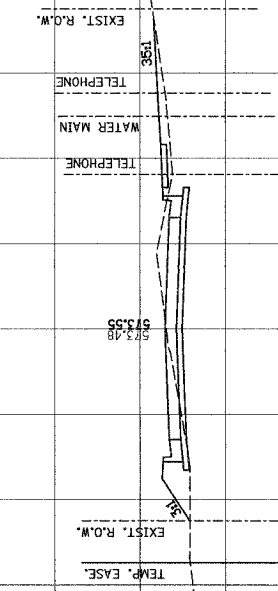

C=28
F=13

36 + 00.00

580
575
570
565

NO.	DATE	BY	REVISIONS	REMARKS

Januzzi Associates, Inc. P.C.
 100 South Street, P.O. Box 1303
 Springfield, Illinois 62766-1303
 Phone: (217) 244-8800
 Fax: (217) 244-0911

CLIENT/PROJECT :
GLEN CROSSING ROAD IMPROVEMENT
 SECTION No. 03-00026-00-RP

GLEN CROSSING ROAD CROSS SECTIONS

DESIGNED BY: SAS
 DRAWN BY: SAS
 CHECKED BY: BFK
 JOB NO. E040630
 DATE: 12/12/06
 SCALE: HORZ. 1 inch = 10 feet
 VERT. 1 inch = 5 feet
 SHEET No.

97