

T.R.	SECTION	COUNTY	TOTAL SHEETS	SHEET NO.
228	06-12122-00-BR	HAMILTON	15	2
323 W. 3RD ST. P.O. BOX 160 MT. CARMEL, IL 62863				
FED. ROAD DIST. NO. 9 ILLINOIS HOGG CREEK				
PROJECT * BR05-065(41) CONTRACT * 99304				
PHONE: (618)-262-8651 FAX: (618)-263-3327				
LEC JOB * H06L02HM				

GENERAL NOTES:

THIS SECTION SHALL BE CONSTRUCTED IN ACCORDANCE WITH THE PLANS, SPECIAL PROVISIONS AND "STANDARD SPECIFICATIONS FOR ROAD AND BRIDGE CONSTRUCTION", ADOPTED JANUARY 1, 2007.

THE WORK INVOLVED ON THIS SECTION CONSISTS OF THE REMOVAL OF THE EXISTING STRUCTURE, THE CONSTRUCTION OF A 115 FOOT LONG TRIPLE SPAN (35', 45', 35') PRECAST, PRESTRESSED CONCRETE DECK BEAM BRIDGE, EARTH APPROACHES, AGGREGATE SURFACE COURSE AND OTHER MISCELLANEOUS ITEMS NECESSARY TO COMPLETE THIS SECTION.

ALL ELEVATIONS ARE BASED ON U.S.G.S. MEAN SEA LEVEL DATUM.

IT SHALL BE THE CONTRACTOR'S RESPONSIBILITY TO CONTACT ALL THE UTILITIES, AFFECTING THE PROJECT, PRIOR TO CONSTRUCTION.

NOTE: CONSTRUCTION TRANSITION
STA. 2+30 TO STA 2+80
STA. 8+83 TO STA 9+33

ALL QUANTITIES ARE INCLUDED IN THE PROPOSAL

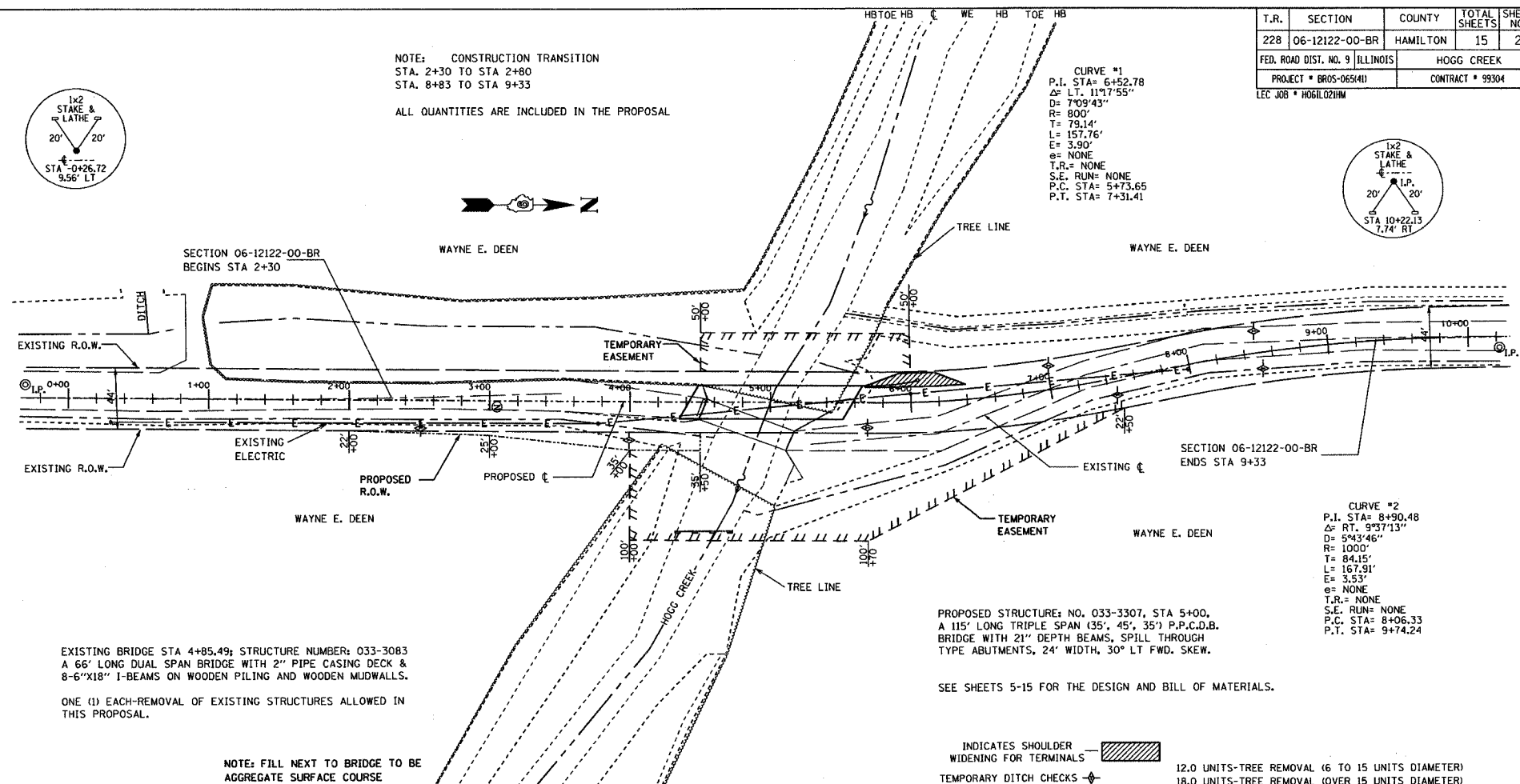
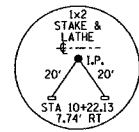
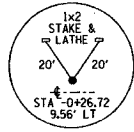

CURVE #1
P.I. STA= 6+52.78
ΔP LT. 117'55"
DE 1°09'43"
R= 800'
T= 79.14'
L= 157.76'
E= 3.90'
e= NONE
T.R.= NONE
S.E. RUN= NONE
P.C. STA= 5+13.65
P.T. STA= 7+31.41

CURVE #2
P.I. STA= 8+90.48
ΔP RT. 9°37'13"
D= 543'46"
R= 1000'
T= 84.15'
L= 167.91'
E= 3.53'
e= NONE
T.R.= NONE
S.E. RUN= NONE
P.C. STA= 8+06.33
P.T. STA= 9+74.24

PROPOSED STRUCTURE: NO. 033-3307, STA 5+00.
A 115' LONG TRIPLE SPAN (35', 45', 35') P.P.C.D.B.
BRIDGE WITH 21" DEPTH BEAMS, SPILL THROUGH
TYPE ABUTMENTS, 24' WIDTH, 30' LT FWD. SKEW.

SEE SHEETS 5-15 FOR THE DESIGN AND BILL OF MATERIALS.

EXISTING BRIDGE STA 4+85.49; STRUCTURE NUMBER: 033-30B3
A 66' LONG DUAL SPAN BRIDGE WITH 2" PIPE CASING DECK &
8-6"x18" I-BEAMS ON WOODEN PILING AND WOODEN MUDWALLS.

ONE (1) EACH-REMOVAL OF EXISTING STRUCTURES ALLOWED IN
THIS PROPOSAL.

NOTE: FILL NEXT TO BRIDGE TO BE
AGGREGATE SURFACE COURSE

INDICATES SHOULDER
WIDENING FOR TERMINALS

TEMPORARY DITCH CHECKS

AGGREGATE (EROSION CONTROL)

12.0 UNITS-TREE REMOVAL (6 TO 15 UNITS DIAMETER)

18.0 UNITS-TREE REMOVAL (OVER 15 UNITS DIAMETER)

0.4 ACRES SEEDING, CLASS 2 SPECIAL REQUIRED

TYPICAL CROSS SECTION
PROPOSED

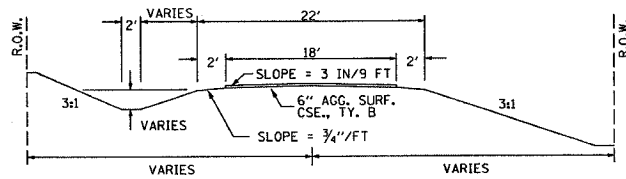

TYPICAL CROSS SECTION
EXISTING

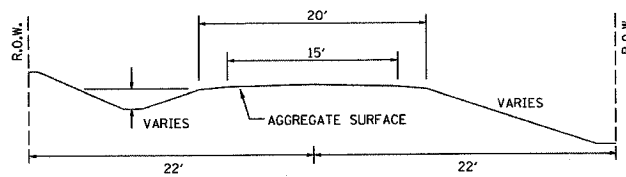

NOTE: CONSTRUCT SPECIAL DITCH

STA 2+30 TO STA 4+30 RT
STA 5+70 TO STA 9+33 RT
STA 6+50 TO STA 9+00 LT

NOTE: CONSTRUCT STONE RIPRAP DITCH

STA 4+05 TO STA 4+30 RT (0.62 TON/LIN FT)
16 TON STONE RIPRAP DITCH ALLOWED IN PROPOSAL.

SEE SHEET NO. 15 FOR STONE RIPRAP DITCH DETAIL.

UTILITIES:
J.U.L.I.E. 1-800-892-0123

SOUTHEASTERN ILLINOIS
ELECTRIC CO-OP
800-833-2611

SCHEDULE FOR SIGNS AND POSTS

STA.	LOC.	MUTCD CODE	STYLE	SIZE	SO. FT.	METAL POST-TYPE A LENGTH
2+48.6	17' RT.	W1-3L	REVERSE TURN	30"x30"	6.25	14.00
12+99.2	17' LT.	W1-3L	REVERSE TURN	30"x30"	6.25	15.00

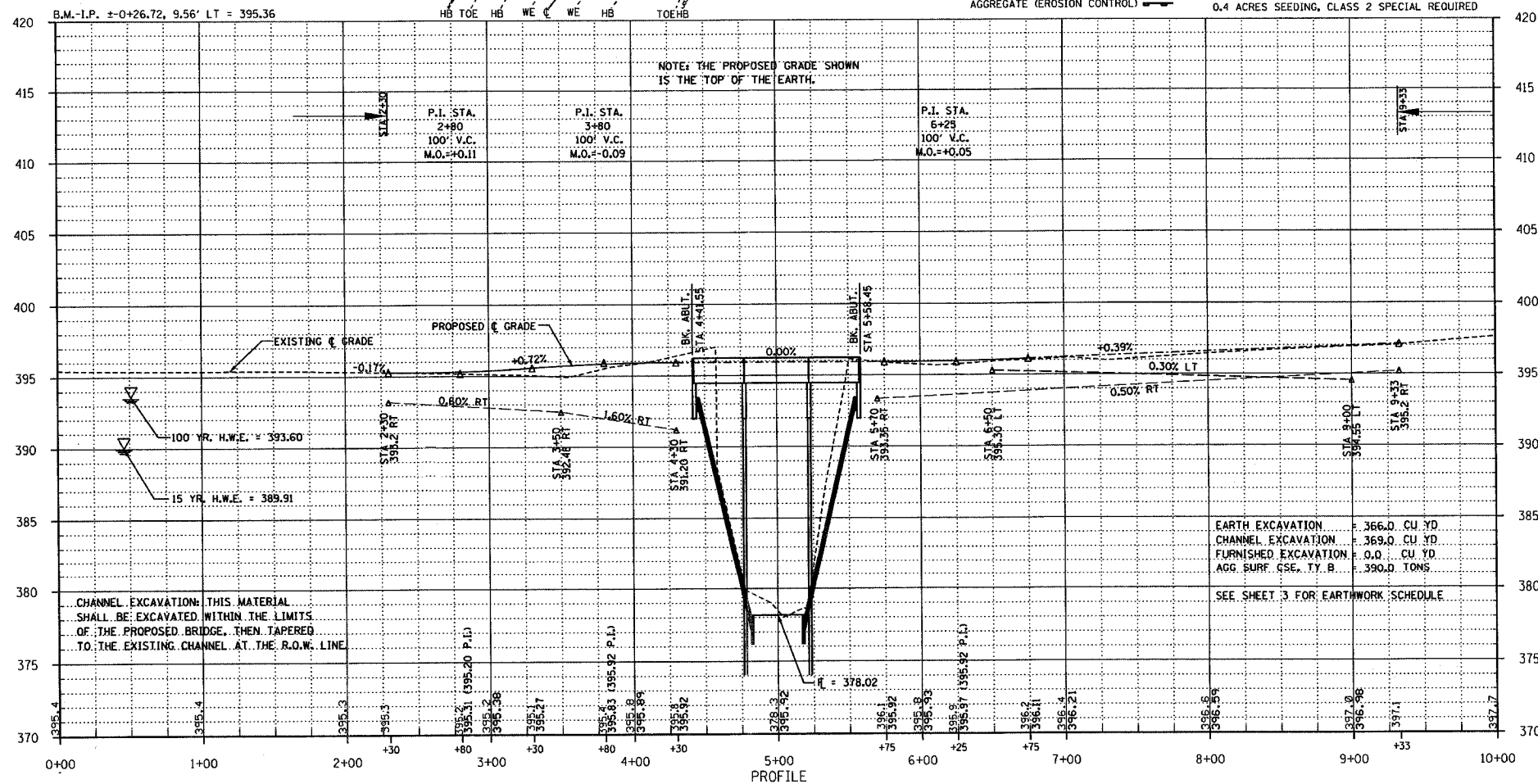

CHANNEL EXCAVATION: THIS MATERIAL SHALL BE EXCAVATED WITHIN THE LIMITS OF THE PROPOSED BRIDGE, THEN TAPERED TO THE EXISTING CHANNEL AT THE R.O.W. LINE.

EARTH EXCAVATION 366.0 CU YD
CHANNEL EXCAVATION 369.0 CU YD
FURNISHED EXCAVATION 0.0 CU YD
AGG. SURF. CSE. TY. B 390.0 TONS
SEE SHEET 3 FOR EARTHWORK SCHEDULE

AARON M. MEFFORD
NAME
SIGNATURE
DATE
11-30-07
EXPIRES

TWIGG TOWNSHIP
OVER HOGG CREEK
HAMILTON COUNTY, ILLINOIS

SHEET TITLE:
PLAN & PROFILE

SCALE: VARIES
BY: AMM
DATE: 8/20/07
REV:

2 OF 15
SHEETS

SHEET NO.
2