

**NOTE 1:**

**RESTORATION NOTES:**

CONTRACTOR SHALL REMOVE AND REPLACE CURB & GUTTER, MEDIAN AND SIDEWALK IN-KIND FOR THE FOLLOWING LIMITS:

CURB & GUTTER LIMITS: STA. 152+88.00± TO STA. 158+58.28 (EAST ONLY)

MEDIAN LIMITS: STA. 154+79.17± TO STA. 158+58.28

SIDEWALK LIMITS: STA. 156+50.00± TO STA. 162+27.06 (EAST ONLY)

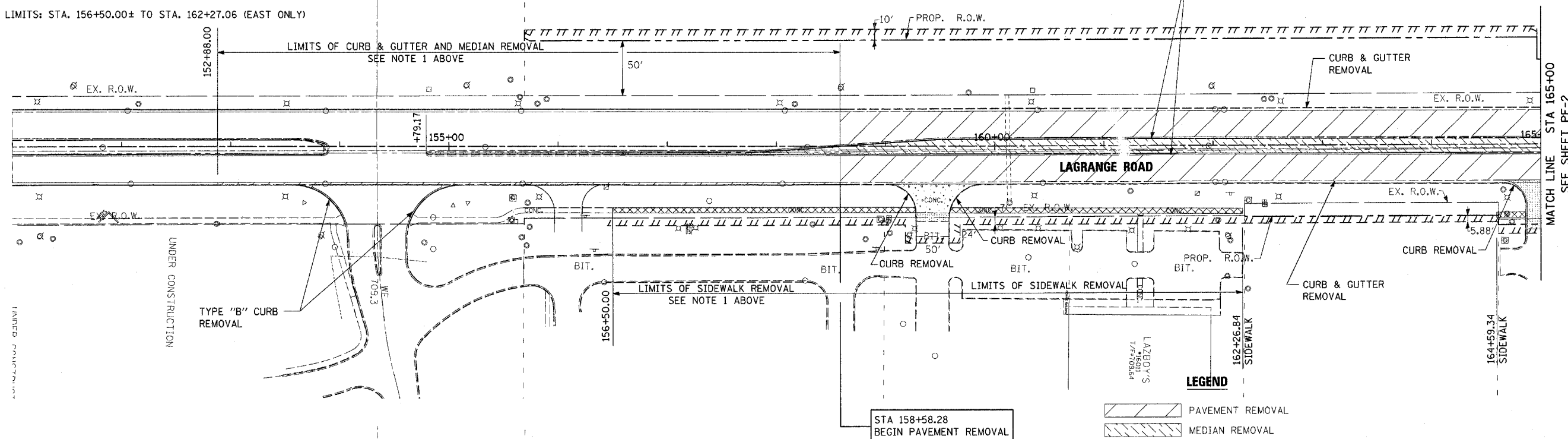

**EXISTING CONDITIONS AND REMOVAL PLAN**

**LEGEND**

- PAVEMENT REMOVAL
- MEDIAN REMOVAL
- SIDEWALK REMOVAL
- CONCRETE DRIVEWAY REMOVAL (PAID AS "DRIVEWAY PAVEMENT REMOVAL")
- BITUMINOUS DRIVEWAY/PARKING REMOVAL (PAID AS "DRIVEWAY PAVEMENT REMOVAL")
- 5" TREE REMOVAL
- TEMPORARY EASEMENT

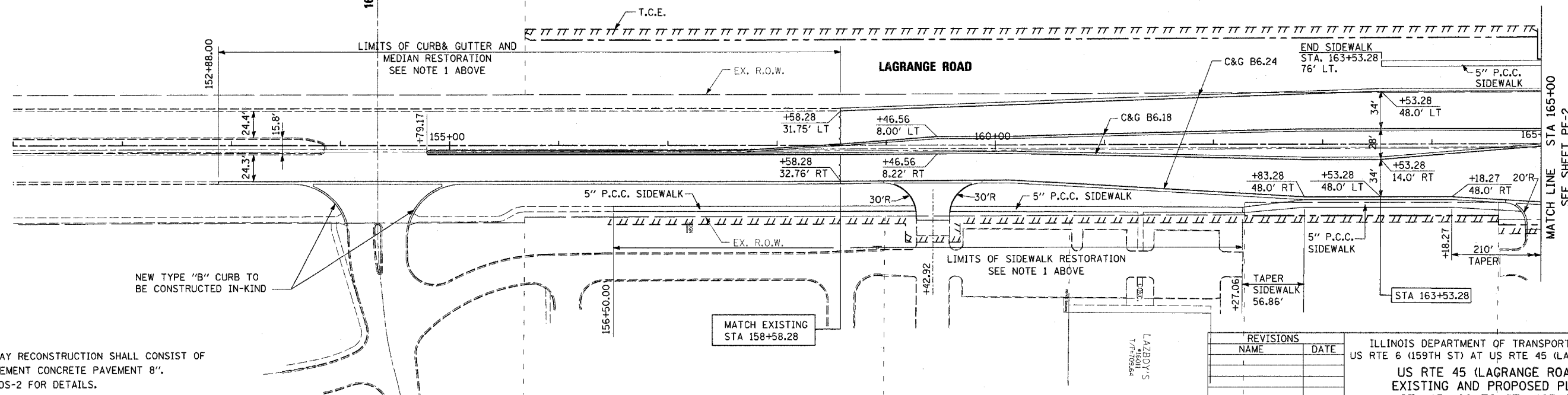

**PROPOSED IMPROVEMENT PLAN**

**NOTE 2:**

1. ALL DRIVEWAY RECONSTRUCTION SHALL CONSIST OF PORTLAND CEMENT CONCRETE PAVEMENT 8". SEE SHEET DS-2 FOR DETAILS.
2. CONTRACTOR SHALL CONSTRUCT HANDICAP ACCESSIBILITY RAMPS AT ALL INTERSECTIONS AND DRIVEWAYS. SEE IDOT STANDARD 424001-03.

REVISIONS	
NAME	DATE

ILLINOIS DEPARTMENT OF TRANSPORTATION  
 US RTE 6 (159TH ST) AT US RTE 45 (LAGRANGE RD)  
 US RTE 45 (LAGRANGE ROAD)  
 EXISTING AND PROPOSED PLAN  
 STA 151+00 TO STA 165+00

SCALE: 1"=50'  
 DATE: 7-07-06  
 DRAWN BY: JTF  
 CHECKED BY: RCH

**McDonough Associates Inc.**  
 Engineers / Architects

E:\Dgn\p101001.sht  
 7/31/2006  
 12:06:53 PM