

CONTRACT # 62880

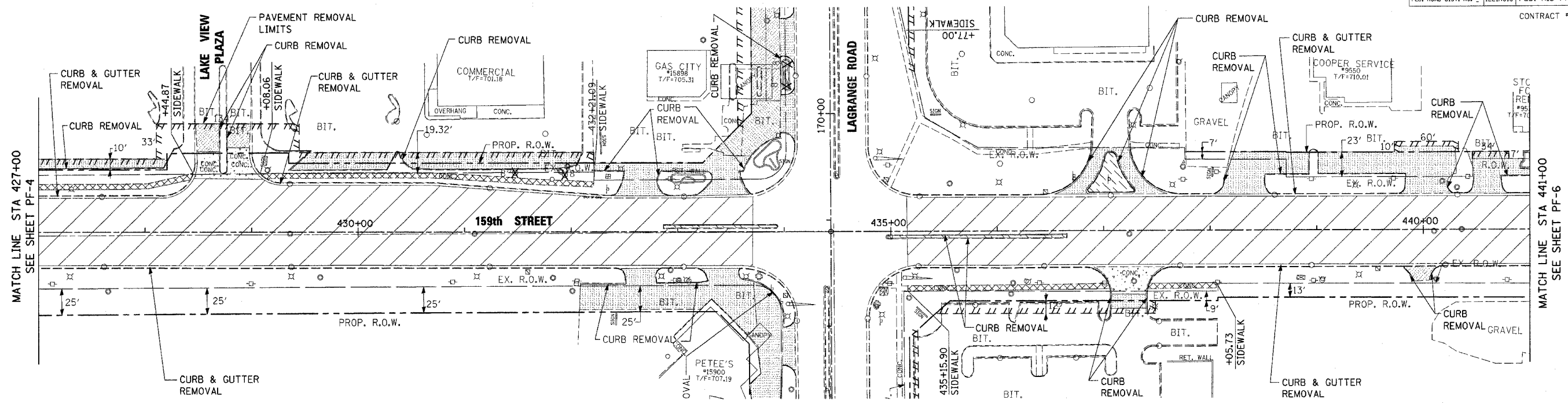

EXISTING CONDITIONS AND REMOVAL PLAN

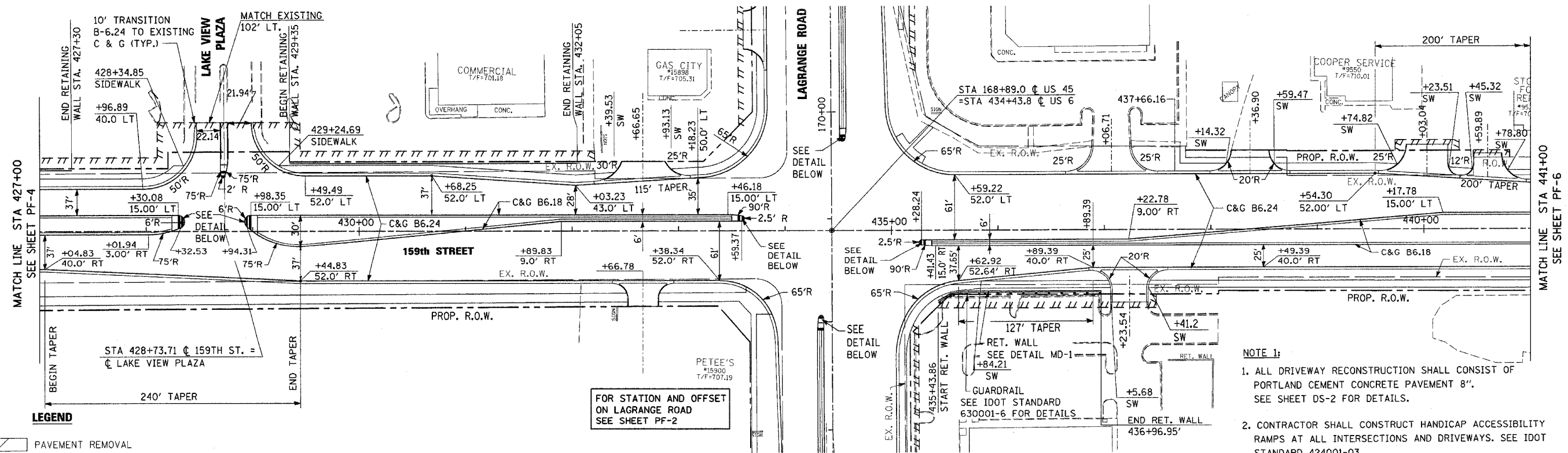

PROPOSED IMPROVEMENT PLAN

LEGEND

- PAVEMENT REMOVAL
- MEDIAN REMOVAL
- SIDEWALK REMOVAL
- CONCRETE DRIVEWAY REMOVAL (PAID AS "DRIVEWAY PAVEMENT REMOVAL")
- BITUMINOUS DRIVEWAY/PARKING REMOVAL (PAID AS "DRIVEWAY PAVEMENT REMOVAL")
- TREE REMOVAL
- TEMPORARY EASEMENT

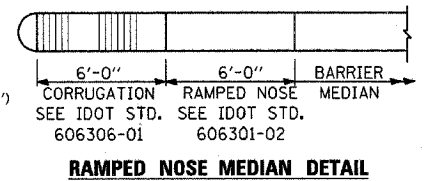

- NOTE 1:**
- ALL DRIVEWAY RECONSTRUCTION SHALL CONSIST OF PORTLAND CEMENT CONCRETE PAVEMENT 8". SEE SHEET DS-2 FOR DETAILS.
 - CONTRACTOR SHALL CONSTRUCT HANDICAP ACCESSIBILITY RAMPS AT ALL INTERSECTIONS AND DRIVEWAYS. SEE IDOT STANDARD 424001-03.

REVISIONS	
NAME	DATE

ILLINOIS DEPARTMENT OF TRANSPORTATION
 US RTE 6 (159TH ST) AT US RTE 45 (LAGRANGE RD)
US RTE 6 (159TH STREET)
EXISTING AND PROPOSED PLAN
 STA 427+00 TO STA 441+00
 SCALE: 1"=50'
 DATE: 7-07-06
 DRAWN BY: JTF
 CHECKED BY: RCH

