

SECTION	COUNTY	TOTAL SHEETS	SHEET NO.
537 R-1	COOK	245	34
STA. TO STA.		ILLINOIS FED. AID PROJECT	
FED. ROAD DIST. NO.		CONTRACT # 62880	

CONTINUED FROM DRAWING PF-5  
MATCH LINE STA 441+00

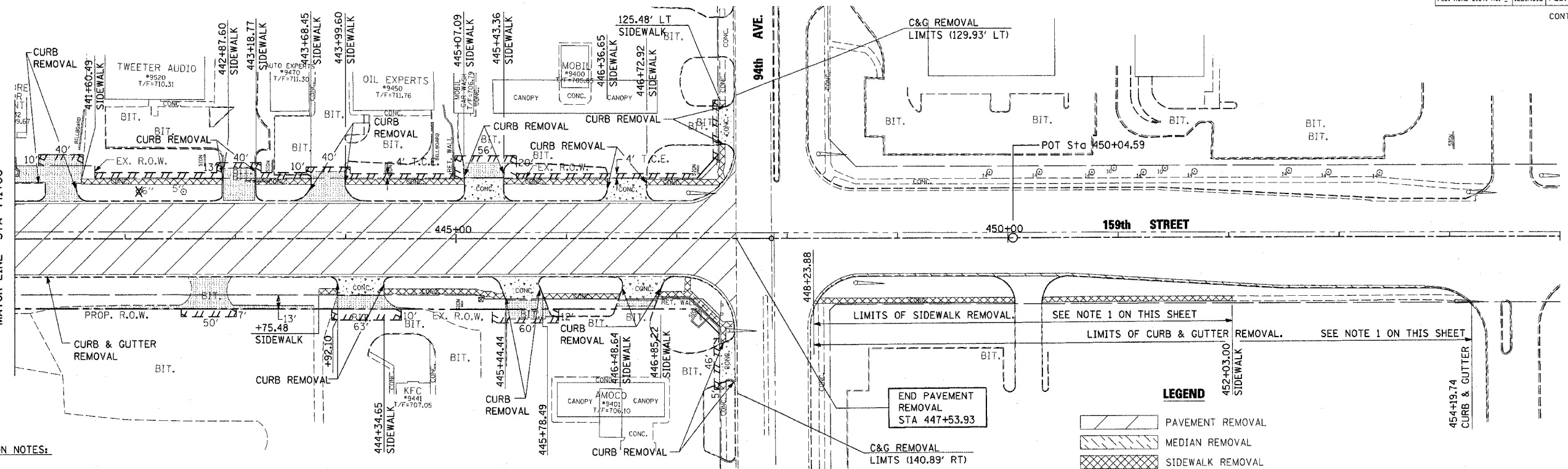

**NOTE 1:**

**RESTORATION NOTES:**

AT THE TEMPORARY PAVEMENT LOCATION, THE CONTRACTOR SHALL REMOVE AND REPLACE CURB & GUTTER, MEDIAN AND SIDEWALK IN-KIND FOR THE FOLLOWING LIMITS:

- CURB & GUTTER LIMITS: STA. 448+23.88± TO STA. 454+19.74± (SOUTH ONLY)
- SIDEWALK LIMITS: STA. 448+23.88± TO STA. 454+19.74± (SOUTH ONLY)

**EXISTING CONDITIONS AND REMOVAL PLAN**

**LEGEND**

- PAVEMENT REMOVAL
- MEDIAN REMOVAL
- SIDEWALK REMOVAL
- CONCRETE DRIVEWAY REMOVAL (PAID AS "DRIVEWAY PAVEMENT REMOVAL")
- BITUMINOUS DRIVEWAY/PARKING REMOVAL (PAID AS "DRIVEWAY PAVEMENT REMOVAL")
- TREE REMOVAL
- TEMPORARY EASEMENT

CONTINUED FROM DRAWING PF-5  
MATCH LINE STA 441+00

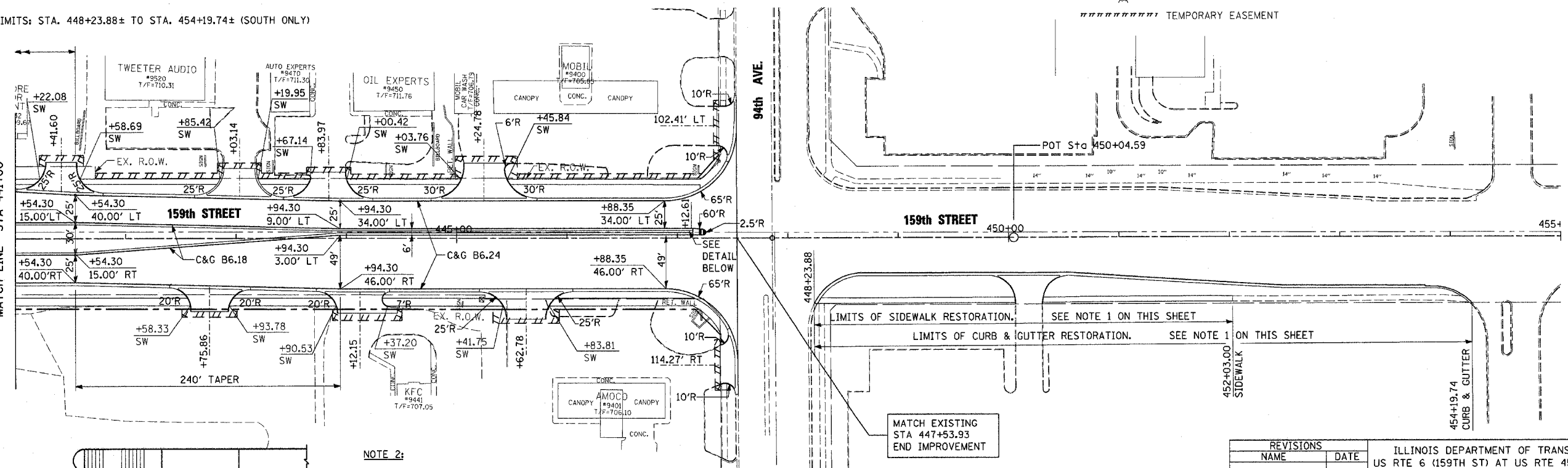

**NOTE 2:**

- ALL DRIVEWAY RECONSTRUCTION SHALL CONSIST OF PORTLAND CEMENT CONCRETE PAVEMENT 8". SEE SHEET DS-2 FOR DETAILS.
- CONTRACTOR SHALL CONSTRUCT HANDICAP ACCESSIBILITY RAMPS AT ALL INTERSECTIONS AND DRIVEWAYS. SEE IDOT STANDARD 424001-03.

**PROPOSED IMPROVEMENT PLAN**

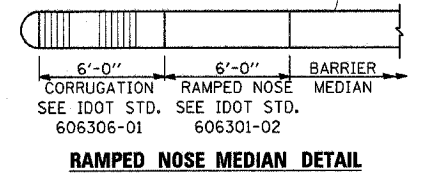

REVISIONS	
NAME	DATE

ILLINOIS DEPARTMENT OF TRANSPORTATION  
US RTE 6 (159TH ST) AT US RTE 45 (LAGRANGE RD)  
US RTE 6 (159TH STREET)  
EXISTING AND PROPOSED PLAN  
STA 441+00 TO 94TH AVE.

SCALE: 1"=50'  
DATE: 7-07-06

DRAWN BY: JTF  
CHECKED BY: RCH

**McDonough Associates Inc.**  
Engineers / Architects