

F.A.P. RTE.:	SECTION	COUNTY	TOTAL SHEETS	SHEET NO.
351	537 R-1	COOK	245	43
STA. _____ TO STA. _____		ILLINOIS FED. AID PROJECT		
FED. ROAD DIST. NO. _____		CONTRACT # 62880		

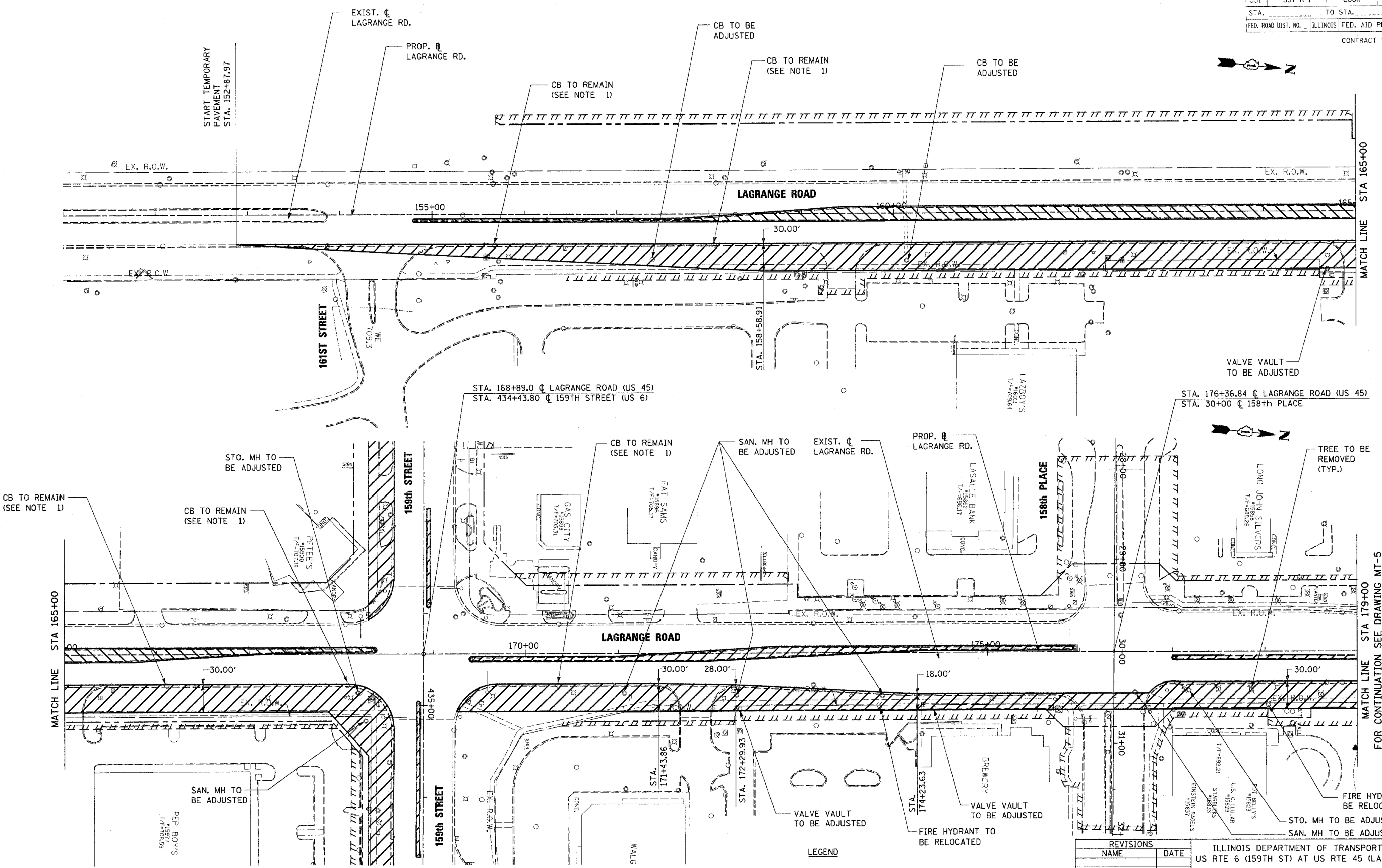
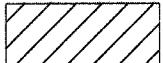

NOTE 1:
 THE CONTRACTOR SHALL UTILIZE ALL THE EXISTING CATCH BASINS LOCATED ON THE EAST EDGE OF LAGRANGE ROAD TO DRAIN THE TEMPORARY PAVEMENT. THE TEMPORARY PAVEMENT SHALL BE CONSTRUCTED WITH A MIN. OF 1% SLOPE TOWARDS THESE CATCH BASINS. SEE SHEET MT-2 FOR TYPICAL SECTIONS.

LEGEND
 TEMPORARY PAVEMENT AND AGGREGATE SHOULDER
 SEE MT-1 FOR MOT SYMBOLS LEGEND

REVISIONS	
NAME	DATE

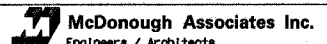
ILLINOIS DEPARTMENT OF TRANSPORTATION
 US RTE 6 (159TH ST) AT US RTE 45 (LAGRANGE RD)
MAINTENANCE OF TRAFFIC - PRE-STAGE
 U.S. 45 (LAGRANGE ROAD)
 STA 151+00 TO STA 179+00
 SCALE: 1"=50'
 DATE: 7-07-06
 DRAWN BY: TRK
 CHECKED BY: RCH
 McDonough Associates Inc.
 Engineers / Architects

I:\D\1\m101004.sht
 7/27/06 10:56 AM
 12:10:18 PM