

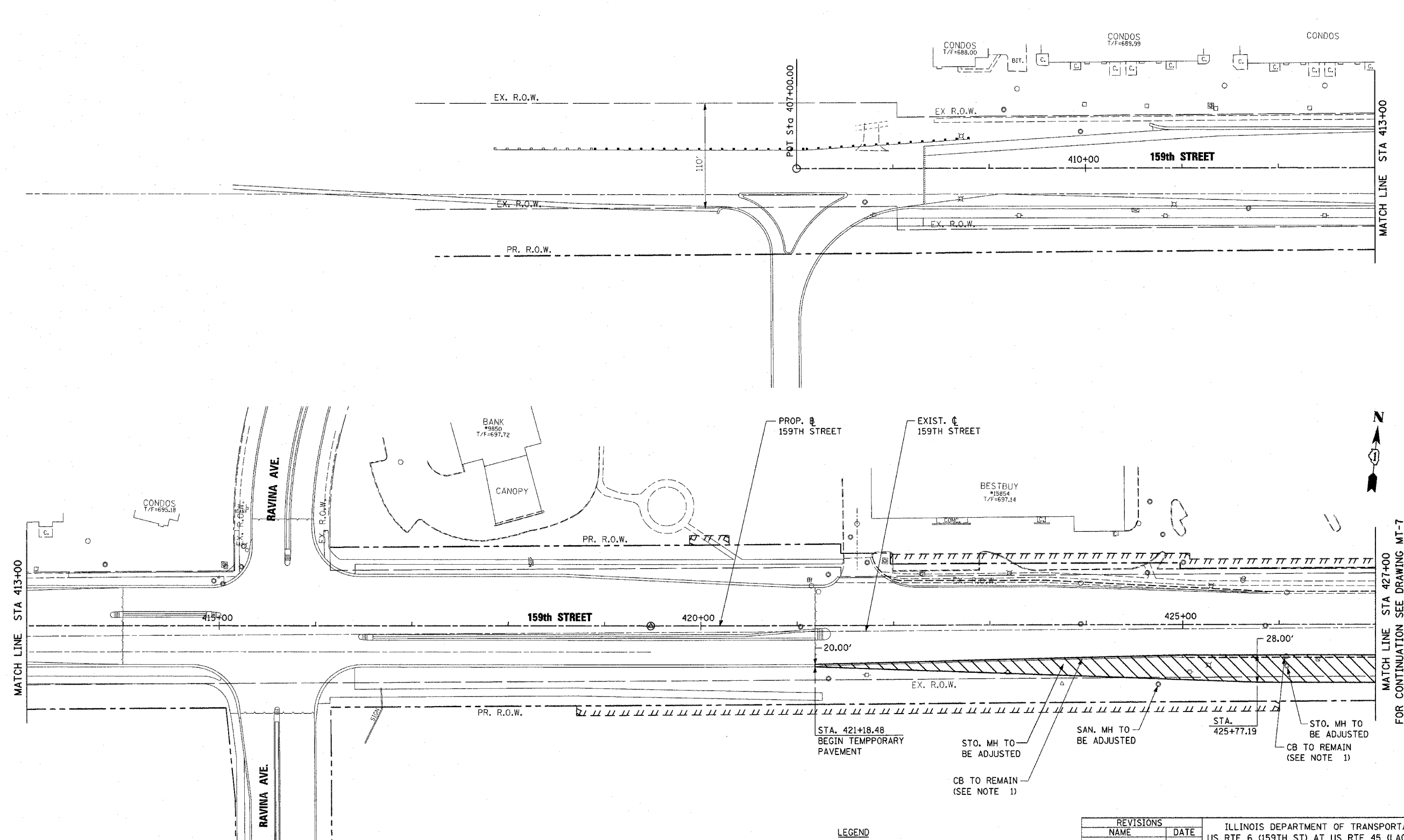

EXP. RTE.	SECTION	COUNTY	TOTAL SHEETS	SHEET NO.
351	537 R-1	COOK	245	45
STA.		TO STA.		
FED. ROAD DIST. NO.		ILLINOIS FED. AID PROJECT		

CONTRACT • 62880



NOTE 1:
 THE CONTRACTOR SHALL UTILIZE ALL THE EXISTING CATCH BASINS LOCATED ON THE EAST EDGE OF LAGRANGE ROAD TO DRAIN THE TEMPORARY PAVEMENT. THE TEMPORARY PAVEMENT SHALL BE CONSTRUCTED WITH A MIN. OF 1% SLOPE TOWARDS THESE CATCH BASINS. SEE SHEET MT-2 FOR TYPICAL SECTIONS.

LEGEND

 TEMPORARY PAVEMENT AND AGGREGATE SHOULDER

SEE MT-1 FOR MOT SYMBOLS LEGEND

REVISIONS		NAME	DATE
NO.	DESCRIPTION		

ILLINOIS DEPARTMENT OF TRANSPORTATION
 US RTE 6 (159TH ST) AT US RTE 45 (LAGRANGE RD)
 MAINTENANCE OF TRAFFIC - PRE-STAGE
 U.S. ROUTE 6 (159TH ST.)
 STA 408+00 TO STA 427+00
 SCALE: 1"=50'
 DATE: 7-07-06

DRAWN BY: RCH
 CHECKED BY: RCH

McDonough Associates Inc.
 Engineers / Architects

FILES
 SDATES
 STIMES