

E.A.P. RTE.	SECTION	COUNTY	TOTAL SHEETS	SHEET NO.
351	537 R-1	COOK	245	48
STA.		TO STA.		
FED. ROAD DIST. NO.		ILLINOIS	FED. AID PROJECT	

CONTRACT # 62880

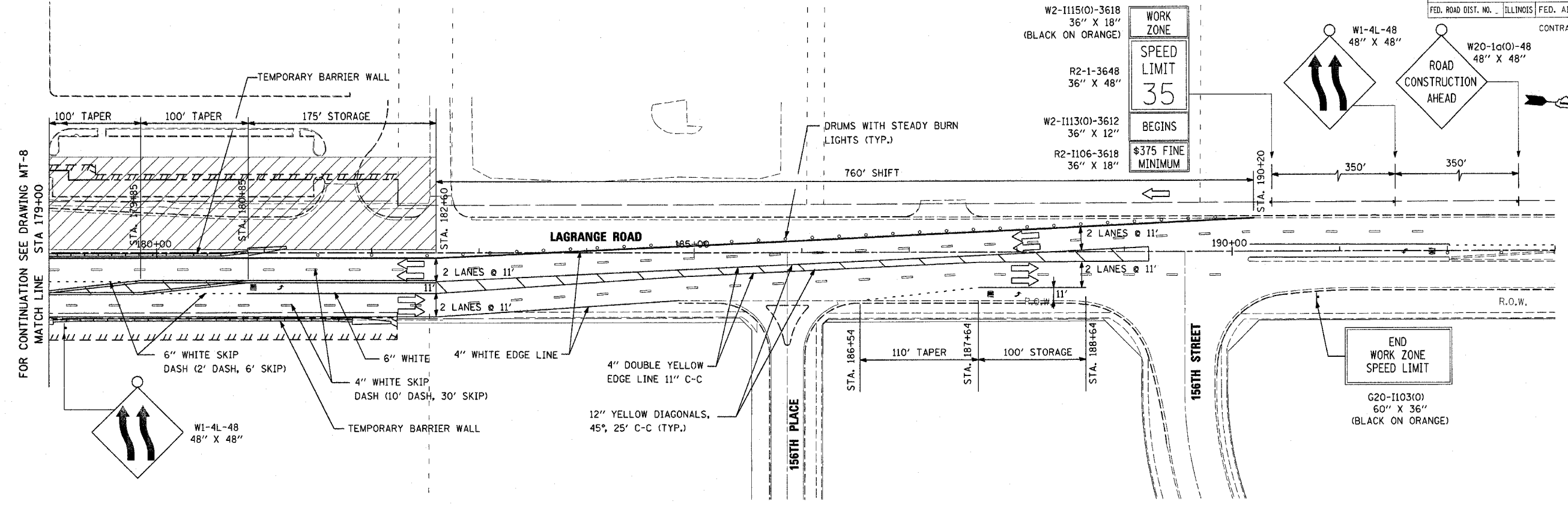

FOR CONTINUATION SEE DRAWING MT-8
MATCH LINE STA 179+00

LEGEND

- TYPE II BARRICADE WITH MONO-DIRECTIONAL STEADY BURN LIGHTS AT 50' CENTERS, 25' IN TAPERS AND 10' IN RADII (TYP.) SEE NOTE 1.
- ⊥ TYPE III BARRICADE WITH LIGHT
- ➔ TRAFFIC LANE
- ⊥ TEMPORARY TRAFFIC ADVISORY SIGN
- ▨ WORK AREA
- ▬ TEMPORARY CONCRETE BARRIER
- ▴ IMPACT ATTENUATOR, TEMPORARY, FULLY REDIRECTIVE, NARROW, NCHRP 350, TEST LEVEL 2

NOTE 1:
TEMPORARY CONCRETE BARRIER WALL SHALL BE PROVIDED WHEREVER THE VERTICAL DROP-OFF BETWEEN DRIVING LANES AND THE ADJACENT GROUND EXCEEDS 18 INCHES.

REVISIONS	
NAME	DATE

ILLINOIS DEPARTMENT OF TRANSPORTATION
US RTE 6 (159TH ST) AT US RTE 45 (LAGRANGE RD)
MAINTENANCE OF TRAFFIC - STAGE 1
U.S. 45 (LAGRANGE ROAD)
STA 179+00 TO STA 183+50
SCALE: 1"=50'
DATE: 7-07-06

DRAWN BY: TRK
CHECKED BY: RCH

McDonough Associates Inc.
Engineers / Architects