

DRAINAGE LEGEND AND SYMBOLS

- | | | | |
|--------|--|------|-------------------------------------|
| (160R) | STRUCTURE NUMBER (STORM SEWER) | → | SWALE |
| (R) | STRUCTURE REMOVAL | ○ | EXISTING CATCH BASIN |
| (ADJ) | STRUCTURE TO BE ADJUSTED | ● | PROPOSED CATCH BASIN |
| (REC) | STRUCTURE TO BE RECONSTRUCTED | ▷ | EXISTING CULVERT FLARED END SECTION |
| (F) | STRUCTURE TO BE FILLED | ▷ | PROPOSED CULVERT FLARED END SECTION |
| (RP) | REMOVE EXISTING DRAINAGE STRUCTURE AND PLUG EXISTING STORM SEWER | ---- | EXISTING UTILITY TO BE REMOVED |
| (A) | VALVE VAULT TO BE ADJUSTED | XXXX | EXISTING UTILITY TO BE ABANDONED |
| (△) | TELEPHONE MANHOLE TO BE REMOVED/ADJUSTED (BY OTHERS) | | |
| (160W) | STRUCTURE NUMBER (WATER MAIN) | | |
| (160S) | STRUCTURE NUMBER (SANITARY SEWER) | | |
| (M) | STRUCTURE TO BE REMOVED | | |

EXISTING CONDITIONS

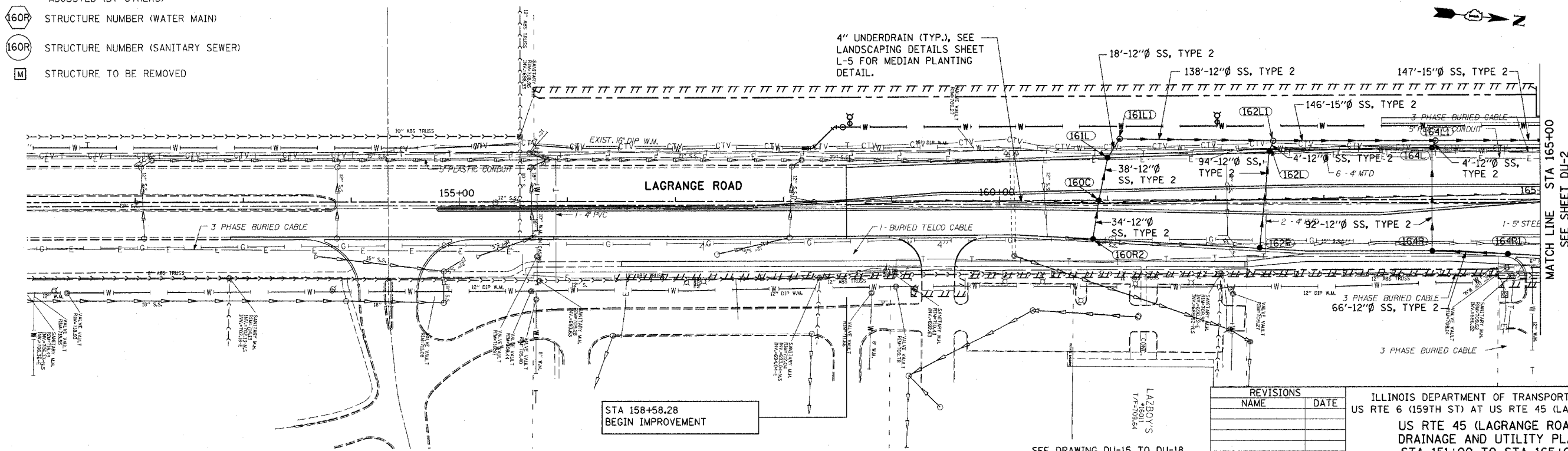

STA 158+58.28
BEGIN IMPROVEMENT

SEE DRAWING DU-15 TO DU-18
FOR WATER MAIN RELATED ITEMS

PROPOSED IMPROVEMENTS

REVISIONS	
NAME	DATE

ILLINOIS DEPARTMENT OF TRANSPORTATION
US RTE 6 (159TH ST) AT US RTE 45 (LAGRANGE RD)
**US RTE 45 (LAGRANGE ROAD)
DRAINAGE AND UTILITY PLAN
STA 151+00 TO STA 165+00**
SCALE: 1"=50' DRAWN BY: GIU
DATE: 7-07-06 CHECKED BY: RCH