

F.A.P. RTE.	SECTION	COUNTY	TOTAL SHEETS	SHEET NO.
351	537 R-1	COOK	245	162
STA. 179+00		TO STA. 183+50		
FED. ROAD DIST. NO.	ILLINOIS	FED. AID PROJECT		
CONTRACT # 62880				

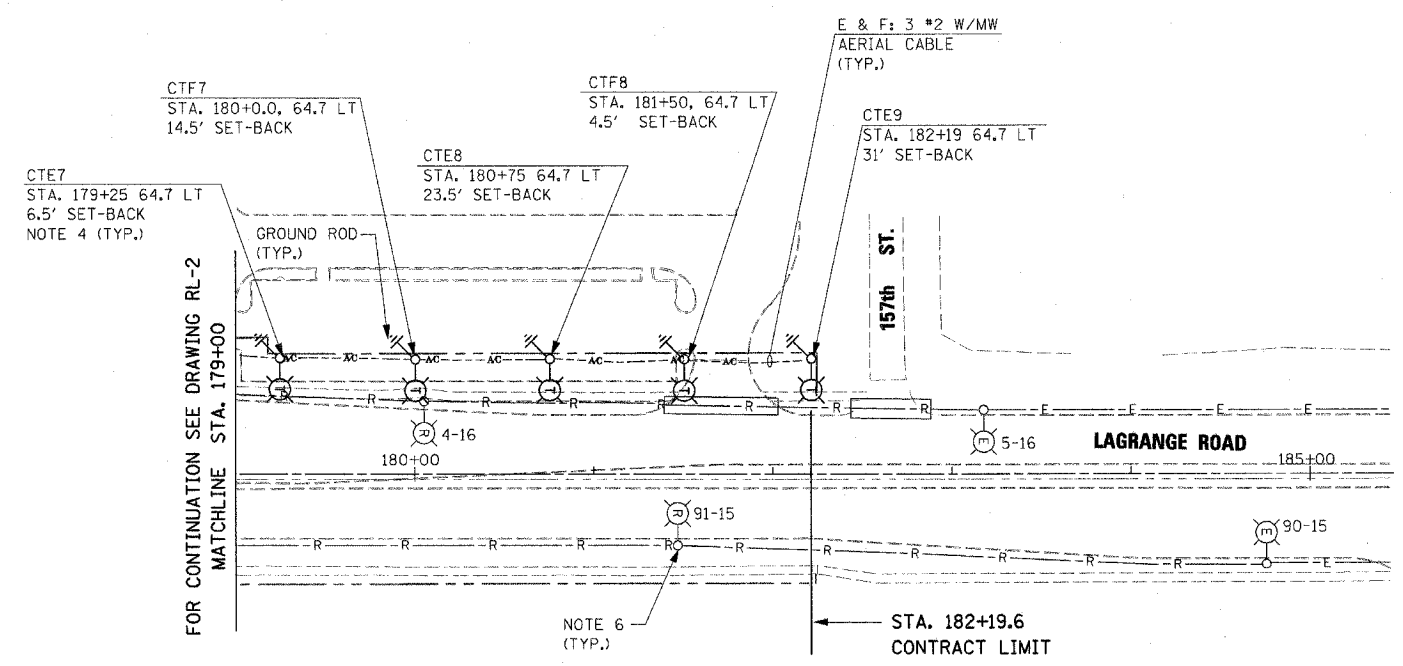

- NOTES:**
- SEE DRAWING RL-1 FOR LIGHTING PHASING NOTES.
 - TEMPORARY LIGHTING UNITS SHALL BE FURNISHED, INSTALLED AND ENERGIZED PRIOR TO THE COMMENCEMENT OF STAGE 1 WORK.
 - TEMPORARY LIGHTING WILL REMAIN IN SERVICE UNTIL PROPOSED (PERMANENT) LIGHTING IS INSTALLED, ENERGIZED, TESTED AND APPROVED BY THE ENGINEER.
 - FOR TEMPORARY LIGHTING DETAILS, SEE DRAWING ED-7.
 - INDICATED SET-BACK DISTANCE FOR TEMPORARY LIGHT POLES IS FROM THE BACK OF THE CURB INSTALLED IN STAGE 1 OF CONSTRUCTION.
 - EXISTING LIGHT POLE FOUNDATION SHALL BE REMOVED IN ACCORDANCE WITH IDOT STANDARD SPECIFICATIONS.

FILES
DATES
TIMES

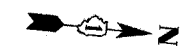
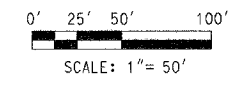
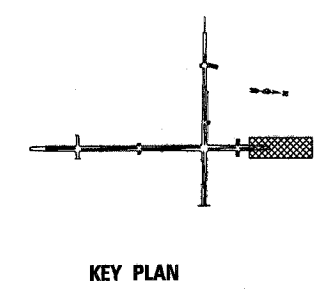

RL-3

REVISIONS		DATE
NAME		

ILLINOIS DEPARTMENT OF TRANSPORTATION
US RTE 6 (159TH ST) AT US RTE 45 (LAGRANGE RD)
LAGRANGE ROAD (US45)
TEMPORARY LIGHTING AND REMOVAL PLAN
STA 179+00 TO STA 182+19.6

SCALE: 1" = 50' DRAWN BY: MB
DATE: 7-07-06 CHECKED BY: KMY

McDonough Associates Inc.
Engineers / Architects