

F.A. RTE.	SECTION	COUNTY	TOTAL SHEETS	SHEET NO.
			245	228
STA.		TO STA.		
FED. ROAD DIST. NO.	ILLINOIS	FED. AID PROJECT		

62880

LEGEND

TEMPORARY PAVEMENT
SHOWING SLOPE TO
EXISTING GRADE

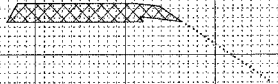

FINAL SURVEY	DATE
SURVEYED	BY
NOTE BOOK	NO.
AREAS CHECKED	

ORIGINAL SURVEY	DATE
SURVEYED	BY
NOTE BOOK	NO.
AREAS CHECKED	

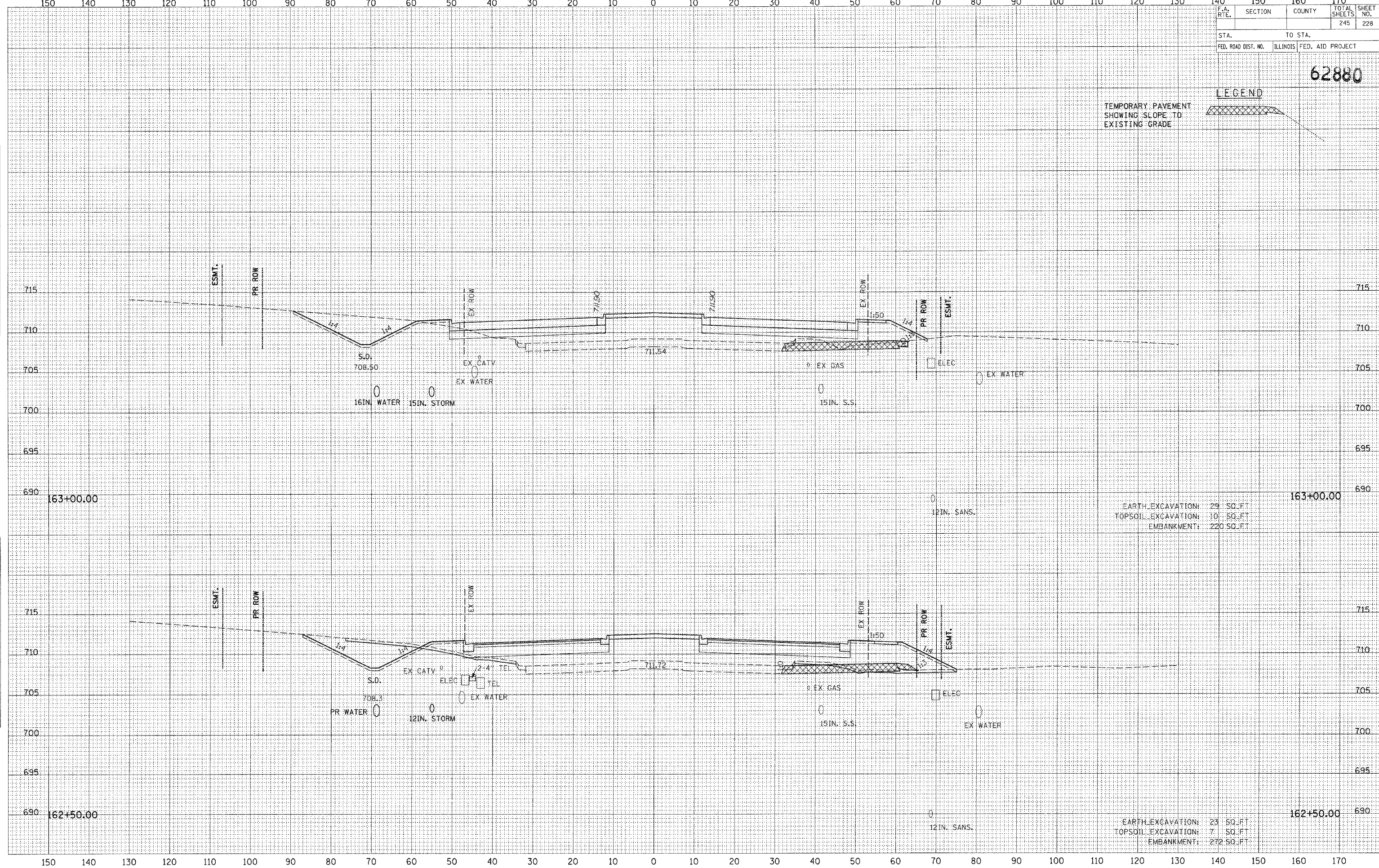

EARTH EXCAVATION: 29 SQ.FT
TOPSOIL EXCAVATION: 10 SQ.FT
EMBANKMENT: 220 SQ.FT

EARTH EXCAVATION: 23 SQ.FT
TOPSOIL EXCAVATION: 7 SQ.FT
EMBANKMENT: 272 SQ.FT