

F. & M. NO.	SECTION	COUNTY	TOTAL SHEETS	SHEET NO.
VAR. 2005-026	GRR	*	18	10
STA.	TO STA.			
FED. ROAD DIST. NO.	ELLINGS	FED. AID PROJECT		

* WILL, KANE, DU PAGE AND COOK
CONTRACT 62960

NOTE:
 FOR DETAILS OF RAIL ELEMENTS, RAIL SPLICING, NUT, BOLT AND SIDE VIEW OF RAIL, SEE STANDARD 630001
 ALL WELDS SHALL BE GROUND SMOOTH
 POSTS SHALL BE CUT AND WELDED TO THE BASE PLATE SO THAT THE POST WILL BE PLUMB WHEN ERECTED.
 TWO PERCENT (2%) OF ALL ANCHOR BOLTS SHALL BE TEST LOADED IN PLACE, MINIMUM TEST LOAD=8 KIPS. IF ONE ANCHOR BOLT FAILS DURING THE TEST, TWO OTHER ANCHOR BOLTS SHALL BE TESTED. TESTING EQUIPMENT SHALL BE BOLT COMPANIES.
 PROVIDE 1/8" AND 2/16" GALVANIZED SHIMS FOR 25% OF THE POSTS.

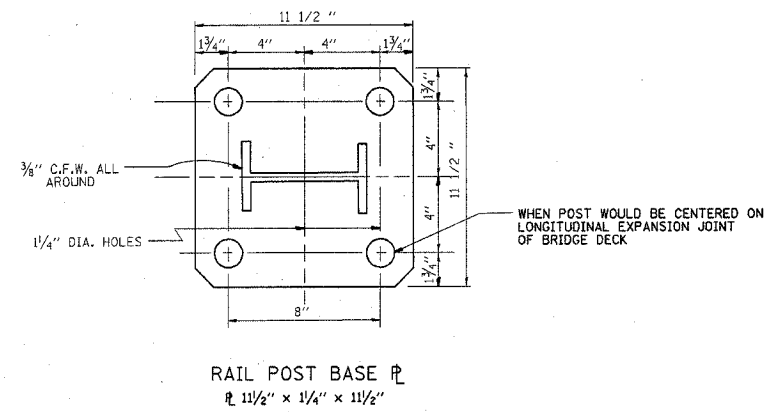

NOTE:
 ALL WELDS SHALL BE GROUND SMOOTH. POSTS SHALL BE CUT AND WELDED TO THE TO THE BASE PLATE SO THAT THE POSTS WILL BE PLUMB WHEN ERECTED.

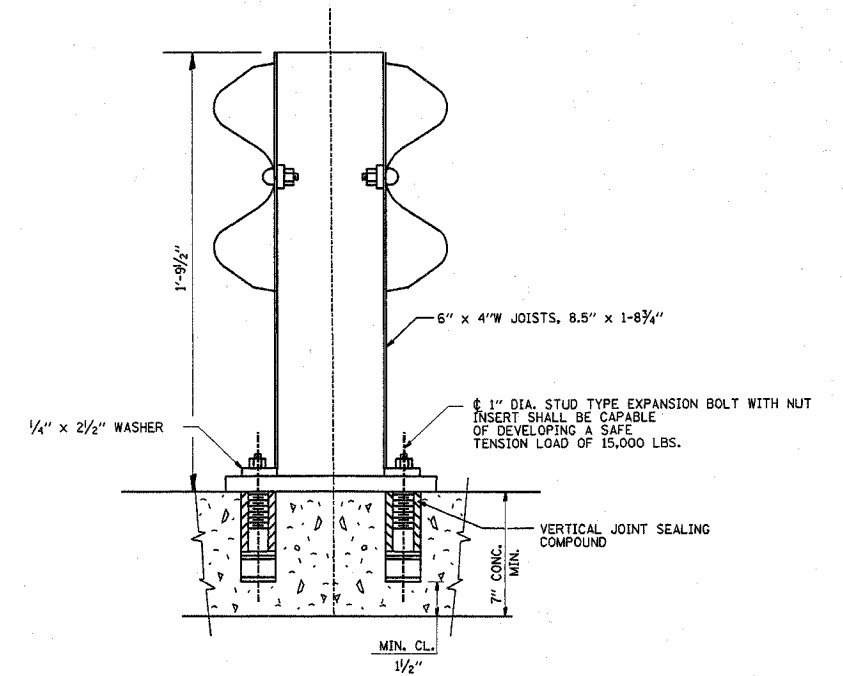

ILLINOIS DEPARTMENT OF TRANSPORTATION

**ANCHOR DETAIL FOR
 STEEL PLATE BEAM GUARD RAIL
 ON CONCRETE**

REVISIONS	
NAME	DATE
CREATED	10-31-88

SCALE: NONE
 DATE: 10-31-88

DRAWN BY R.F.L.
 CHECKED BY