

JOSE M. ALBERT, MD

CONTRACT NO. 64602

FAL	SECTION	COUNTY	TOTAL SHEETS	SHEET NO.
80	37-1HBR-1	HENRY	133	30
STA. 59+00.0000 TO STA. 65+00.0000				
FED. ROAD DIST. NO. ILLINOIS			FED. AID PROJECT	



DATE	
BY	
NO. OF WAY CHECKED	
NO. OF FILE NAME	

DATE	
BY	
NO. OF WAY CHECKED	
NO. OF FILE NAME	

DATE TIME: 11/11/11  
 DRAWN BY: JMA  
 CHECKED BY: JMA  
 REF: 517.92

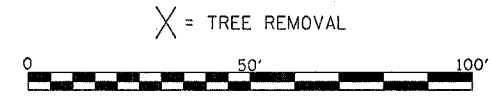
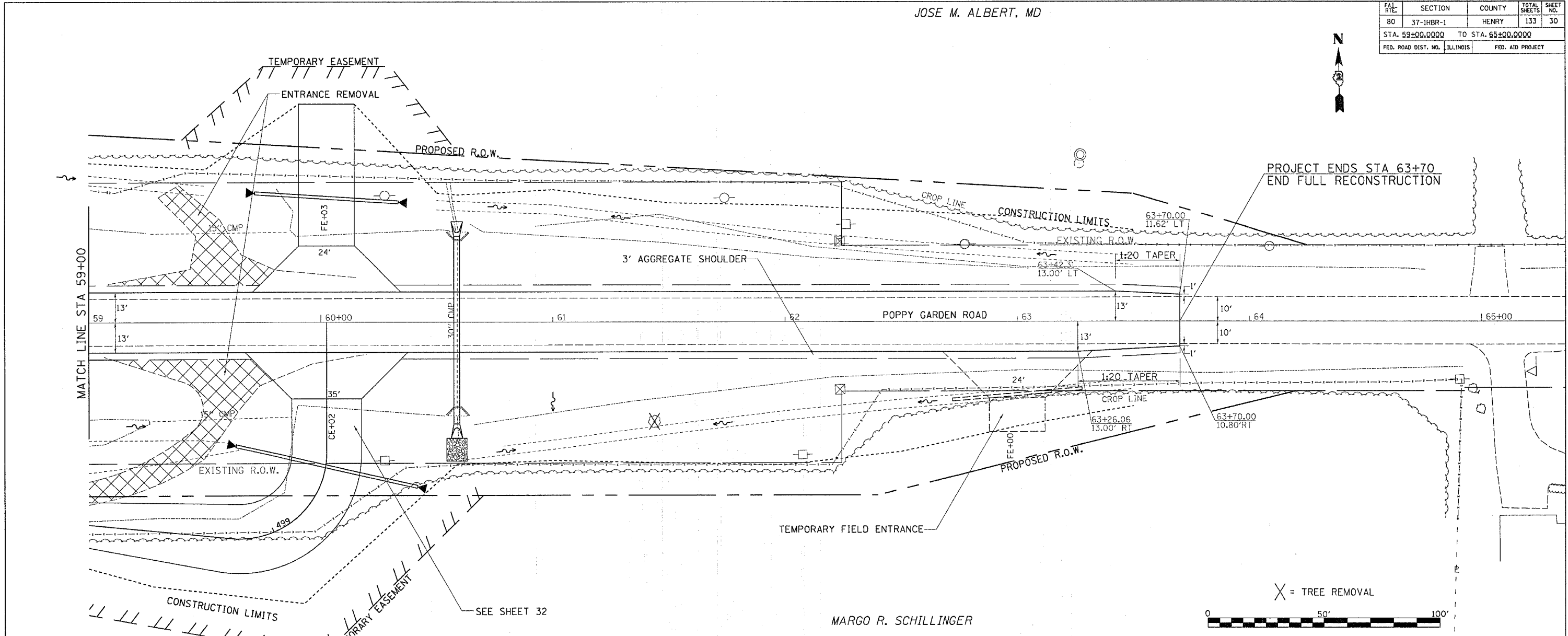

MARGO R. SCHILLINGER

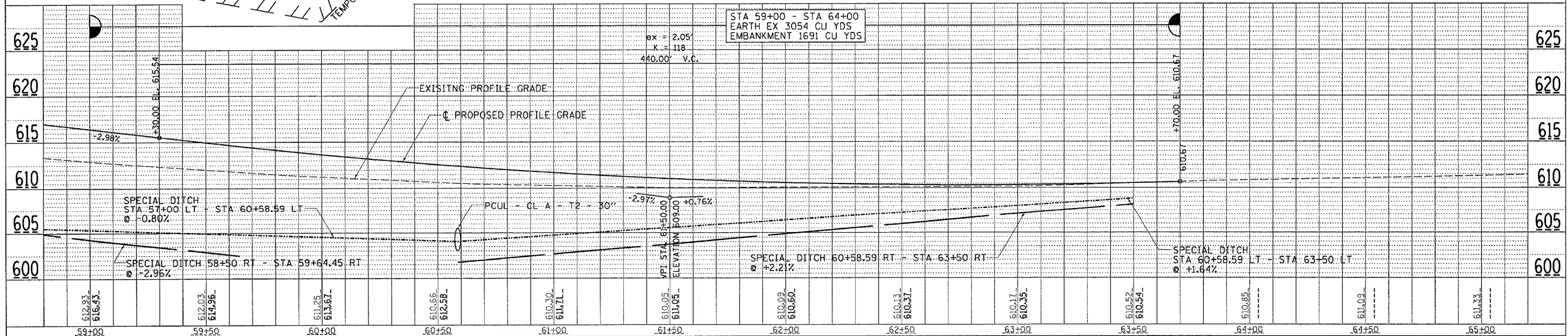

**POPPY GARDEN RD**  
**STA 59+00 - STA 65+00**