

F.A.P. RTE.	SECTION	COUNTY	TOTAL SHEETS	SHEET NO.
17	16-T	CARROLL	47	12
STA.		TO STA.		
FED. ROAD DIST. NO.		ILLINOIS FED. AID PROJECT		

CONTRACT NO. 64897

SEQUENCE OF CONSTRUCTION

- PRE-STAGE 1**
- REMOVE EXISTING BITUMINOUS SHOULDER IN THE AREA OF TEMPORARY WIDENING. CONSTRUCT WIDENING AND TEMPORARY PIPE CULVERT EXTENSION ON THE WEST SIDE OF US 52/IL 64 AS SHOWN. TRAFFIC CONTROL AND PROTECTION SHALL BE IN ACCORDANCE WITH STANDARD 701326.
- STAGE 1**
- PROVIDE ONE-WAY TRAFFIC AROUND WORK AREA ON THE EXISTING SOUTHBOUND LANE AND THE WIDENING CONSTRUCTED IN PRE-STAGE 1. TRAFFIC CONTROL AND PROTECTION SHALL BE IN ACCORDANCE WITH STANDARD 701201.
 - CONSTRUCT THE EASTERN 42' OF THE PROPOSED 48" CULVERT. PATCH THE CULVERT TRENCH. SEE NOTE BELOW.
- STAGE 2**
- PROVIDE ONE-WAY TRAFFIC ON THE EXISTING NORTHBOUND LANE AND BITUMINOUS SHOULDER. TRAFFIC CONTROL AND PROTECTION SHALL BE IN ACCORDANCE WITH STANDARD 701201.
 - CONSTRUCT THE WESTERN 54' OF THE PROPOSED 48" CULVERT. PATCH THE CULVERT TRENCH. SEE NOTE BELOW.
 - REMOVE TEMPORARY PIPE CULVERT EXTENSION AND FILL WESTERN HALF OF EXISTING 4'x6' RCBC AT STA 1441+74. SEE SPECIAL PROVISIONS.
- STAGE 3**
- FILL EASTERN HALF OF EXISTING 4'x6' RCBC AT STA 1441+74. SEE SPECIAL PROVISIONS. TRAFFIC CONTROL AND PROTECTION SHALL BE IN ACCORDANCE WITH STANDARD 701201.
 - PATCH CULVERT TRENCHES RESULTING FROM CULVERT CONSTRUCTION AND CULVERT FILLING INCLUDING PORTION OF BITUMINOUS BASE COURSE WIDENING WHICH WILL BE PART OF ULTIMATE PAVEMENT. TRAFFIC CONTROL AND PROTECTION SHALL BE IN ACCORDANCE WITH STANDARD 701201.
 - REMOVE WIDENING ON WEST SIDE BEYOND ULTIMATE PAVEMENT WIDENING WHICH WAS CONSTRUCTED IN STAGE 1. TRAFFIC CONTROL AND PROTECTION SHALL BE IN ACCORDANCE WITH STANDARD 701326.
 - CONSTRUCT GRATED END SECTION AND DROP BOX AT ENDS OF CULVERT.

NOTE: AT THE END OF EACH WORKDAY, FAP 17 SHALL BE PATCHED AND OPENED TO TWO-WAY TWO-LANE TRAFFIC. IN THE EVENT THE CLASS D PATCHES CAN'T BE PLACED AT THE END OF THE WORK DAY, TEMPORARY PAVEMENT PATCH SHALL BE PLACED UNTIL SUCH TIME THE CLASS D PATCHING CAN BE CONSTRUCTED.

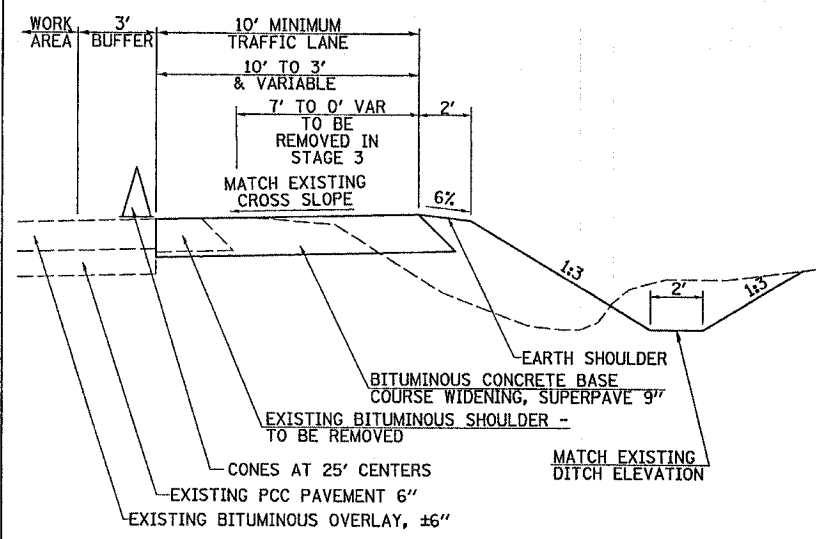
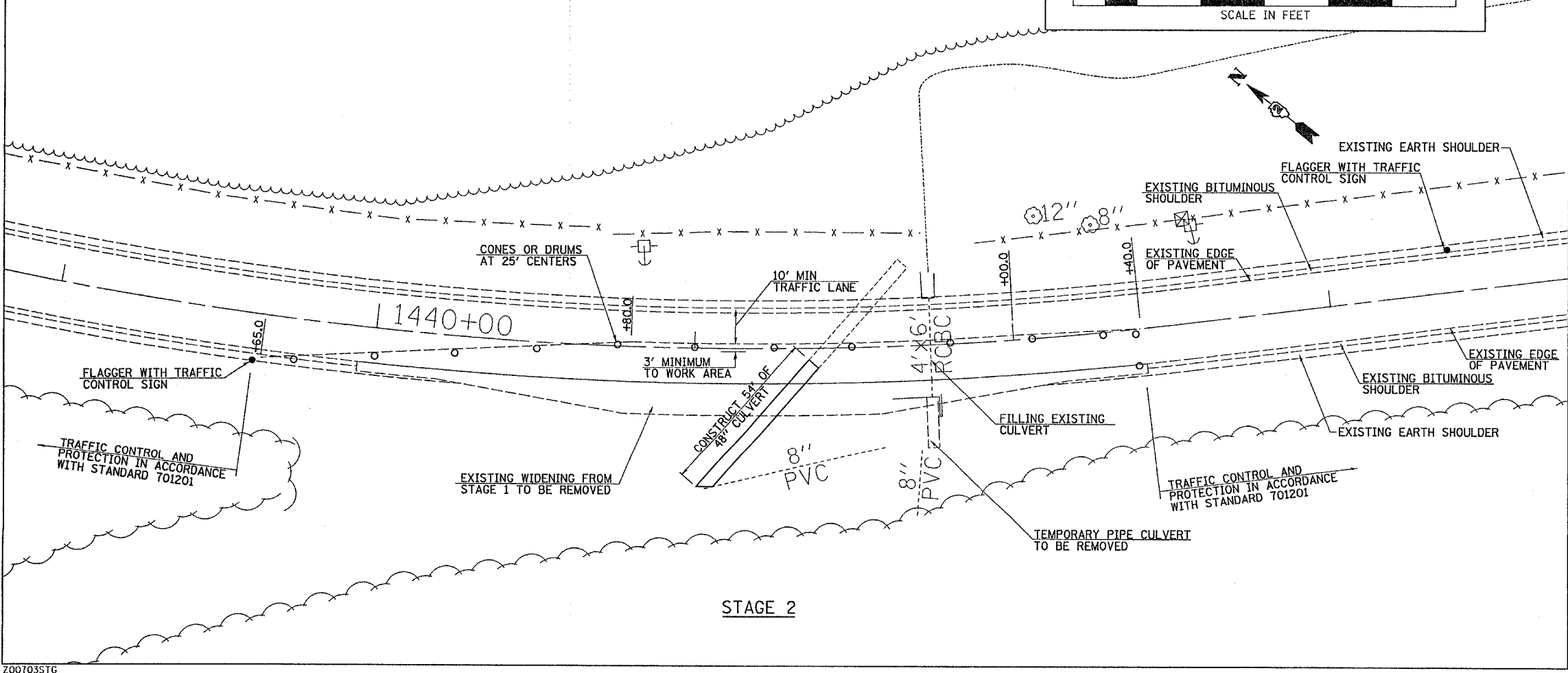
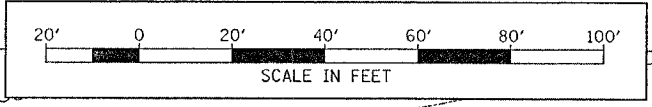
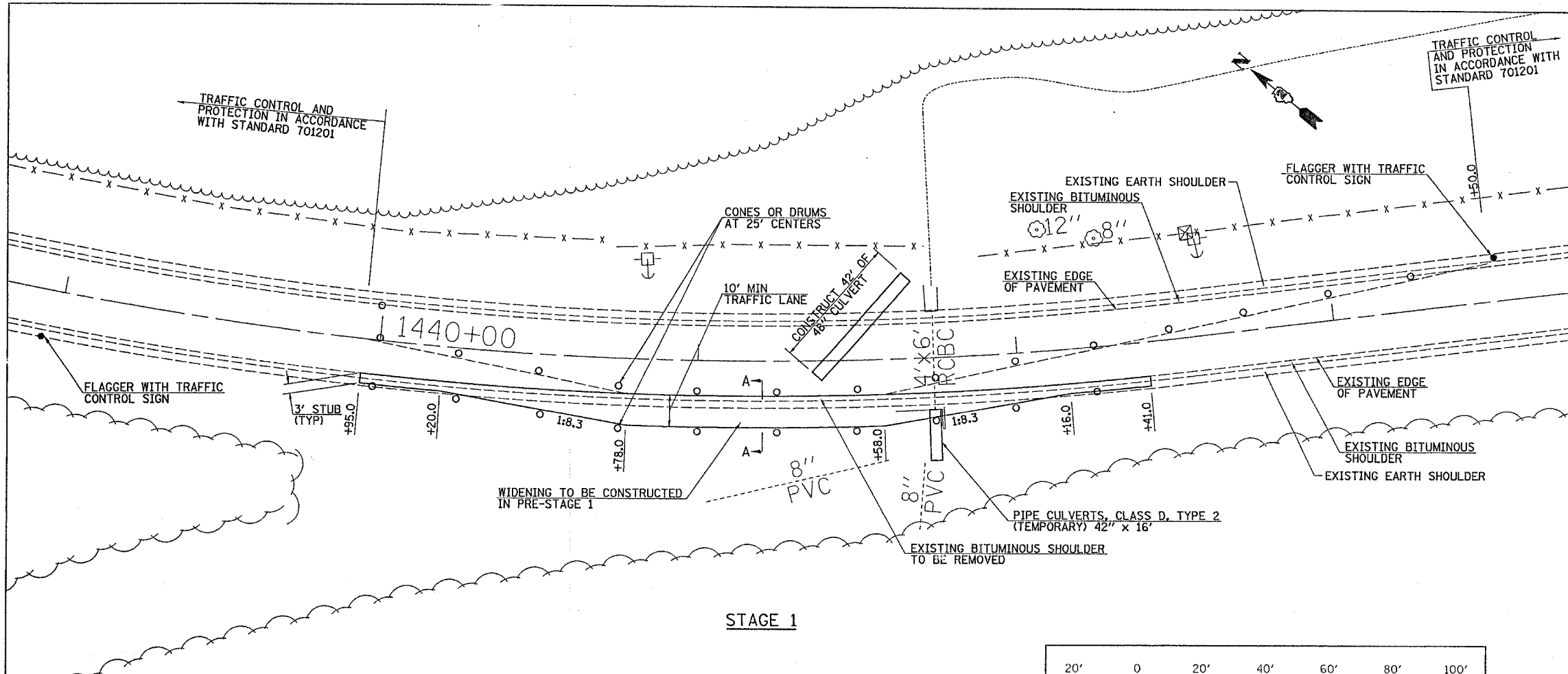

SECTION A-A
NOT TO SCALE

REVISIONS	
NAME	DATE

ILLINOIS DEPARTMENT OF TRANSPORTATION

FAP 17
MAINTENANCE OF TRAFFIC
CULVERT CONSTRUCTION
AT STA 1441+42.0

SCALE: VERT. _____
HORIZ. _____
DATE 8/22/2006

DRAWN BY TJD
CHECKED BY AWM