

F.A.S. RTE.	SECTION	COUNTY	TOTAL SHEETS	SHEET NO.
2247	13X-BR-1	BUREAU	51	1

PROJECT ENGINEER
BECKY MARRUFFO

SQUAD LEADER
THOMAS HALLA
815-234-5993

SENIOR SQUAD LEADER
MIKE YUSEF
815-234-5354

DISTRICT 3 CONTACT:
PROJECT ENGINEER: DAN DRAPER
815-434-8454

JAMES K CLINARD
CHAMLIN & ASSOCIATES
815-223-3344

INDEX OF SHEETS

1. COVER SHEET
2. GENERAL NOTES
3. SUMMARY OF QUANTITIES
4. - 5. TYPICAL SECTIONS
6. HORIZONTAL AND VERTICAL CONTROL
7. - 8. SCHEDULE OF QUANTITIES
9. - 10. PLAN AND PROFILE US 6
11. PLAN AND PROFILE COUNTY HIGHWAY 19
12. TRAFFIC CONTROL (DETOUR)
13. - 28. STRUCTURE PLANS
29. - 31. STRUCTURE BORINGS
32. - 39. EXISTING BRIDGE PLANS (FOR INFORMATION ONLY)
40. BOX CULVERT EXTENSION DETAILS
41. GRATING FOR CULVERTS WITH WINGWALLS
42. CONCRETE HEADWALLS FOR PIPE DRAINS (27.4)
- DELINEATOR AND POST ORIENTATION (37.4)
- WITNESS MARKER FOR PERMANENT SURVEY MARKERS, TYPE II (38.4)
- DRAIN FOR AGGREGATE BASE COURSE (96.4)
- EROSION CONTROL DETAILS FOR SILT FENCE (29.2)
- SUPERELEVATION TRANSITION ON TWO-LANE HIGHWAY (45.2)
- TWO CENTER CURVE DATA (92.2)
- TRAFFIC CONTROL FOR ROAD CLOSURE (40.1)
46. - 51. CROSS SECTIONS

HIGHWAY STANDARDS

- | | |
|-----------|---|
| 000001-04 | STANDARD SYMBOLS, ABBREVIATIONS AND PATTERNS |
| 001001 | AREA OF REINFORCEMENT BARS |
| 280001-02 | TEMPORARY EROSION CONTROL SYSTEMS |
| 420001-06 | PAVEMENT JOINTS |
| 420401-05 | BRIDGE APPROACH PAVEMENT |
| 421001-01 | BAR REINFORCEMENT FOR CRC PAVEMENT |
| 515001-02 | NAME PLATE FOR BRIDGES |
| 542401 | METAL END SECTION FOR PIPE CULVERTS |
| 601101 | CONCRETE HEADWALL FOR PIPE DRAIN |
| 609006-02 | BRIDGE APPROACH PAVEMENT (DRAIN DETAIL) |
| 630001-06 | STEEL PLATE BEAM GUARDRAIL |
| 630201-03 | PCC/ BITUMINOUS STABILIZATION AT STEEL PLATE BEAM GUARDRAIL |
| 630301-03 | SHOULDER WIDENING FOR TYPE 1 (SPECIAL) GUARDRAIL TERMINALS |
| 631031-05 | TRAFFIC BARRIER TERMINAL, TYPE 6 |
| 635001 | DELINEATORS |
| 635006-02 | REFLECTOR AND TERMINAL MARKER PLACEMENT |
| 635011-01 | REFLECTOR MARKER AND MOUNTING DETAILS |
| 667101 | PERMANENT SURVEY MARKERS |
| 701311-02 | LANE CLOSURE, 2L, 2W, MOVING OPERATIONS-DAY ONLY |
| 702001-06 | TRAFFIC CONTROL DEVICES |
| 720011 | METAL POSTS FOR SIGNS, MARKERS, AND DELINEATORS |
| 780001-01 | TYPICAL PAVEMENT MARKINGS |
| 781001-02 | TYPICAL APPLICATIONS RAISED REFLECTIVE PAVEMENT MARKERS |

TRAFFIC DATA

HIGHWAY CLASSIFICATION: RURAL MAJOR COLLECTOR
 2008 ADT = 2600
 DESIGN SPEED 55 MPH
 POSTED SPEED 55 MPH

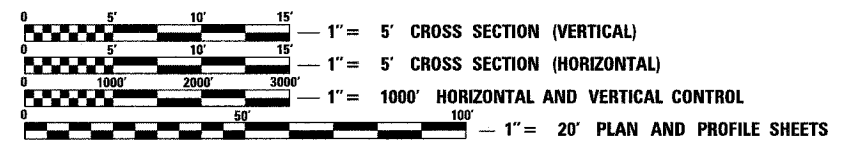

FULL SIZE PLANS HAVE BEEN PREPARED USING STANDARD ENGINEERING SCALES. REDUCED SIZED PLANS WILL NOT CONFORM TO STANDARD SCALES. IN MAKING MEASUREMENTS ON REDUCED PLANS, THE ABOVE SCALES MAY BE USED.

J.U.I.E.
 JOINT UTILITY LOCATION INFORMATION FOR EXCAVATION
 1-800-892-0123

CONTRACT NO. 64938

STATE OF ILLINOIS
 DEPARTMENT OF TRANSPORTATION
 DIVISION OF HIGHWAYS
**PLANS FOR PROPOSED
 FEDERAL AID HIGHWAY**
 FAS ROUTE 2247 (U.S. 6)
 SECTION 13X-BR-1
 OVER BRUSH CREEK
 BUREAU COUNTY
 PROJECT NO. BRS-2247(104)

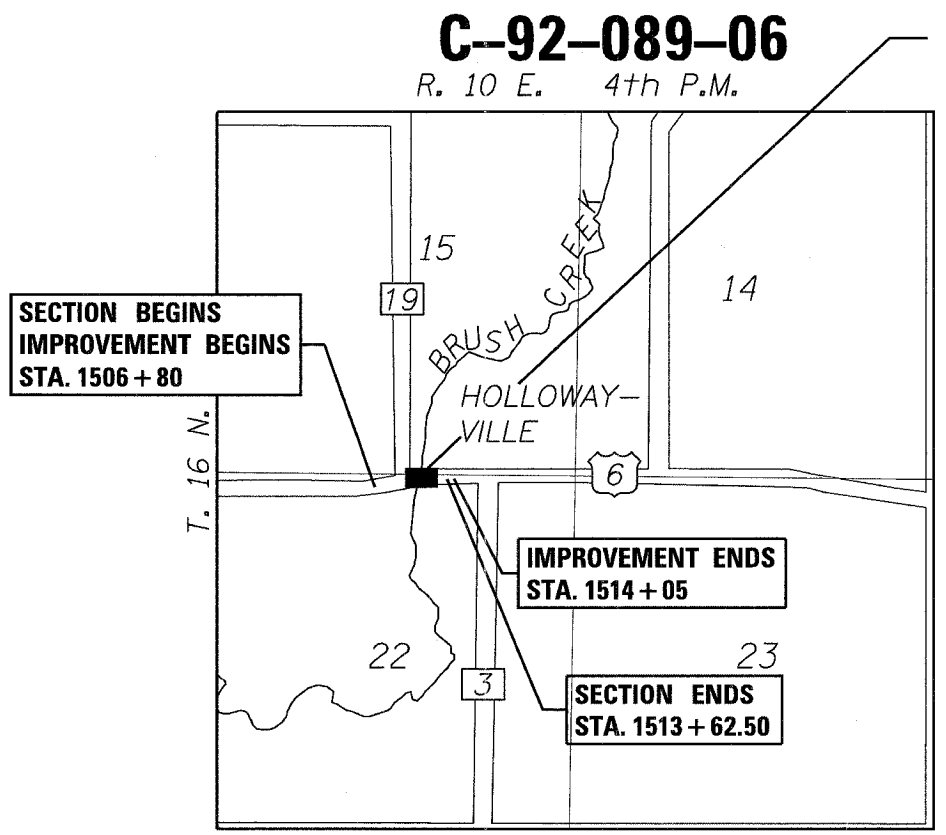

NET LENGTH OF SECTION 682.5 FEET (0.129 MILES)
 GROSS LENGTH OF SECTION 682.5 FEET (0.129 MILES)

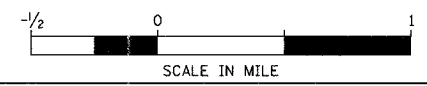

SECTION 13X-BR-1 INCLUDES THE REMOVAL OF EXISTING STRUCTURE NO. 006-0071 AND CONSTRUCTION OF THE NEW STRUCTURE NO. 006-0169, A THREE SPAN COMPOSITE STEEL BEAM BRIDGE OVER BRUSH CREEK AT STA. 1510 + 65.80, 127'-0" BK TO BK ABUTMENT.

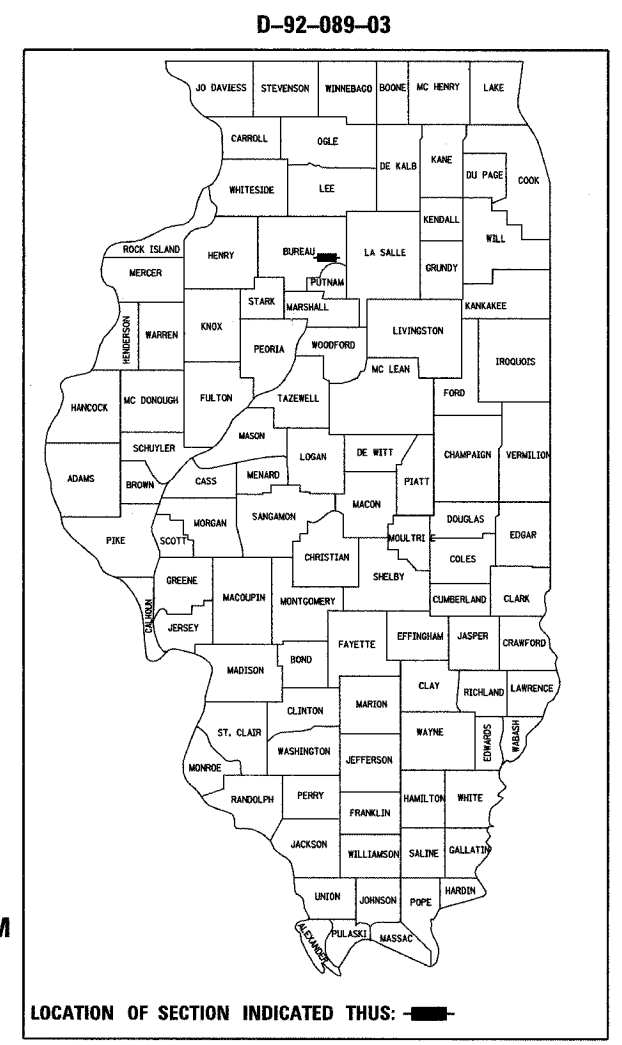
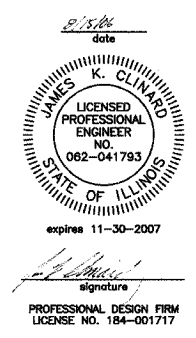

STATE OF ILLINOIS
 DEPARTMENT OF TRANSPORTATION
 DIVISION OF HIGHWAYS

SUBMITTED _____ 20

Angus E. Mantz
 DEPUTY DIRECTOR OF HIGHWAYS, REGION ENGINEER

October 13, 20 06
Mike Hine
 ENGINEER OF DESIGN AND ENVIRONMENT

October 13, 20 06
Milton R. See P.E.
 DIRECTOR OF HIGHWAYS, CHIEF ENGINEER

DISTRICT 3 OTTAWA IL.
 PRINTED BY THE AUTHORITY
 OF THE STATE OF ILLINOIS