

F.A.S. R.T.E.	SECTION	COUNTY	TOTAL SHEETS	SHEET NO.
2247	13X-BR-1	BUREAU	51	34
STA.		TO STA.		
FED. ROAD DIST. NO.		ILLINOIS FED. AID PROJECT		

FOR INFORMATION ONLY 34 of 51

B.M. Top of Street E on Top 3rd Bridge Girders
 at Sta 19+50 ELEV. 627.18
 Existing Bridge Continuous Anchored R.C.C. on Pile Bent Pier & Abut.
 Superstructure to be removed by others prior to construction. Portions of Abut. & Piers to be removed by Contractor under item Concrete Removal No. 51111.
 No Temporary Bridge Req'd.

STATE OF ILLINOIS
 DEPARTMENT OF PUBLIC WORKS & BUILDINGS
 DIVISION OF HIGHWAYS

DATE	REVISION	BY	CHKD.	APP'D.	SHEET NO.
11/18/58	132-01	Bureau	11	3	5 SHEETS

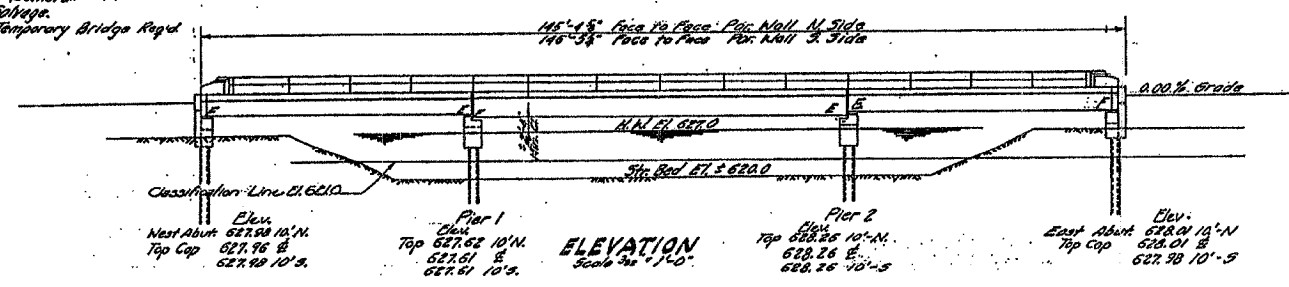

GENERAL NOTES

Class X Concrete shall be used in abutments, Piers and Curb.
 Handrail Concrete shall be used in End Posts.
 For Item 224000, Prestressed Concrete Bridge Deck, see Special Provisions.
 All surfaces of expansion guards inaccessible after erection shall be given two shop coats of red lead paint; the anchor bolts shall not be painted.
 Expansion guards shall be fabricated and erected in accordance with Article 21.13(d) of the Standard Specifications. Cost to be incidental to Prestressed Concrete Bridge Deck.
 Structural Steel (A36 & A572 Gr. 50) shall be painted one shop coat of red lead paint and 2 field coats of aluminum paint.

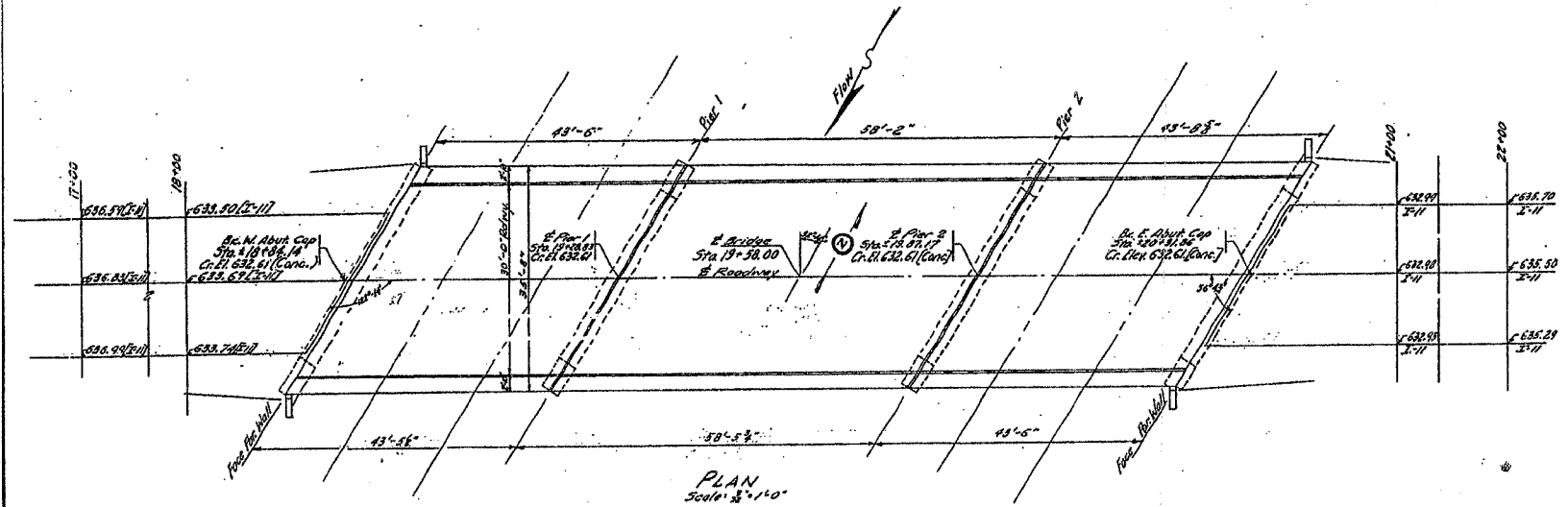

STATION 19+50
 BUILT 19 BY
 STATE OF ILLINOIS
 P.A. RT. 134 SEC. 13X-BY
 LOADING H-20-S16

NAME PLATE LETTERING
 See Standard 2113

TOTAL BILL OF MATERIAL

Item	Super	Sub.	Tons
Precast Prestressed Conc. Br. Deck 500	4790	40.9	4790
Class X Concrete Cu. Yds.	2307.98	4.51	2312.49
Handrail Concrete Cu. Yds.	1.6		1.6
Reinforcement Bars Lbs.	100	2150	4630
Met. Handrail Lin. Ft.	267		267
Precast Concrete Piles (16") Lin. Ft.		400	400
Concrete Removal Cu. Yds.		0	0
3/4" Expansion Bolts Ea.		100	100
Name Plate Ea.	1		1
Structural Steel Lbs.	700		700
Bit. Mortar (Prime Coat) Cu. Yds.	49		49
Bit. Conc. Surf. Gr. Ft. Tons	60		60

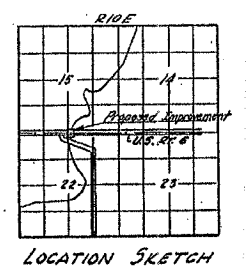

PRESTRESSED UNITS DESIGN STRESSES

$f_c = 8000$ p.s.i.
 $f_{ci} = 4000$ p.s.i.
 $f_s = 150,000$ p.s.i. (Cable)
 $f_s = 150,000$ p.s.i. (Strand)

FIELD UNITS DESIGN STRESSES

$f_c = 1400$ p.s.i. Super & Sub.
 $f_c = 2000$ p.s.i. Deck
 $f_s = 18,000$ p.s.i. Struct.
 $n = 10$

BRUSH CREEK
 P.A. RT. 134 SEC. 13X-BY
 BUREAU COUNTY
 STA. 19+50

DESIGNED *Alphonse G. DeB.*
 CHECKED *Ch. Adams*
 EXAMINED *Mr. P.*
 PASSED *E. H. ...*
 DATE **SEPT. 25 1959**

REVISIONS	
NAME	DATE

ILLINOIS DEPARTMENT OF TRANSPORTATION

FOR INFORMATION ONLY

SCALE: VERT. _____
 HORIZ. _____
 DATE _____

DRAWN BY _____
 CHECKED BY _____