

F.A.P. RTE.	SECTION	COUNTY	TOTAL SHEETS	SHEET NO.
627	(I-1) BR & I	LA SALLE	106	22
STA.	TO STA.			
FED. ROAD DIST. NO.	ILLINOIS	FED. AID PROJECT		

LEGEND

- XXXX TO BE COVERED
- FLASHING LIGHT
- 18"x8" ORANGE FLAG
- TT TYPE III BARRICADE
- DIRECTION ARROW CHANGE

- ① **DETOUR** M4-8 24x12
71
M6-1 21x15
- ② **DETOUR** M4-8 24x12
M1-I100 24x24
71
M5-1 21x15
- ③ **DETOUR** M4-8 24x12
M2-1 21x12
JCT
71
M1-I100 24x24
- ④ **DETOUR** M4-8 24x12
M1-I100 24x24
71
M6-6 21x15
- ⑤ **DETOUR** M4-8 24x12
M1-I100 24x24
71
M6-6 21x15
- ⑥ **DETOUR** M4-8 24x12
WEST
71
M3-4 24x12
M6-1 21x15
*ONLY AT NORTH LEG OF INTERSECTION.
- ⑦ **DETOUR** M4-8 24x12
M1-I100 24x24
71
M5-1 21x15
- ⑧ **STATE PARKS**
STARVED ROCK 3
MATTHIESSEN 5
BUFFALO ROCK 8
ROAD TO PARKS OPEN SEE "SIGN DETAIL"
- ⑨ **STATE PARKS**
← STARVED ROCK
← BUFFALO ROCK
← MATTHIESSEN
ROAD TO PARKS OPEN SEE "SIGN DETAIL"
- ⑩ **STATE PARKS**
↑ STARVED ROCK
↑ BUFFALO ROCK
↑ MATTHIESSEN
ROAD TO PARKS OPEN SEE "SIGN DETAIL"
- ⑪ **STATE PARKS**
STARVED ROCK →
BUFFALO ROCK →
MATTHIESSEN →
ROAD TO PARKS OPEN SEE "SIGN DETAIL"

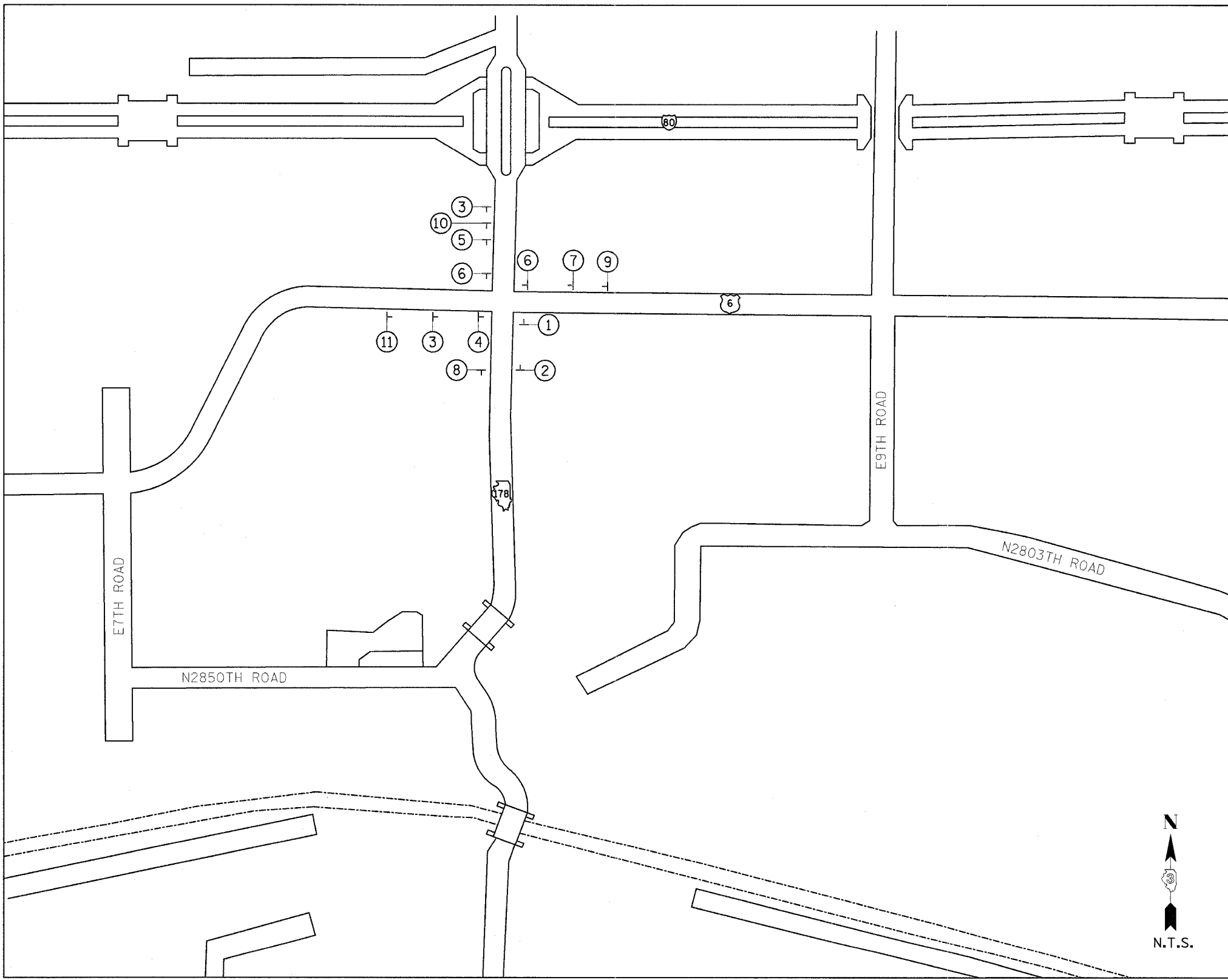

SIGN DETAIL
SIGN PANEL - TYPE 1

NOTES:

- 1.) AREA = 5.25 SQ. FT.
- 2.) TOTAL AREA REQUIRED (4-SIGNS) = 21.0 SQ. FT.
- 3.) 4" SERIES C LETTERS
- 4.) LEGEND = BLACK
- 5.) BACKGROUND = ORANGE

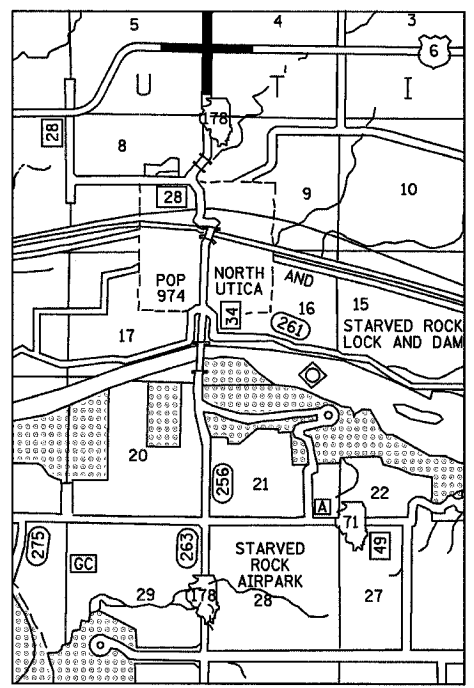

LOCATION MAP

JUNCTION IL 178 & US 6

GENERAL NOTES:

- 1.) ONLY SIGNS THAT ARE TO BE CHANGED OR ADDED ARE SHOWN ON THIS MAP.
- 2.) ALL SIGNS TO BE POST MOUNTED.

DETOUR MAP

IL ROUTE 71
OVER TRIBUTARY TO ILLINOIS RIVER
F.A.P. ROUTE 627 - SEC. (I-1) BR & I
LA SALLE COUNTY

DESIGNED BY MSW	 2706 McGraw Drive Bloomington, Illinois 61704 309/893-6436, 309/893-5871 fax	FILE NO. 24-6772
DRAWN BY DJM		DATE 05/12/06
CHECKED BY MSW		SHEET NO. 22 OF 106