

F.A.P. R.T.E.	SECTION	COUNTY	TOTAL SHEETS	SHEET NO.
627	(1-1) BR & I	LA SALLE	106	24
STA.	TO STA.			
FED. ROAD DIST. NO.	ILLINOIS FED. AID PROJECT			

LEGEND

- XXXX TO BE COVERED
- FLASHING LIGHT
- ◇ 18"x8" ORANGE FLAG
- TT TYPE III BARRICADE
- DIRECTION ARROW CHANGE

1. [Sign: 71] M1-I100 24x24
2. [Sign: DETOUR WEST] M3-4 24x12, M4-8 24x12, M5-1 21x15, M1-I100 24x24
3. [Sign: ROAD CLOSED 7 MILES AHEAD LOCAL TRAFFIC ONLY, DETOUR USE US 6 AND ILL 178] M1-I100 24x24, R11-3a 60x30
4. [Sign: 71]
5. [Sign: DETOUR] M4-8 24x12, M1-I100 24x24
6. [Sign: ROAD CLOSED 7 MILES AHEAD LOCAL TRAFFIC ONLY, DETOUR] M1-I100 24x24, R11-3a 60x30, M4-10 48x18
7. [Sign: DETOUR] M4-8 24x12, M1-I100 24x24, M6-3 21x15
8. [Sign: DETOUR AHEAD] W20-2 36x36
9. [Sign: ROAD CLOSED 7 MILES AHEAD LOCAL TRAFFIC ONLY, DETOUR USE US 6 AND ILL 178] M1-I100 24x24, R11-3a 60x30

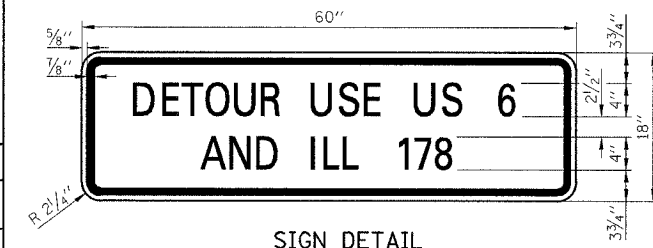
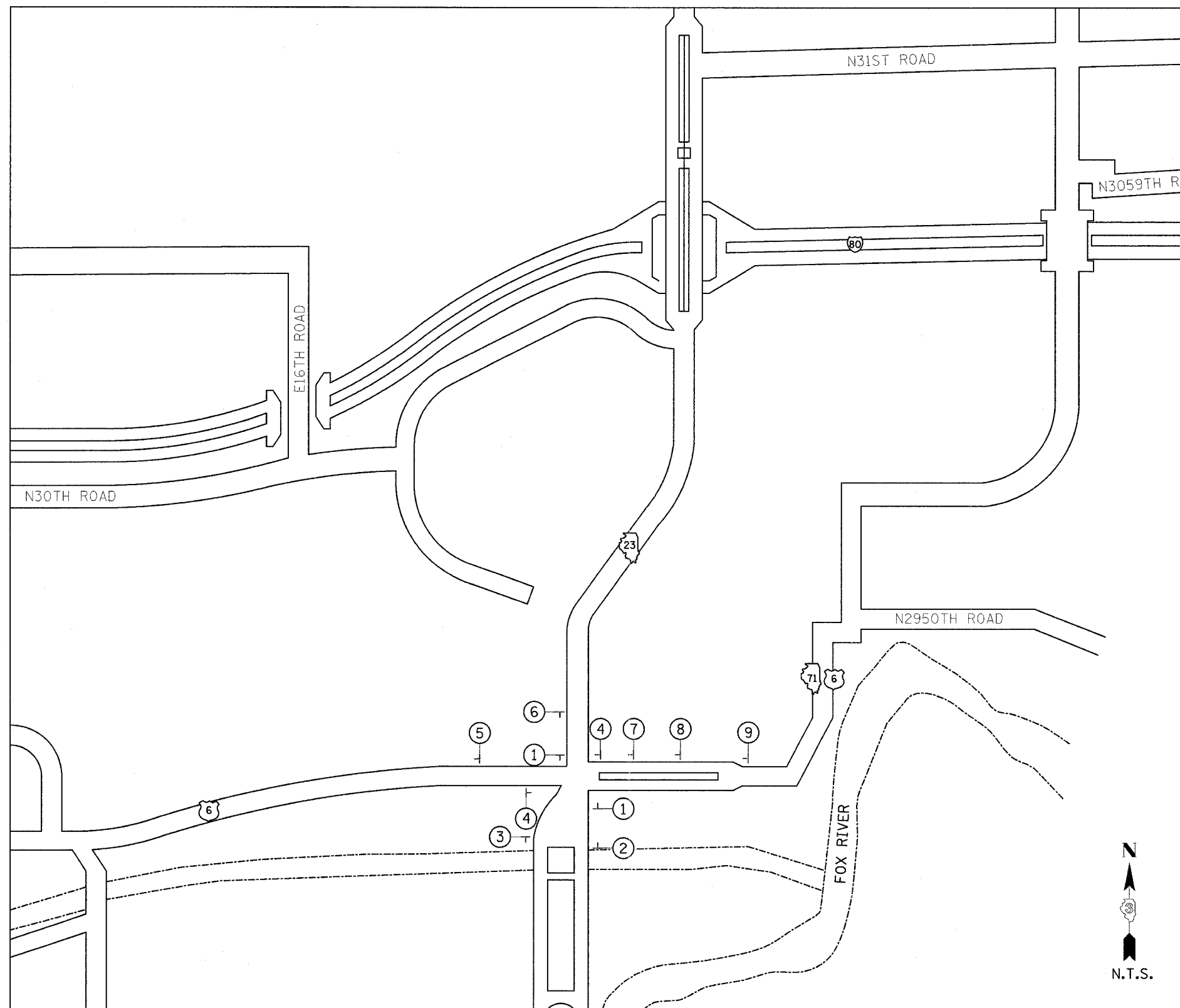

SIGN DETAIL
SIGN PANEL - TYPE 1

NOTES:

- 1.) AREA REQUIRED = 7.5 SQ. FT.
- 2.) TOTAL AREA (2-SIGNS) = 15.0 SQ. FT.
- 3.) 4" SERIES C LETTERS
- 4.) LEGEND = BLACK
- 5.) BACKGROUND = ORANGE

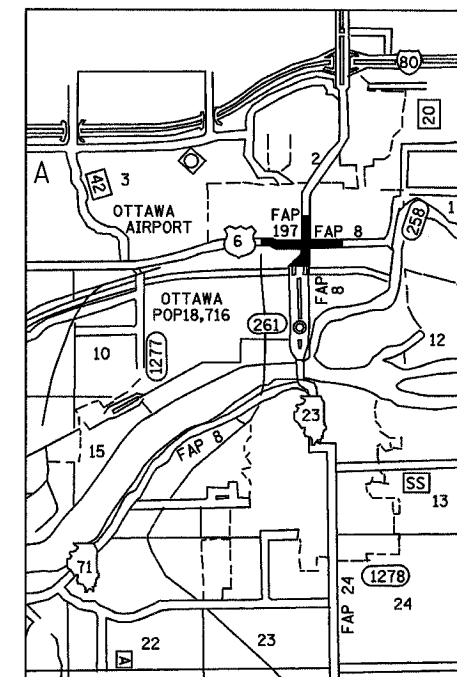

LOCATION MAP

DETOUR MAP

IL ROUTE 71
OVER TRIBUTARY TO ILLINOIS RIVER
F.A.P. ROUTE 627 - SEC. (1-1) BR & I
LA SALLE COUNTY

JUNCTION IL 23 & US 6

GENERAL NOTES:

- 1.) ONLY SIGNS THAT ARE TO BE CHANGED OR ADDED ARE SHOWN ON THIS MAP.
- 2.) ALL SIGNS TO BE POST MOUNTED.

DESIGNED BY MSW	 2700 McGrand Drive Bloomington, Illinois 61704 309/898-6436, 309/898-1871 fax	FILE NO. 24-6772
DRAWN BY D.J.M.		DATE 05/12/06
CHECKED BY MSW		SHEET NO. 24 OF 106