

Benchmarks: 1.) Top of guardrail post on the South side of IL Rte. 71 @ back center of the 10th post East from the West end of the rail @ Station 400+80.31/14.61' RT., Elevation = 581.01.
 2.) Top of guardrail post on the South side of IL Rte. 71 @ back center of the 10th post West from the East end of the rail @ Station 396+93.99/15.57' RT., Elevation = 579.55.

Existing Structure: Culvert No. 7, built 1922, Section I-1 At Station 393+00.00 and carries F.A.P. 627 (IL 71) over tributary to Illinois River. Consists of a single barrel 10'x6' reinforced concrete box culvert with wingwalls parallel to the roadway and the out to out headwall length = 60'-0". Traffic will be maintained during construction via detour routes.

No Salvage.

F.A.P. RTE.	SECTION	COUNTY	TOTAL SHEETS	SHEET NO.
627	(I-1) BR & I	LA SALLE	106	29
STA. TO STA.				
FED. ROAD DIST. NO.			ILLINOIS FED. AID PROJECT	

SHEET NO. A1
OF 6 SHEETS

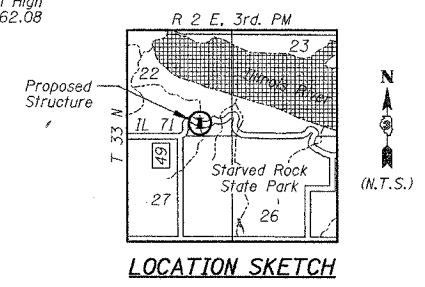
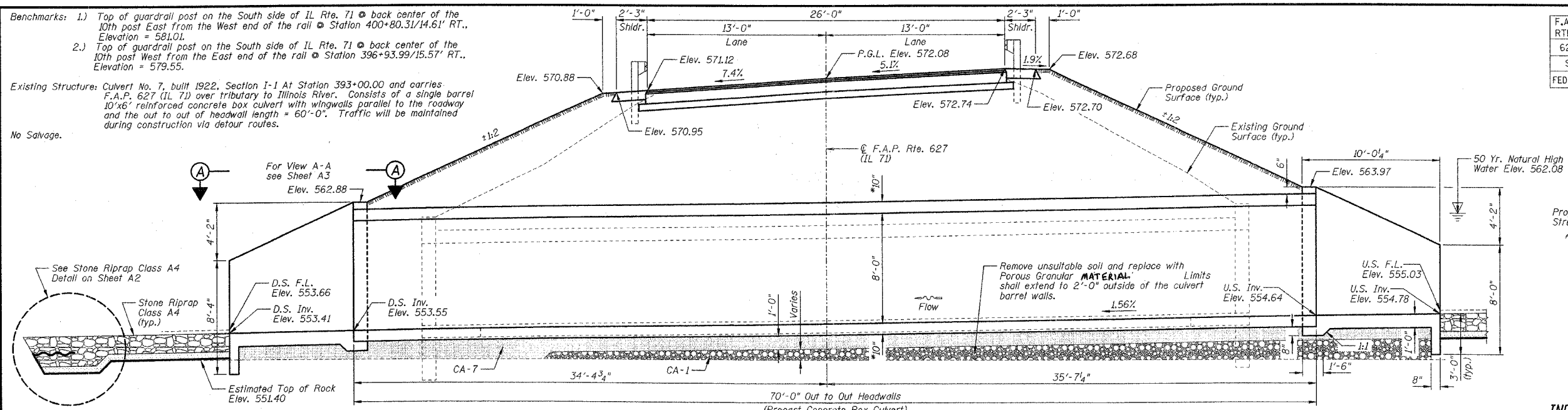

INDEX TO SHEETS

SHEET NO.	TITLE
A1	GENERAL PLAN AND ELEVATION
A2	10'x8' PRECAST CONCRETE BOX CULVERT SECTION, DETAILS, GENERAL NOTES AND BILL OF MATERIALS
A3	CAST-IN-PLACE APRON VIEW, ELEVATION, SECTIONS AND DETAILS
A4-A5	SOIL BORING LOGS
A6	EXISTING PLANS

HORIZONTAL CURVE DATA

P.I. STA. = 393+07.74
 Δ = 39°22'
 D = 09°21'
 R = 612.82'
 T = 219.19'
 L = 421.01'
 E = 38.02'
 S.E. = 0.074'/ft. & 0.051'/ft.
 P.C. STA. = 390+88.55
 P.T. STA. = 395+09.56

DESIGN SPECIFICATIONS

AASHTO 2002
LOADING HS20-44
 Allow 50#/sq. ft. for future wearing surface.

DESIGN STRESSES

FIELD UNITS
 f'c = 3,500 psi (Cast-in-Place)
 fy = 60,000 psi (Reinforcement)

PRECAST UNITS
 f'c = 5,000 psi (Precast Concrete)
 fy = 65,000 psi (Welded Wire Fabric)

LONGITUDINAL SECTION
 (Looking East @ C of Culvert)

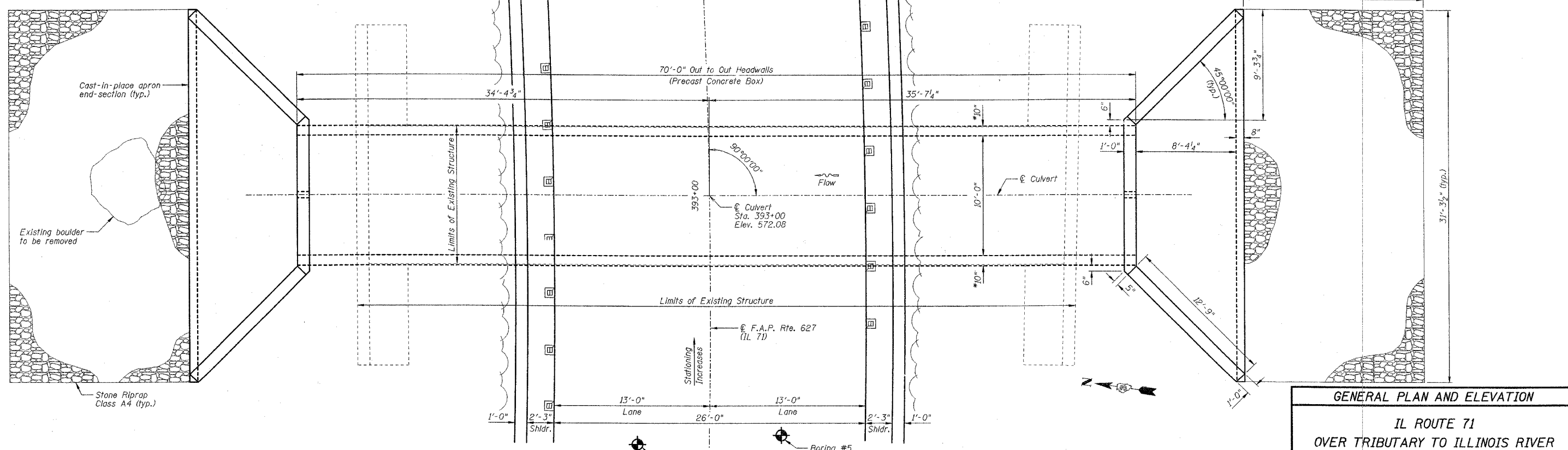
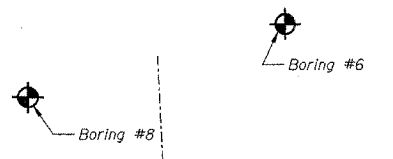

GENERAL PLAN AND ELEVATION

IL ROUTE 71
 OVER TRIBUTARY TO ILLINOIS RIVER
 F.A.P. ROUTE 627 - SEC. (I-1) BR & I
 LA SALLE COUNTY
 STATION 393+00.00

- NOTES:
- 1.) Work this sheet with Sheets A2 and A3.
 - 2.) *Confirm slab and wall thickness with precaster.
 - 3.) P.G.L. denotes Profile Grade Line.

DESIGNED BY J.M.L.
 DRAWN BY D.J.M.
 CHECKED BY M.S.W.

Farnsworth GROUP
 2709 McGraw Drive
 Bloomington, Illinois 61704
 309/663-3436, 309/663-1671 fax

FILE NO. 24-6772
 DATE 05-12-06
 SHEET NO. 29 OF 106