

F.A.U. NO.	SECTION	COUNTY	TOTAL SHEETS
627	(I-D) BR & I	LA SALLE	106
STA. 462+24.35		TO STA. 462+31	
FED. ROAD DIST. NO. 7 ILLINOIS FED. AID PROJECT			

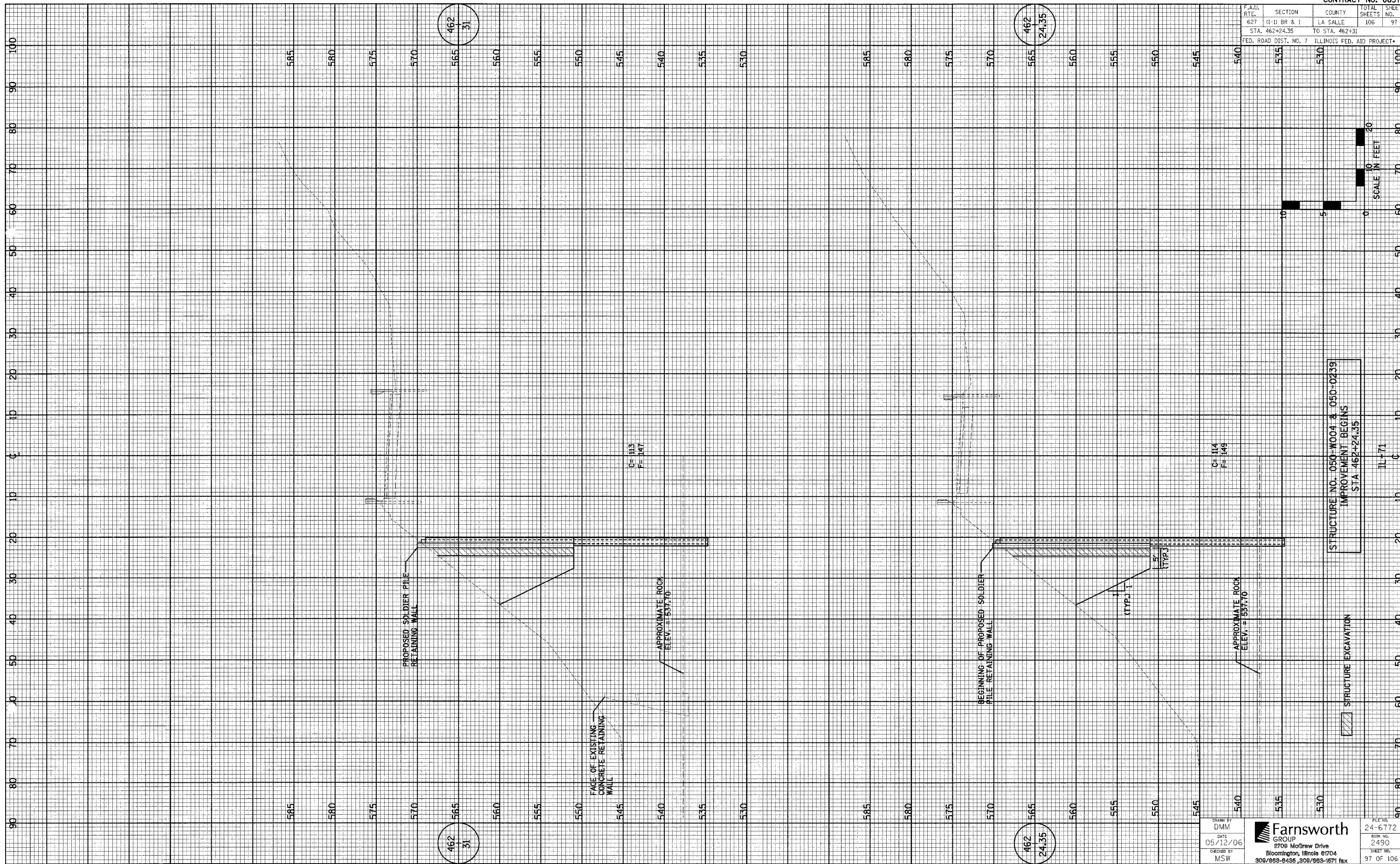

STRUCTURE NO. 050-W004 & 050-0239  
IMPROVEMENT BEGINS  
STA. 462+24.35

IL-71

STRUCTURE EXCAVATION

DRAWN BY  
DMM  
DATE  
05/12/06  
CHECKED BY  
MSW

**Farnsworth GROUP**  
2706 McGraw Drive  
Bloomington, Illinois 61704  
309/883-8435, 309/863-1671 fax

FILE NO.  
24-6772  
BOOK NO.  
2490  
SHEET NO.  
97 OF 106