

F.A.P. RTE.	SECTION	COUNTY	TOTAL SHEETS	SHEET NO.
330	*	KANKAKEE	24	20

* (11X-2)RS-1 & (11,1)RS-4

MATCH LINE STA. 239+00

N.B. I-57

MATCH LINE STA. 244+00

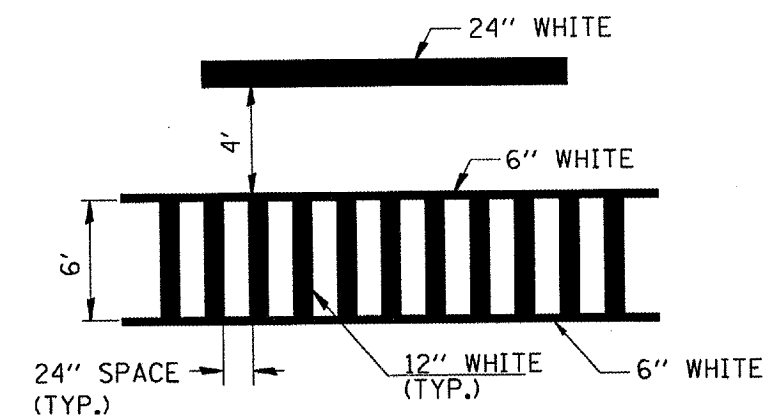
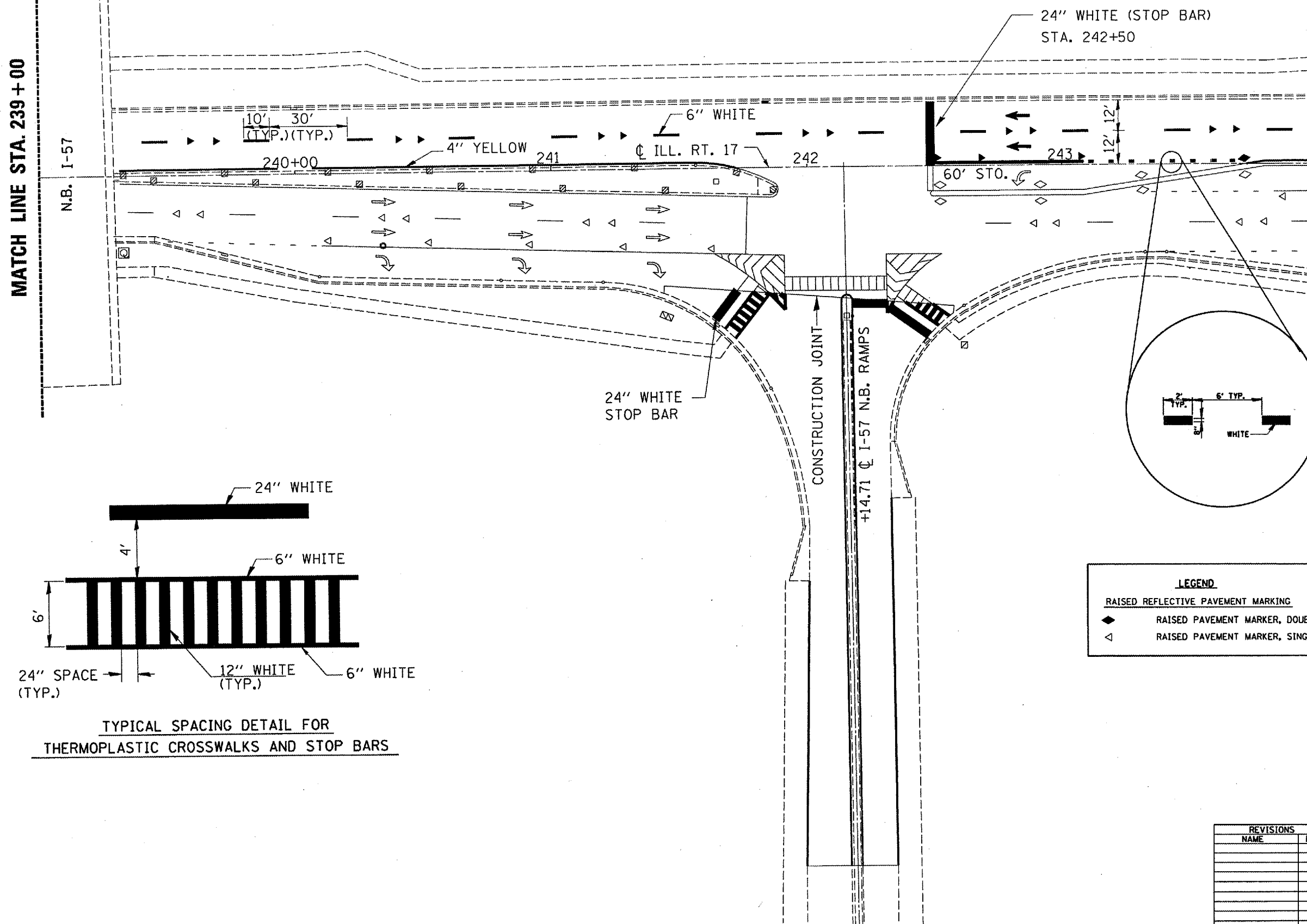
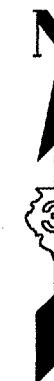

TYPICAL SPACING DETAIL FOR THERMOPLASTIC CROSSWALKS AND STOP BARS

LEGEND

RAISED REFLECTIVE PAVEMENT MARKING

- ◆ RAISED PAVEMENT MARKER, DOUBLE YELLOW
- ◁ RAISED PAVEMENT MARKER, SINGLE WHITE

REVISIONS	
NAME	DATE

ILLINOIS DEPARTMENT OF TRANSPORTATION

PAVEMENT MARKING

F.A.P. ROUTE 330 (IL ROUTE 17)

SECTION (11X-2)RS-1 & (11,1)RS-4

KANKAKEE COUNTY

DATE: 06/27/2006
c:/projects/main07/cm305/details.dgn