

F.A.P. RTE.	SECTION	COUNTY	TOTAL SHEETS	SHEET NO.
330	*	KANKAKEE	24	21

\* (11X-2)RS-1 & (11,1)RS-4

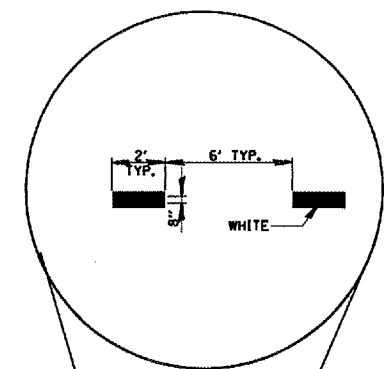

END PROJECT  
 EQUATION: =  
 STA 249+19.06 BK =  
 STA 3+83.36 AH

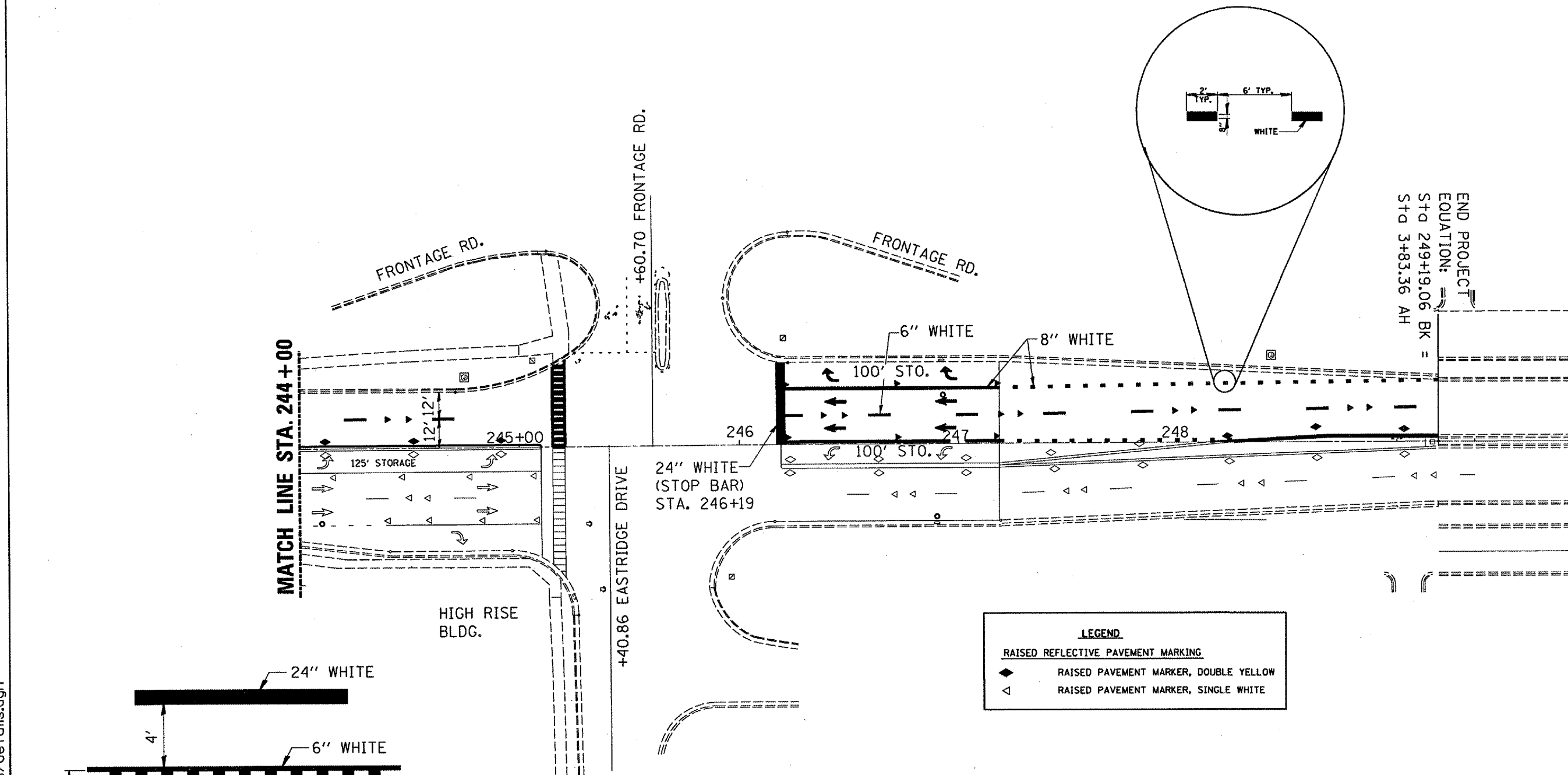

**LEGEND**

**RAISED REFLECTIVE PAVEMENT MARKING**

- ◆ RAISED PAVEMENT MARKER, DOUBLE YELLOW
- ◁ RAISED PAVEMENT MARKER, SINGLE WHITE

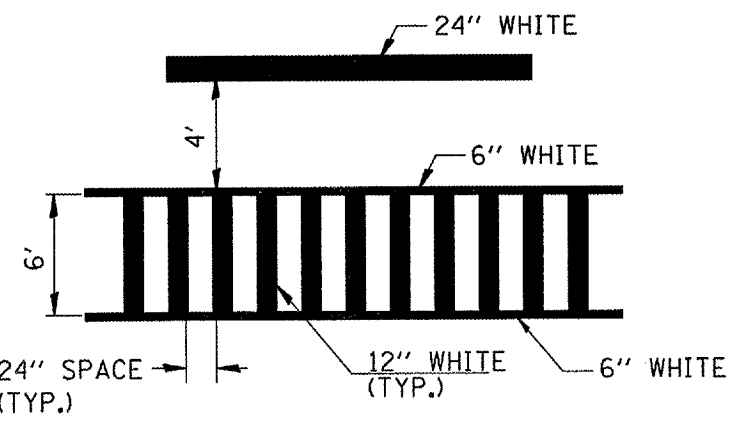

TYPICAL SPACING DETAIL FOR THERMOPLASTIC CROSSWALKS AND STOP BARS

REVISIONS	
NAME	DATE

ILLINOIS DEPARTMENT OF TRANSPORTATION

**PAVEMENT MARKING**

F.A.P. ROUTE 330 (IL ROUTE 17)  
 SECTION (11X-2)RS-1 & (11,1)RS-4  
 KANKAKEE COUNTY

DATE: 06/27/2006  
 c:/projects/cmain07/cm305/details.dgn