

ROUTE		SECTION	COUNTY	SHEET	
MKD.	FAP	D-4 PAVT. MARKING 2007	PEORIA	TOTAL	NO.
US 150	317			15	9

D-94-111-06
CONTRACT NO. 68642

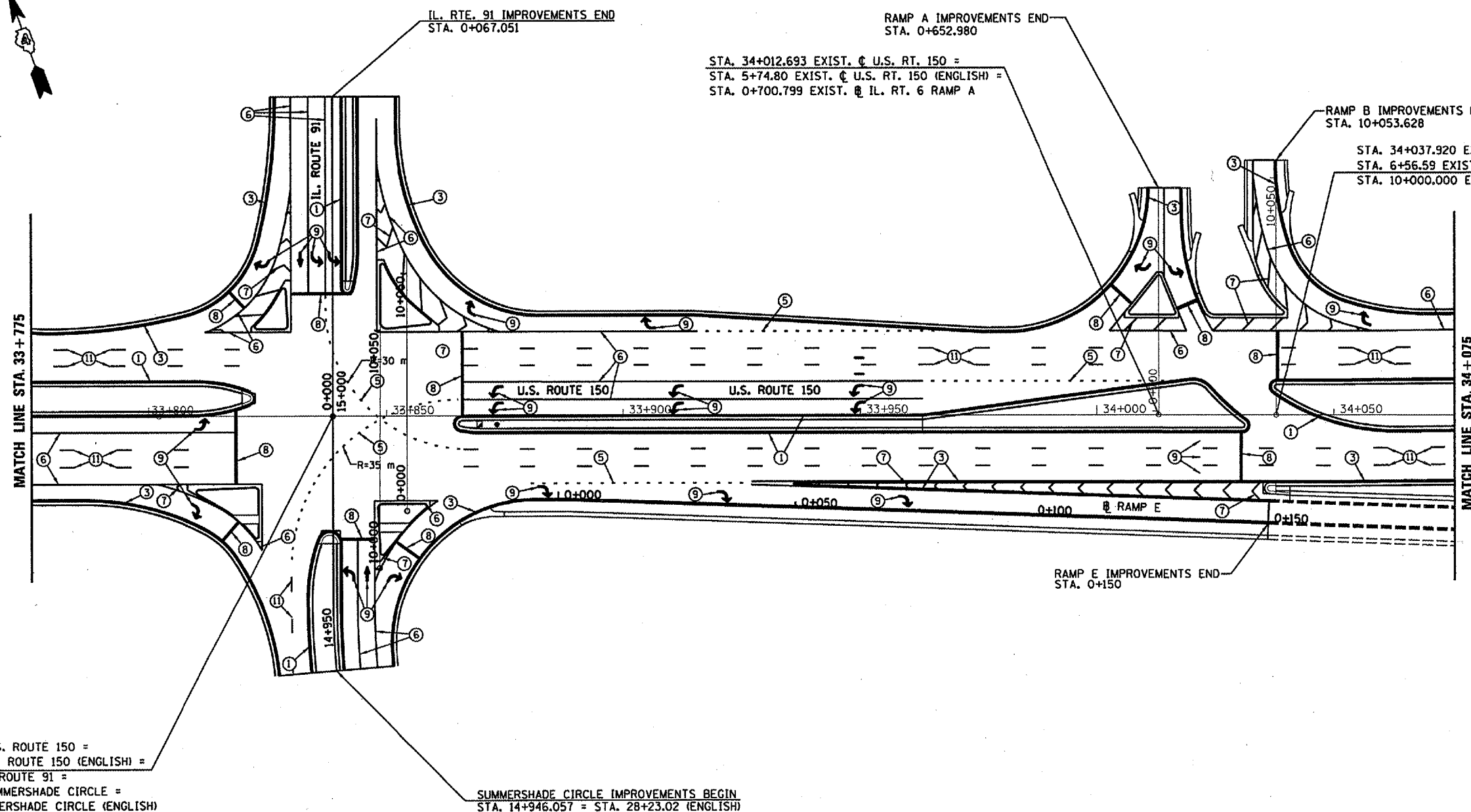

STA. 33+838.694 EXIST. @ U.S. ROUTE 150 =
 STA. 200+02.96 EXIST. @ U.S. ROUTE 150 (ENGLISH) =
 STA. 0+000.000 PROP. @ IL. ROUTE 91 =
 STA. 15+000.000 PROP. @ SUMMERSHADE CIRCLE =
 STA. 30+00.00 PROP. @ SUMMERSHADE CIRCLE (ENGLISH)

SUMMERSHADE CIRCLE IMPROVEMENTS BEGIN
 STA. 14+946.057 = STA. 28+23.02 (ENGLISH)

PAVEMENT MARKING LEGEND

- ① PREFORMED PLASTIC PAVEMENT MARKING - LINE 4" YELLOW SOLID
- ② PREFORMED PLASTIC PAVEMENT MARKING - LINE 4" YELLOW SOLID (DOUBLE LINE)
- ③ PREFORMED PLASTIC PAVEMENT MARKING - LINE 4" WHITE SOLID
- ④ PREFORMED PLASTIC PAVEMENT MARKING - LINE 4" YELLOW SKIP DASH
- ⑤ PREFORMED PLASTIC PAVEMENT MARKING - LINE 8" WHITE SKIP DASH
- ⑥ PREFORMED PLASTIC PAVEMENT MARKING - LINE 8" WHITE SOLID
- ⑦ PREFORMED PLASTIC PAVEMENT MARKING - LINE 12" WHITE SOLID
- ⑧ PREFORMED PLASTIC PAVEMENT MARKING - LINE 24" WHITE SOLID (STOP BAR)
- ⑨ PREFORMED PLASTIC PAVEMENT MARKING - LETTERS AND SYMBOLS
- ⑩ PREFORMED PLASTIC PAVEMENT MARKING - LINE 12" YELLOW SOLID
- ⑪ PREFORMED PLASTIC PAVEMENT MARKING - LINE 6" WHITE SKIP DASH

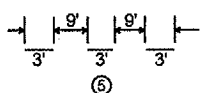
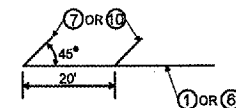
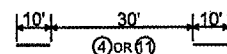

ILLINOIS DEPARTMENT OF TRANSPORTATION

**PAVEMENT
MARKING
DETAIL**