

STATE OF ILLINOIS  
DEPARTMENT OF TRANSPORTATION

ROUTE NO.	SECTION	COUNTY	TOTAL SHEETS	SHEET NO.	SHEET NO. 5
F.A.P. 717	(111B)BR	DEWITT	53	25	16 SHEETS
FED. ROAD DIST. NO. 7	ILLINOIS	FED. AID PROJECT			

Contract #70387

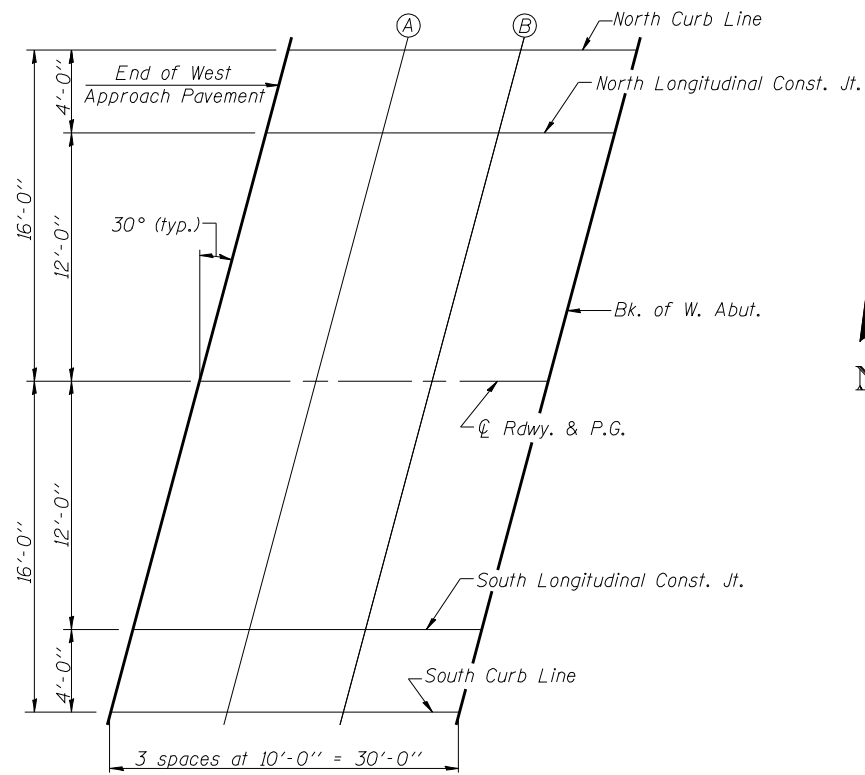

**PLAN**  
(West Approach)

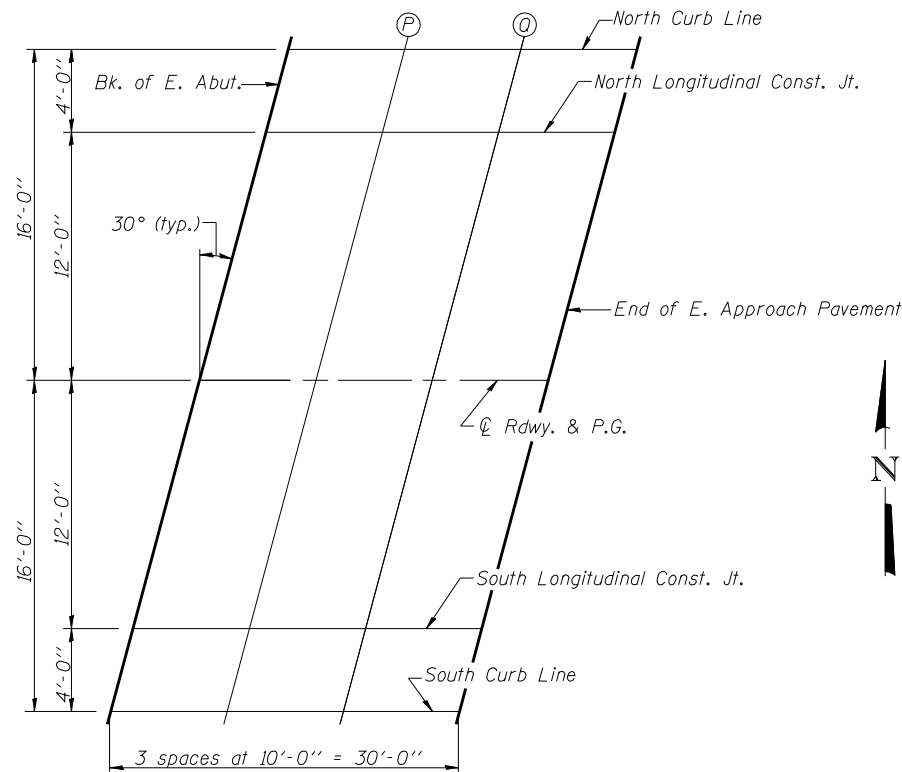

**PLAN**  
(East Approach)

DESIGNED	Stephen M. Ryan
CHECKED	Angela J. Bryant
DRAWN	R. Sommer
CHECKED	S.M.R./F.T.

EXAMINED	September 29, 2006	Thomas J. Domagalaki	ENGINEER OF BRIDGE DESIGN
PASSED		Ralph E. Anderson	ENGINEER OF BRIDGES AND STRUCTURES

**NORTH CURB LINE**

Location	Station	Offset	Theoretical Grade Elevations	Theoretical Grade Elevations Adjusted For Grinding
End W Approach Pvm	106853.24	-16.00	694.19	694.21
A	106863.24	-16.00	694.20	694.22
B	106873.24	-16.00	694.22	694.24
Bk W Abut	106883.24	-16.00	694.23	694.25
Bk E Abut	107043.24	-16.00	694.40	694.42
P	107053.24	-16.00	694.41	694.43
Q	107063.24	-16.00	694.42	694.44
End E Approach Pvm	107073.24	-16.00	694.44	694.46

**SOUTH LONGITUDINAL CONSTRUCTION JOINT**

Location	Station	Offset	Theoretical Grade Elevations	Theoretical Grade Elevations Adjusted For Grinding
End W Approach Pvm	106837.07	12.00	694.26	694.28
A	106847.07	12.00	694.27	694.29
B	106857.07	12.00	694.28	694.30
Bk W Abut	106867.07	12.00	694.29	694.31
Bk E Abut	107027.07	12.00	694.47	694.49
P	107037.07	12.00	694.48	694.50
Q	107047.07	12.00	694.49	694.51
End E Approach Pvm	107057.07	12.00	694.50	694.52

**NORTH LONGITUDINAL CONSTRUCTION JOINT**

Location	Station	Offset	Theoretical Grade Elevations	Theoretical Grade Elevations Adjusted For Grinding
End W Approach Pvm	106850.93	-12.00	694.27	694.29
A	106860.93	-12.00	694.28	694.30
B	106870.93	-12.00	694.30	694.32
Bk W Abut	106880.93	-12.00	694.31	694.33
Bk E Abut	107040.93	-12.00	694.48	694.50
P	107050.93	-12.00	694.49	694.51
Q	107060.93	-12.00	694.50	694.52
End E Approach Pvm	107070.93	-12.00	694.52	694.54

**SOUTH CURB LINE**

Location	Station	Offset	Theoretical Grade Elevations	Theoretical Grade Elevations Adjusted For Grinding
End W Approach Pvm	106834.76	16.00	694.17	694.19
A	106844.76	16.00	694.18	694.20
B	106854.76	16.00	694.19	694.21
Bk W Abut	106864.76	16.00	694.21	694.23
Bk E Abut	107024.76	16.00	694.38	694.40
P	107034.76	16.00	694.39	694.41
Q	107044.76	16.00	694.40	694.42
End E Approach Pvm	107054.76	16.00	694.41	694.43

**Centerline ROADWAY & P.G.**

Location	Station	Offset	Theoretical Grade Elevations	Theoretical Grade Elevations Adjusted For Grinding
End W Approach Pvm	106844.00	0.00	694.45	694.47
A	106854.00	0.00	694.46	694.48
B	106864.00	0.00	694.48	694.50
Bk W Abut	106874.00	0.00	694.49	694.51
Bk E Abut	107034.00	0.00	694.66	694.68
P	107044.00	0.00	694.67	694.69
Q	107054.00	0.00	694.68	694.70
End E Approach Pvm	107064.00	0.00	694.70	694.72

**BRIDGE APPROACH**  
**TOP OF SLAB ELEVATIONS**  
**F.A.P. RT. 717 SEC. (111B)BR**  
**DEWITT COUNTY**  
**STATION 1069+54.00**  
**STRUCTURE NO. 020-0063**