

F.A.P. RTE	SECTION	COUNTY	TOTAL SHEETS	SHEET NO.
329	126BR-1	RANDOLPH	27	2
STA.		TO STA.		

CONTRACT NO. 76898

INDEX OF SHEETS

1. COVER SHEET
2. GENERAL NOTES AND BUTT JOINT DETAIL
- 3.-4. SUMMARY OF QUANTITIES
5. TYPICAL SECTIONS
6. TIE POINTS AND SECHEDULES
7. PLAN AND ELEVATION
8. DETOUR SIGNING SHEET
9. STAGE 1 SHEET
10. WIDE LOAD SIGNING SHEET
- 11.-12. STAGE 2 AND 3 SHEET
- 13.-14. CROSS SECTIONS
- 15.-27. BRIDGE PLANS S.N. 079-0016

GENERAL NOTES:

1. THE STANDARDS AND REVISION NUMBERS SHALL APPLY TO THIS PROJECT.
2. THE CONTRACTOR SHALL VERIFY ALL DIMENSIONS AND CONDITIONS IN THE FIELD PRIOR TO CONSTRUCTION AND ORDERING MATERIALS.
3. ILLINOIS STATE LAW REQUIRES A 48-HOUR NOTICE BE GIVEN TO UTILITIES WITHIN THE PROJECT AREA BEFORE DIGGING BY CALLING J.U.L.I.E. AND BY NOTIFYING NON-J.U.L.I.E. MEMBERS INDIVIDUALLY. AGENCIES KNOWN TO HAVE FACILITIES WITHIN THE PROJECT AREA ARE AS FOLLOWS:
 •EGYPTIAN TELEPHONE COOP. ASSN.
 •VILLAGE OF SPARTA
 •VERIZON NORTH, INC.
 •AMEREN IP
 MEMBERS OF J.U.L.I.E. (800) 892-0122 ARE INDICATED BY •. NON-MEMBERS MUST BE NOTIFIED INDIVIDUALLY.
4. SAW CUTTING ON ALL EDGES FOR REMOVAL ITEMS SHALL BE INCLUDED IN THE COST OF THE REMOVAL ITEM AS INDICATED AND ACCORDING TO SECTION 440 OF THE STANDARD SPECIFICATIONS.
5. THE THICKNESS OF THE BITUMINOUS MIXTURES SHOWN ON THE PLANS IS THE NOMINAL THICKNESS. DEVIATIONS MAY OCCUR DUE TO IRREGULARITIES IN THE EXISTING SURFACE OR BASE ON WHICH THE BITUMINOUS MIXTURE IS PLACED.
6. THE EXISTING BEAMS SHALL BE CAREFULLY REMOVED AND DISPOSED OF OUTSIDE OF THE JOB SITE.
7. THE COST OF THE BRIDGE RAIL REMOVAL SHALL BE INCLUDED IN THE COST OF REMOVAL OF THE EXISTING SUPERSTRUCTURE.
8. PRIOR TO INSTALLATION OF THE DETOUR, THE ENGINEER SHALL DOCUMENT THE CONDITION OF THE EXISTING ROAD. UPON REMOVAL OF THE DETOUR, THE ENGINEER SHALL COORDINATE WITH THE COUNTY ENGINEER TO DETERMINE ANY PATCHING, IF NECESSARY. THE CONTRACTOR SHALL PLACE ALL PATCHING IN AREAS DESIGNATED BY THE ENGINEER. THE COST OF THIS WORK WILL BE PAID AS DESIGNATED IN THE PATCHING SCHEDULE.
9. WIDE LOAD SIGNING WILL BE PROVIDED BY IDOT.
10. THE ENGINEER WILL SPECIFY THE LOCATION OF THE CHANGEABLE MESSAGE SIGNS AND THE MESSAGE TO BE PLACED ON THEM.
11. THE WIDTHS OF BITUMINOUS SURFACE REMOVAL SHOWN ON THE PLANS ARE THE NOMINAL WIDTHS. IRREGULARITIES IN THE SURFACE WIDTH MAY OCCUR THROUGHOUT THE LENGTH OF THE SECTION. BITUMINOUS SURFACE REMOVAL WILL BE PAID FOR IN SQUARE YARDS BASED UPON THE NOMINAL WIDTHS INDICATED.
12. FILL ANY EXISTING DOWEL BAR HOLES WITH NON-SHRINK GROUT WHERE THE BARS PULL OUT. THE COST IS INCLUDED WITH THE REMOVAL OF EXISTING SUPERSTRUCTURE.
13. THE END SECTION OF THE BARRIER SHALL BE PINNED IN ALL SIX HOLES.
14. THE MESSAGE BOARDS SHALL BE PLACED A MINIMUM OF 14 DAYS PRIOR TO THE CLOSURE.
15. A QUANTY OF 1020 FEET OF TEMPORARY PAVEMENT MARKING LINE 6" HAS BEEN INCLUDED TO PAINT THE BOTTOM OF THE CONCRETE BARRIER.

EROSION AND SEDIMENT CONTROL PLAN

1. PLANS INCLUDE ESTIMATED QUANTITIES FOR TEMPORARY EROSION AND SEDIMENT CONTROL. THESE ARE WORST CASE ESTIMATES. DISTURBANCE OF AREAS BEYOND THE LIMITS OF ACTUAL IMPROVEMENT IS TO BE HELD TO A MINIMUM.
2. TEMPORARY SEEDING AND MULCH SHALL BE COMPLETED ON A WEEKLY BASIS ON EXPOSED GROUND AND SHALL BE IN ACCORDANCE WITH SECTION 280 OF THE STANDARD SPECIFICATIONS EXCEPT THAT MULCH AND TEMPORARY SEEDING SHALL BE PAID FOR AS TEMPORARY EROSION CONTROL SEEDING AND NO OTHER PAYMENT WILL BE PERMITTED.
3. ALL AREAS DISTURBED FOR ANY REASON SHALL BE SEEDED WITH CLASS 2 SEEDING AS DIRECTED BY THE ENGINEER. NUTRIENTS SHALL CONFORM TO ARTICLE 250.04 EXCEPT FERTILIZER NUTRIENTS WILL NOT BE PAID FOR SEPARATELY AS INCLUDED IN THE COST OF CLASS 2 SEEDING.
4. ALL EROSION CONTROL PRODUCTS FURNISHED SHALL BE SPECIFICALLY RECOMMENDED BY THE MANUFACTURER FOR THE USE SPECIFIED IN THE EROSION CONTROL PLAN. PRIOR TO APPROVAL AND USE OF THE PRODUCT, THE CONTRACTOR SHALL SUBMIT TO THE ENGINEER A NOTARIZED CERTIFICATION BY THE PRODUCER STATING THE INTENDED USE OF THE PRODUCT AND THAT THE PHYSICAL PROPERTIES REQUIRED FOR THIS APPLICATION ARE MET OR EXCEEDED. THE CONTRACTOR SHALL PROVIDE MANUFACTURER RECOMMENDED INSTALLATION PROCEDURES TO FACILITATE THE ENGINEER IN CONSTRUCTION INSPECTION.
5. EARTH STOCKPILES SHALL BE TEMPORARILY SEEDED IF THEY ARE TO REMAIN UNUSED FOR MORE THAN FOURTEEN DAYS.
6. FINAL SEEDING SHALL BE PERFORMED AS SOON AS POSSIBLE.

HIGHWAY STANDARDS

000001-04	635011-01
001001	701006-02
001006	701011-01
442201-01	701201-02
515001-02	701321-08
630001-06	702001-06
630301-03	704001-02
631032-02	780001-01
635006-02	781001-02
	B.L.R. 21-6

COMMITMENTS

1. THE BRIDGE WILL BE CLOSED AND A DETOUR IN PLACE FOR STAGE I CONSTRUCTION. THIS DETOUR IS LIMITED TO A MAXIMUM 7 DAYS, AND SHALL NOT INTERFERE WITH ANY SIGNIFICANT PLANNED EVENT AT THE WORLD SHOOTING COMPLEX, E.G. THE GRAND AMERICAN.
2. THE DEPARTMENT WILL NOTIFY MR. AND MRS. WILLIAM BOYD 2 WEEKS PRIOR TO THE CLOSURE OF THEIR ENTRANCE AT STATION 722+00± LEFT. AT THAT TIME THE DEPARTMENT WILL ADVISE THEM OF THE DATES THE CLOSURE WILL BE IN EFFECT.

TRANSITION DETAIL

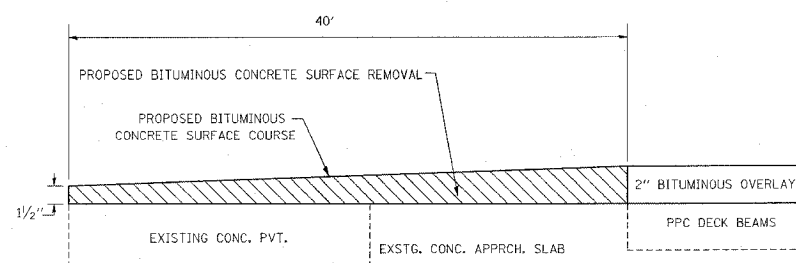

MIXTURE USE	SURFACE	LEVELING BINDER	PARTIAL DEPTH PATCH	SHOULDERS	TOP LEFT SHOULDERS	BINDER/PATCH
AC/PG	PG 64-22	PG 64-22	PG 64-22	PG 58-22	PG 58-22	PG 64-22
RAP % (MAX)	10%	15%	10%	30%	30%	150%
DESIGN AIR VIODS	4% @ Ndes=70	4% @ Ndes=70	4% @ Ndes=70	2% @ Ndes=30	2% @ Ndes=30	4% @ Ndes=70
MIX COMPOSITION (GRADATION MIXTURE)						IL 19.0
FRICTION AGG	MIXTURE "C"	MIXTURE "C"	MIXTURE "C"	BAM	BAM	MIXTURE "B"

REVISIONS	
NAME	DATE

ILLINOIS DEPARTMENT OF TRANSPORTATION
**INDEX OF SHEETS, GEN. NOTES,
 & STANDARDS**
 FAP ROUTE 329 (IL 154)
 SECTION 126BR-1
 RANDOLPH COUNTY

Rev. 10-23-06

PLOT DATE = 10/28/2006
 FILE NAME = c:\pwworkspace\126BR1\126BR1.dgn
 PLOT SCALE = 50.0000 / IN.
 USER NAME = millterra

F.A.P. RTE.	SECTION	COUNTY	TOTAL SHEETS	SHEET NO.
329	126BR-1	RANDOLPH	27	4

STA. TO STA.
CONTRACT NO. 76898

SUMMARY OF QUANTITIES

SUMMARY OF QUANTITIES			80% FED. 20% STATE TOTAL QUANTITIES	CONSTRUCTION TYPE CODE	
CODE NO	ITEM	UNIT		BRIDGE X080-2A SN 079-0016	SFTY-3N
70301000	WORK ZONE PAVEMENT MARKING REMOVAL	SQ FT	1998	1998	
70400100	TEMPORARY CONCRETE BARRIER	FOOT	510	510	
70400200	RELOCATE TEMPORARY CONCRETE BARRIER	FOOT	510	510	
* 78000200	THERMOPLASTIC PAVEMENT MARKING - LINE 4"	FOOT	667	667	
* 78100100	RAISED REFLECTIVE PAVEMENT MARKER	EACH	2	2	
* 78200410	GUARDRAIL MARKERS, TYPE A	EACH	16	16	
* 78200530	BARRIER WALL MARKERS, TYPE C	EACH	4	4	
* 78201000	TERMINAL MARKER - DIRECT APPLIED	EACH	4	4	
78300100	PAVEMENT MARKING REMOVAL	SQ FT	539	539	
78300200	RAISED REFLECTIVE PAVEMENT MARKER REMOVAL	EACH	2	2	
X0320047	REMOVAL OF EXISTING PRECAST PRESTRESSED CONCRETE DECK BEAMS	SQ FT	151	151	
X0324952	DETOUR SIGNING	L SUM	1	1	
X0325305	STRUCTURAL REPAIR OF CONCRETE (DEPTH EQUAL TO OR LESS THAN 5 INCHES)	SQ FT	302	302	
X0656180	PARTIAL DEPTH PATCHING (SPECIAL)	SQ YD	733	733	
X4066416	BITUMINOUS CONCRETE SURFACE COURSE, SUPERPAVE, MIX "C", N70	TON	106	106	
X4066770	LEVELING BINDER (MACHINE METHOD), SUPERPAVE N70	TON	4	4	
X7015000	CHANGEABLE MESSAGE SIGN	CAL MO	10	10	
X7200200	WIDE LOAD SIGNING	L SUM	1	1	
X8002137	EROSION AND SEDIMENT CONTROL	SUM	1	1	
XX005495	PRECAST PRESTRESSED CONCRETE DECK BEAMS (21" DEPTH), SPECIAL	SQ FT	151	151	
Z0030250	IMPACT ATTENUATORS, TEMPORARY (NON- REDIRECTIVE), TEST LEVEL 3	EACH	2		2
Z0030350	IMPACT ATTENUATORS, RELOCATE (NON- REDIRECTIVE), TEST LEVEL 3	EACH	2		2
X0325599	PARTIAL DEPTH PATCHING 2"	TON	82	82	
X4422025	PARTIAL DEPTH REMOVAL 2"	SQ YD	733	733	

△

PLOT DATE = 8/24/2005
FILE NAME = c:\pwworkspace\1030885\plott\p1030885.dgn
PLOT SCALE = 43.9333' / IN.
REFERENCE = *REF*

* SPECIALTY ITEMS

Rev.

△ Rev. 10-23-06

F.A.P. RTE.	SECTION	COUNTY	TOTAL SHEETS	SHEET NO.
329	126BR-1	RANDOLPH	27	7
STA.	TO STA.			
FED. ROAD DIST. NO.	ILLINOIS	FED. AID PROJECT		
CONTRACT NO. 76898				

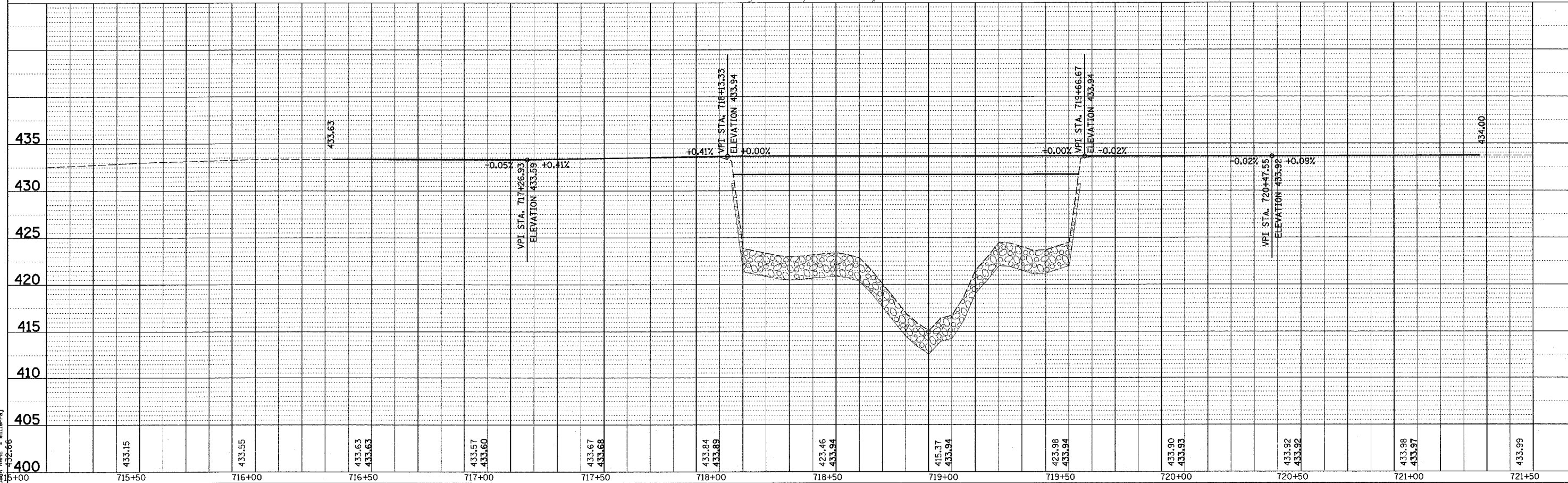
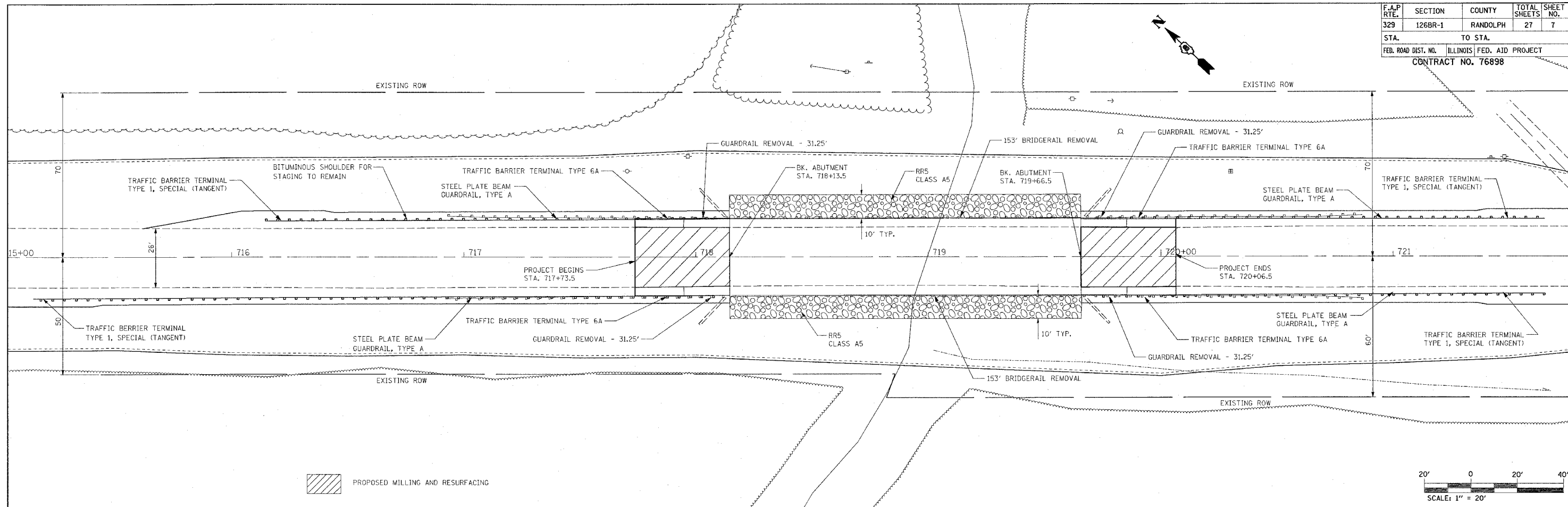

PLAN	DATE	BY
NO.		
NO.		
NO.		

PROFILE	DATE	BY
NO.		
NO.		
NO.		

PLOT DATE = 10/20/2006
 FILE NAME = c:\projects\126BR-1\plan\p102306b1.dgn
 USER NAME = milleraj
 432666

Rev. Sheet 10-23-06

