

F.A.P. RTE.	SECTION	COUNTY	TOTAL SHEETS	SHEET NO.
329	126BR-1	RANDOLPH	27	8
STA.	TO STA.			
FED. ROAD DIST. NO.	ILLINOIS	FED. AID PROJECT		
CONTRACT NO. 76898				

NOTES:

1. DETOUR SIGNS THAT ARE REQUIRED SHALL BE SUPPLIED BY I.D.O.T. AND BY THE CONTRACTOR, AS NOTED BELOW. THE CONTRACTOR SHALL FURNISH TYPE 3 BARRICADES, THE POSTS, AND ERECT SIGNS AT THE LOCATIONS SHOWN ON THIS SHEET, AS DIRECTED BY THE R.E./R.T. THE POSTS SHALL REMAIN THE PROPERTY OF THE CONTRACTOR.
2. THE CONTRACTOR SHALL GIVE ILLINOIS DEPARTMENT OF TRANSPORTATION, BUREAU OF OPERATIONS TWO WEEKS NOTICE FOR THE SIGNS WHICH SHALL BE SUPPLIED BY I.D.O.T. THE CONTRACTOR SHALL PICK UP THE SIGNS AT THE TM BUILDING AT 9601 ST. CLAIR AVE. IN FAIRVIEW HEIGHTS. THE CONTACT PERSON IS JEAN SLAPE WHO CAN BE REACHED AT (618) 346-3289.
3. THE CONTRACTOR SHALL REMOVE AND RETURN THE SIGNS THAT WERE SUPPLIED BY I.D.O.T. TO THE TM BUILDING IN FAIRVIEW HEIGHTS AFTER THE CONTRACT HAS BEEN COMPLETED. ANY DAMAGED SIGNS SHALL BE REPLACED AT THE CONTRACTORS EXPENSE.
4. THIS WORK SHALL BE PAID FOR AT THE CONTRACT UNIT PRICE, LUMP SUM, FOR DETOUR SIGNING AND NO OTHER COMPENSATION WILL BE ALLOWED, EXCEPT FOR PAYMENT OF SIGNS THAT WILL BE SUPPLIED BY THE CONTRACTOR.
5. THE CONTRACTOR SHALL FURNISH ADVANCE WARNING SIGNS AND ALL SIGNS AND TRAFFIC CONTROL DEVICES REQUIRED BY STANDARD BLR 21-6
6. THE SIGNS THAT ARE TO BE SUPPLIED BY THE CONTRACTOR SHALL BE PAID FOR AT THE CONTRACT UNIT PRICE, LUMP SUM, FOR TRAFFIC CONTROL AND PROTECTION, STANDARD BLR 21-6
7. SIGN SPACING WILL BE 400' OR TO FIT FIELD CONDITIONS.
8. THE HEIGHT TO THE BOTTOM OF THE LOWEST SIGN SHALL NOT BE LESS THAN 6'.
9. ALL ADVANCE WARNING SIGNS SHALL BE 48" FLUORESCENT ORANGE WITH FLASHING LIGHTS.

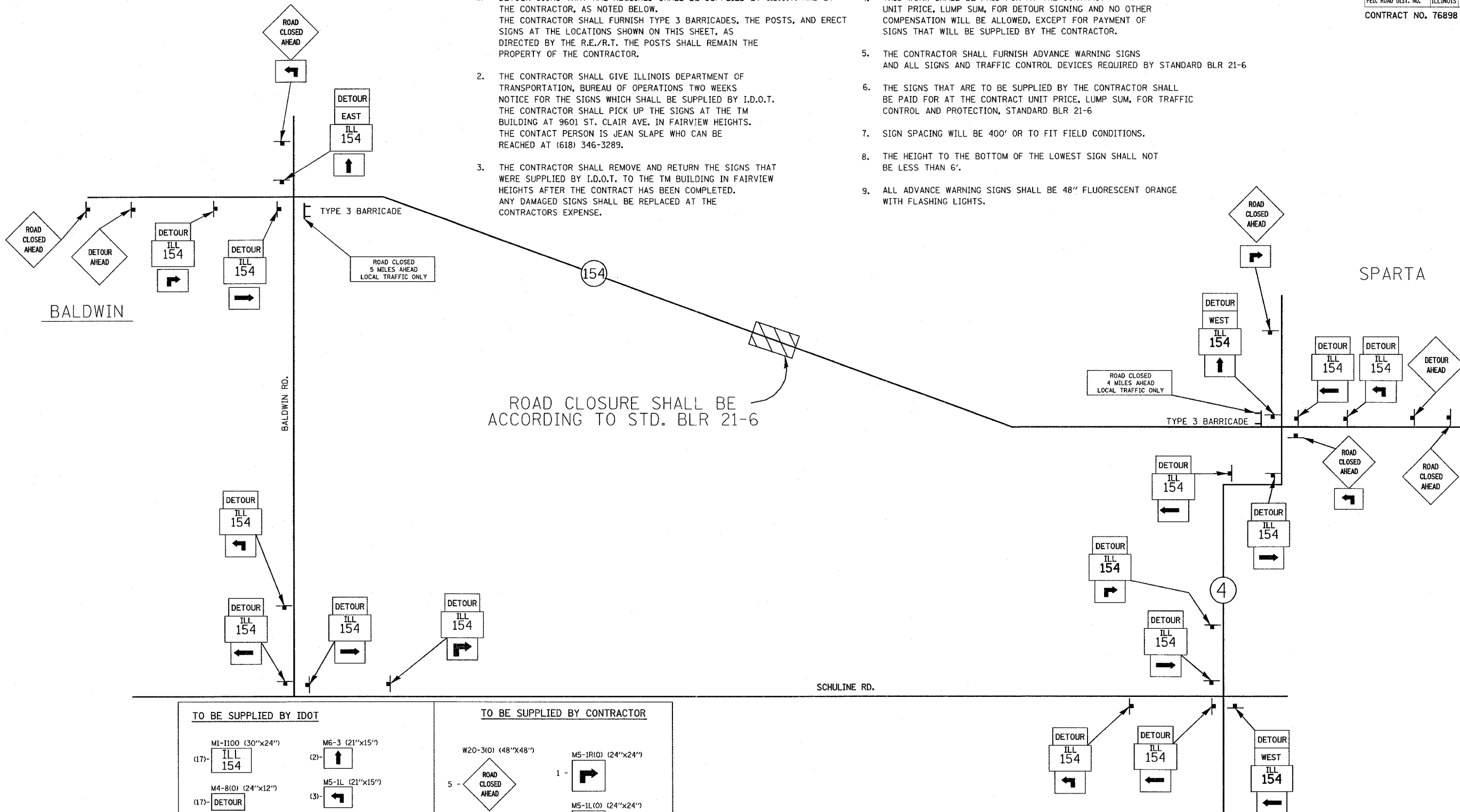

TO BE SUPPLIED BY IDOT		TO BE SUPPLIED BY CONTRACTOR	
(17)- MI-1100 (30"x24") ILL 154	(2)- M6-3 (21"x15") ↑	5 - W20-310 (48"x48") ROAD CLOSED AHEAD	1 - M5-1R10 (24"x24") ↘
(17)- M4-8(0) (24"x12") DETOUR	(3)- M5-1L (21"x15") ↙	(48"x48")	1 - M5-1L(0) (24"x24") ↙
(2)- M3-3 (24"x12") WEST	(3)- M5-1R (0) (21"x15") ↘	2 - (48"x48") DETOUR AHEAD	
(1)- M3-3 (24"x12") EAST	(9)- M6-1 (21"x15") →		
(1) -4 MILES AHEAD (1) -5 MILES AHEAD	R11-3B (60"x30") ROAD CLOSED X MILES AHEAD LOCAL TRAFFIC ONLY	CONTRACTOR SHALL ALSO SUPPLY ALL SIGNS REQUIRED BY STD. BLR 21-6	

REVISIONS	
NAME	DATE

ILLINOIS DEPARTMENT OF TRANSPORTATION
 DETOUR SIGNING
 S.N. 079-0016
 FAP ROUTE 329 (IL 154)
 SECTION 126BR-1
 RANDOLPH COUNTY
 SCALE: VERT. _____
 HORIZ. _____
 DATE _____ DRAWN BY _____
 CHECKED BY _____

PLOT DATE = 8/19/2006
 FILE NAME = z:\projects\126BR-1\plan\126BR-1.dgn
 USER NAME = dballard@idot.gov