

SECTION D-D
(Looking East)

*** Height of curb varies from 6" to 9 1/2" along a 10' length toward the bridge.

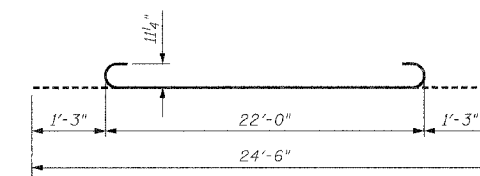

BAR a11(E)

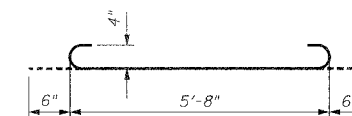

BAR a12(E)

TWO APPROACH PAVEMENTS

BILL OF MATERIAL

Item	Unit	Quantity
Bridge Approach Pavement (Special)	Sq. Yd.	83

DESIGN STRESSES

$f'c = 3,500$ p.s.i.
 $f_y = 60,000$ p.s.i.
 $n = 8.5$

See Bridge Approach Pavement Std. 420401 for additional details.
All reinforcement bars shall be Epoxy Coated.

DATE: 3/10/2006
FILENAME: n:\proj\32778\eldorado\design\structural_eldorado_32778_cad\final_plan\32778-eldo-bapp01.dgn

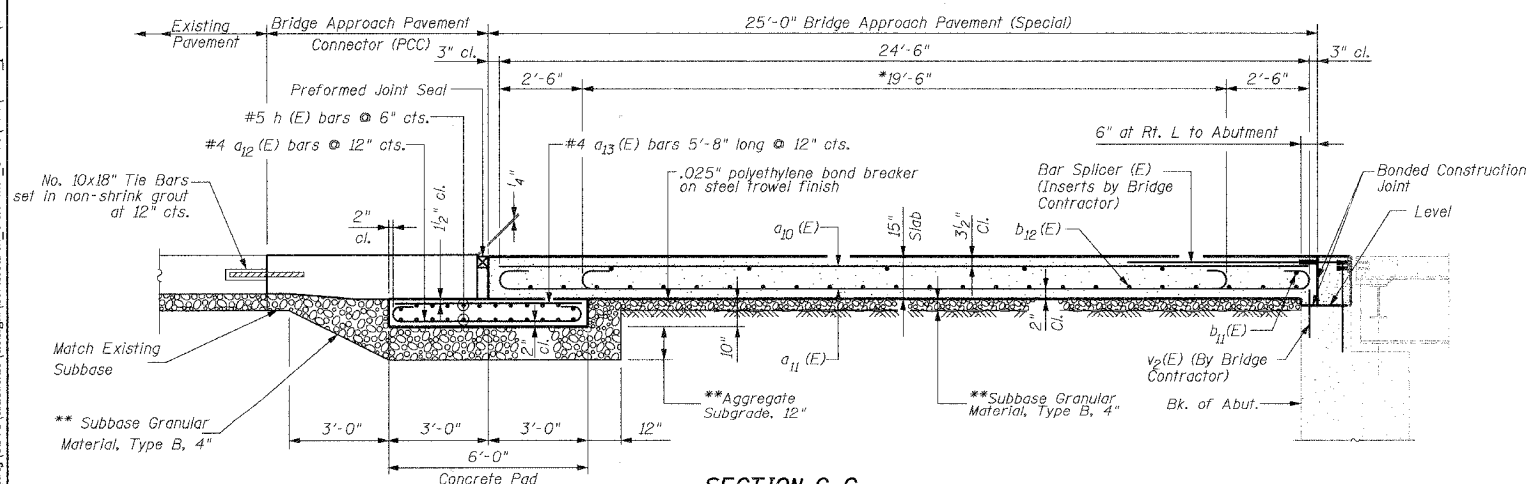

SECTION C-C

*Stagger #9 a10(E) bars as shown on Plan-Full width.
**Items included in cost of Approach Pavement (Special)

REVISIONS	
NAME	DATE

Ciorba Group, Inc.
CONSULTING ENGINEERS
5507 NORTH CUMBERLAND AVENUE :: CHICAGO, ILLINOIS 60656 :: (773) 775-4009

VILLAGE OF WINNETKA, ILLINOIS
BRIDGE APPROACH PAVEMENT (SPECIAL)
ELDORADO STREET OVER THE UNION PACIFIC R.R.
R.R. MILE POST 17.26 KENOSHA SUBDIVISION
COOK COUNTY STA. 201+07.21
STRUCTURE NO. 016-8260

SCALE: NONE
DATE: MARCH 2006
FILE: 3278

DRAWN BY: RCD
DESIGN BY: BWS
CHECKED BY: SCD