

CONTRACT NO. 83862

F.A.P. R/L	SECTION	COUNTY	TOTAL SHEETS	SHEET NO.
361	06-00214-03-BR	KANE	52	36
STA.		TO STA.		
FED. ROAD DIST. NO. 1 ILLINOIS FED. AID PROJECT				

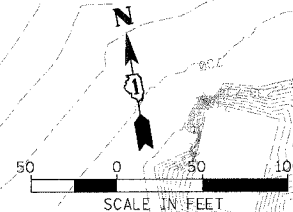
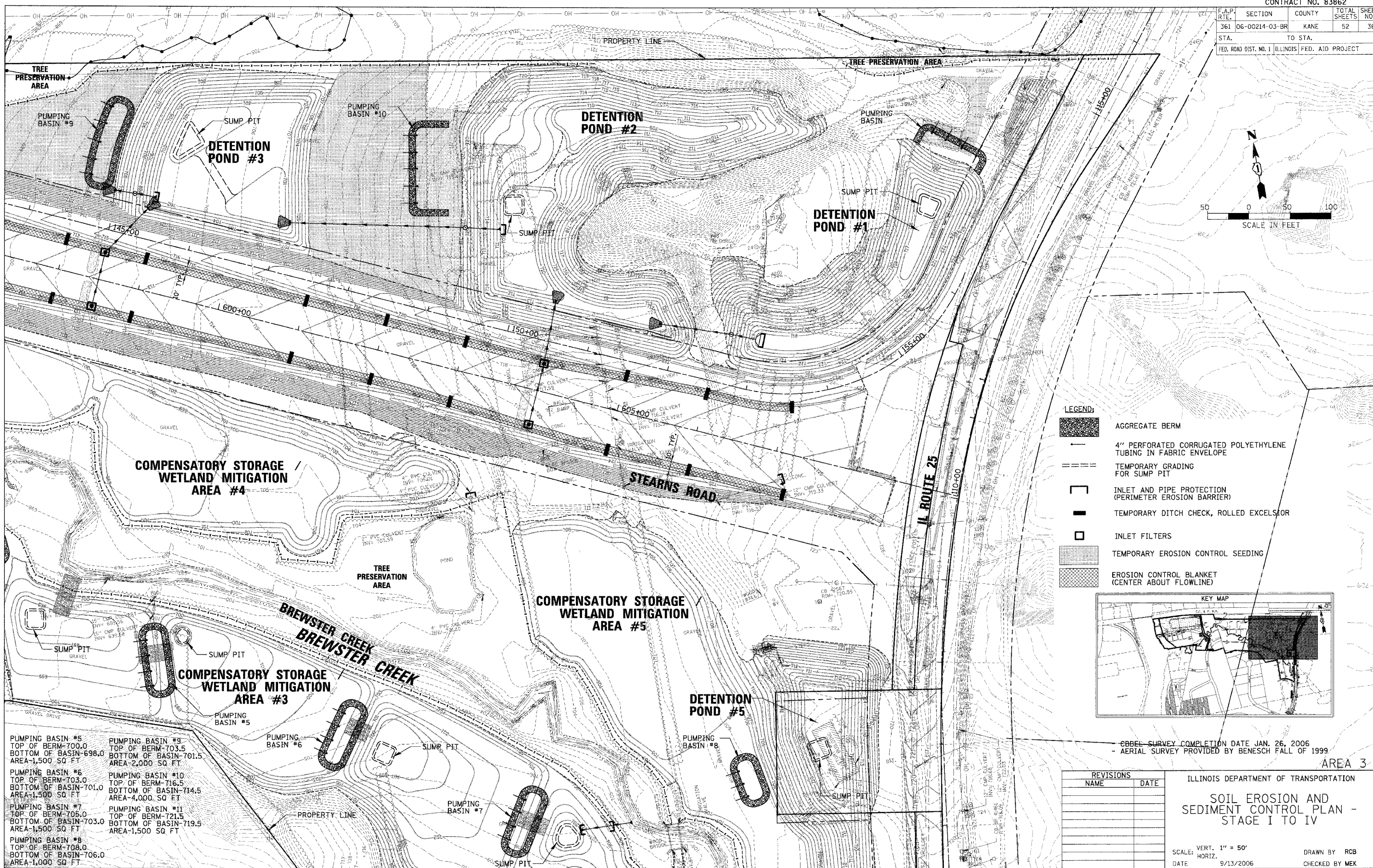

LEGEND:

- AGGREGATE BERM
- 4" PERFORATED CORRUGATED POLYETHYLENE TUBING IN FABRIC ENVELOPE
- TEMPORARY GRADING FOR SUMP PIT
- INLET AND PIPE PROTECTION (PERIMETER EROSION BARRIER)
- TEMPORARY DITCH CHECK, ROLLED EXCELSIOR
- INLET FILTERS
- TEMPORARY EROSION CONTROL SEEDING
- EROSION CONTROL BLANKET (CENTER ABOUT FLOWLINE)

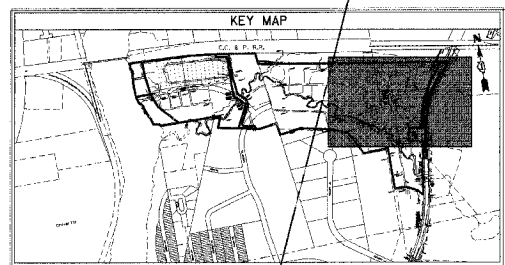

CBEL SURVEY COMPLETION DATE JAN. 26, 2006
 - AERIAL SURVEY PROVIDED BY BENESCH FALL OF 1999

AREA 3

REVISIONS	
NAME	DATE

ILLINOIS DEPARTMENT OF TRANSPORTATION
 SOIL EROSION AND SEDIMENT CONTROL PLAN - STAGE I TO IV

SCALE: VERT. 1" = 50'
 HORIZ. 1" = 100'
 DATE 9/13/2006
 DRAWN BY RCB
 CHECKED BY MEK

CHRISTOPHER B. BURKE ENGINEERING, LTD.
 9575 W. Higgins Road, Suite 600
 Rosemont, Illinois 60018
 (847) 823-0500



PLOT DATE = 9/13/2006
 FILE NAME = N:\Users\cburke\My Documents\814710\RD\G...NPR_21471_23.ECP
 USER NAME = BURKE

PUMPING BASIN #5 TOP OF BERM-700.0 BOTTOM OF BASIN-698.0 AREA-1,500 SQ FT	PUMPING BASIN #9 TOP OF BERM-703.5 BOTTOM OF BASIN-701.5 AREA-2,000 SQ FT
PUMPING BASIN #6 TOP OF BERM-703.0 BOTTOM OF BASIN-701.0 AREA-1,500 SQ FT	PUMPING BASIN #10 TOP OF BERM-716.5 BOTTOM OF BASIN-714.5 AREA-4,000 SQ FT
PUMPING BASIN #7 TOP OF BERM-705.0 BOTTOM OF BASIN-703.0 AREA-1,500 SQ FT	PUMPING BASIN #11 TOP OF BERM-721.5 BOTTOM OF BASIN-719.5 AREA-1,500 SQ FT
PUMPING BASIN #8 TOP OF BERM-708.0 BOTTOM OF BASIN-706.0 AREA-1,000 SQ FT	