

CONTRACT NO. 83862

F.A.P. RTE.	SECTION	COUNTY	TOTAL SHEETS	SHEET NO.
361	06-00214-03-BR	KANE	52	37
STA.		TO STA.		
FED. ROAD DIST. NO. 1 ILLINOIS FED. AID PROJECT				

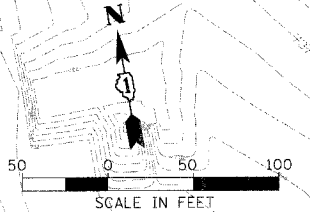
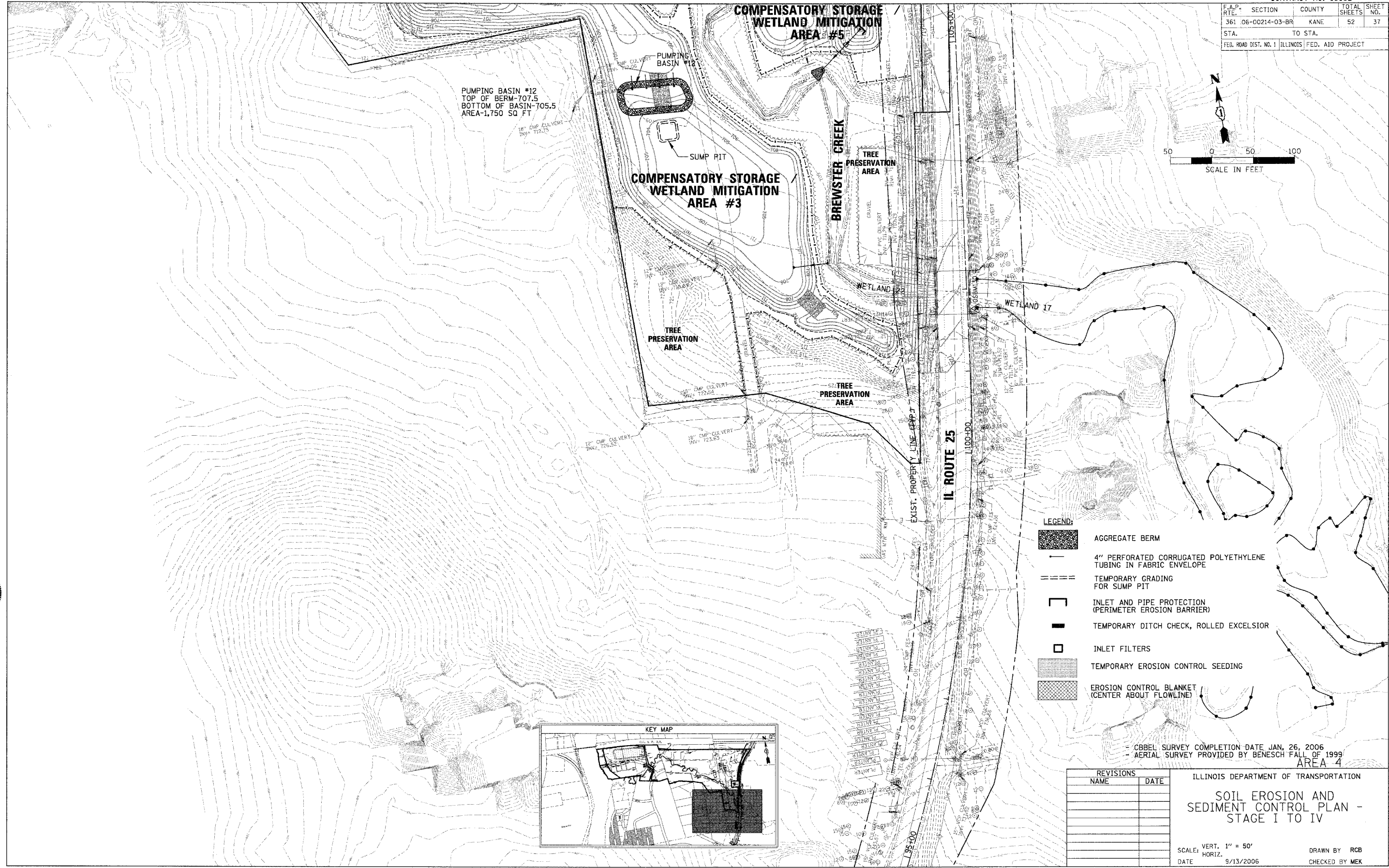

- LEGEND:**
- AGGREGATE BERM
 - 4" PERFORATED CORRUGATED POLYETHYLENE TUBING IN FABRIC ENVELOPE
 - TEMPORARY GRADING FOR SUMP PIT
 - INLET AND PIPE PROTECTION (PERIMETER EROSION BARRIER)
 - TEMPORARY DITCH CHECK, ROLLED EXCELSIOR
 - INLET FILTERS
 - TEMPORARY EROSION CONTROL SEEDING
 - EROSION CONTROL BLANKET (CENTER ABOUT FLOWLINE)

- CBEL SURVEY COMPLETION DATE JAN. 26, 2006
 - AERIAL SURVEY PROVIDED BY BENESCH FALL OF 1999

REVISIONS	
NAME	DATE

ILLINOIS DEPARTMENT OF TRANSPORTATION
SOIL EROSION AND SEDIMENT CONTROL PLAN - STAGE I TO IV
 SCALE: VERT. 1" = 50'
 DATE: 9/13/2006
 DRAWN BY RCB
 CHECKED BY MEK

CHRISTOPHER B. BURKE ENGINEERING, LTD.
 9575 W. Higgins Road, Suite 600
 Rosemont, Illinois 60018
 (847) 823-0500

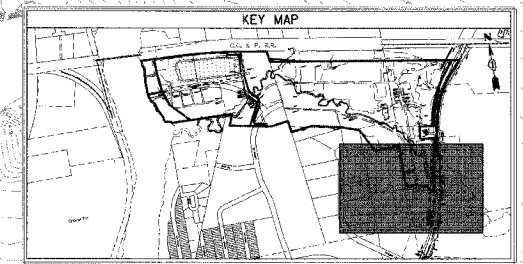

PLOT DATE = 9/13/2006
 FILE NAME = N:\kennecott\14710RD\Civil\PLR\14710_84.ECP
 PLOT SCALE = 5"
 USER NAME = JUSERS