

F.A.P. RTE.	SECTION	COUNTY	TOTAL SHEETS	SHEET NO.
1517	03-00247-00-BR	KANE	121	12
STA.	117+50	TO STA.	125+00	
FED. ROAD DIST. NO. 1 ILLINOIS HIGHWAY PROJECT				
CONTRACT: 83B67				

LINE	LENGTH	BEARING	BEGIN STA.	END STA.
L1	500.00'	S89°04'04"W	100+00	105+00
L2	401.59'	S89°04'04"W	105+00	109+07.59
L3	406.52'	N89°35'59"E	109+07.59	113+08.10
L4	722.16'	N88°59'04"E	113+08.10	120+30.26
L5	454.41'	S89°34'41"E	120+30.26	124+84.68
L6	53.89'	N89°37'36"E	124+84.68	125+38.57
L7	283.23'	N63°42'21"E	125+38.57	128+22.30
L8	271.84'	N89°24'05"E	128+22.30	130+94.14

- NOTES:**
- EXISTING LIGHTING HANDHOLE REMOVAL SHALL BE INCLUDED UNDER "REMOVAL OF EXISTING LIGHTING UNIT, SALVAGE".
 - EXISTING HANDRAIL REMOVAL OFF OF BRIDGES SHALL BE INCLUDED UNDER "SIDEWALK REMOVAL".
 - CONTRACTOR SHALL VERIFY STATUS OF 8" GAS MAIN WITH GAS COMPANY BEFORE BRIDGE SUPERSTRUCTURE REMOVAL.

PROJECT LEGEND:

- [Pattern] DENOTES BITUMINOUS SURFACE REMOVAL 1 1/2" OR BITUMINOUS CONCRETE REMOVAL (DECK)
- [Pattern] DENOTES BITUMINOUS SURFACE REMOVAL - BUTT JOINT
- [Pattern] DENOTES PAVEMENT REMOVAL OR CONCRETE MEDIAN REMOVAL
- [Pattern] DENOTES SIDEWALK REMOVAL
- [Pattern] DENOTES COMBINATION CURB AND GUTTER REMOVAL
- [Pattern] DENOTES DRIVEWAY PAVEMENT REMOVAL
- [Symbol] DENOTES TREE REMOVAL (6 TO 15 UNITS DIAMETER)

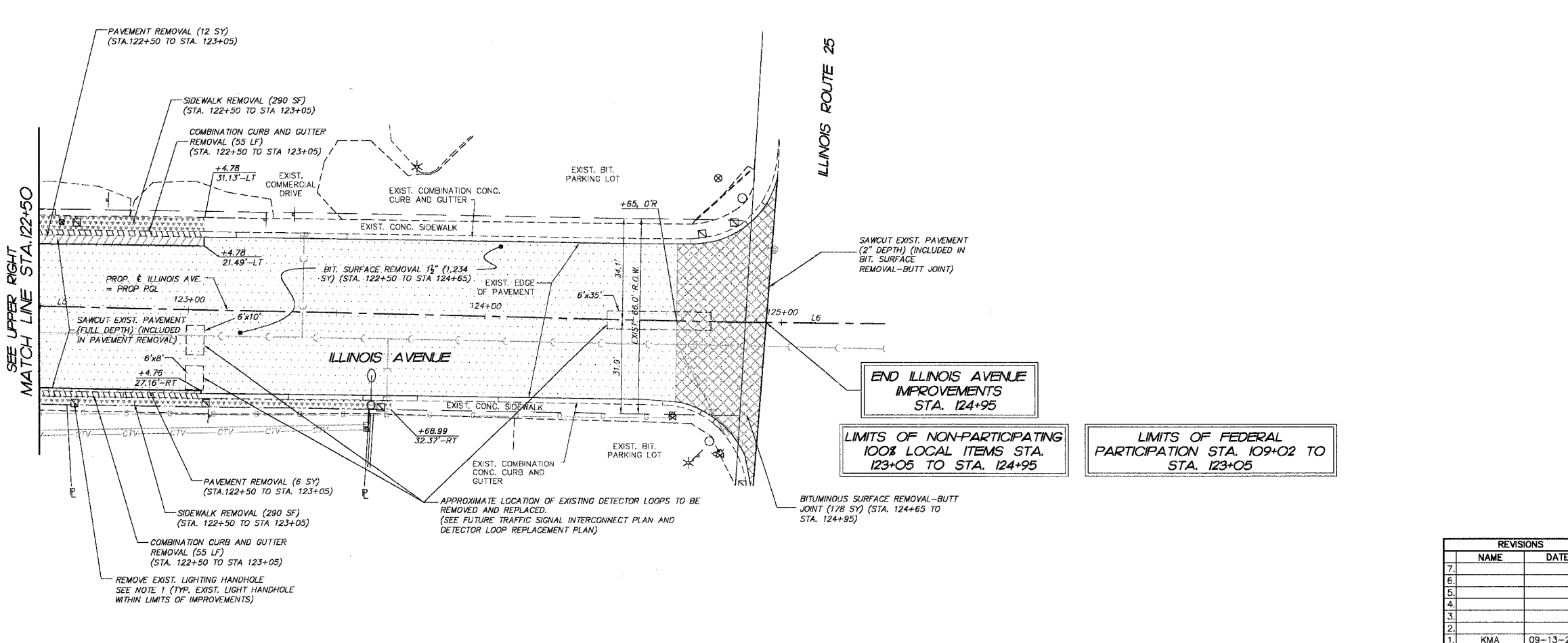
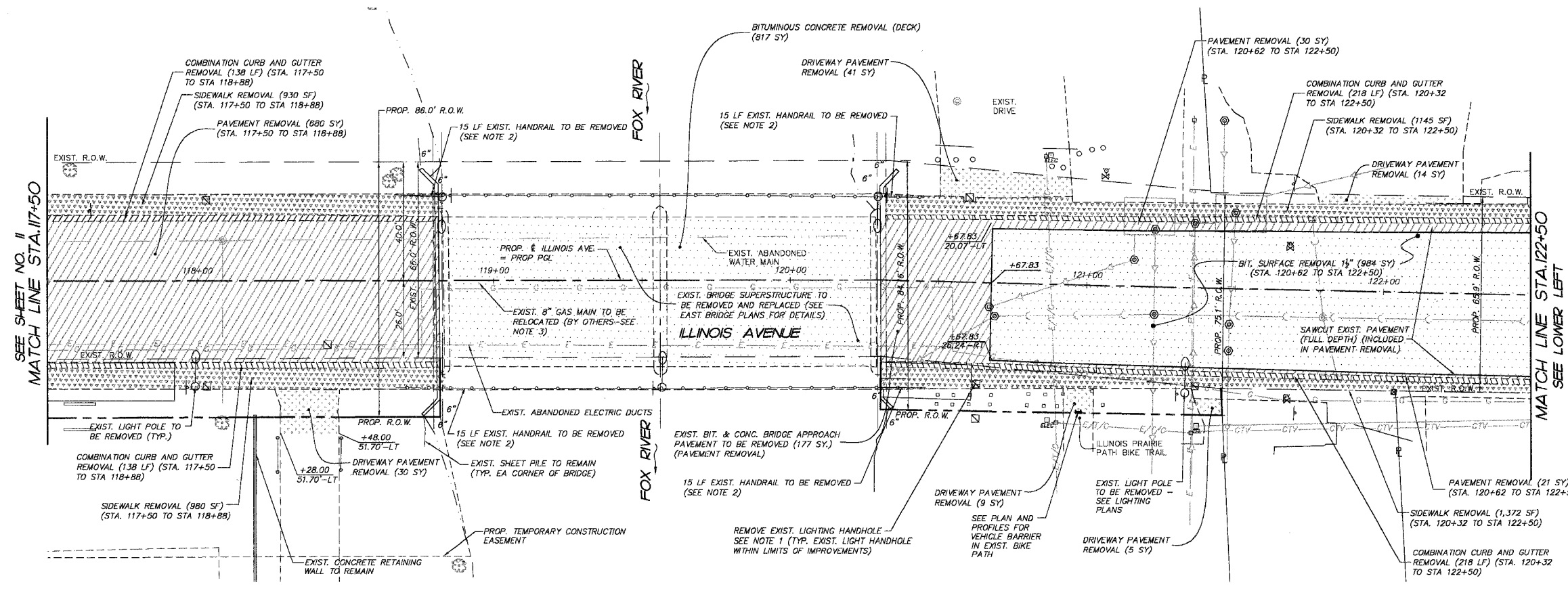

END ILLINOIS AVENUE IMPROVEMENTS STA. 124+95

LIMITS OF NON-PARTICIPATING 100% LOCAL ITEMS STA. 123+05 TO STA. 124+95

LIMITS OF FEDERAL PARTICIPATION STA. 109+02 TO STA. 123+05

REVISIONS	
NO.	DATE
7.	
6.	
5.	
4.	
3.	
2.	
1.	KMA 09-13-2006

SMITH ENGINEERING CONSULTANTS, INC.
 CIVIL/STRUCTURAL ENGINEERS AND SURVEYORS
 4000 PRIME PARKWAY, SUITE 201
 McHENRY, ILLINOIS 60050
 PH: 815-386-1770 FAX: 815-386-1781
 www.smithengineering.com E-MAIL: seo@smithengineering.com
 McHENRY HUNTLEY YORKVILLE
 ILLINOIS PROFESSIONAL DESIGN FIRM # 154-000108

ILLINOIS DEPARTMENT OF TRANSPORTATION
 CITY OF AURORA
 ILLINOIS AVENUE OVER THE FOX RIVER
 REMOVAL PLAN
 STA 117+50 TO STA 125+00

SCALE: 1" = 20'
 DATE 07-28-2006
 DRAWN BY MPL
 CHECKED BY JLP

PLOT FILE: STANDARD
 COMP. FILE: 090181-6000.dwg