

PROJECT NO. BHM-8003(213)
CONTRACT NO. 83875

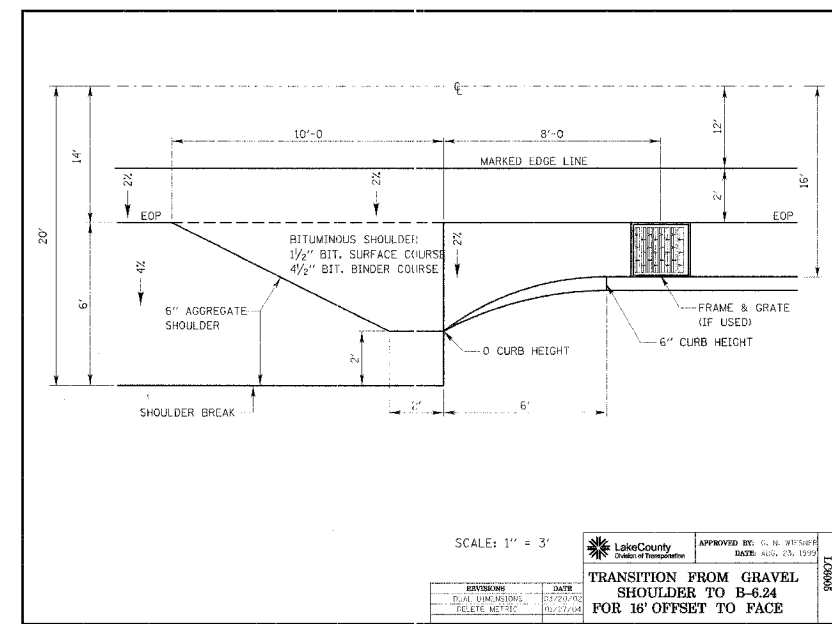
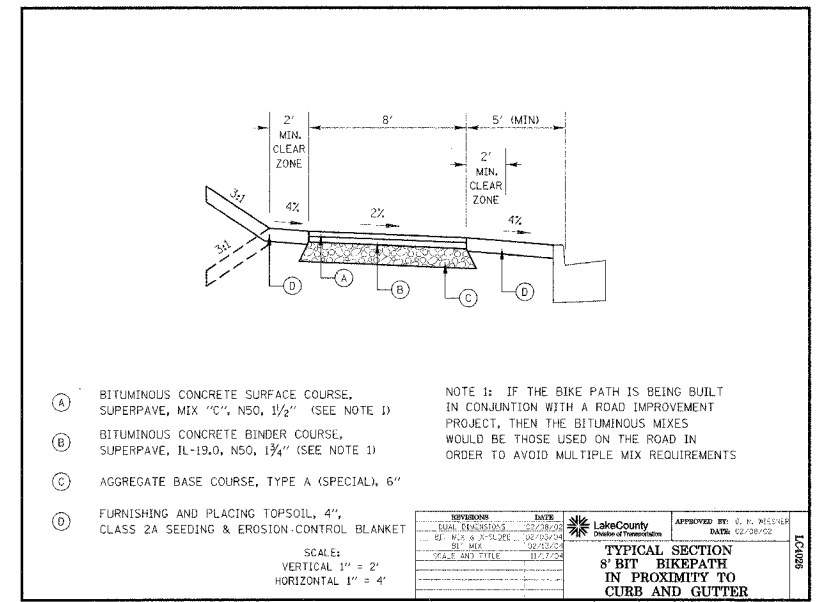

ENGLISH						METRIC						
S.S. DIA.	T	WIDTH (W)	OFFSET FROM E.O.P.	1/2 AREA PIPE	1/2 AREA	S.S. DIA. (NOMINAL)	S.S. DIA. (ACTUAL)	T	WIDTH (W)	OFFSET FROM E.O.P.	1/2 AREA PIPE	1/2 AREA
		WITHOUT SHORING	WITH SHORING	WITHOUT SHORING	WITH SHORING							
10"	2'	2'8"	4'2"	4'8"	6'2"	250	254	51	0.806m	1.356m	1.406m	1.956m
12"	2'	2'10"	4'4"	4'10"	6'4"	300	305	51	0.856m	1.406m	1.456m	2.006m
15"	2'4"	3'2"	4'8"	5'2"	6'8"	375	381	57	0.945m	1.495m	1.545m	2.095m
18"	2'8"	3'5"	4'11"	7'1"	6'11"	450	457	64	1.034m	1.584m	1.634m	2.184m
21"	2'8"	3'9"	5'3"	5'9"	7'3"	525	533	70	1.212m	1.673m	1.723m	2.273m
24"	3'	4'0"	5'6"	6'0"	7'6"	600	610	76	1.212m	1.762m	1.812m	2.362m
27"	3'4"	4'4"	5'10"	6'4"	7'10"	675	686	83	1.301m	1.851m	1.901m	2.451m
30"	3'8"	4'7"	6'1"	6'7"	8'1"	750	762	89	1.390m	1.940m	1.990m	2.540m
36"	4'	5'2"	6'8"	7'2"	8'8"	900	914	102	1.568m	2.118m	2.168m	2.718m
42"	4'8"	5'9"	7'3"	7'9"	9'3"	1050	1067	114	1.745m	2.295m	2.345m	2.895m
48"	5'	6'4"	7'10"	8'4"	9'10"	1200	1219	127	1.923m	2.473m	2.523m	3.073m

NOTES:

- TRENCH BACKFILL IS REQUIRED IF THE STORM SEWER OR CULVERT OFFSET FROM THE EDGE OF THE PAVEMENT IS LESS THAN THE TABULATED VALUES (THE INNER TRENCH WALL IS CLOSER THAN 2' (600mm) TO THE EDGE OF PAVEMENT).
- PAYMENT FOR THE TRENCH BACKFILL SHALL NOT EXCEED THE QUANTITY COMPUTED USING THE MAXIMUM TRENCH WIDTH DIMENSIONS. IF THE TRENCH IS EXCAVATED BEYOND THESE LIMITS, THE CONTRACTOR SHALL FURNISH AND PLACE ANY ADDITIONAL TRENCH BACKFILL AT HIS/HER EXPENSE.
- IF THE TRENCH WIDTH IS LESS THAN THE ABOVE MAXIMUM VALUES, PAYMENT WILL BE BASED ON THE ACTUAL DIMENSIONS OF THE DUS TRENCH.
- BEDDING SHALL BE PLACED FROM 4" UNDER THE PIPE TO THE SPRING LINE OF THE PIPE AND IS INCIDENTAL TO THE CORRESPONDING STORM SEWER OR CULVERT PAY ITEM.
- IF ANY PART OF THE EXCAVATION FOR A DRAINAGE STRUCTURE FALLS WITHIN 2' (600mm) OF THE EDGE OF PAVEMENT, THE SPACE BETWEEN THE SIDE OF THE EXCAVATION AND THE OUTER SURFACE OF THE DRAINAGE STRUCTURE SHALL BE FILLED WITH TRENCH BACKFILL. THE COST OF THIS ITEM IS INCLUDED IN THE PAY ITEM FOR THE DRAINAGE STRUCTURE.

SCALE: 1" = 2'

APPROVED BY: G. H. WESPER
DATE: SEP. 2, 1999

Lake County
Division of Transportation

**TRENCH WIDTHS FOR
TRENCH BACKFILL &
PAVEMENT REPLACEMENT**

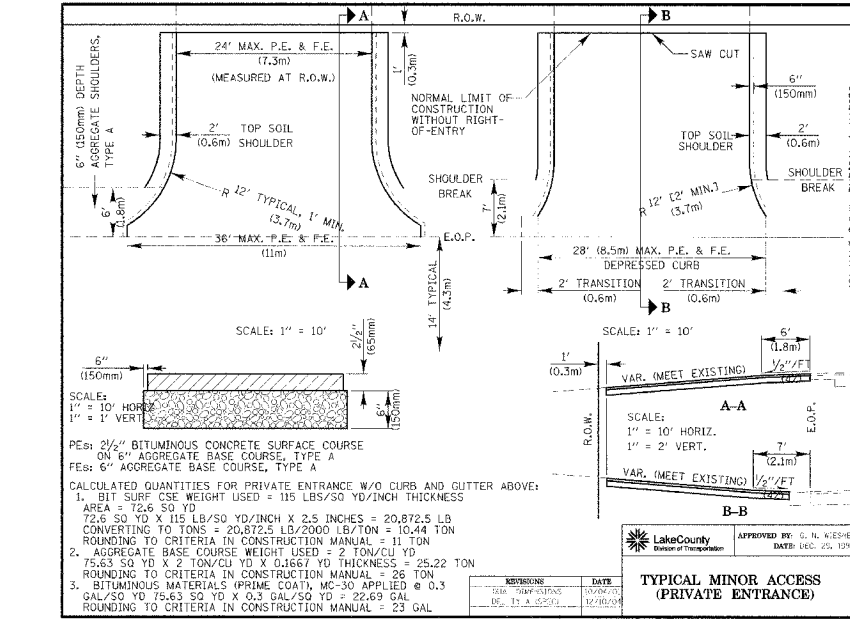
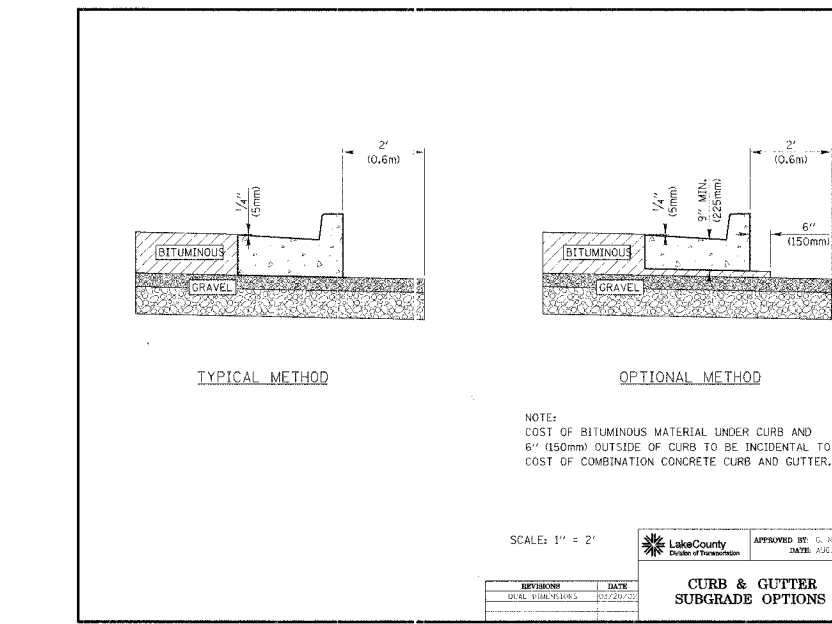
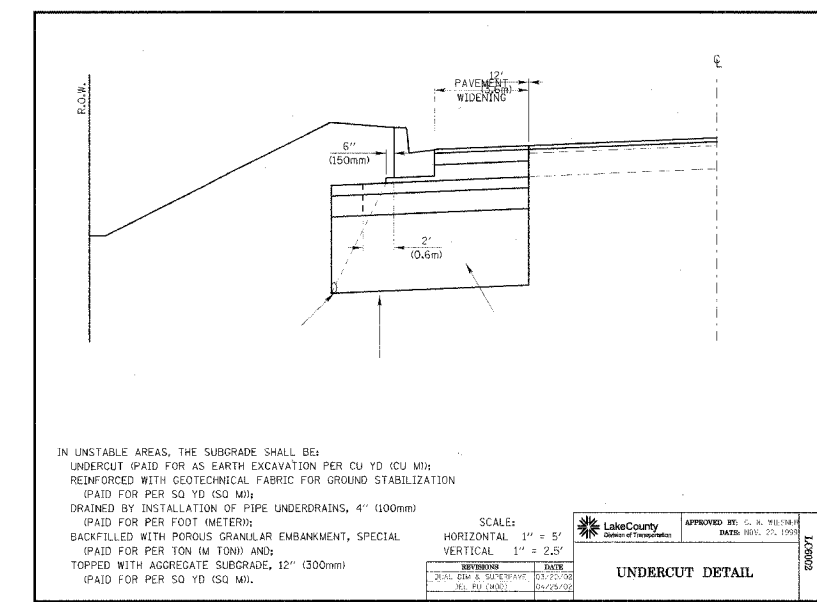

REVISIONS	NAME	DATE

ILLINOIS DEPARTMENT OF TRANSPORTATION

**CONSTRUCTION DETAILS
BUFFALO GROVE ROAD**

SCALE: VERT.: N.T.S.
HORIZ.: N.T.S.
DATE: 7/21/06

DRAWN BY: ERD
CHECKED BY: PWK

CMT
CRAWFORD MURPHY & TILLY, INC.
CONSULTING ENGINEERS
SPRINGFIELD, IL ■ AURORA, IL ■ ST. LOUIS, MO

L:\LakeCo\0220113\Draw\shhets\DETAL3.dgn