

Existing Structure No. 089-3013

Sta. 255+30 - 3-Span Continuous Steel Wide Flange Beam Bridge with Concrete Deck on Pile Bent Steel Piers with Closed Timber Abutments with Steel Piles. 120'-0" Bk.-Bk. Abuts., 24'-0" O.-O. Deck, 0° Skew.

B.M. Descriptions

B.M. #2 - Spike Nail In Fence Post
71.4' Lt. Sta. 254+62, Elev. 766.11

ROUTE NO.	SECTION	COUNTY	TOTAL SHEETS	SHEET NO.
C.H. 5	04-00163-00-BR	STEPHENSON	29	6

Sheet 1 of 20 CONTRACT NO. 85391

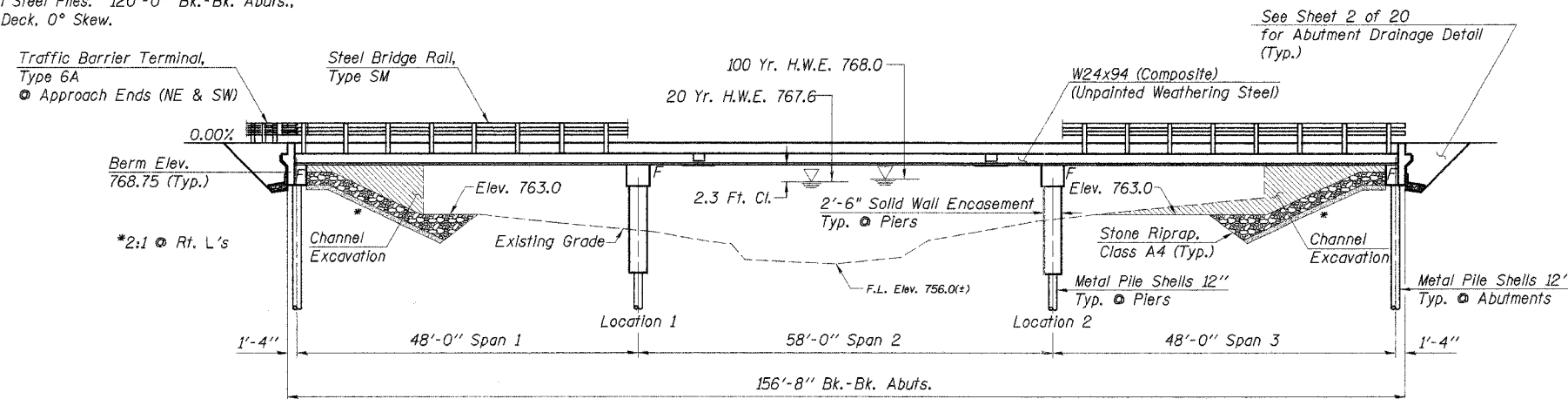

ELEVATION

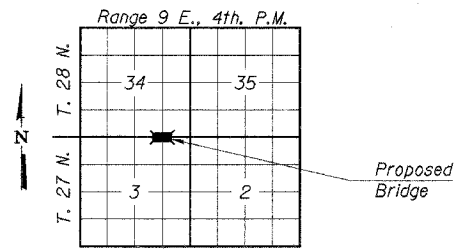

LOCATION PLAN

INDEX OF SHEETS

- 1. General Plan and Elevation
- 2. General Notes and Bill of Materials
- 3.-5. Top of Slab Elevations
- 6.-7. Superstructure
- 8. Steel Railing, Type SM
- 9.-10. Structural Steel
- 11. Bearing Details
- 12. Anchor Bolt Details
- 13.-14. Abutments
- 15.-16. Piers
- 17. Concrete Pile Details
- 18. Cantilever Forming Bracket Details
- 19.-20. Soil Boring Logs

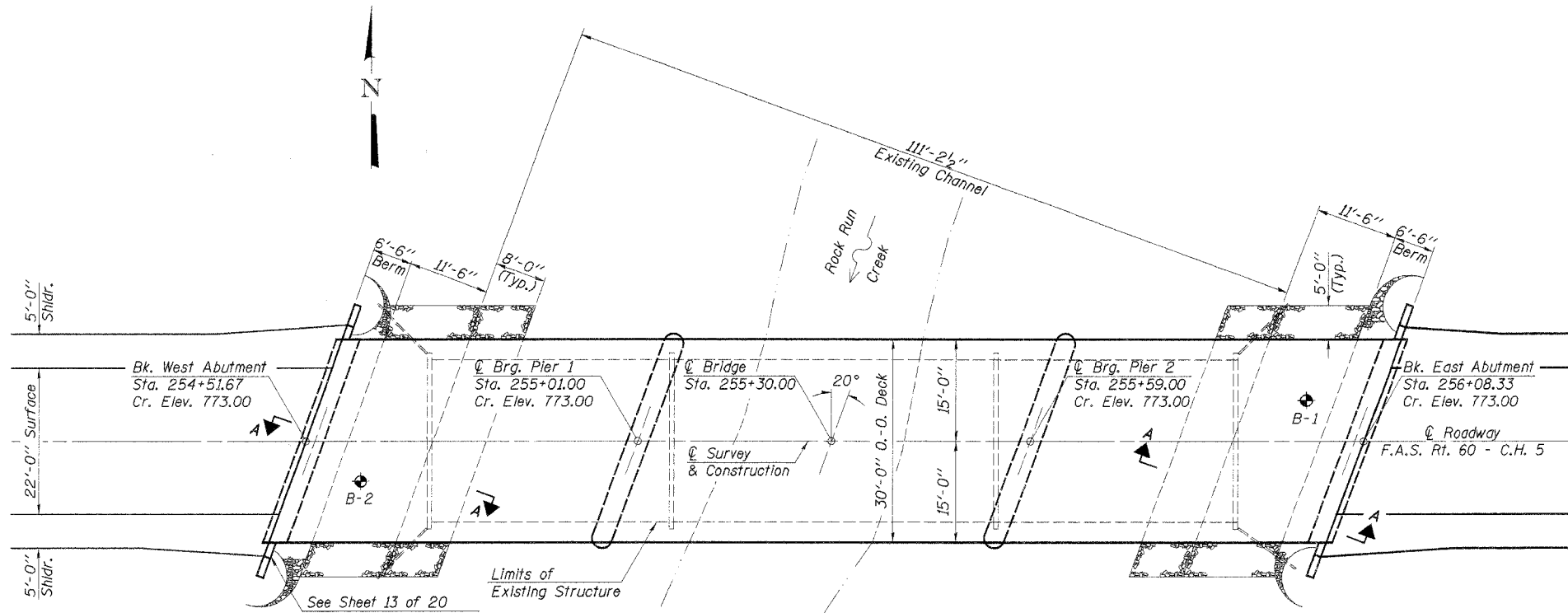

PLAN

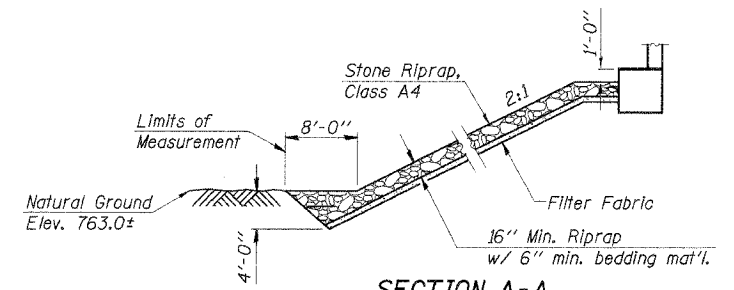

**SECTION A-A
RIPRAP PLACEMENT DETAIL**

Construction Permits:
The requirements of the IDNR - Office of Water Resources have been fulfilled in accordance with Statewide Permit No. 2.

WATERWAY INFORMATION

Drainage Area	32.95 Sq. Mi.
Existing Opening (20 Yr.)	785 Sq. Ft.
Required Opening (20 Yr.)	842 Sq. Ft.
Proposed Opening (20 Yr.)	842 Sq. Ft.
Design Discharge (20 Yr.)	2978 C.F.S.
Created Head (20 Yr.)	0.2 Ft.
100 Year Discharge	4261 C.F.S.
100 Yr. Created Head	0.3 Ft.

SEISMIC DATA

Seismic Performance Category (SPC) = A
Bedrock Acceleration Coefficient (A) = 0.032 g
Site Coefficient (S) = 1.0

DESIGN STRESSES

$f_c = 3,500$ p.s.i. (Sub. & Super)
 $f_y = 60,000$ p.s.i. (Reinf. Bars -- Field Units)
 $f_y = 50,000$ p.s.i. AASHTO M270 GR 50W (Structural Steel)

DESIGN SPECIFICATIONS

2002 AASHTO

LOADING HS 20-44

25#/Sq. Ft. included in dead load for future wearing surface.

"I certify that to the best of my knowledge, information and belief, this bridge design is structurally adequate for the design loading shown on the plans. The design is an economical one for the style of structure and complies with requirements of the current 'AASHTO Standard Specifications for Highway Bridges'."

Fred J. Stone, Jr. (S-9-06)
ILLINOIS STRUCTURAL NO. 2934 (Expires 11/30/06)

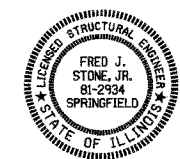

DESIGNED	A.R.K.
CHECKED	S.F.M. & F.J.S.
DRAWN	S.A.P.
CHECKED	A.R.K. & F.J.S.

GENERAL PLAN & ELEVATION
SECTION 04-00163-00-BR
F.A.S. ROUTE 60 - C.H. 5
STEPHENSON COUNTY
STATION 255+30

4440 ASH GROVE
SPRINGFIELD, IL 62711
(217) 793-8600
oasinc@insightbb.com

OZYURT AND STONE, INC.
CONSULTING ENGINEERS

JOB NO.: 0527
FILE: 0527GPE.DGN
DATE: 03/07/06