

SEC 26, TWP4N, R2W, 4TH P.M.

F.A.P. RTE.	SECTION	COUNTY	TOTAL SHEETS	SHEET NO.
310	(41-A)BR	McDONOUGH	58	14
STA. 567+20.0		TO STA. 572+00.0		
FED. ROAD DIST. NO.	ILLINOIS	FED. AID PROJECT		

GUARDRAIL SCHEDULES SOUTH OF PR. BRIDGE CONTRACT NO. 88939

TRAFFIC BARRIER TERMINAL TYPE 1, SPECIAL (FLARED)  
 50' - STA. 569+85.15 TO STA. 570+35.15, LEFT  
 50' - STA. 568+97.65 TO STA. 569+47.65, RIGHT

STEEL PLATE BEAM GUARD RAIL, TYPE A  
 175' - 14 SECTIONS, STA. 568+10.15 TO STA. 569+85.15, LEFT  
 87.5' - 7 SECTIONS, STA. 568+10.15 TO STA. 568+97.65, RIGHT

TRAFFIC BARRIER TERMINAL, TYPE 6  
 BRIDGE PARAPET TO STA. 568+10.15, BOTH LEFT & RIGHT

- PROPOSED STRUCTURE (S.N. 055-0048)  
 @ STA. 567+41.50, SKEW = 0°
- REMOVE EX. BRIDGE (S.N. 055-0007)  
 AND APPROACH PAVEMENT

MATCH LINE STA. 567+20.00

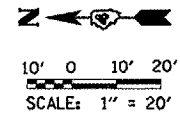
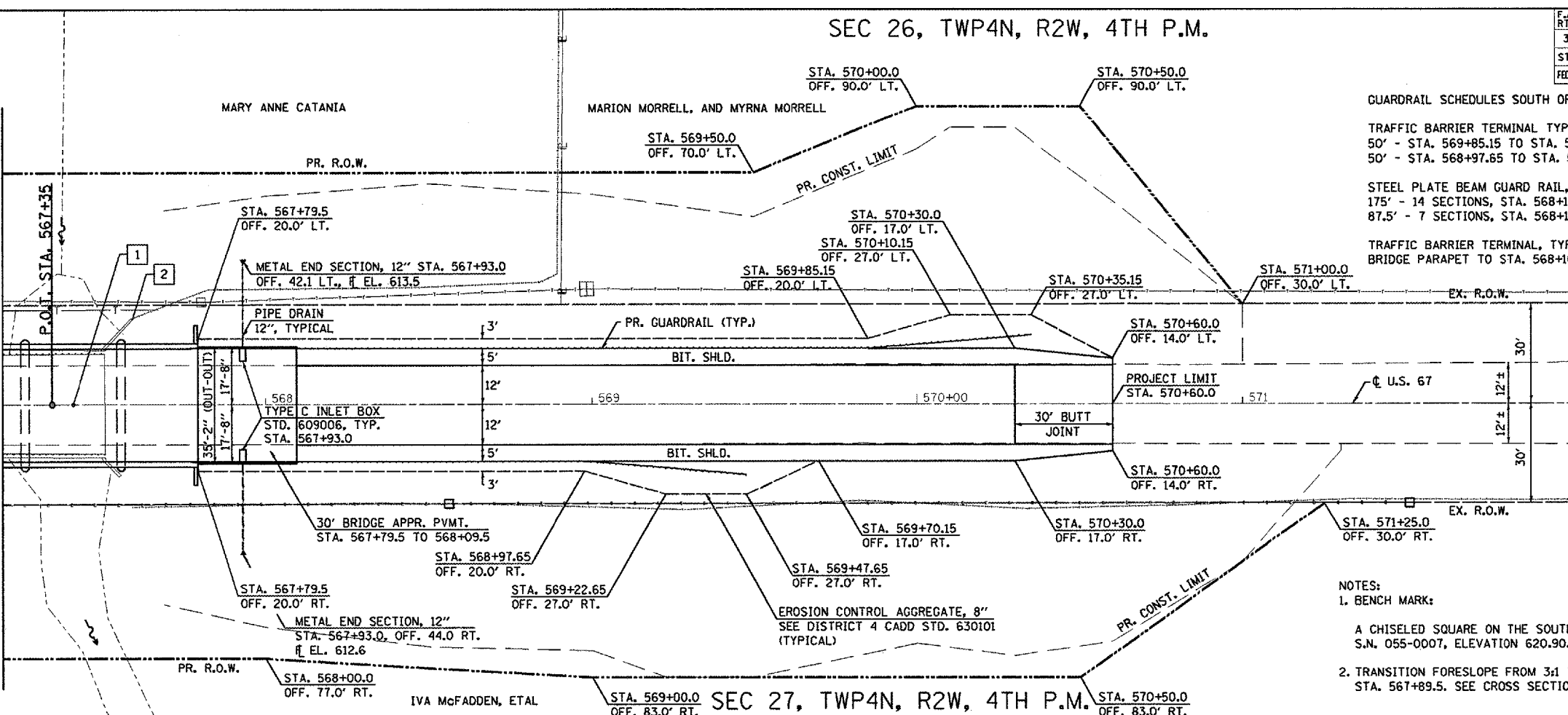

- NOTES:
- BENCH MARK:  
 A CHISELED SQUARE ON THE SOUTHWEST WINGWALL OF EXISTING S.N. 055-0007, ELEVATION 620.90.
  - TRANSITION FORESLOPE FROM 3:1 TO 2:1 FROM STA. 568+09.5 TO STA. 567+89.5. SEE CROSS SECTION SHEETS FOR MORE DETAILS.

PLAN	DATE
SURVEYED	
NOTED	
BY	

PROFILE	DATE
SURVEYED	
NOTED	
BY	

