

F.A.P. RTE.	SECTION	COUNTY	TOTAL SHEETS	SHEET NO.
332	1-BB-1	VERMILION	140	19
STA. 185±00.00		TO STA. 191±00.00		
FED. ROAD DIST. NO. ILLINOIS FED. AID PROJECT				

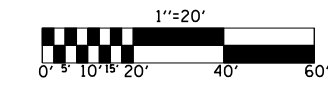

SECTION 8, T20N, R11W, 2ND PM

NORTH FORK VERMILION RIVER

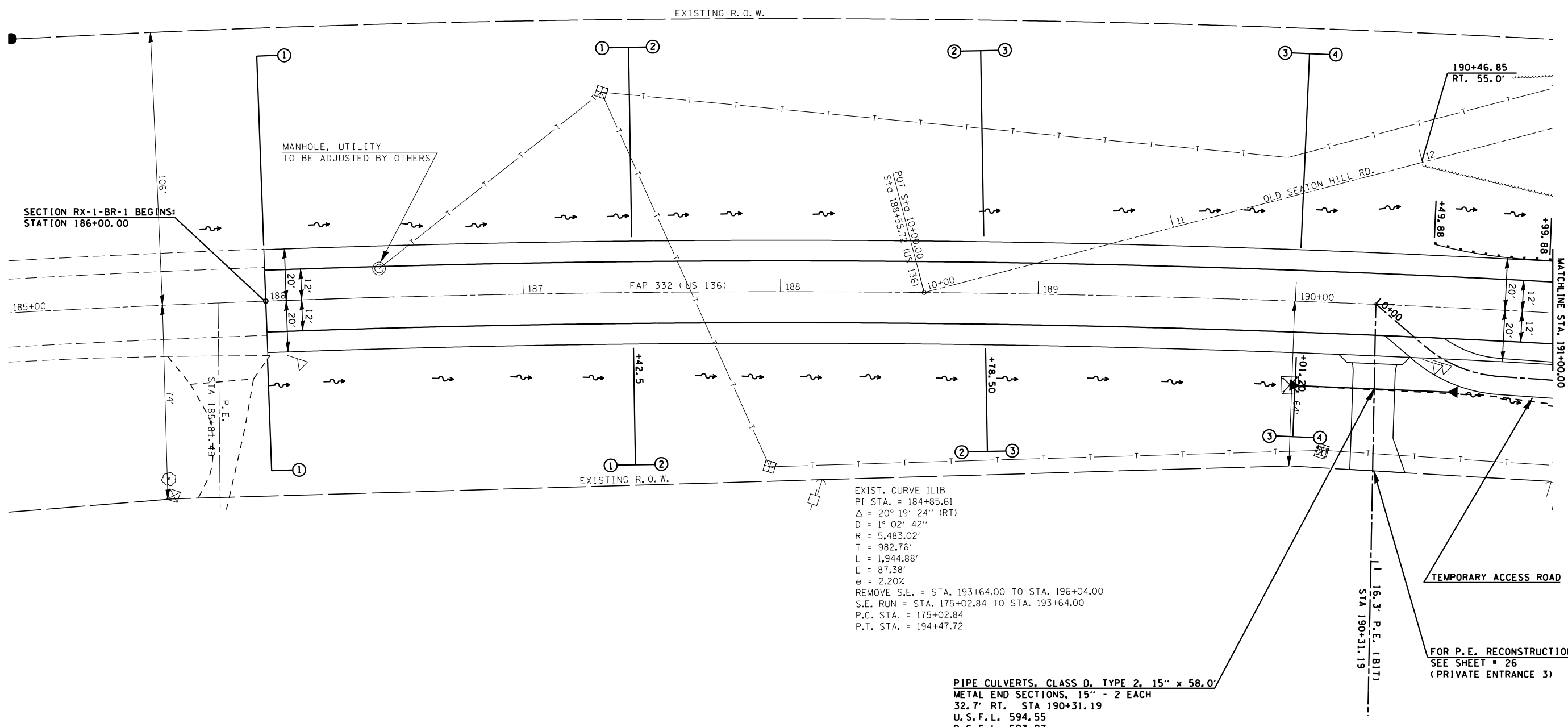

EXIST. CURVE IL1B  
 PI STA. = 184+85.61  
 $\Delta = 20^\circ 19' 24''$  (RT)  
 $D = 1^\circ 02' 42''$   
 $R = 5,483.02'$   
 $T = 982.76'$   
 $L = 1,944.88'$   
 $E = 87.38'$   
 $e = 2.20\%$   
 REMOVE S.E. = STA. 193+64.00 TO STA. 196+04.00  
 S.E. RUN = STA. 175+02.84 TO STA. 193+64.00  
 P.C. STA. = 175+02.84  
 P.T. STA. = 194+47.72

PIPE CULVERTS, CLASS D, TYPE 2, 15" x 58.0'  
 METAL END SECTIONS, 15" - 2 EACH  
 32.7' RT. STA 190+31.19  
 U.S.F.L. 594.55  
 D.S.F.L. 593.97

BM 4395-6 CHISELED "□" ON TOP SIGNAL BASE AT N.W. QUADRANT OF NEWELL RD. & IL. 1, STA. 152+20.27, 58.59' LT. ELEV. = 657.912

BM 4395-7 CHISELED "□" ON TOP OF EAST HDWL OF A.R.P.C., STA. 160+78.46, 42.08' RT. ELEV= 655.987

BM 4395-8 TOP BOLT ON CONCRETE END SECTION OF A.R.P.C., STA. 173+17.84, 38.11' LT. ELEV. = 629.666

MAILBOXES SHALL BE PROTECTED AND RESTORED PER ARTICLE 107.20

REVISIONS	
NAME	DATE

ILLINOIS DEPARTMENT OF TRANSPORTATION

FAP 332 (US 136)  
ROADWAY PLAN

SCALE: VERT. NA  
HORIZ. 20

DATE

DRAWN BY JLD  
CHECKED BY

PLOT DATE = 8/28/2006  
 FILE NAME = c:\projects\90841\185\136.pln\08.dgn  
 PLOT SCALE = 42.3525' / IN.  
 USER NAME = stults,j