

F.A.P. RTE.	SECTION	COUNTY	TOTAL SHEETS	SHEET NO.
332	RX-1-BR-1	VERMILION	140	40
STA. 191+00.00		TO STA. 197+00.00		
FED. ROAD DIST. NO. ILLINOIS		FED. AID PROJECT		

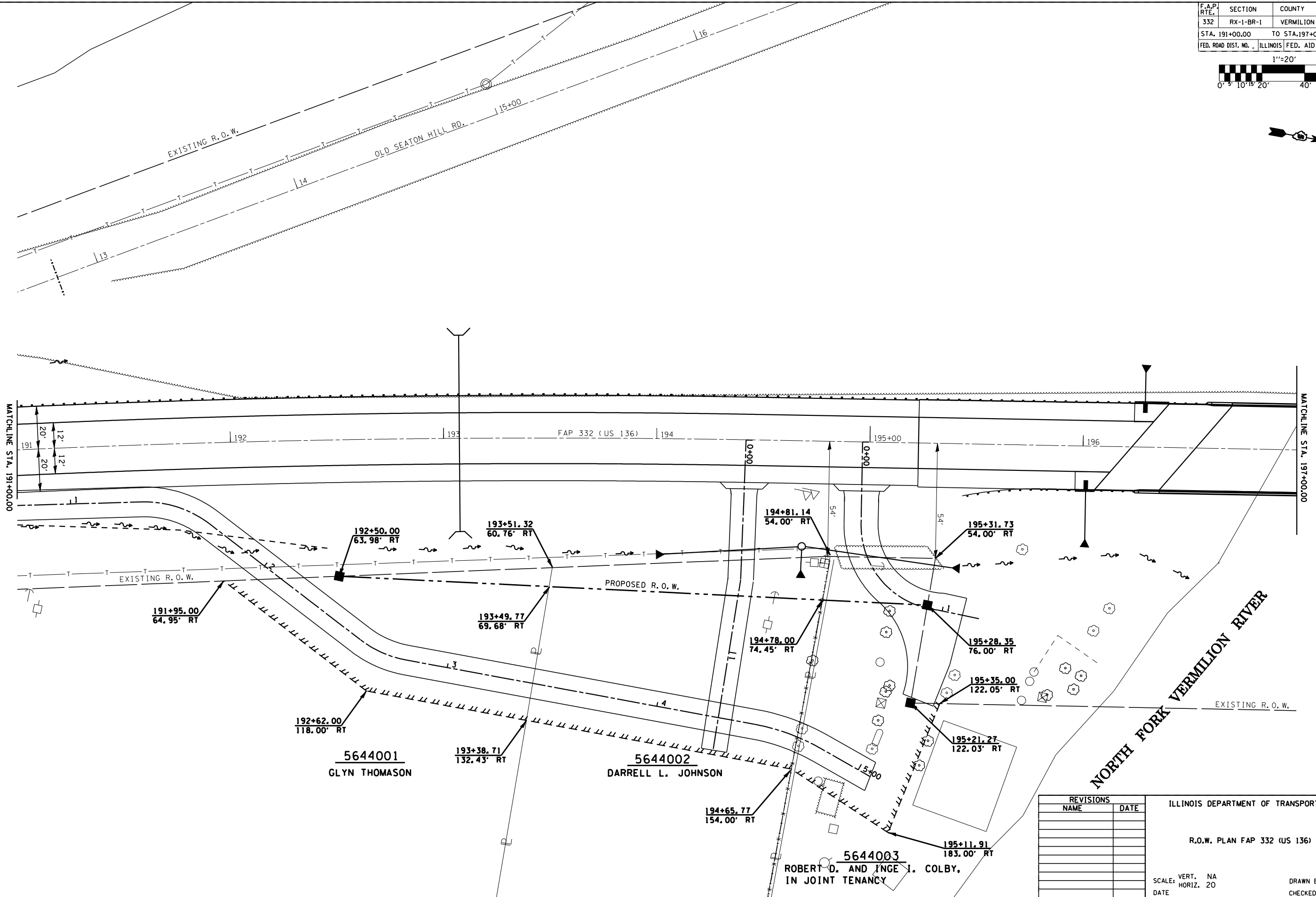
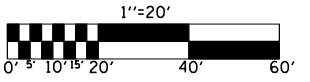

PLOT DATE = 8/28/2006
 FILE NAME = c:\projects\90841\90841\136.rwdgn
 PLOT SCALE = 42.3525' / IN.
 USER NAME = stults,j

REVISIONS	
NAME	DATE

ILLINOIS DEPARTMENT OF TRANSPORTATION

R.O.W. PLAN FAP 332 (US 136)

SCALE: VERT. NA
 HORIZ. 20

DRAWN BY JWS
 CHECKED BY