

F.A.S. RTE.	SECTION	COUNTY	TOTAL SHEETS	SHEET NO.
583	****	SCHUYLER	56	19
STA.		TO STA.		
FED. ROAD DIST. NO.	ILLINOIS	FED. AID PROJECT **		
*** SECTION 02-00067-00-BR				
** BRS-583(111)				

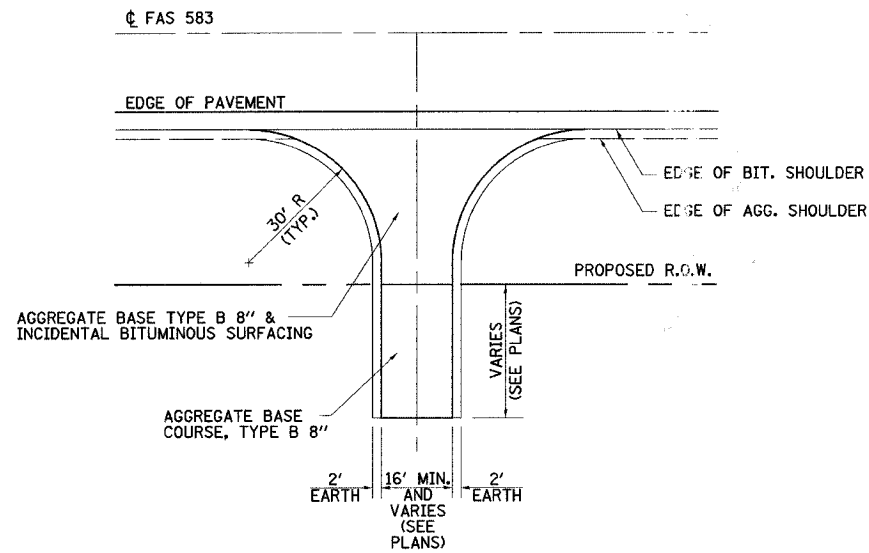

FIELD ENTRANCE DETAIL

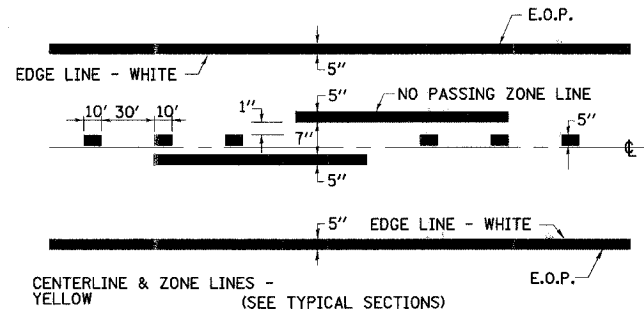

UNLESS DIRECTED BY THE ENGINEER, LINES SHALL NOT BE LAID DIRECTLY OVER A LONGITUDINAL CRACK OR JOINT NOR OVER A TAR OR ASPHALT PAINTED LINE. THE EDGE OF A CENTER LINE OR LANE LINE SHALL BE OFFSET A MINIMUM DISTANCE OF 2 INCHES FROM A LONGITUDINAL CRACK OR JOINT. EDGE LINES SHALL BE APPROXIMATELY 2 INCHES FROM THE EDGE OF PAVEMENT. SEE SECTION 780. OF THE STANDARD SPECIFICATIONS.

PAINT PAVEMENT MARKING DETAIL

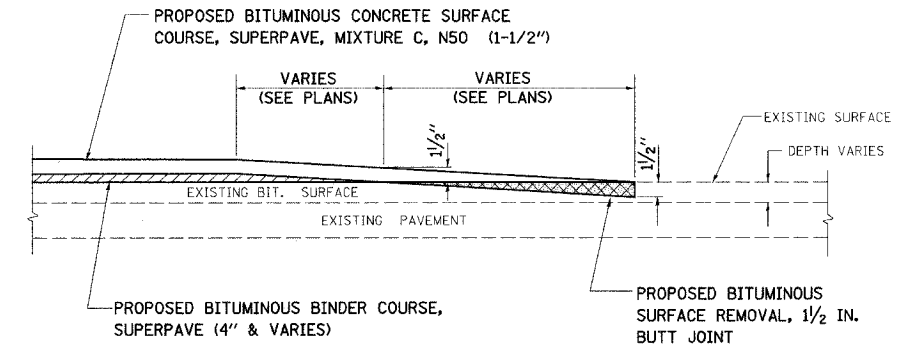

TAPER DETAIL

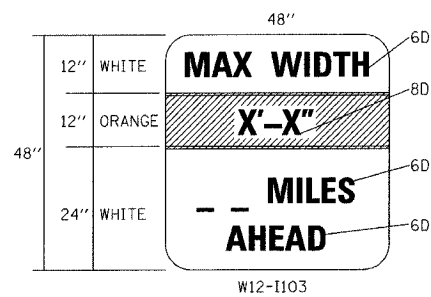

TO BE POST MOUNTED AS SHOWN ON LANE RESTRICTION PLAN SHEET. COST INCLUDED IN PAYMENT FOR STANDARD 701321 (SPECIAL)

THE CONTRACTOR SHALL NOTIFY THE COUNTY ENGINEER 14 CALENDAR DAYS PRIOR TO INSTALLING ANY TRAFFIC CONTROL DEVICES THAT WILL RESTRICT THE PAVEMENT WIDTH.

WIDTH RESTRICTION SIGNING DETAILS

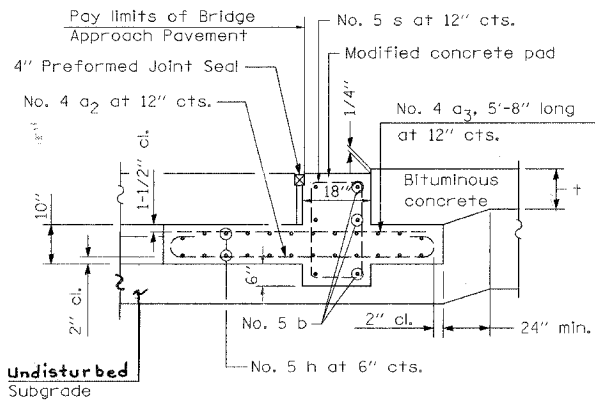
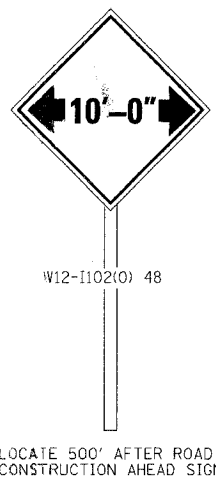

BRIDGE APPROACH PAVEMENT (SPECIAL) SEC. G-G DETAIL

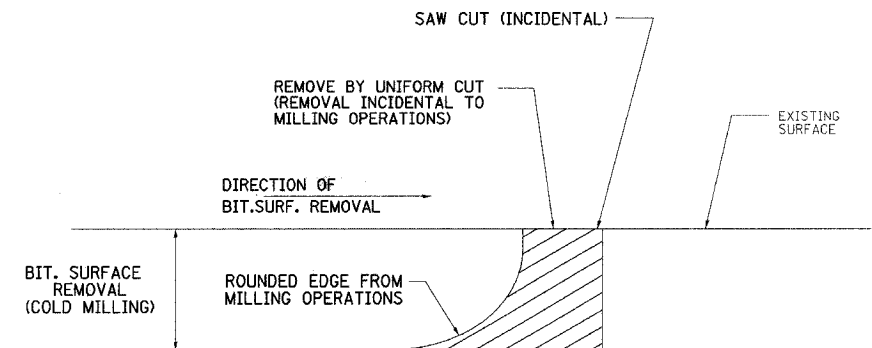

NOTE: WHEN MILLING OPERATIONS PRODUCE A ROUNDED EDGE, THEN A SAW CUT SHALL BE USED TO MANUFACTURE A PERPENDICULAR EDGE AS SHOWN IN THE DETAIL. THE ENGINEER SHALL BE THE SOLE JUDGE CONCERNING THE USE OF THIS DETAIL

BITUMINOUS BUTT JOINT DETAIL

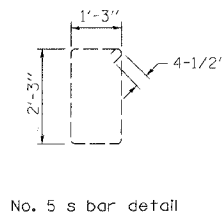

REVISIONS	
NAME	DATE

ILLINOIS DEPARTMENT OF TRANSPORTATION

DETAILS

FAS 583 (CH5) OVER LAMOINE RIVER
SECTION 02-00067-00-BR
SCHUYLER COUNTY

SCALE: VERT. DATE 5/12/06

DRAWN BY SUTHEARD
CHECKED BY BOIT

COMPUTER FILE NO. 02157SPL
PROJECT 02157
9/22/06-MDS

GREENE & BRADFORD, INC.
CONSULTING ENGINEERS
OF SPRINGFIELD
1000 W. WASHINGTON ST., SUITE 200
SPRINGFIELD, ILLINOIS 62760
PROFESSIONAL & STRUCTURAL ENGINEERING CORPORATION
OFFICE NO. 583, 1000 W. WASHINGTON ST., SPRINGFIELD, ILLINOIS 62760