

S.B.I. RTE.	SECTION	COUNTY	TOTAL SHEETS	SHEET NO.
IE	(8C)B-2	WABASH	36	8
FED. ROAD DIST. NO. 7		ILLINOIS	FED. AID PROJECT NO.	

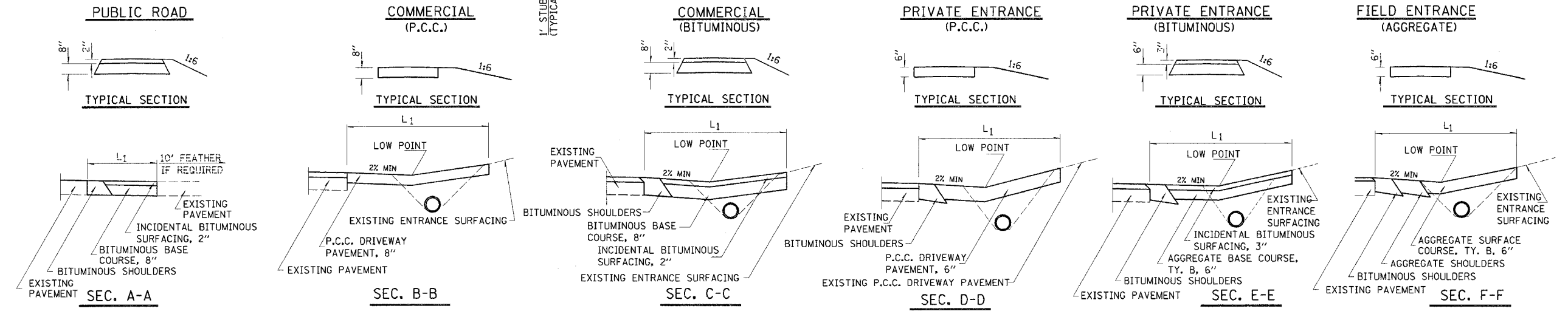
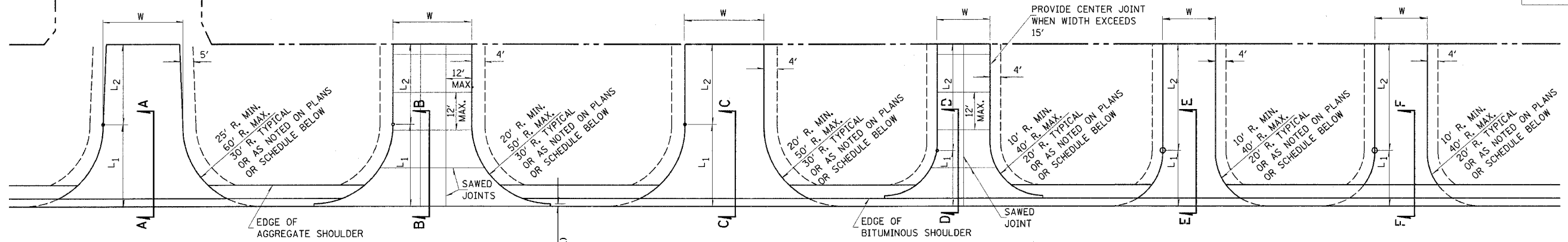

ENTRANCE SCHEDULE

TYPE	SIDE/STATION	WIDTH	LENGTH		RADI	AGGREGATE BASE, CSE. TY. B, 6"	BITUMINOUS BASE COURSE, 8"	AGGREGATE SURF. CSE. TYPE B	INCIDENTAL BITUMINOUS SURFACING	P.C.C. DRIVEWAY PAV'T		PCC PAVEMENT 8"
			L ₁	L ₂						6"	8"	
PE	RT 201+49.17	19	10	12	20	18.5		22.0	9.0			
FE	LT 201+96.00	20	20	10	20		16.3					
FE	LT 206+91.00	14	20	9	20		24.5					
FE	LT 207+75.00	16	20	10	20							

SIDE/STATION	CULVERT SCHEDULE	
	PIPE CULVERT REMOVAL (FOOT)	PIPE CULVERTS, CLASS D, TYPE 1 12" (FOOT)
RT 201+49.17	30	31
TOTALS =	30	31

NOTES

L₁ = DISTANCE FROM EDGE OF PAVEMENT TO RADIUS POINT OR MAXIMUM DISTANCE OF 30'.
 L₂ = DISTANCE FROM RADIUS POINT OR MAXIMUM DISTANCE OF 30' FROM EDGE OF PAVEMENT TO R.O.W. LINE
 MATERIAL USED TO CONSTRUCT L₂ LENGTH SHALL BE THE SAME TYPE OF MATERIAL AS THE EXISTING ENTRANCE

THE THICKNESS OF THE BITUMINOUS SHOULDERS THROUGH COMMERCIAL ENTRANCES (BITUMINOUS) AND PUBLIC ROADS SHALL BE 10". THE COST OF THE EXTRA THICKNESS SHALL BE INCLUDED WITH THE BITUMINOUS SHOULDERS PAY ITEM.

THE COST OF THE BITUMINOUS MATERIALS AND AGGREGATE (PRIME COAT) FOR ENTRANCES AND PUBLIC ROAD APPROACHES SHALL BE INCLUDED IN THE PAY ITEM INCIDENTAL BITUMINOUS SURFACING.