

STRUCTURE NUMBER 041-0057

F.A.I. RTE.	SECTION	COUNTY	TOTAL SHEETS	SHEET NO.
57	*	VARIOUS	21	16
STA. _____		TO STA. _____		
FED. ROAD DIST. NO.	ILLINOIS	FED. AID PROJECT		

\* D-9 SAFETY FY 07-1

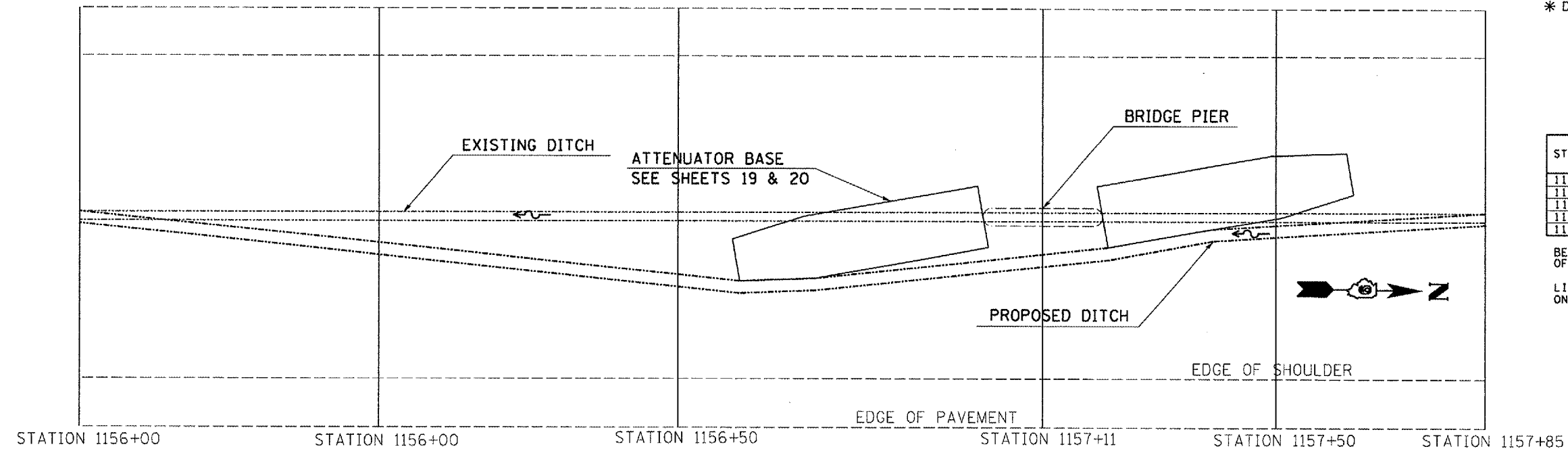

ELEVATIONS

STATION	EDGE OF SOUTHBOUND PAVEMENT	EXISTING FLOWLINE	PROPOSED FLOWLINE
1156+00	20.00	15.20	16.84
1156+50	20.24	15.53	17.38
1157+11	20.43	16.63	17.38
1157+50	20.80	17.15	18.30
1158+00	21.30	16.47	16.47

BENCH MARK STATION 1156+00, INSIDE EDGE OF SOUTHBOUND PAVEMENT, ELEVATION 20.00

LISTED ELEVATIONS ARE LOCAL REFERENCE ONLY. NO TIES TO U. S. G. S. COORDINATES.

STRUCTURE NUMBER 041-0058

ELEVATIONS

STATION	EDGE OF SOUTHBOUND PAVEMENT	EXISTING FLOWLINE	PROPOSED FLOWLINE
526+50	9.39	5.80	5.81
527+00	10.00	6.21	6.22
527+50	10.61	6.62	6.63
527+80	11.00	6.88	7.82
527+90	11.13	6.97	8.29
528+15	11.43	7.26	8.90
528+50	11.86	7.66	9.24
529+00	11.66	8.66	9.26
529+50	11.50	9.66	9.27

BENCH MARK STATION 527+00, INSIDE EDGE OF SOUTHBOUND PAVEMENT, ELEVATION 10.00

LISTED ELEVATIONS ARE LOCAL REFERENCE ONLY. NO TIES TO U. S. G. S. COORDINATES.

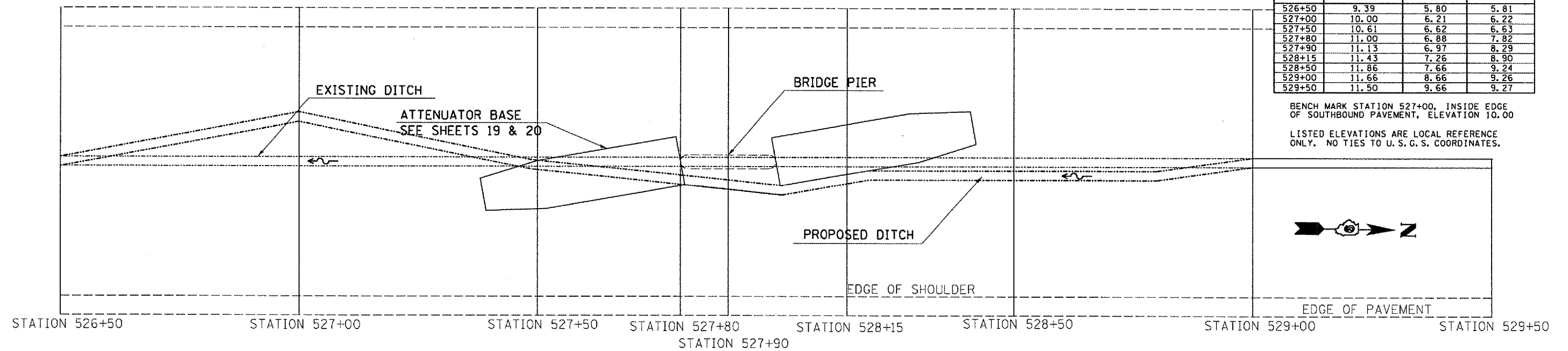

PLOT DATE = 8/21/2006  
 PLOT SCALE = 1/8" = 100'  
 USER NAME = shepardg