

F.A.I. RTE.	SECTION	COUNTY	TOTAL SHEETS	SHEET NO.
57	*	VARIOUS	21	1

* D-9 SAFETY FY 07-1

D-99-041-06

+5
26

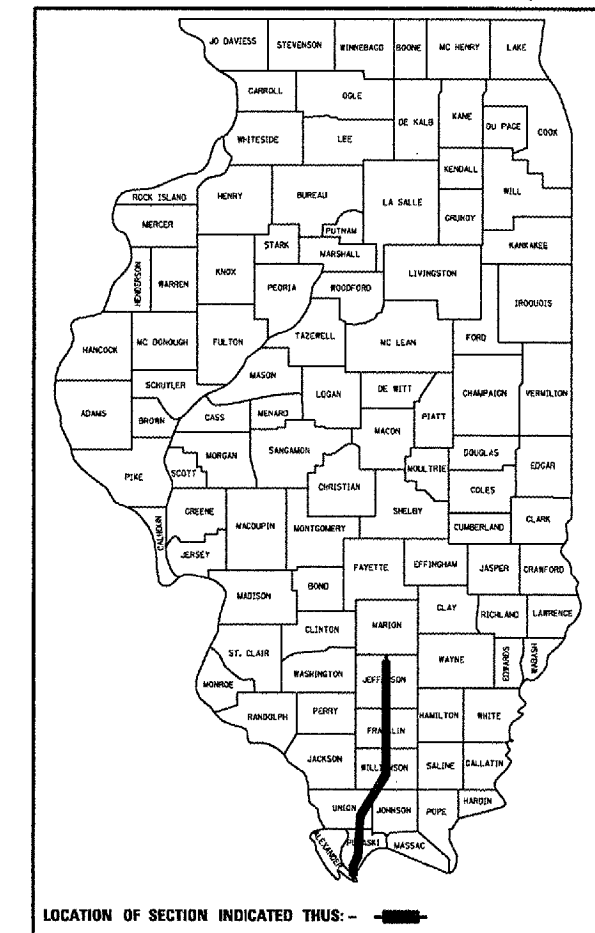

STATE OF ILLINOIS DEPARTMENT OF TRANSPORTATION DIVISION OF HIGHWAYS

PROPOSED INTERSTATE HIGHWAY PLANS

**F.A.I. ROUTE 57 (I-57)
SECTION D-9 SAFETY FY 07-1
PROJECT NO: HSIP-057-1 (195)004
VARIOUS COUNTIES
C-99-051-06**

INDEX OF SHEETS

SHEET NO.	DESCRIPTION
1	COVER SHEET
2	GENERAL NOTES LISTING OF APPLICABLE HIGHWAY STANDARDS
3	SUMMARY OF QUANTITIES
3A.-3D.	SOIL BORING LOGS
4-4A	TYPICAL SECTIONS
5-7	SCHEDULES OF QUANTITIES
8-14	PLAN SHEETS FOR CABLE BARRIER SYSTEM
15-18	DETAILS FOR PIER PROTECTION PLACEMENT
19	DETAIL FOR DRAIN IN ATTENUATOR BASE
20	DETAIL OF SLOPES FOR ATTENUATOR BASE
21	DETAIL OF SLOPES FOR ATTENUATOR BASE WITH AN EXISTING DRAINAGE STRUCTURE

HIGHWAY STANDARDS

MEDIAN CABLE BARRIER SYSTEM

WILLIAMSON COUNTY
MILE POST 48.9 - 52.75
STATION 1542+00 TO STATION 165+50
STATION EQUATION
STA 1572+91.08 @ BK = STA 0+00.00 @ AH

SHOULDER RUMBLE STRIP

VARIOUS COUNTIES
NORTHBOUND LANES: MILEPOST 20.75 TO 50.55
SOUTHBOUND LANES: MILEPOST 20.75 TO 80.68

CENTER PIER PROTECTION

VARIOUS COUNTIES
MILE POST 4.29 - 104
15 LOCATIONS

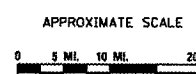
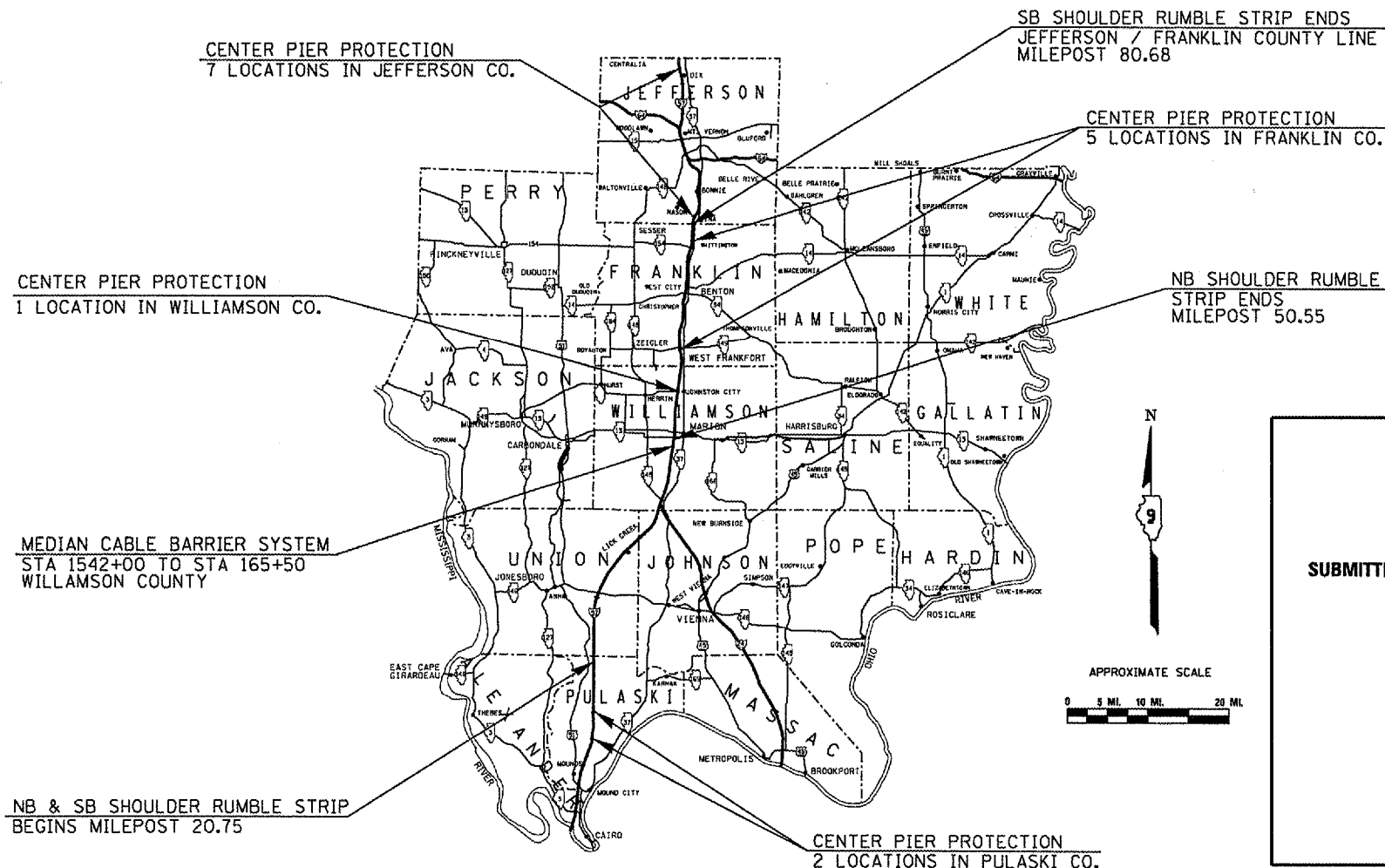

**STATE OF ILLINOIS
DEPARTMENT OF TRANSPORTATION
DIVISION OF HIGHWAYS**

SUBMITTED Aug 21 20 06
Man Chams
DEPUTY DIRECTOR OF HIGHWAYS, REGION ENGINEER

October 13, 20 06
Mike Dine
ENGINEER OF DESIGN AND ENVIRONMENT

October 13, 20 06
Milton R. Saes P.E.
DIRECTOR OF HIGHWAYS, CHIEF ENGINEER

**PRINTED BY THE AUTHORITY
OF THE STATE OF ILLINOIS**

J.U.L.I.E.
JOINT UTILITY LOCATION INFORMATION FOR EXCAVATION
1-800-892-0123 or www.juliecall.com

GROSS LENGTH OF PROJECT = 99.71 MILES (SB)
99.71 MILES (NB)
NET LENGTH OF PROJECT = 60.00 MILES (SB)
30.00 MILES (NB)

CONTRACT NO. 98982

PROJECT ENGINEER: CHARLES STEIN
DESIGNER: CINDY DETERING
618: 549-2171
CENTREX 782-4554

Rev.

F.A.I. RTE.	SECTION	COUNTY	TOTAL SHEETS	SHEET NO.
57	*	VARIOUS	21	2
STA. _____		TO STA. _____		
FED. ROAD DIST. NO. _____		ILLINOIS	FED. AID PROJECT	

* D-9 SAFETY FY 07-1

GENERAL NOTES

THE COST OF ANY EXCAVATION OR BUSH REMOVAL SHALL BE INCLUDED IN THE COST OF SAND MODULE IMPACT ATTENUATORS.

EXISTING PIPE UNDERDRAIN OUTLETS AND DRAINAGE STRUCTURES IN THE MEDIAN SLOPES SHALL BE PRESERVED AND PROTECTED DURING CONSTRUCTION. ANY DAMAGE TO AN UNDERDRAIN OUTLET RESULTING FROM CONSTRUCTION ACTIVITY SHALL BE REPAIRED AT THE CONTRACTOR'S EXPENSE.

IN ADDITION TO THE REQUIREMENTS OF ARTICLE 107.16, THE CONTRACTOR SHALL PROTECT THE SURFACE OF ALL BRIDGE DECKS AND BRIDGE APPROACH PAVEMENTS IN A MANNER SATISFACTORY TO THE ENGINEER BEFORE ANY EQUIPMENT IS ALLOWED TO CROSS THE STRUCTURE. PROTECTION SHALL BE PROVIDED FOR ALL EQUIPMENT AS DEFINED IN ARTICLE 107.16 REGARDLESS IF TRACK MOUNTED OR WHEELED.

TWO APPLICATIONS OF TEMPORARY EROSION CONTROL SEEDING HAVE BEEN INCLUDED. THE ACTUAL QUANTITY, LOCATIONS, AND APPLICATIONS SHALL BE AS DIRECTED BY THE ENGINEER. THE APPLICATION RATE SHALL BE AS PER ARTICLE 280.04(f).

REVISE THE FIRST SENTENCE OF ARTICLE 107.09 PUBLIC CONVIENCE AND SAFETY TO THE FOLLOWING "THE CONTRACTOR SHALL NOTIFY THE ENGINEER AT LEAST 14 DAYS IN ADVANCE OF STARTING ANY CONSTRUCTION WORK. THIS ADDITIONAL INFORMATION IS REQUIRED SO THAT THE PUBLIC CAN BE NOTIFIED OF THE PENDING CONSTRUCTION."

STANDARDS

000001-04	701101-01
	701106-01
280001-02	701400-02
	701406-04
542401	701426-02
642001	702001-06

Prepared By:	<i>Joe Zdanowicz</i> DISTRICT STUDIES & PLANS ENGINEER
Examined By:	<i>James Travis Emery</i> DISTRICT LAND ACQUISITION ENGINEER
Examined By:	<i>Carrie Nelson</i> DISTRICT PROGRAM DEVELOPMENT ENGINEER
Examined By:	<i>Kevin Hammer</i> DISTRICT OPERATIONS ENGINEER
Examined By:	<i>Joseph Legini</i> DISTRICT CONSTRUCTION ENGINEER
Examined By:	<i>Bruce D. Dwyer</i> DISTRICT MATERIALS ENGINEER
Examined By:	<i>John Smothers</i> DISTRICT PROJECT IMPLEMENTATION ENGINEER
Examined By:	<i>Anna L. Taylor</i> ASSISTANT REGIONAL ENGINEER
Approved By:	<i>May K. Harris</i> DEPUTY DIRECTOR OF HIGHWAYS, REGION ENGINEER
DATE	Aug 21 20 06

Rev.

F.A.I. RTE.	SECTION	COUNTY	TOTAL SHEETS	SHEET NO.
57	*	VARIOUS	21	3
STA. _____		TO STA. _____		
FED. ROAD DIST. NO. _____		ILLINOIS FED. AID PROJECT		
* D-9 SAFETY FY 07-1				

SUMMARY OF QUANTITIES

VARIOUS COUNTIES

CODE NUMBER	ITEM DESCRIPTION	UNIT	TOTAL QUANTITY	HSIP 90% FEDERAL / 10% STATE									
				PULASKI COUNTY	PULASKI COUNTY	UNION COUNTY	JOHNSON COUNTY	WILLIAMSON COUNTY	WILLIAMSON COUNTY	WILLIAMSON COUNTY	FRANKLIN COUNTY	FRANKLIN COUNTY	JEFFERSON COUNTY
	CONSTRUCTION TYPE CODE			SFTY - 2A	SFTY - 3N	SFTY - 2A	SFTY - 2A	SFTY - 2A	SFTY - 3N	SFTY - 4A	SFTY - 2A	SFTY - 3N	I 000
X0325586	MOW STRIP	SQ YD	8,498							8498			
X0325589	HIGH TENSION CABLE MEDIAN BARRIER	FOOT	18,680							18680			
X0325590	HIGH TENSION CABLE MEDIAN BARRIER TERMINAL	EACH	10							10			
X0325588	HIGH TENSION CABLE MEDIAN BARRIER DEMONSTRATION	L SUM	1							1			
X7015000	CHANGEABLE MESSAGE SIGN	CAL MO	3	1.5									1.5
Z0030150	IMPACT ATTENUATORS (NON-REDIRECTIVE), TEST LEVEL 3	EACH	30		4				2			24	
20400800	FURNISHED EXCAVATION	CU YD	1,635										1635
25000350	SEEDING, CLASS 7	ACRE	6.5	0.8				0.2		1.8	1.5		2.2
25000400	NITROGEN FERTILIZER NUTRIENT	POUND	1,040	128				32		288	240		352
25000500	PHOSPHORUS FERTILIZER NUTRIENT	POUND	780	96				24		216	180		264
25000600	POTASSIUM FERTILIZER NUTRIENT	POUND	780	96				24		216	180		264
25000700	AGRICULTURAL GROUND LIMESTONE	TON	13.0	1.6				0.4		3.6	3.0		4.4
25001010	SEEDING, CLASS 2 (MODIFIED)	ACRE	6.5	0.8				0.2		1.8	1.5		2.2
25100115	MULCH, METHOD 2	ACRE	13.0	1.6				0.4		3.6	3.0		4.4
28000300	TEMPORARY DITCH CHECKS	EACH	45	6				3			15		21
54200217	PIPE CULVERTS, CLASS D, TYPE 1 12"	FOOT	40										40
54215547	METAL END SECTIONS 12"	EACH	2										2
63400205	GUARD POSTS REMOVAL	EACH	8										8
64200105	SHOULDER RUMBLE STRIP	FOOT	879,369	26,612		340,451	87,000	238,058				187,248	
67000400	ENGINEERS FIELD OFFICE	CAL MO	9	1.5		1.5	1.5			1.5	1.5		1.5
67100100	MOBILIZATION	L SUM	1	0.16		0.17	0.17			0.17	0.16		0.17
70100700	TRAFFIC CONTROL AND PROTECTION, STANDARD 701406	L SUM	1	0.16		0.17	0.17			0.17	0.16		0.17
80300100	LOCATING UNDERGROUND CABLE	FOOT	100					100					

PLOT DATE = 8/22/2006
 FILE NAME = c:\puro\mca\p984108\p984108.dwg
 PLOT SCALE = 1/8"=1'-0" IN.
 USER NAME = jasperggd

F.A.I. RTE.	SECTION	COUNTY	TOTAL SHEETS	SHEET NO.
57	*	VARIOUS	21	4

STA. _____ TO STA. _____
 FED. ROAD DIST. NO. _ ILLINOIS FED. AID PROJECT

* D-9 SAFETY FY 07-1

TYPICAL SECTION #1

CABLE BARRIER SYSTEM
 I-57 WILLIAMSON COUNTY

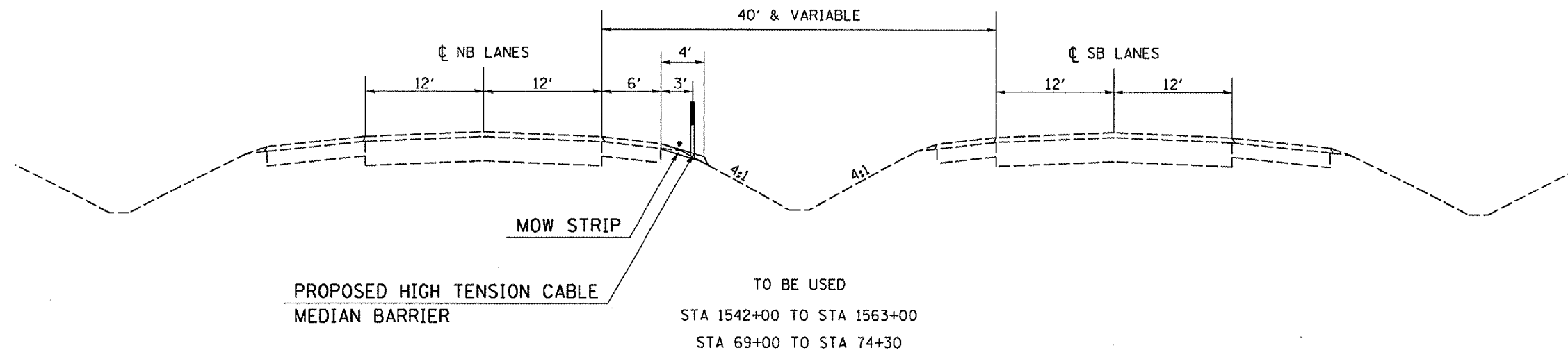

• MATCH EXISTING SLOPES

TYPICAL SECTION #2

CABLE BARRIER SYSTEM
 I-57 WILLIAMSON COUNTY

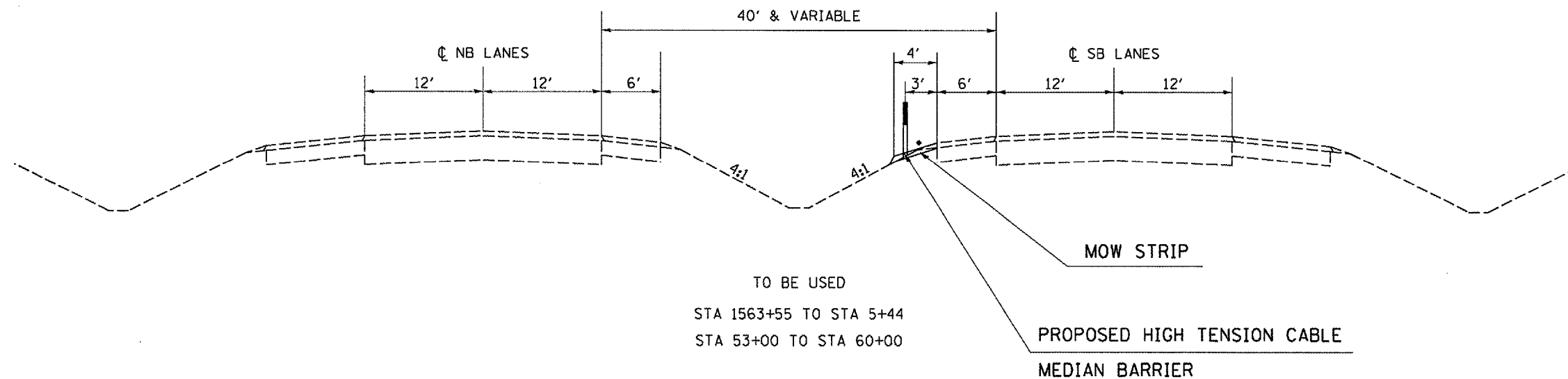

TO BE USED
 STA 1563+55 TO STA 5+44
 STA 53+00 TO STA 60+00

STATION EQUATION

STA 1572+91.05 BK = STA 0+00.00 AH

• MATCH EXISTING SLOPES

PLOT DATE = 8/21/2006
 PLOT SCALE = 1/8" = 1'-0"
 USER NAME = shapardgf

F.A.I. RTE.	SECTION	COUNTY	TOTAL SHEETS	SHEET NO.
57	*	VARIOUS	21	6
STA. _____		TO STA. _____		
FED. ROAD DIST. NO. _____		ILLINOIS FED. AID PROJECT		
* D-9 SAFETY FY 07-1				

RUMBLE STRIP SCHEDULE

LOCATION MILEPOST TO MILEPOST	RUMBLE STRIP	REMARKS
	FOOT	
PULASKI COUNTY		
FAI 57		
NB LANES		
OUTSIDE SHOULDER MP 20.75 TO MP 22.01	6653	
MEDIAN SHOULDER MP 20.75 TO MP 22.01	6653	
SB LANES		
OUTSIDE SHOULDER MP 20.75 TO MP 22.01	6653	
MEDIAN SHOULDER MP 20.75 TO MP 22.01	6653	
COUNTY TOTAL:	26,612	
UNION COUNTY		
FAI 57		
NB LANES		
OUTSIDE SHOULDER MP 22.01 TO MP 39.02	82,439	GAP SN 091-0001 (121') GAP EXIT RAMP AT DONGOLA INTERCHANGE (528') GAP SN 091-0004 (339') GAP ENTRANCE RAMP AT DONGOLA INTERCHANGE (900') GAP SN 091-0005 (195'), SN 091-0007 (210'), SN 091-0009 (175') GAP EXIT RAMP AT IL 146 INTERCHANGE (450') GAP SN 091-0011 (137') GAP ENTRANCE RAMP AT IL 146 INTERCHANGE (800') GAP EXIT RAMP AT TRAIL OF TEARS REST AREA (530') GAP ENTRANCE RAMP AT TRAIL OF TEARS REST AREA (1050') GAP SN 091-0013 (192'), SN 091-0015 (127') GAP EXIT RAMP AT LICK CREEK INTERCHANGE (580') GAP ENTRANCE RAMP AT LICK CREEK INTERCHANGE (800') GAP SN 091-0017 (240') TOTAL LENGTH TO BE GAPPED FOR OUTSIDE SHOULDER = 7374'
MEDIAN SHOULDER MP 22.01 TO MP 39.02	88,077	GAP SN 091-0001 (121'), SN 091-0004 (339'), SN 091-0005 (195'), SN 091-0007 (210'), SN 091-0009 (175'), SN 091-0011 (137'), SN 091-0013 (192'), SN 091-0015 (127'), SN 091-0017 (240') TOTAL LENGTH TO BE GAPPED FOR MEDIAN SHOULDER = 1736'
SB LANES		
OUTSIDE SHOULDER MP 22.01 TO MP 39.02	81,830	GAP SN 091-0002 (121') GAP ENTRANCE RAMP AT DONGOLA INTERCHANGE (850') GAP SN 091-0003 (339') GAP EXIT RAMP AT DONGOLA INTERCHANGE (460') GAP SN 091-0006 (167') GAP ENTRANCE RAMP AT US 51 INTERCHANGE (680') GAP SN 091-0008 (210'), SN 091-0010 (175') GAP ENTRANCE RAMP AT IL 146 INTERCHANGE (885') GAP SN 091-0012 (137') GAP EXIT RAMP AT IL 146 INTERCHANGE (440') GAP ENTRANCE RAMP AT TRAIL OF TEARS REST AREA (1050') GAP EXIT RAMP AT TRAIL OF TEARS REST AREA (530') GAP SN 091-0014 (192'), SN 091-0016 (127') GAP ENTRANCE RAMP AT LICK CREEK INTERCHANGE (800') GAP EXIT RAMP AT LICK CREEK INTERCHANGE (580') GAP SN 091-0018 (240') TOTAL LENGTH TO BE GAPPED FOR OUTSIDE SHOULDER = 7983'
MEDIAN SHOULDER MP 22.01 TO MP 39.02	88,105	GAP SN 091-0002 (121'), SN 091-0003 (339'), SN 091-0006 (167'), SN 091-0008 (210'), SN 091-0010 (175'), SN 091-0012 (137'), SN 091-0014 (192'), SN 091-0016 (127'), SN 091-0018 (240') TOTAL LENGTH TO BE GAPPED FOR MEDIAN SHOULDER = 1708'
COUNTY TOTAL:	340,451	

LOCATION MILEPOST TO MILEPOST	RUMBLE STRIP	REMARKS
	FOOT	
JOHNSON COUNTY		
FAI 57		
NB LANES		
OUTSIDE SHOULDER MP 39.02 TO MP 43.27	21,060	GAP EXIT RAMP AT GOREVILLE INTERCHANGE (580') GAP ENTRANCE RAMP AT GOREVILLE INTERCHANGE (800') TOTAL LENGTH TO BE GAPPED FOR OUTSIDE SHOULDER = 1380'
MEDIAN SHOULDER		
MP 39.02 TO MP 43.27	22,440	
SB LANES		
OUTSIDE SHOULDER MP 39.02 TO MP 43.27	21,060	GAP ENTRANCE RAMP AT GOREVILLE INTERCHANGE (800') GAP EXIT RAMP AT GOREVILLE INTERCHANGE (580') TOTAL LENGTH TO BE GAPPED FOR OUTSIDE SHOULDER = 1380'
MEDIAN SHOULDER		
MP 39.02 TO MP 43.27	22,440	
COUNTY TOTAL:	87,000	
WILLIAMSON		
FAI 57		
NB LANES		
OUTSIDE SHOULDER MP 43.27 TO MP 50.55	33,188	GAP EXIT RAMP AT FAI 24 INTERCHANGE (656') GAP ENTRANCE RAMP AT FAI 24 INTERCHANGE (1220') GAP EXIT RAMP AT IL 148 INTERCHANGE (580') GAP ENTRANCE RAMP AT IL 148 INTERCHANGE (830') GAP EXIT RAMP AT WEIGH STATION (595') GAP ENTRANCE RAMP AT WEIGH STATION (1370') TOTAL LENGTH TO BE GAPPED FOR OUTSIDE SHOULDER = 5251'
MEDIAN SHOULDER		
MP 43.27 TO MP 50.55	38,439	
SB LANES		
OUTSIDE SHOULDER MP 43.27 TO MP 62.10	80,528	GAP ENTRANCE RAMP AT FAI 24 INTERCHANGE (1000') GAP EXIT RAMP AT FAI 24 INTERCHANGE (2025') GAP EXIT RAMP AT IL 148 INTERCHANGE (580') GAP ENTRANCE RAMP AT WEIGH STATION (1370') GAP EXIT RAMP AT WEIGH STATION (400') GAP CRAB ORCHARD CREEK PROJECT (2500') GAP OLD IL13 & IL 13 INTERCHANGE PROJECT (6920') GAP LAKE CREEK-JOHNSTON CITY INTERCHANGE PROJECT (4100') TOTAL LENGTH TO BE GAPPED FOR OUTSIDE SHOULDER = 18,895'
MEDIAN SHOULDER		
MP 43.27 TO MP 62.10	85,903	GAP CRAB ORCHARD CREEK PROJECT (2500') GAP OLD IL13 & IL 13 INTERCHANGE PROJECT (6920') GAP LAKE CREEK-JOHNSTON CITY INTERCHANGE PROJECT (4100') TOTAL TO BE GAPPED FOR MEDIAN SHOULDER = 13,520'
COUNTY TOTAL:	238,058	

PLOT DATE = 8/21/2006
 FILE NAME = c:\pvc\secta\p98106\p98106sch.mxd
 PLOT SCALE = 1/8"=100'
 USER NAME = shpaar-dgd

F.A.I. RTE.	SECTION	COUNTY	TOTAL SHEETS	SHEET NO.
57	*	VARIOUS	21	7
STA. _____		TO STA. _____		
FED. ROAD DIST. NO. _____		ILLINOIS FED. AID PROJECT		
* D-9 SAFETY FY 07-1				

RUMBLE STRIP SCHEDULE

LOCATION MILEPOST TO MILEPOST	RUMBLE STRIP	REMARKS
	FOOT	
FRANKLIN		
FAL 57		
SB LANES		
OUTSIDE SHOULDER		
MP 62.10 TO MP 80.68	90,367	GAP SN 028-0002 (133') GAP ENTRANCE RAMP AT IL 149 INTERCHANGE (900') GAP EXIT RAMP AT IL 149 INTERCHANGE (490') GAP SN 028-0005 (195'), SN 028-0007 (368'), SN 028-0008 (235'), GAP ENTRANCE RAMP AT IL 14 INTERCHANGE (900') GAP EXIT RAMP AT IL 14 INTERCHANGE (600') GAP SN 028-0011 (128') GAP ENTRANCE RAMP AT IL 154 INTERCHANGE (940') GAP EXIT RAMP AT IL 154 INTERCHANGE (660') GAP ENTRANCE RAMP AT REST AREA (1225') GAP SN 028-0014 & EXIT RAMP AT REST AREA (962') TOTAL TO BE GAPPED FOR OUTSIDE SHOULDER = 7736'
MEDIAN SHOULDER		
MP 62.10 TO MP 80.68	96,881	GAP SN 028-0002 (133'), SN 028-0005 (195'), SN 028-0007 (368'), SN 028-0008 (235'), SN 028-0011 (128'), SN 028-0014 (163') TOTAL TO BE GAPPED FOR MEDIAN SHOULDER = 1222'
COUNTY TOTAL:	187,248	
PROJECT TOTAL:	879,369	

CABLE BARRIER SCHEDULE

LOCATION STATION TO STATION	REMARKS	LENGTH	HIGH TENSION CABLE	HIGH TENSION CABLE	MOW STRIP	NOTES
			MEDIAN BARRIER	MEDIAN BARRIER		
			FOOT	EACH	SO YD	
1542+00.0 TO 1542+44.0	TERMINAL SECTION	44		1	20	
1542+44.0 TO 1562+56.0		2,012	2,012		894	
1562+56.0 TO 1563+00.0	TERMINAL SECTION	44		1	20	
1563+00.0 TO 1563+55.0	GAP CROSS-OVER					
1563+55.0 TO 1563+99.0	TERMINAL SECTION	44		1	20	CABLE TRANSITIONS FROM TYPICAL #1 TO #2
1563+99.0 TO 1572+91.1		892	892		396	
1572+91.1 TO 0+00	STATION EQUATION					
0+00 TO 5+00.0		500	500		222	
5+00.0 TO 5+44.0	2 TERMINAL SECTIONS	44		2	39	CABLE TRANSITIONS FROM TYPICAL #2 TO #3
5+44.0 TO 41+16.0		3,572	3,572		1,588	
41+16.0 TO 41+60.0	TERMINAL SECTION	44		1	20	TERMINAL SECTION FLAIRS TO WEST OF BNRR OVERPASS PIER
41+40.0 TO 41+84.0	TERMINAL SECTION	44		1	20	TERMINAL SECTION FLAIRS FROM EAST OF BNRR OVERPASS PIER
41+84.0 TO 50+00.0		816	816		363	
50+00.0 TO 53+00.0		300	300		133	
53+00.0 TO 61+26.0		826	826		367	CABLE TRANSITIONS FROM TYPICAL #3 TO #2
61+26.0 TO 61+70.0	TERMINAL SECTION	44		1	20	
61+70.0 TO 67+00.0	GAP CRAB ORCHARD CREEK	530				
67+00.0 TO 67+44.0	TERMINAL SECTION	44		1	20	
67+44.0 TO 74+30.0		686	686		305	
74+30.0 TO 78+50.0		420	420		187	
78+50.0 TO 165+06.0		8,656	8,656		3,847	CABLE TRANSITIONS FROM TYPICAL #1 TO #3
165+06.0 TO 165+50.0	TERMINAL SECTION	44		1	20	
PROJECT TOTALS:			18,680	10	8,498	

PLOT DATE = 9/20/08
 FILE NAME = c:\pwworkspace\98982\98982.dwg
 PLOT SCALE = 1/8" = 1'-0"
 USER NAME = shppardgl

F.A.I. RTE.	SECTION	COUNTY	TOTAL SHEETS	SHEET NO.
57	*	VARIOUS	21	8
STA. _____ TO STA. _____		FED. ROAD DIST. NO. ILLINOIS FED. AID PROJECT		
* D-9 SAFETY FY 07-1				

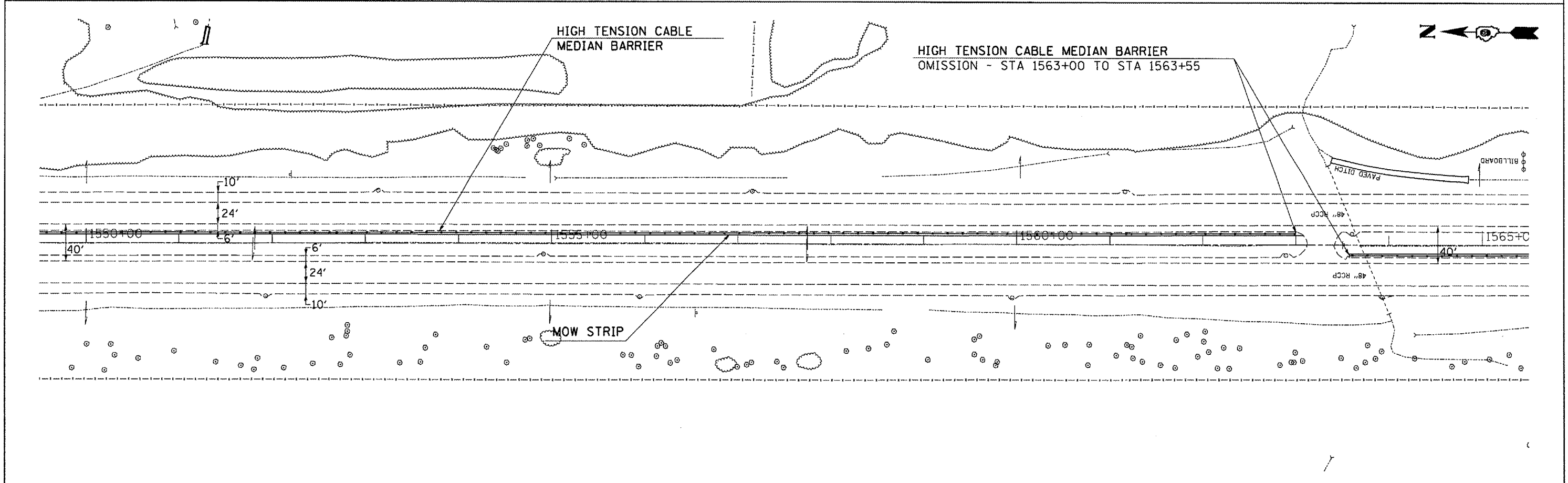
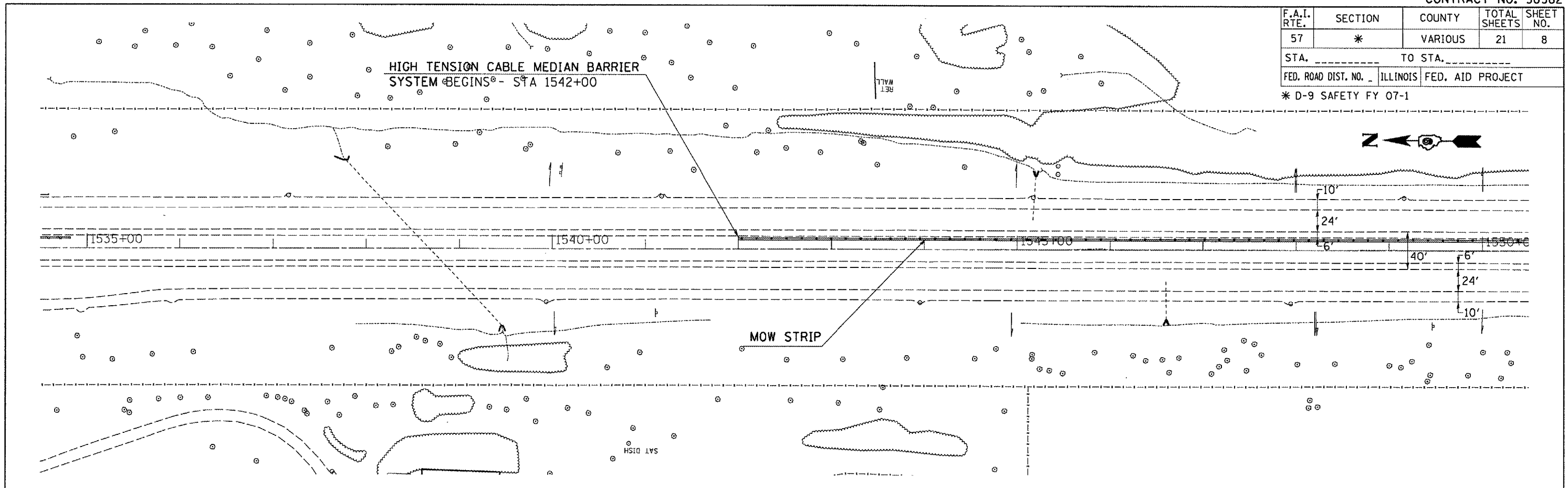

PLOT DATE = 8/21/2006
 PLOT SCALE = 1"=40'
 USER NAME =

F.A.I. RTE.	SECTION	COUNTY	TOTAL SHEETS	SHEET NO.
57	*	VARIOUS	21	9
STA. _____ TO STA. _____				
FED. ROAD DIST. NO. _____ ILLINOIS		FED. AID PROJECT		
* D-9 SAFETY FY 07-1				

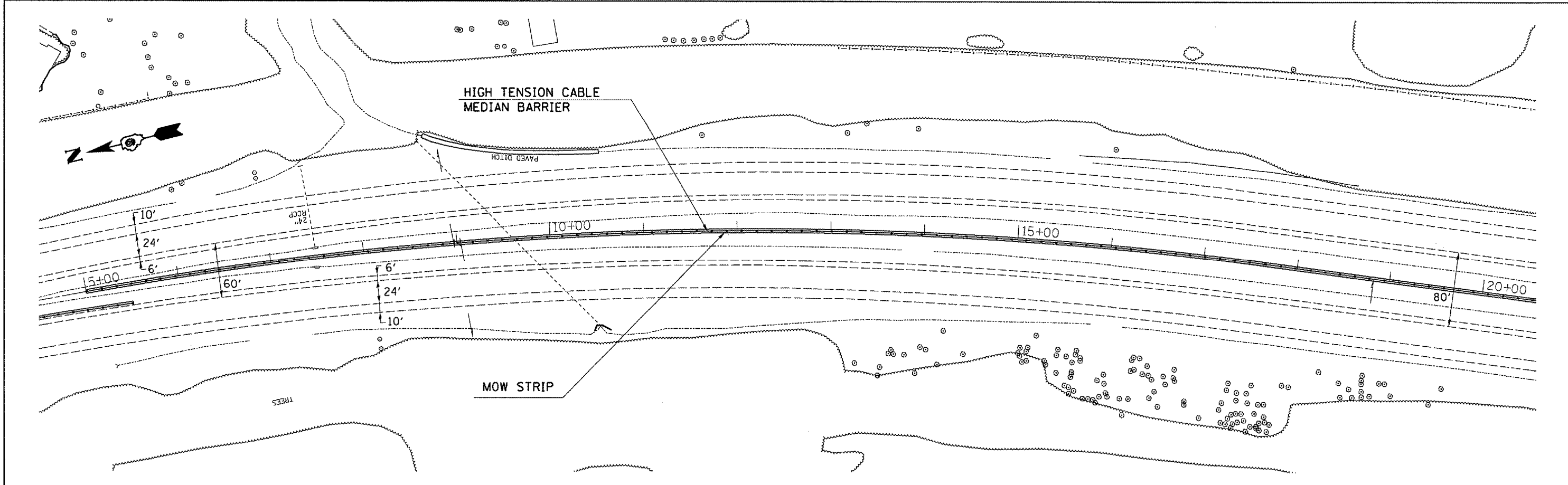
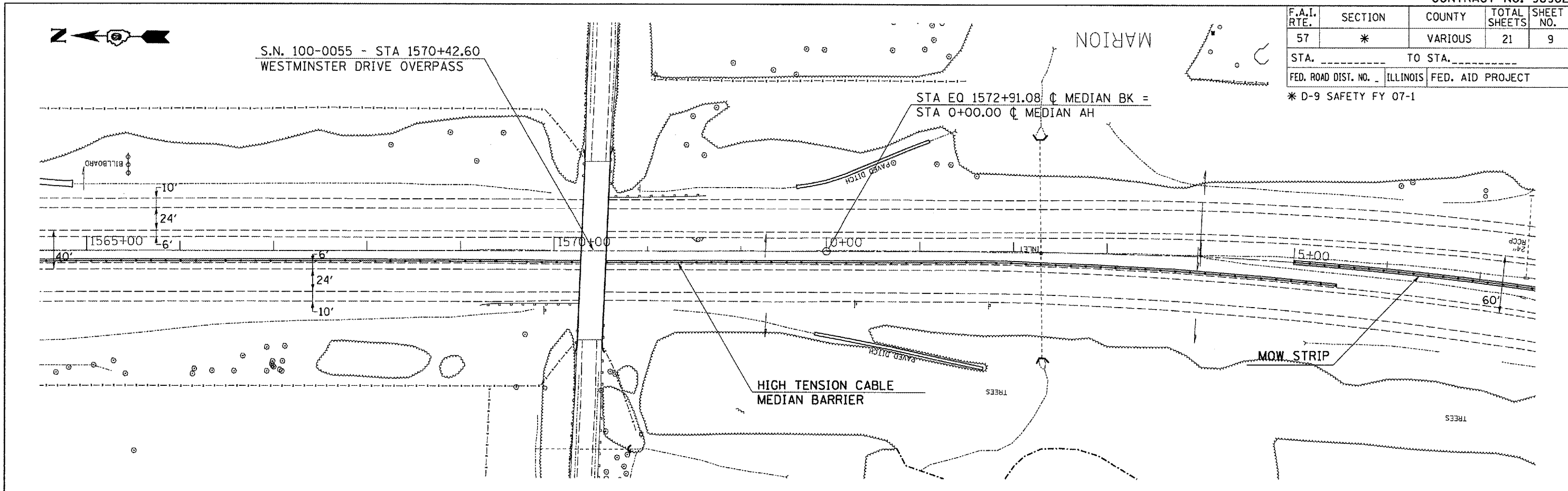

PLOT DATE = 8/21/2006
 PLOT SCALE = 1/8"=1'-0"
 USER NAME = shepardg

F.A.I. RTE.	SECTION	COUNTY	TOTAL SHEETS	SHEET NO.
57	*	VARIOUS	21	10
STA. _____ TO STA. _____				
FED. ROAD DIST. NO. _____		ILLINOIS FED. AID PROJECT		
* D-9 SAFETY FY 07-1				

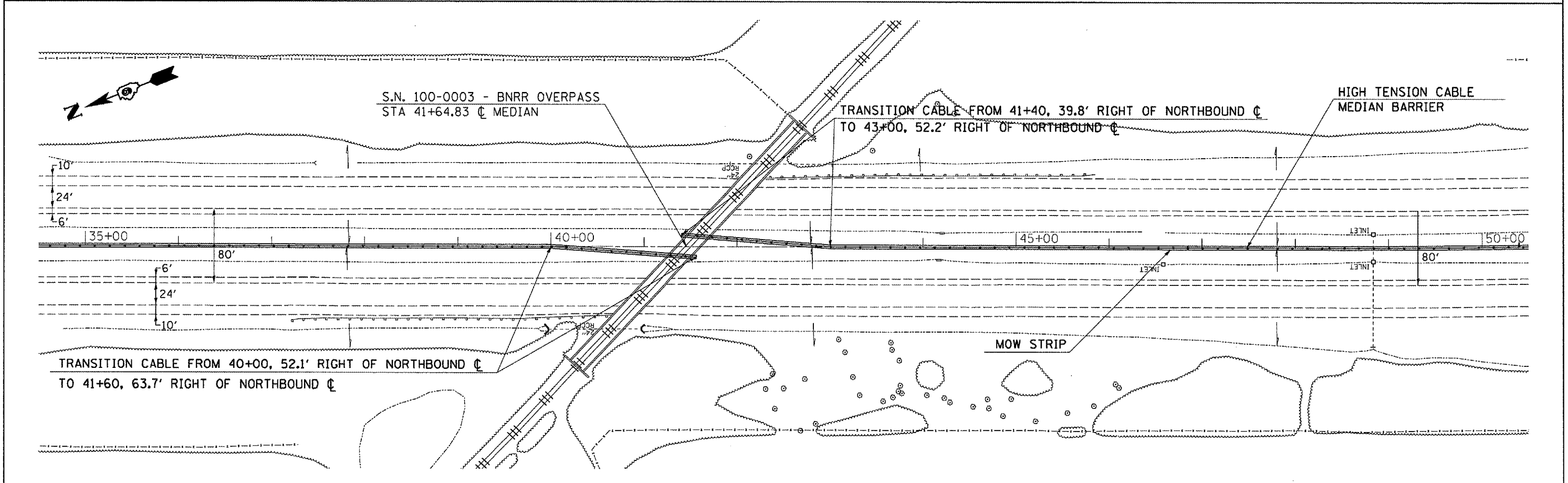
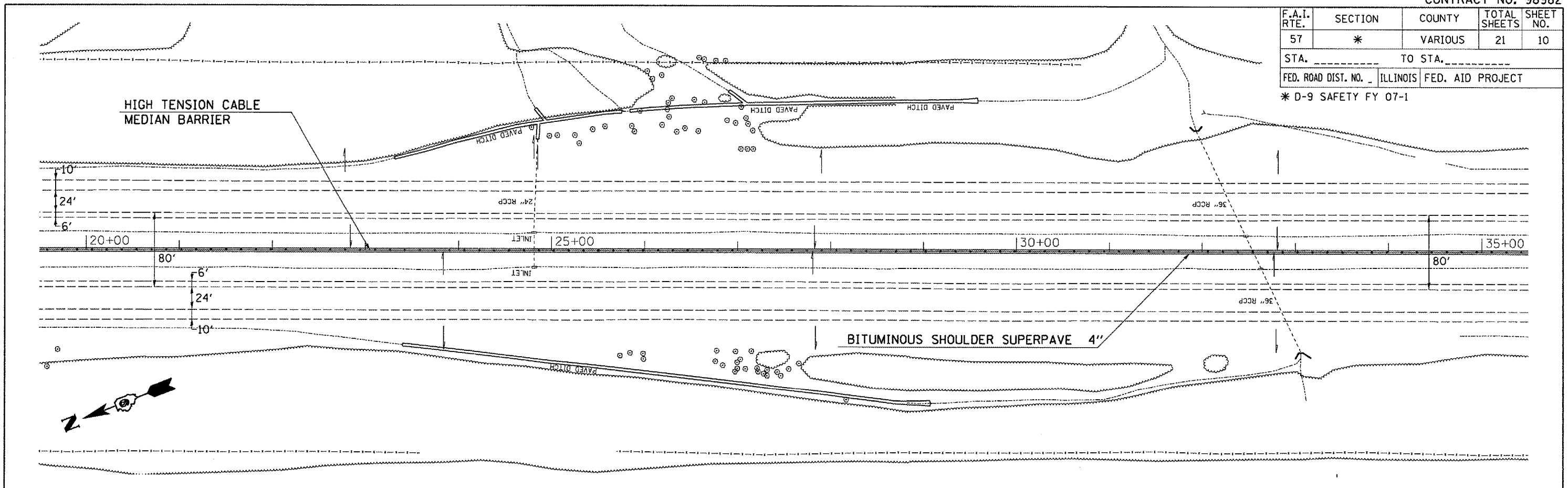

PLOT DATE = 8/21/2006
 PLOT SCALE = 1/8" = 10' / IN.
 USER NAME = jhp-ar-05d

F.A.I. RTE.	SECTION	COUNTY	TOTAL SHEETS	SHEET NO.
57	*	VARIOUS	21	11
STA. _____ TO STA. _____				
FED. ROAD DIST. NO. _____ ILLINOIS		FED. AID PROJECT		
* D-9 SAFETY FY 07-1				

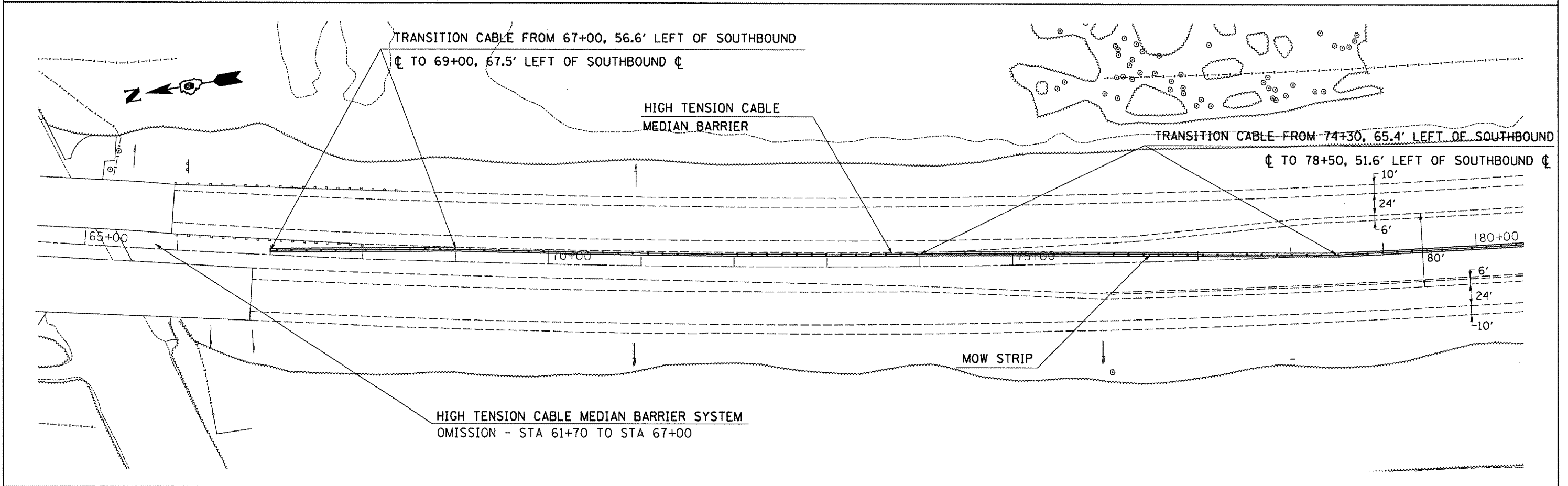
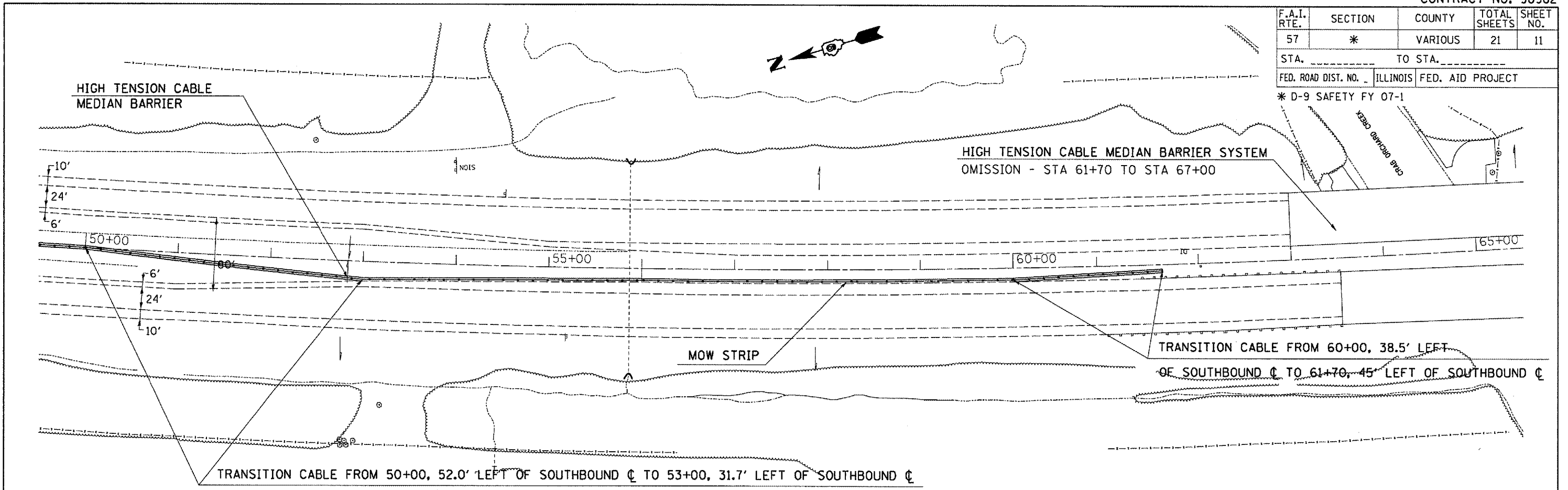

PLOT DATE = 9/21/2006
 PLOT SCALE = 1" = 40'
 USER NAME = mhpardog

F.A.I. RTE.	SECTION	COUNTY	TOTAL SHEETS	SHEET NO.
57	*	VARIOUS	21	12

STA. _____ TO STA. _____
 FED. ROAD DIST. NO. _____ ILLINOIS FED. AID PROJECT

* D-9 SAFETY FY 07-1

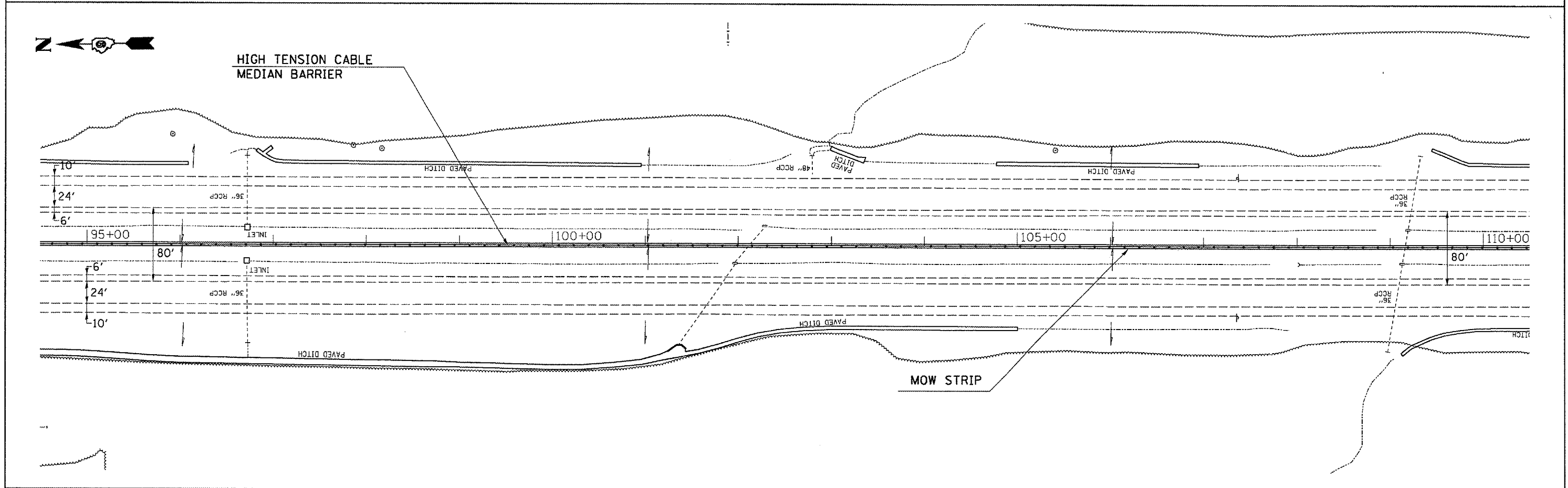
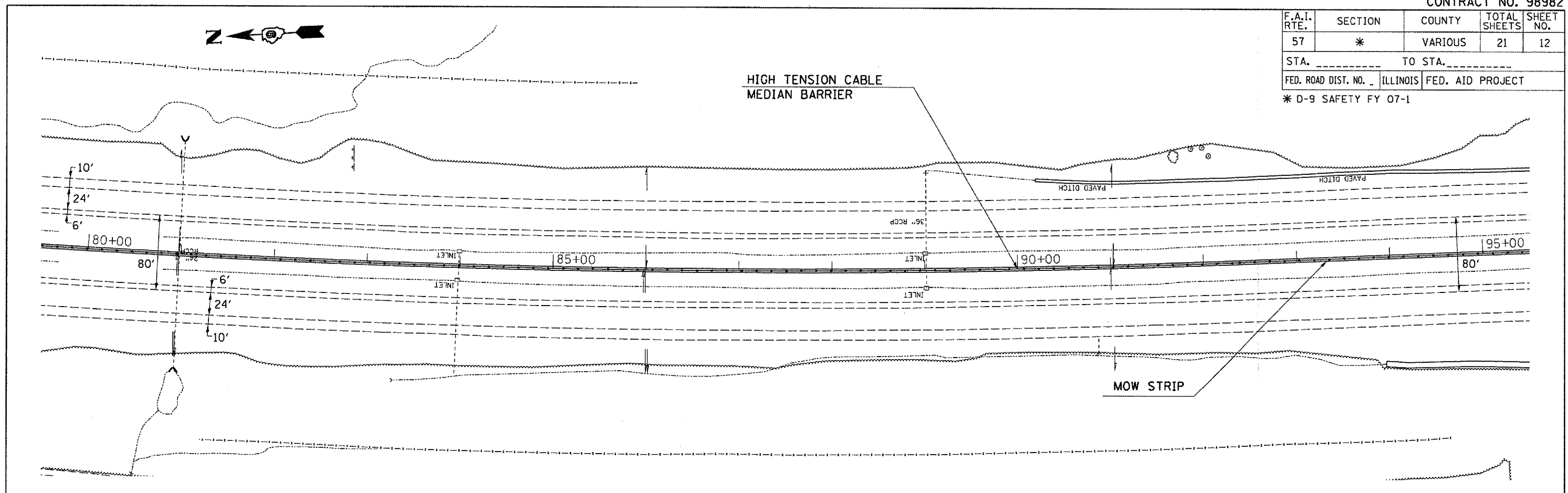

PLOT DATE = 8/21/2006
 PLOT SCALE = 1/4" = 10'-0"
 USER NAME = shepardg

F.A.I. RTE.	SECTION	COUNTY	TOTAL SHEETS	SHEET NO.
57	*	VARIOUS	21	13

STA. _____ TO STA. _____
 FED. ROAD DIST. NO. ILLINOIS FED. AID PROJECT

* D-9 SAFETY FY 07-1

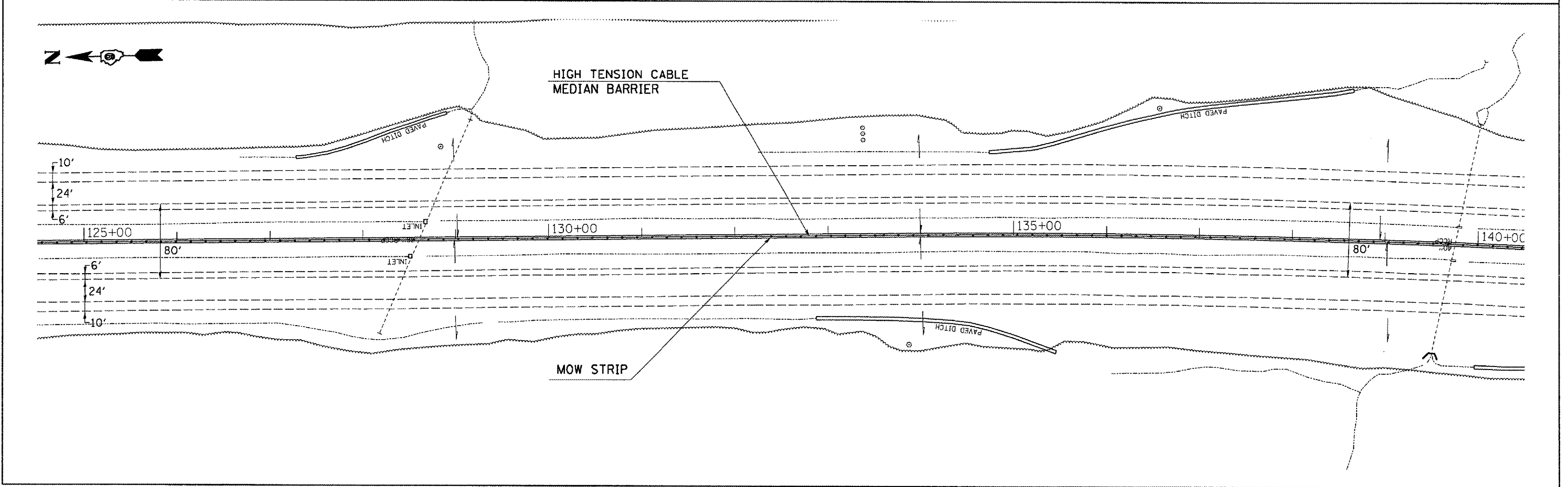
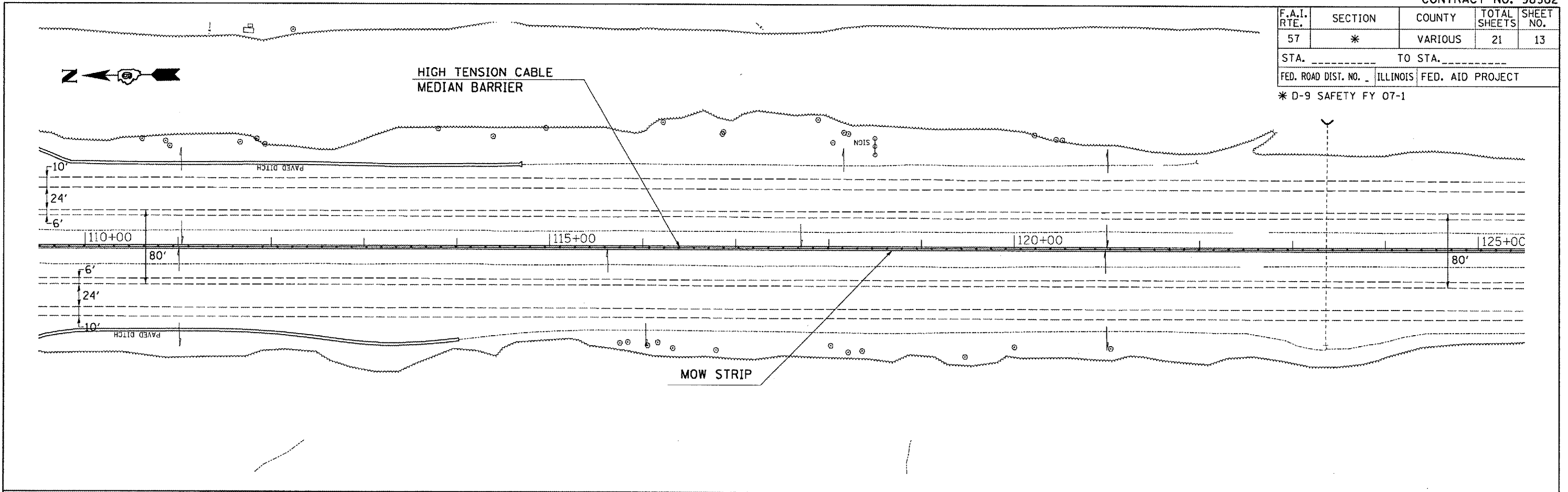

PLOT DATE = 8/21/2008
 PLOT NAME = c:\projects\98982\98982.dwg
 USER NAME = sheppard

F.A.I. RTE.	SECTION	COUNTY	TOTAL SHEETS	SHEET NO.
57	*	VARIOUS	21	14
STA. _____ TO STA. _____		FED. ROAD DIST. NO. _ ILLINOIS FED. AID PROJECT		

* D-9 SAFETY FY 07-1

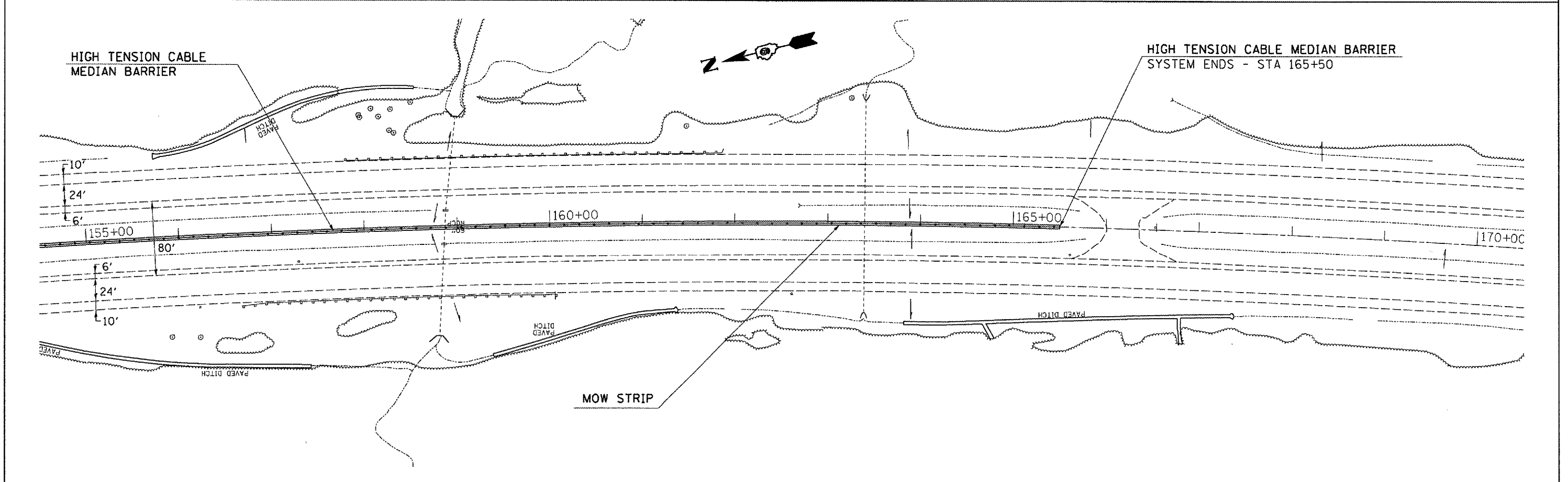
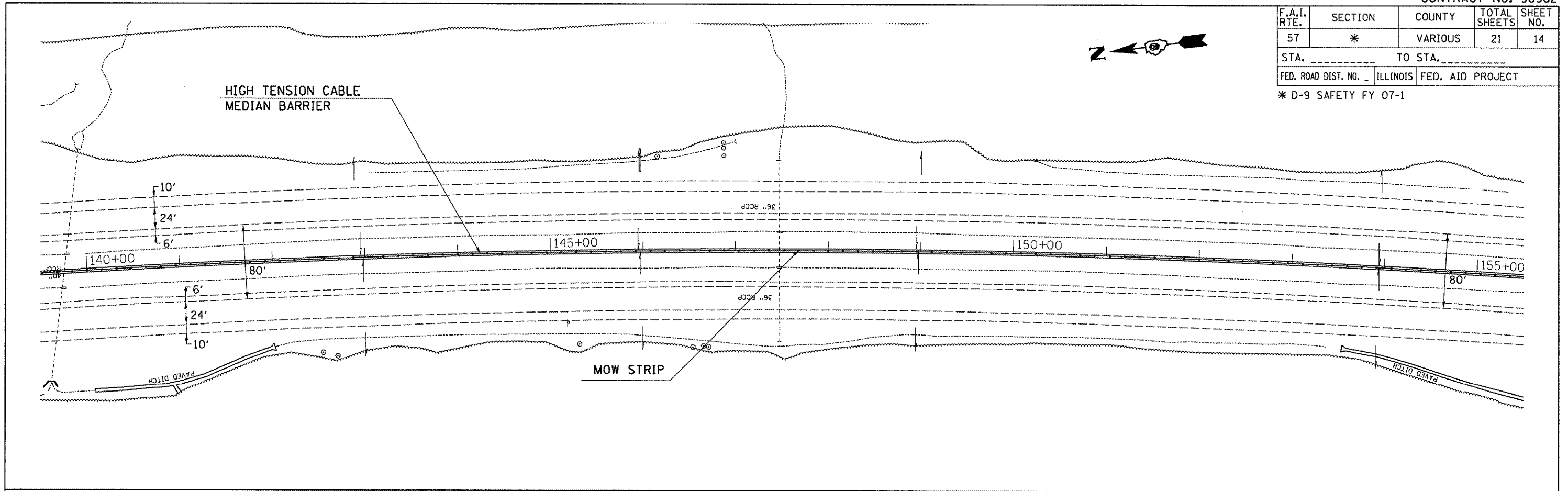

PLOT DATE : 8/21/2008
 PLOT SCALE : 1/8"=1'-0"
 USER NAME : shapiro

STRUCTURE NUMBER 041-0051

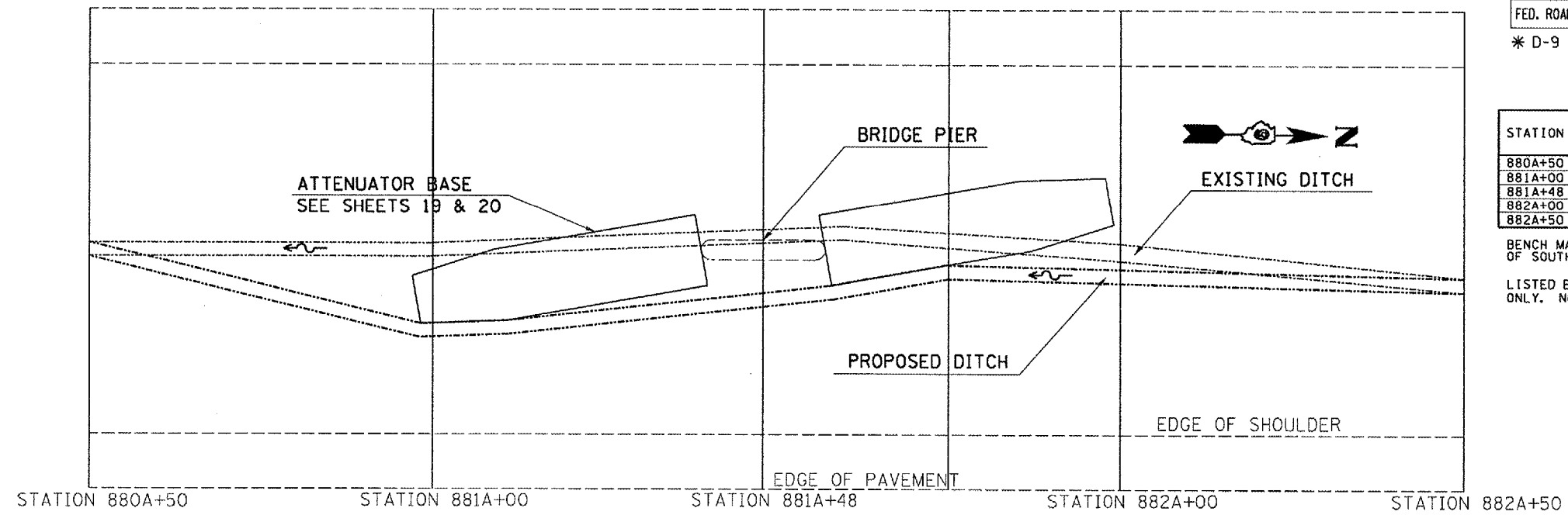

F.A.I. RTE.	SECTION	COUNTY	TOTAL SHEETS	SHEET NO.
57	*	VARIOUS	21	15

STA. _____ TO STA. _____
 FED. ROAD DIST. NO. _____ ILLINOIS FED. AID PROJECT

* D-9 SAFETY FY 07-1

ELEVATIONS

STATION	EDGE OF SOUTHBOUND PAVEMENT	EXISTING FLOWLINE	PROPOSED FLOWLINE
880A+50	20.00	17.33	17.33
881A+00	20.91	18.30	18.79
881A+48	21.70	19.19	20.27
882A+00	22.49	20.40	20.40
882A+50	23.32	21.64	21.64

BENCH MARK STATION 880A+50, INSIDE EDGE OF SOUTHBOUND PAVEMENT, ELEVATION 20.00

LISTED ELEVATIONS ARE LOCAL REFERENCE ONLY. NO TIES TO U. S. G. S. COORDINATES.

STRUCTURE NUMBER 041-0053

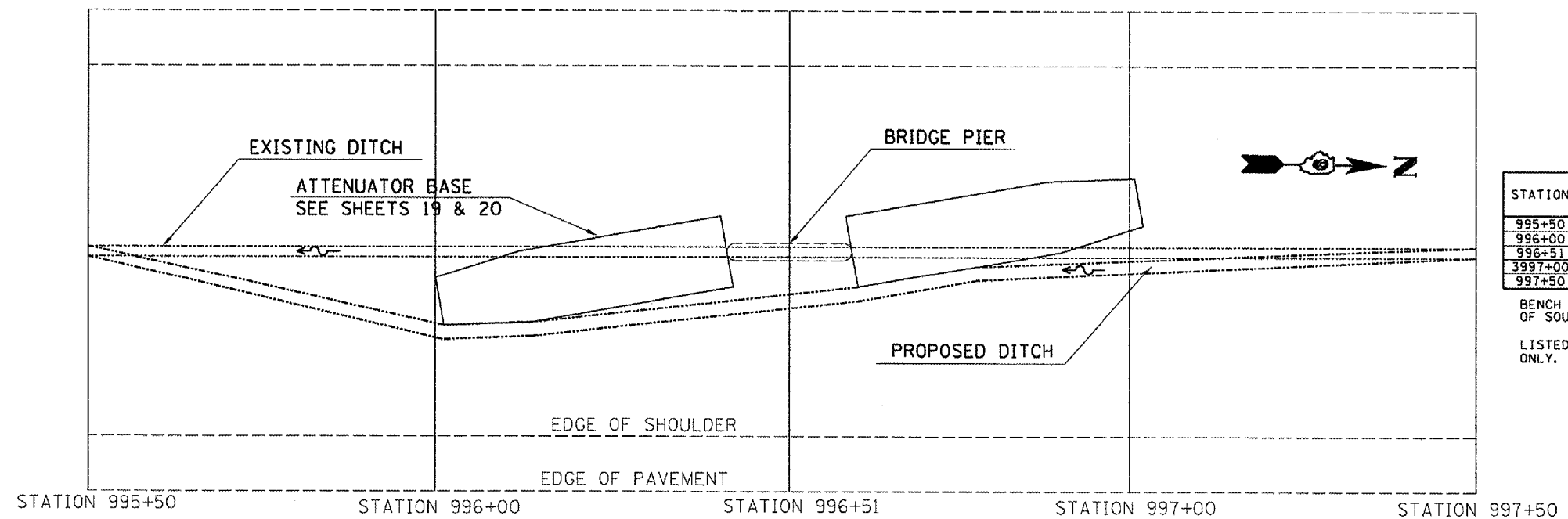

ELEVATIONS

STATION	EDGE OF SOUTHBOUND PAVEMENT	EXISTING FLOWLINE	PROPOSED FLOWLINE
995+50	20.00	15.81	17.01
996+00	20.53	17.02	18.94
996+51	21.27	18.17	19.94
997+00	22.17	19.66	19.66
997+50	23.08	19.44	20.35

BENCH MARK STATION 995+50, INSIDE EDGE OF SOUTHBOUND PAVEMENT, ELEVATION 20.00

LISTED ELEVATIONS ARE LOCAL REFERENCE ONLY. NO TIES TO U. S. G. S. COORDINATES.

PLOT DATE = 6/21/2006
 PLOT SCALE = 1" = 40'
 USER NAME = shapardj

STRUCTURE NUMBER 041-0057

F.A.I. RTE.	SECTION	COUNTY	TOTAL SHEETS	SHEET NO.
57	*	VARIOUS	21	16
STA. _____		TO STA. _____		
FED. ROAD DIST. NO.	ILLINOIS	FED. AID PROJECT		

* D-9 SAFETY FY 07-1

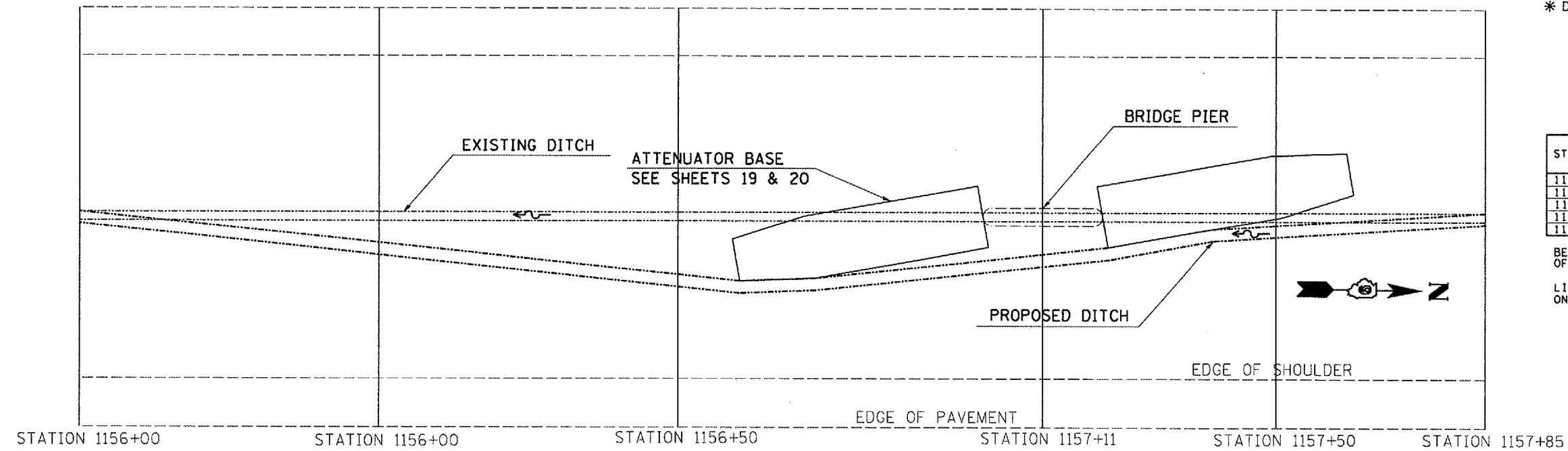

ELEVATIONS

STATION	EDGE OF SOUTHBOUND PAVEMENT	EXISTING FLOWLINE	PROPOSED FLOWLINE
1156+00	20.00	15.20	16.84
1156+50	20.24	15.53	17.38
1157+11	20.43	16.63	17.38
1157+50	20.80	17.15	18.30
1158+00	21.30	16.47	16.47

BENCH MARK STATION 1156+00, INSIDE EDGE OF SOUTHBOUND PAVEMENT, ELEVATION 20.00

LISTED ELEVATIONS ARE LOCAL REFERENCE ONLY. NO TIES TO U. S. G. S. COORDINATES.

STRUCTURE NUMBER 041-0058

ELEVATIONS

STATION	EDGE OF SOUTHBOUND PAVEMENT	EXISTING FLOWLINE	PROPOSED FLOWLINE
526+50	9.39	5.80	5.81
527+00	10.00	6.21	6.22
527+50	10.61	6.62	6.63
527+80	11.00	6.88	7.82
527+90	11.13	6.97	8.29
528+15	11.43	7.26	8.90
528+50	11.86	7.66	9.24
529+00	11.66	8.66	9.26
529+50	11.50	9.66	9.27

BENCH MARK STATION 527+00, INSIDE EDGE OF SOUTHBOUND PAVEMENT, ELEVATION 10.00

LISTED ELEVATIONS ARE LOCAL REFERENCE ONLY. NO TIES TO U. S. G. S. COORDINATES.

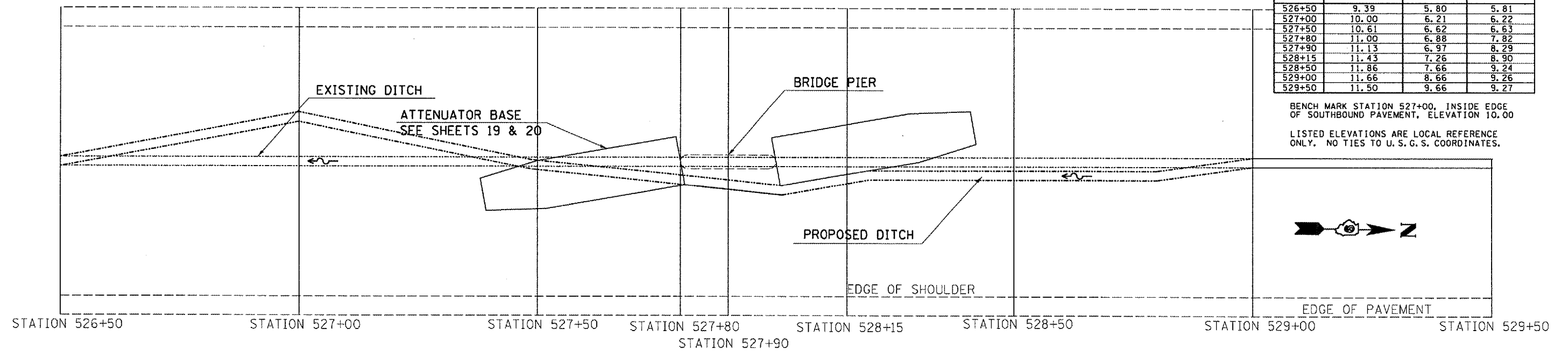

PLOT DATE = 8/21/2006
 PLOT SCALE = 1/8" = 100'
 USER NAME = shepardg

F.A.I. RTE.	SECTION	COUNTY	TOTAL SHEETS	SHEET NO.
57	*	VARIOUS	21	17
STA. _____ TO STA. _____		FED. ROAD DIST. NO. ILLINOIS FED. AID PROJECT		

* D-9 SAFETY FY 07-1

STRUCTURE NUMBER 041-0056

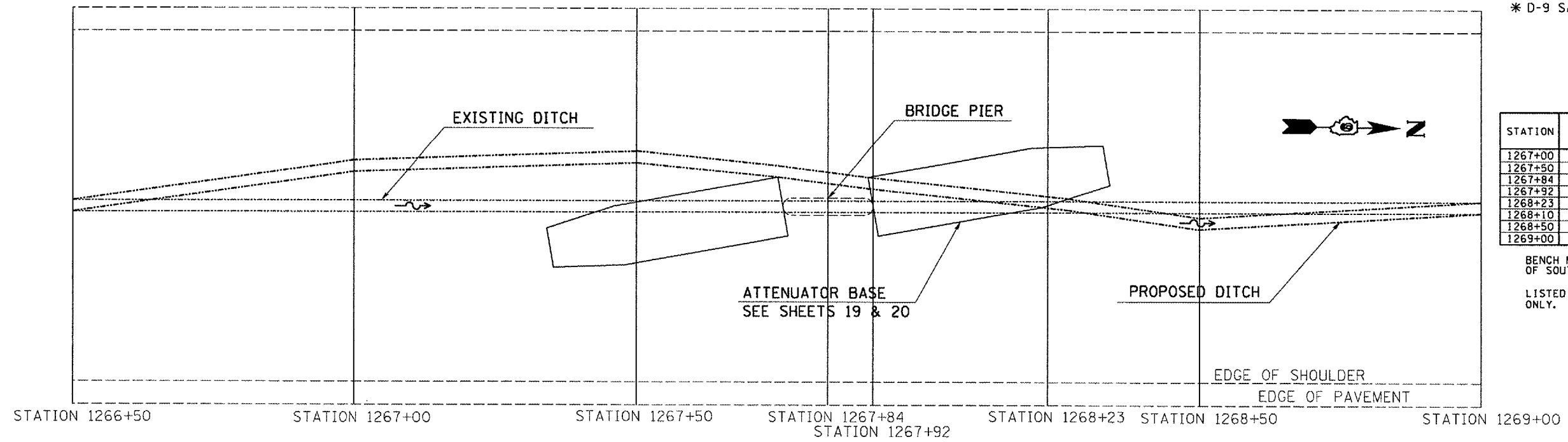

ELEVATIONS

STATION	EDGE OF SOUTHBOUND PAVEMENT	EXISTING FLOWLINE	PROPOSED FLOWLINE
1267+00	20.00	16.02	16.02
1267+50	19.00	15.26	15.68
1267+84	18.32	14.17	15.22
1267+92	18.20	14.06	14.59
1268+23	17.74	13.63	14.38
1268+50	17.78	13.81	14.43
1268+50	17.18	13.25	13.66
1269+00	15.44	12.89	12.89

BENCH MARK STATION 1267+00, INSIDE EDGE OF SOUTHBOUND PAVEMENT, ELEVATION 20.00

LISTED ELEVATIONS ARE LOCAL REFERENCE ONLY. NO TIES TO U. S. G. S. COORDINATES.

STRUCTURE NUMBER 041-0054

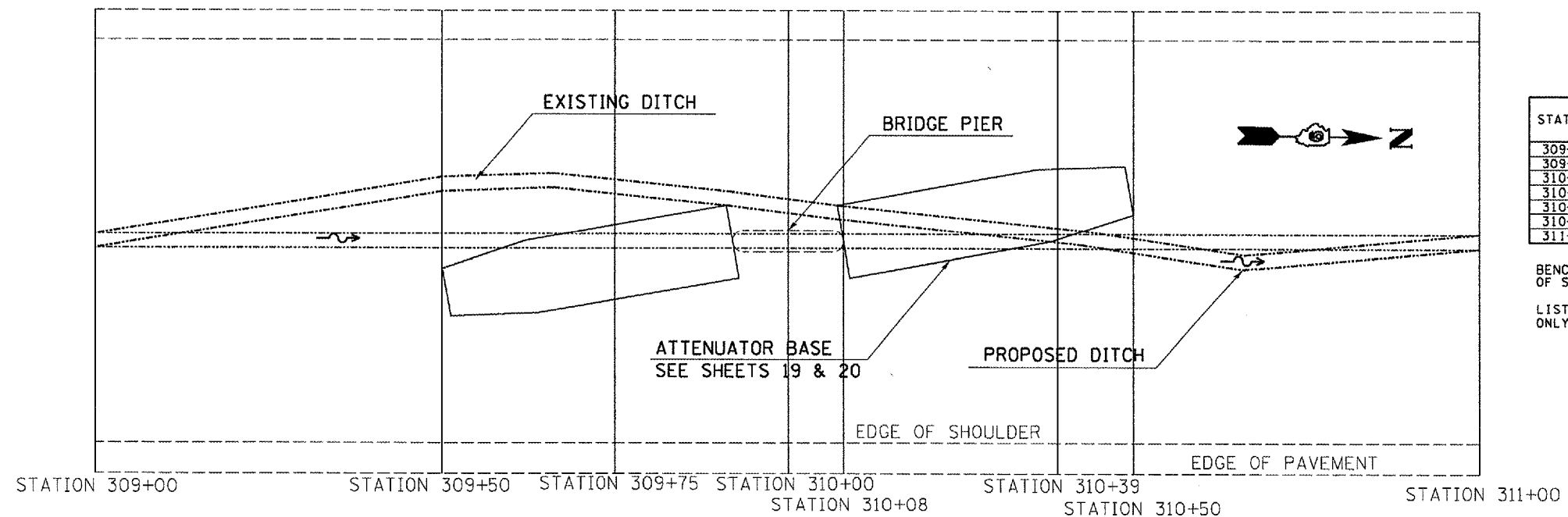

ELEVATIONS

STATION	EDGE OF SOUTHBOUND PAVEMENT	EXISTING FLOWLINE	PROPOSED FLOWLINE
309+00	20.00	16.76	16.76
309+50	19.69	16.49	16.72
310+00	19.56	16.02	16.68
310+08	19.50	16.00	16.33
310+39	19.44	15.93	16.33
310+50	19.42	15.90	16.33
311+00	19.31	15.69	15.69

BENCH MARK STATION 309+00, INSIDE EDGE OF SOUTHBOUND PAVEMENT, ELEVATION 20.00

LISTED ELEVATIONS ARE LOCAL REFERENCE ONLY. NO TIES TO U. S. G. S. COORDINATES.

DATE: 8/21/2006
 PLOT DATE: 8/21/2006
 PLOT SCALE: 1/8"=1'-0"
 USER NAME: sheperd

F.A.I. RTE.	SECTION	COUNTY	TOTAL SHEETS	SHEET NO.
57	*	VARIOUS	21	18
STA. _____		TO STA. _____		
FED. ROAD DIST. NO. _____		ILLINOIS FED. AID PROJECT		
* D-9 SAFETY FY 07-1				

STRUCTURE NUMBER 041-0055

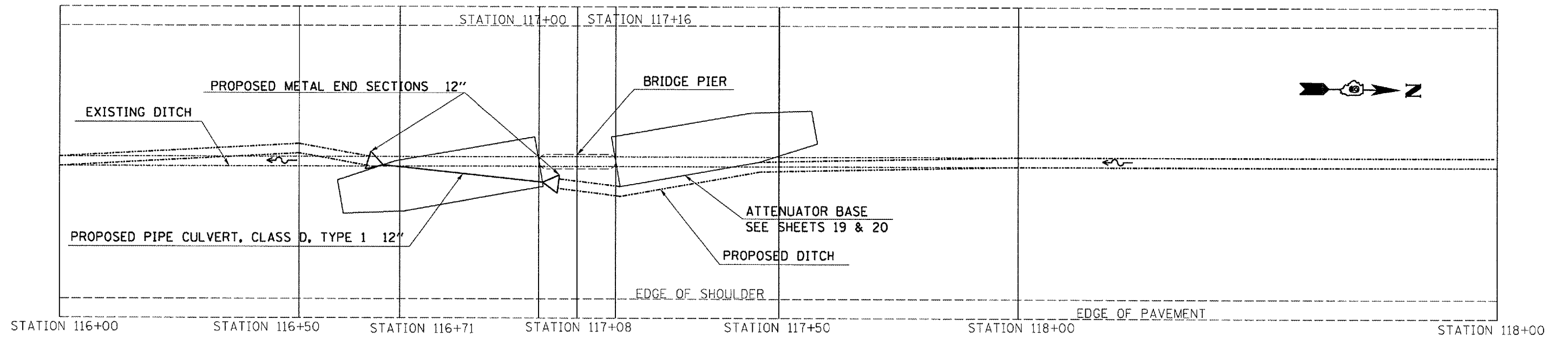

ELEVATIONS

STATION	EDGE OF SOUTHBOUND PAVEMENT	EXISTING FLOWLINE	PROPOSED FLOWLINE
116+00	20.00	14.42	14.42
116+50	20.03	15.43	16.10
116+71	20.01	15.52	16.15
117+00	20.04	15.68	16.43
117+50	20.07	15.97	17.06
118+00	20.17	16.27	17.16
119+00	20.35	16.54	16.54

BENCH MARK STATION 116+00, INSIDE EDGE OF SOUTHBOUND PAVEMENT, ELEVATION 20.00

LISTED ELEVATIONS ARE LOCAL REFERENCE ONLY. NO TIES TO U. S. G. S. COORDINATES.

DATE : 8/21/2006
 USER : jwp
 PROJECT : 98982-041-0055
 SHEET : 18 OF 21

F.A. RTE.	SECTION	COUNTY	TOTAL SHEETS	SHEET NO.
57	*	VARIOUS	21	20
STA. _____		TO STA. _____		
FED. ROAD DIST. NO. _____		ILLINOIS FED. AID PROJECT		

* D-9 SAFETY FY 07-1

SLOPES APPLICABLE TO INERTIAL BARRIERS

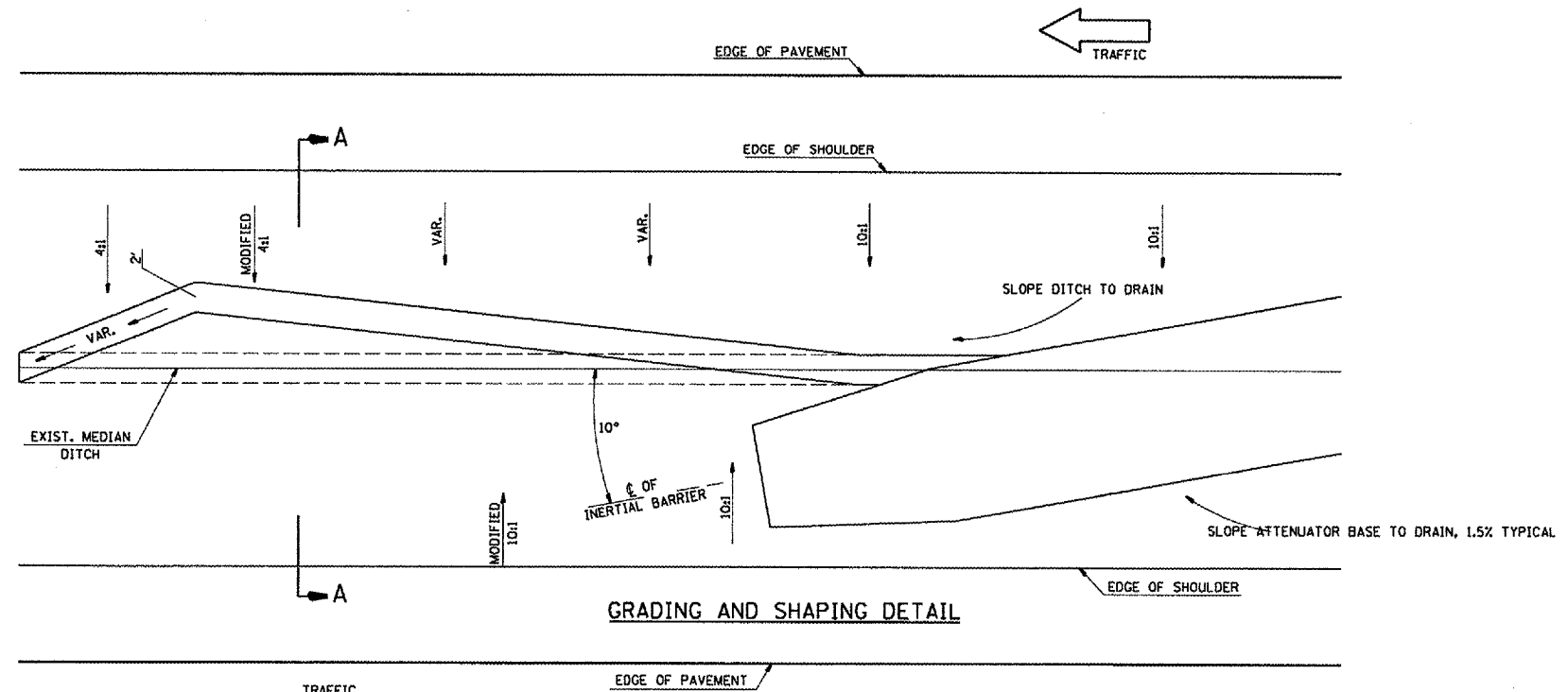

GRADING AND SHAPING DETAIL

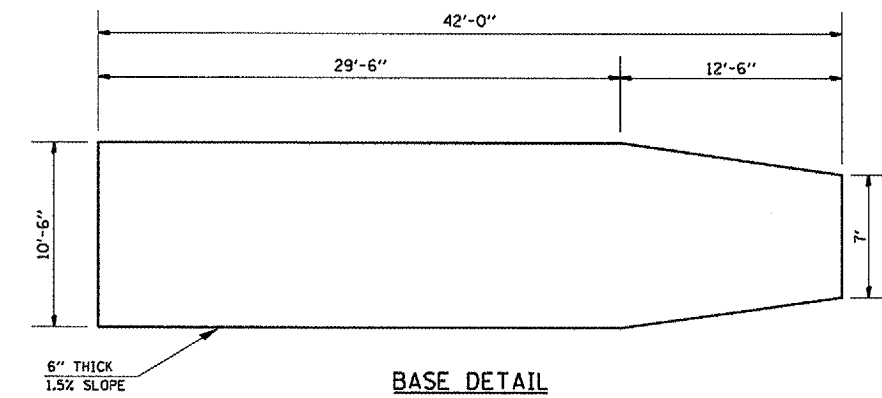

BASE DETAIL

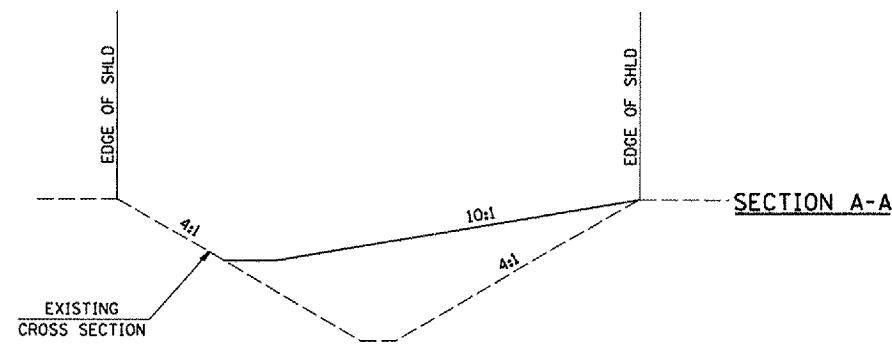

GENERAL NOTES

1. ALL 10:1 SLOPES SHOWN ON THIS DETAIL SHALL BE CONSTRUCTED 10:1 OR FLATTER.
2. THE SLOPES AS SHOWN ON THIS DETAIL SHALL APPLY TO BOTH ENDS OF THE BRIDGE PIERS.
3. THE MATERIAL FOR THE BASE SHALL BE CLASS SI CONCRETE. THE BASE SHALL BE POURED. THIS WILL BE INCLUDED IN THE COST OF IMPACT ATTENUATORS-NON-REDIRECTIVE, TEST LEVEL 3 (EACH).
4. THE EXISTING GROUND HAS A +- 8:1 SLOPE AND STEEPER. THEREFORE THE PROPOSED 10:1 SLOPE WILL NEED FURNISHED EXCAVATION TO COMPLETE.

F.A. RY:	SECTION	COUNTY	TOTAL SHEETS	SHEET NO.
57	•	VARIOUS	21	21
STA. _____		TO STA. _____		
FED. ROAD DIST. NO. _____		ILLINOIS FED. AID PROJECT		

• D-9 SAFETY FY 07-1

SLOPES APPLICABLE TO INERTIAL BARRIERS

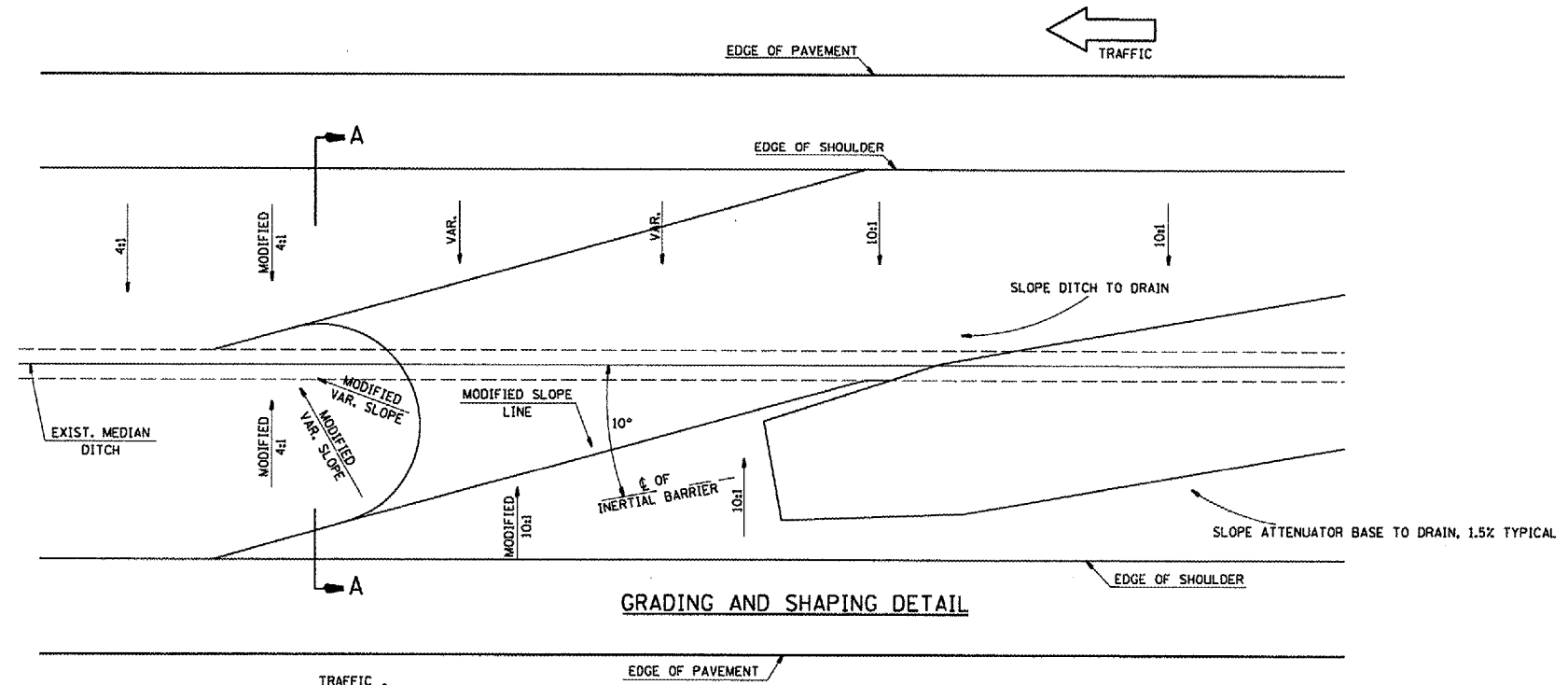

GRADING AND SHAPING DETAIL

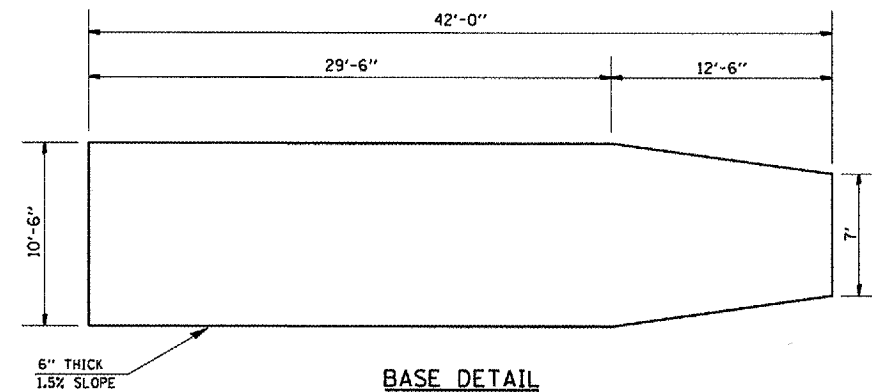

BASE DETAIL

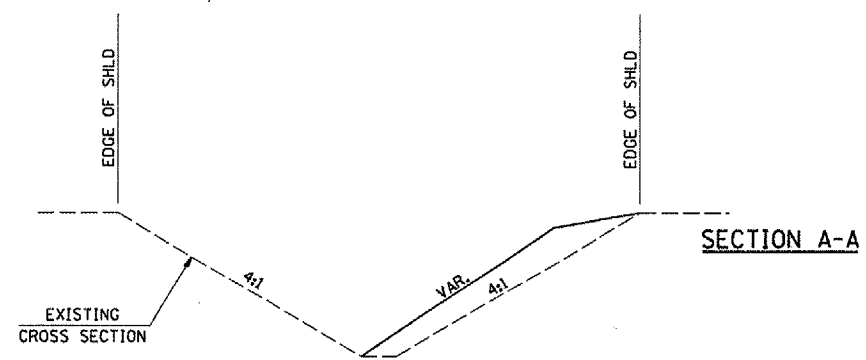

SECTION A-A

GENERAL NOTES

1. ALL 10:1 SLOPES SHOWN ON THIS DETAIL SHALL BE CONSTRUCTED 10:1 OR FLATTER.
2. THE SLOPES AS SHOWN ON THIS DETAIL SHALL APPLY TO BOTH ENDS OF THE BRIDGE PIERS.
3. THE MATERIAL FOR THE BASE SHALL BE CLASS SI CONCRETE. THE BASE SHALL BE POURED. THIS WILL BE INCLUDED IN THE COST OF IMPACT ATTENUATORS-NON-REDIRECTIVE, TEST LEVEL 3 (EACH).
4. THE EXISTING GROUND HAS A +- 8:1 SLOPE AND STEEPER. THEREFORE THE PROPOSED 10:1 SLOPE WILL NEED FURNISHED EXCAVATION TO COMPLETE.

DATE-TIME
DOW-SPEC