

Note: All Steel To Be Painted

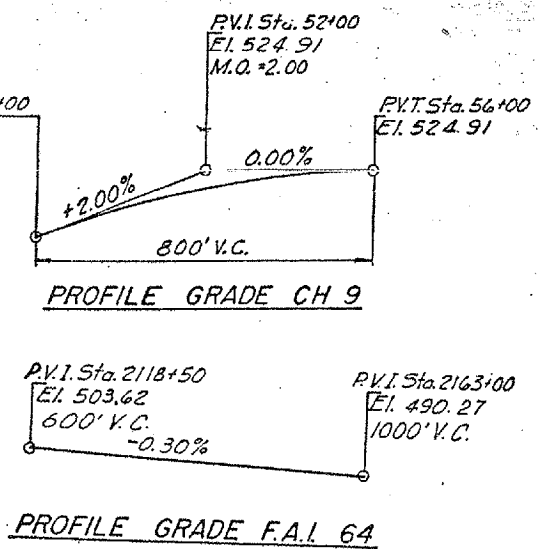
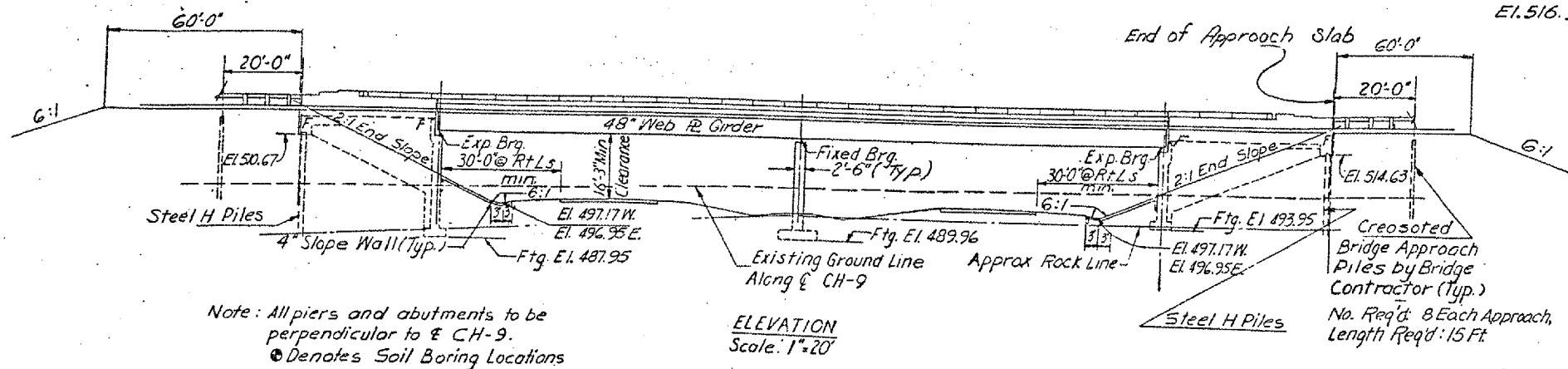

GENERAL NOTES
CONCRETE:
The concrete rail section above the mandatory construct. joint at the top of the slab shall be constructed of Class X Concrete, except the aggregates shall conform to the requirements of Handrail Concrete.
All Reinforcement Bars shall be lapped 24 diameters unless otherwise shown.
For item precast prestressed concrete I-bee see Standard specifications, effective Aug. 1968
All bonded const. joints shall be in accordance with article 504.13(b)1, 2 or 3 of standard specifications.

STATION 2137+99.67
BUILT 197 BY
STATE OF ILLINOIS
F.A.I. RT. 64 SEC. 41-7 HB-1
F.A. PROJ. 1-64-3 (36)
LOADING HS 20

NAME PLATE LETTERING
See Standard 2113-1

DESIGN CRITERIA
A.A.S.H.O. 1965 and Interim Specs. 1966-7
25 p.s.f. for future wearing surface.
Live Load: HS 20-44
Live Load plus Impact deflection $\leq \frac{\text{Span}}{1200}$
Composite Construction.

DESIGN STRESSES
 $f'_c = 3500$ psi. Reinforced Concrete
 $f'_c = 1400$ psi.
 $w_c = 75$ psi. Footings and Wingwalls
 $f'_s = 20,000$ psi Reinforcement
 $f'_s = 20,000$ psi Structural Steel
 $n = 10$
 $f_c = 1200$ p.s.i. Deck Slab

STRUCTURAL STEEL:
All field connections shall be bolted using high strength bolts. Bolts $\frac{3}{4}$ " ϕ , open holes $\frac{1}{2}$ " ϕ , unless otherwise noted.
Field welding of construction accessories will not be permitted to the bottom flange of beams or girders nor to the top flange for a distance equal to one-fourth the span length each way from the pier supports. Field welding in other areas will be permitted only when approved by the Engineer.

Calculated plan weight of Structural Steel = 387,420 pounds.

Welding shall comply with Article 507.04(s) of the Standard Specifications and with the Special Provisions.

All Structural Steel shall be inspected by the Illinois Division of Highways before painting.
The Basic Lead Silico Chromate paint system shall be used for shop and field painting of structural steel.

Anchor bolts shall be set before bolting diaphragms over supports.

SUBSTRUCTURE:
The Contractor shall drive one Steel Test Pile (BBP36) in a permanent location at the South Abutment, as directed by the Engineer before ordering the remainder of Steel Piles. All Steel Piles shall be driven to refusal.

Slope wall shall be reinforced with welded wire fabric 6x6 mesh, weighing 58# per sq. ft.
The embankment configuration shown shall be the minimum embankment that must be constructed prior to construction of the abutments.

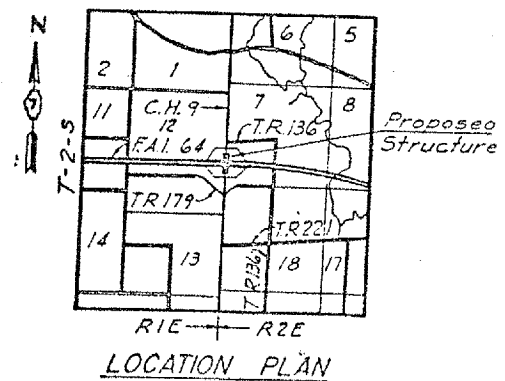
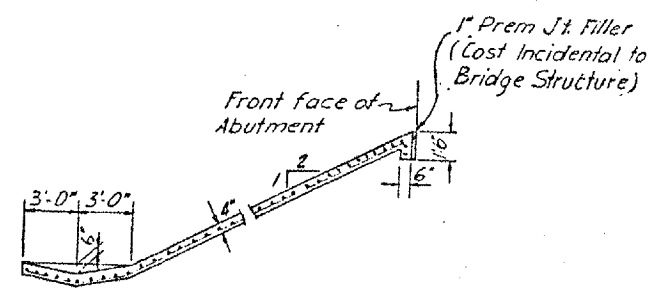
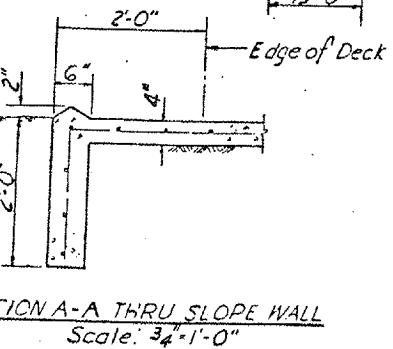
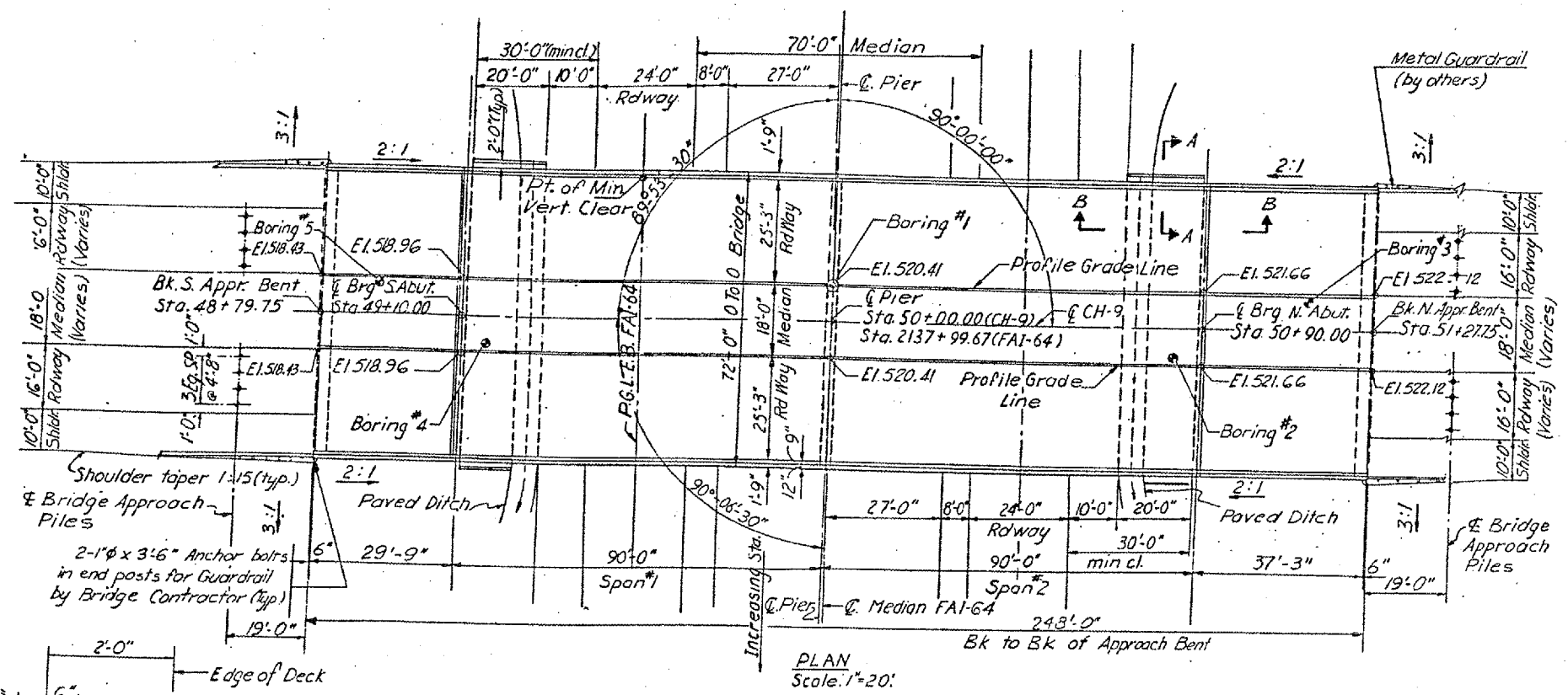

TOTAL BILL OF MATERIAL

Item	Unit	Super	Sub.	Total
Rock Excav for Structures	Cu.Yds.	—	65	65
Class A Excav for Structures	Cu.Yds.	—	687	687
Class X Concrete	Cu.Yds.	556.0	512.1	1068.1
Furn. & Erect. Struct. Steel	L. SUM	—	—	—
Aluminum Fencing	Lin. Ft.	453	—	453
Reinforcement Bars	Lbs.	133600	49060	182660
Creosoted Piles	Lin. Ft.	—	240	240
Steel H Piles (BBP36)	Lin. Ft.	—	501	501
Test Piles (Steel) (BBP36)	Each	—	1	1
Name Plates	Each	—	—	—
Slope Wall 4"	Sq.Yds.	—	227	227
Protective Coat	Sq.Yds.	2067	—	2067
Preformed Joint Sealer	Lin. Ft.	146	—	146
Prec. Prest Conc I-Beam (36)	Lin. Ft.	510	—	510
Shear Stud Connector	Each	2760	—	2760

* Class A Excavation for Structures includes excavation for Slope Wall.

GENERAL PLAN & ELEVATION

BRIDGE NO. 3
041-0069
FOR INFORMATION ONLY